

Hybrid Pro Modular Kit 19B

Hybrid Pro 20x20 Modular Island Kit 19B

Hybrid Pro™ Modular Kit 19B is a towering and eye-catching 20ft x 20ft island exhibit, designed to draw attention to your brand. Kit 19B is available for purchase or rent.

Kit 19B features an aluminum frame decorated with seamless push-fit SEG fabric graphics. Four towering display panels rise 15' 9" and prominently display your message and brand on the tradeshow floor. LED lights atop the structure illuminate messaging. This design features an integrated demonstration area and counter, a meeting table, as well as an integrated closet to secure stored items.



We are continually improving and modifying our product range and reserve the right to vary the specifications without prior notice. All dimensions and weights quoted are approximate and we accept no responsibility for variance. E&OE. See Graphic Templates for graphic bleed specifications

10/15/2024

features and benefits:

- 15'9" tall, square shaped island display
- Silver aluminum extrusion frame
- Push-fit SEG fabric graphics (16) & one sheer graphic (1)
- 16 Lumina 200 LED floodlights
- 36"W x 36"H x 12"D laminate counter for demonstration area (monitor not included)
- Hybrid Pro Counter 14 with graphic serves as a meeting table (chairs not included)
- 102"W x 94"H x 39"D SEG closet for accessible storage
- Kit includes frame, 17 SEG graphic panels, two counters, one closet, 16 Lumina 200 LED floodlights and one Woodcrate
- Lights Included: Lumina 200 LED floodlight, straight arm and adjustable head, black finish, 19.5" from end to end
- Flooring, monitor and chairs not included
- Lifetime hardware warranty against manufacturer defects

dimensions:

Hardware

Assembled unit:

200.79" w x 188.98" h x 200.79" d
5100mm(w) x 4800mm(h) x 5100mm(d)

Approximate Weight:
1147 lbs / 521 kg

Graphics

Refer to related graphic templates for more information Visit:

<https://www.theexhibitorshandbook.com/downloads/download-graphic-templates> or click here

Shipping

Packing case(s):
1 WOODCRATE-K-19-01

Shipping dimensions:
WOODCRATE-K-19-01:
100"W x 50.5"D x 52.5"T
2540mm(l) x 1283mm(h) x 1334mm(d)

Approximate shipping weight:
1697 lbs / 770 kg



This product may include the following materials for recycle: aluminum, select wood, fabric, cardboard, paper, steel, and plastics.

additional information:

Laminate Colors:



Dove
Grey



Black



Designer
White



Fusion
Maple

2 person assembly recommended:



HP-K-19B

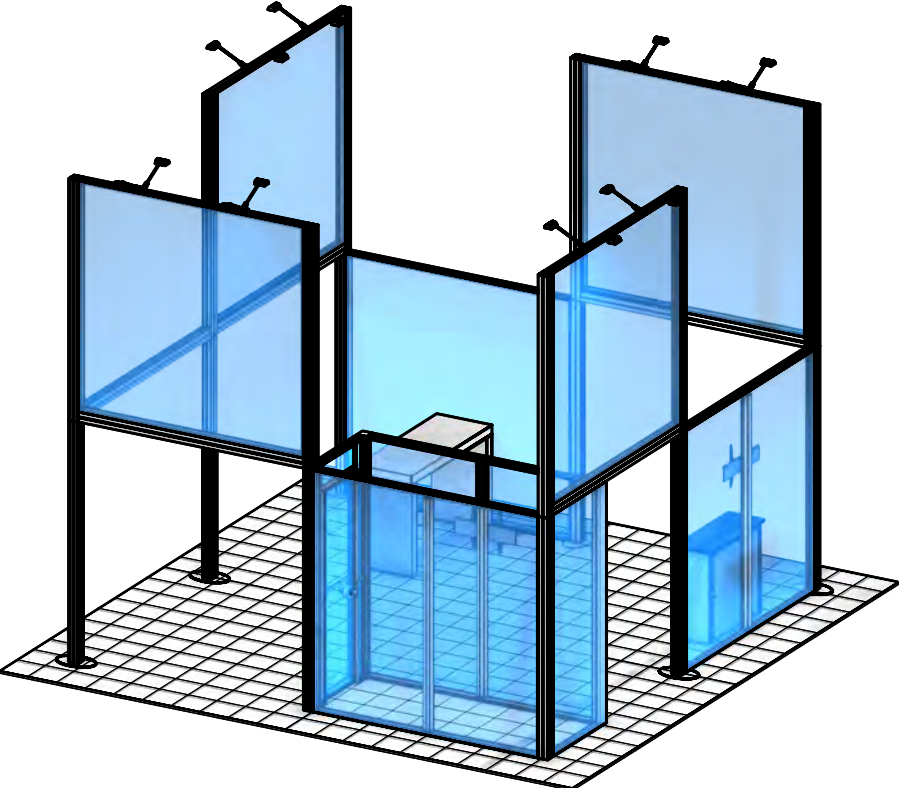
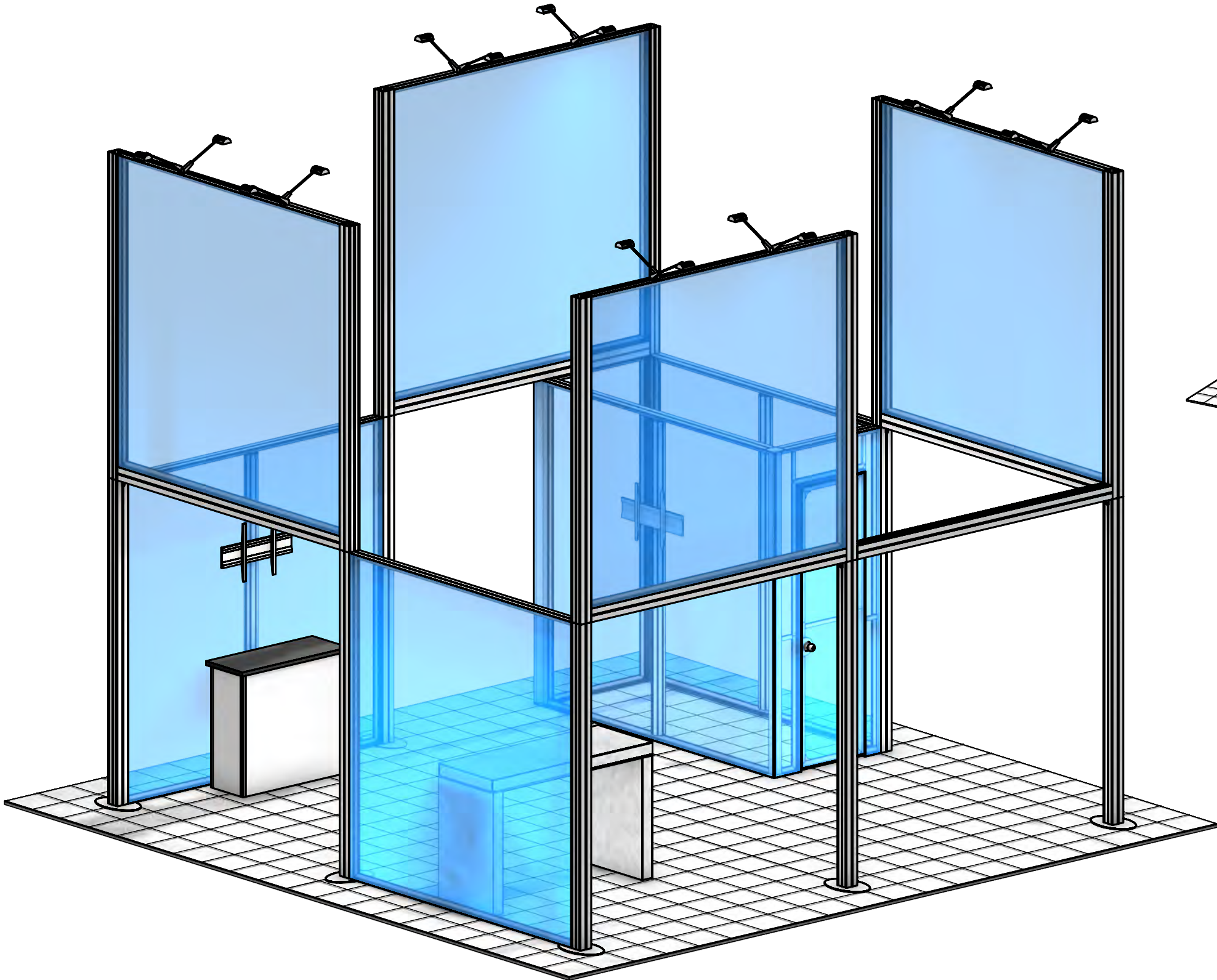

PROJECT BOM

SETUP#	HARDWARE	#	DESCRIPTION
	20x20	1	20x20
A1	101-105-01-01	2	105MM CUT DOWN FROM 300MM LENGTH OF PH1 EXTRUSION-WITH CAM LOCKS BOTH ENDS
A2	101-210-01-01	2	210MM CUT DOWN FROM 300MM LENGTH OF PH1 EXTRUSION-WITH CAM LOCKS BOTH ENDS
A3	241-2400-01-01	5	2400MM LENGTH OF PM4S2-WITH CAM LOCKS BOTH ENDS
A4	241-2400-10-10	16	2400MM LENGTH OF PM4S2-WITH STOPS AT 315MM BOTH SIDES
A5	242-2310-01-01	3	2310MM LENGTH OF PM4R8-WITH CAM LOCKS BOTH ENDS
A6	245-600-11	8	600MM 4-WAY INTERNAL CONNECTION EXTRUSION W/ 8 TENSION GLIDE
A7	302-2386	1	2386MM CUT DOWN FROM 2400MM LENGTH OF FC EXTRUSION
A8	340-900-01-01	1	900MM LENGTH OF PHFC4 EXTRUSION-WITH CAM LOCKS BOTH ENDS
A9	340-900-01-03	2	900MM LENGTH OF PHFC4 EXTRUSION-WITH CAM LOCK 1 END-MITRE CUT 1 END
A10	340-2300-03-03-06	8	2300MM LENGTH OF PHFC4 EXTRUSION-WITH MITRE CUT BOTH ENDS-WITH SIDE LOCKS
A11	340-2389-01-01	2	2389MM LENGTH OF PHFC4 EXTRUSION-WITH CAM LOCKS BOTH ENDS
A12	340-2400-03-03	14	2400MM LENGTH OF PHFC4 EXTRUSION-WITH MITRE CUT BOTH ENDS
A13	340-2400-03-03-06	7	2400MM LENGTH OF PHFC4 EXTRUSION-WITH MITRE CUT BOTH ENDS-WITH SIDE LOCKS
A14	342-2386-10-10	2	2386MM OF PMFC4-90-B EXTRUSION -WITH STOPS AT 315MM
346-600	346-600	4	600MM WME EXTRUSION
346-1000	346-1000	4	1000MM WME EXTRUSION
409-900	409-900	4	900MM LENGTH OF L90S EXTRUSION
CB9	CB9	31	90 DEGREE JOINER
CBE-50	CBE-50	9	CORNER PRESSURE FIT CONNECTOR
CT-31L	CT-31L	1	1000mm X 394mm 30MM LAMINATE COUNTER TOP
	CUS-HINGE	1	VF DOOR HINGE
EXT-LG-MB	EXT-LG-MB	2	Large LCD Monitor mount, 37" - 70" size, 110 Lb. max. weight, Tilting-with extrusion mounted hardware
LUM-LED2	LUM-LED2-ORL-S	16	25 WATT SILVER LED STEM LIGHT (REPLACES 200 W HALOGEN)
PANEL 1	PANEL 1	1	900MM X 588MM WOOD PANEL
PANEL 2	PANEL 2	1	900MM X 588MM WOOD PANEL
PANEL 3	PANEL 3	1	1500MM X 588MM WOOD PANEL
A15	PL-300-900	2	300MM W X 900MM H LAMINATE PANEL
A16	PL-900-900	1	900MM W X 900MM H LAMINATE PANEL
A17	PL-CD-900-900	1	900MM W X 900MM V LAMINATED PANEL CABINET DOOR
PM4BP1	PM4BP1	6	15 3/4" X 9 7/8" ALUMINUM BASE PLATE
PMFC4-90	PMFC4-90-B-CAP	4	PLASTIC MOLDED END CAP FOR THE PMFC4-90-B EXTRUSION
VF-FCD-90	VF-FCD-900-LS	1	VECTOR FRAME FABRIC CHANNEL DOOR 900MM X 2400MM X 100MM FRAME LEFT SPLIT DOOR
SETUP#	GRAPHICS	#	DESCRIPTION
A1	HP-19B-A1-G	1	GRAPHIC (A1) (98.37 w X 94.43 h total size) 94.37 w X 90.43 h finish size, Dye-sub print on Eclipse Blockout Stretch, single sided, sewn with FCE-2 silicone beading around perimeter & pull tab in bottom right corner
A2	HP-19B-A2-G	1	GRAPHIC (A2) (98.37 w X 94.43 h total size) 94.37 w X 90.43 h finish size, Dye-sub print on Eclipse Blockout Stretch, single sided, sewn with FCE-2 silicone beading around perimeter & pull tab in bottom right corner
B1	HP-19B-B1-G	1	GRAPHIC (B1) (98.37 w X 94.43 h total size) 94.37 w X 90.43 h finish size, Dye-sub print on Eclipse Blockout Stretch, single sided, sewn with FCE-2 silicone beading around perimeter & pull tab in bottom right corner
B2	HP-19B-B2-G	1	GRAPHIC (B2) (98.37 w X 94.43 h total size) 94.37 w X 90.43 h finish size, Dye-sub print on Eclipse Blockout Stretch, single sided, sewn with FCE-2 silicone beading around perimeter & pull tab in bottom right corner

PROJECT BOM

C1	HP-19B-C1-G	1	GRAPHIC (C1) (98.37 w X 98.37 h total size) 94.37 w X 94.37 h finish size, Dye-sub print on Eclipse Blockout Stretch, single sided, sewn with FCE-2 silicone beading around perimeter & pull tab in bottom right corner
C2	HP-19B-C2-G	1	GRAPHIC (C2) (43.37 w X 98.37 h total size) 39.37 w X 94.37 h finish size, Dye-sub print on Eclipse Blockout Stretch, single sided, sewn with FCE-2 silicone beading around perimeter & pull tab in bottom right corner
C3	HP-19B-C3-G	1	GRAPHIC (C3) (105.97 w X 98.37 h total size) 101.97 w X 94.37 h finish size, Dye-sub print on Eclipse Blockout Stretch, single sided, sewn with FCE-2 silicone beading around perimeter & pull tab in bottom right corner
C4	HP-19B-C4-G	1	GRAPHIC (C4) (43.37 w X 98.37 h total size) 39.37 w X 94.37 h finish size, Dye-sub print on Eclipse Blockout Stretch, single sided, sewn with FCE-2 silicone beading around perimeter & pull tab in bottom right corner
C5	HP-19B-C5-G	1	GRAPHIC (C5) (26.95 w X 85.38 h total size) 22.95 w X 81.38 h finish size, Dye-sub print on Eclipse Blockout Stretch, single sided, sewn with FCE-2 silicone beading around perimeter & pull tab in bottom right corner
C5	HP-19B-C5-L	1	LINER (C5) (26.95 w X 85.38 h total size) 22.95 w X 81.38 h finish size, Opaque Liner, sewn with FCE-2 silicone beading around perimeter & pull tab in bottom right corner
D1	HP-19B-D1-G	1	GRAPHIC (D1) (98.37 w X 94.43 h total size) 94.37 w X 90.43 h finish size, Dye-sub print on Eclipse Blockout Stretch, single sided, sewn with FCE-2 silicone beading around perimeter & pull tab in bottom right corner
D2	HP-19B-D2-G	1	GRAPHIC (D2) (98.37 w X 94.43 h total size) 94.37 w X 90.43 h finish size, Dye-sub print on Eclipse Blockout Stretch, single sided, sewn with FCE-2 silicone beading around perimeter & pull tab in bottom right corner
D3	HP-19B-D3-G	1	GRAPHIC (D3) (98.37 w X 98.37 h total size) 94.37 w X 94.37 h finish size, Dye-sub print on Eclipse Blockout Stretch, single sided, sewn with FCE-2 silicone beading around perimeter & pull tab in bottom right corner
D4	HP-19B-D4-G	1	GRAPHIC (D4) (98.37 w X 98.37 h total size) 94.37 w X 94.37 h finish size, Dye-sub print on Eclipse Blockout Stretch, single sided, sewn with FCE-2 silicone beading around perimeter & pull tab in bottom right corner
E1	HP-19B-E1-G	1	GRAPHIC (E1) (98.37 w X 94.43 h total size) 94.37 w X 90.43 h finish size, Dye-sub print on Eclipse Blockout Stretch, single sided, sewn with FCE-2 silicone beading around perimeter & pull tab in bottom right corner
E2	HP-19B-E2-G	1	GRAPHIC (E2) (98.37 w X 94.43 h total size) 94.37 w X 90.43 h finish size, Dye-sub print on Eclipse Blockout Stretch, single sided, sewn with FCE-2 silicone beading around perimeter & pull tab in bottom right corner
E3	HP-19B-E3-G	1	GRAPHIC (E3) (98.37 w X 98.37 h total size) 94.37 w X 94.37 h finish size, Dye-sub print on 2oz. Sheer, single sided, sewn with silicone beading around perimeter & pull tab in bottom right corner
E4	HP-19B-E4-G	1	GRAPHIC (E4) (98.37 w X 98.37 h total size) 94.37 w X 94.37 h finish size, Dye-sub print on 2oz. Sheer, single sided, sewn with silicone beading around perimeter & pull tab in bottom right corner

FABRIC, VINYL & UV GRAPHIC CARE GUIDELINES

GENERAL HANDLING FABRIC GRAPHICS

- Your fabric graphics should always be handled in a clean and dry area with clean hands. When possible, use white fabric gloves.
- Be sure fabric is clean and dry before packing.
- Machine washing and/or drying is not recommended for all fabrics. Refer to the chart below for which fabrics are washable.

EMERGENCY STAIN TREATMENT (FABRIC)

- For dry stains, like loose dirt or pencil marks, try initially using masking tape or Magic Eraser (dry-not moistened).
- Introduce water or liquids to treat stains, if at all possible, treat the stain with fabric off of the frame.

- Place a clean dry cloth behind stain (to absorb stains while being treated). Moisten another cloth initially with just water (distilled water is optimal, if available).
- Gently blot stain with moistened cloth (or small area of moistened Magic Eraser), while trying to push stain through to the back, using the dry cloth to absorb.
- Repeat using care to keep the wet area as small as possible.
- Grandma's Secret Spot remover can be an effective stain remover. Mix several drops in a small cup with clean water. Repeat above and using dry cloth on back of stain to absorb.

MACHINE WASHING FABRIC GRAPHICS

- Cold water/delicate cycle/tumble dry low or air dry. For stretch fabrics do not use dryer, let hang dry.
- Use caution on dryer time with graphics containing liners. It's best to put tension fabric on frame when fabric is still damp and let it air dry. Always be sure that the aluminum frame is clean when mounting the damp graphic.
- Fabric stretch graphics that are washed and machine dried may shrink up to 3/4" per every 50" of fabric in the direction of the stretch and shrink up to 1/4" in non stretch direction.

STORING & PACKING BACKLIT GRAPHICS

- To avoid cracks in the ink or having to steam graphics, Backlit fabrics should be loosely folded with bubble wrap or stored around a tube.
- Avoid folding the graphic tightly to store in a small bag or box.

GENERAL HANDLING VINYL & UV GRAPHICS

- Vinyl banners and rigid graphics should always be handled in a clean and dry area with clean hands. When possible, use white fabric gloves.
- Be sure vinyl/ UV is clean and dry before packing. Always follow material handling and packing instructions included.
- All vinyl material should be rolled with graphic facing in to protect the graphic printed side. Roll on a tube in available.
- Avoid folding material to reduce the risk of crease lines and chipped inks. If a graphic must be folded, try and fold loosely and as few times as possible.

EMERGENCY STAIN TREATMENT (UV)

- For dry stains, like loose dirt, pencil marks or adhesive, try initially using masking tape, Masking tape can be quite effective at lifting dry surface dirt. Try 'pulling' as much of stain away as you can and avoid rubbing the stain into the material.
- While using Windex® avoid scrubbing harshly. Too much pressure can fade the graphic print.

GENERAL HANDLING OF ROLLABLE PVC PANELS

All mural panels, truss panels and detachables should be rolled with the graphic facing out to protect the graphic printed side. Mural panels should be stored in the original plastic sleeves that are provided with the panels.

STEAMING FABRIC GRAPHICS

- For optimal results, steam wrinkles when fabric is tensioned and installed securely on the frame.
- Fill steamer with clean drinking water or distilled water. Avoid using water containing hard minerals.
- Hold steamer upright and hold close to fabric. Avoid touching fabric with steamer.
- Do not tap steamer as water drips may cause water marks to form on graphic

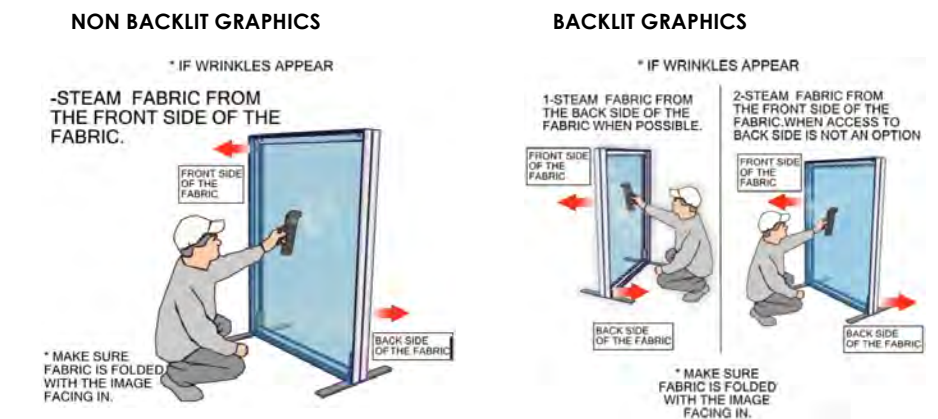

FABRIC	WASHING MACHINE	DRY CLEAN	SPOT CLEAN	STEAMING / IRON	MAGIC ERASER
RESILIENCE	NO	NO	NO	NO	YES (ONLY ON WHITE)
OXFORD	YES	YES	YES	YES	YES
POWER STRETCH	YES	YES	YES	YES	YES
DISPLAY POLYESTER	YES	YES	YES	YES	YES
DISPLY POLY TABLE THROWS	YES	YES	YES	YES	YES
OUTDOOR FLAG	YES (MUST VELCRO THE TABS)	N/A (MUST VELCRO THE TABS)	YES	YES	YES
CANVAS OUTDOOR	NO	NO	YES	STEAM ONLY	YES
CANVAS LIGHTBOX	NO	NO	NO	STEAM ONLY	YES
AGILITY	YES	YES	YES	(ONLY W/ 100% TENSION)	YES
SUPER STRETCH	YES	YES	YES	(ONLY W/ 100% TENSION)	YES
TRIPLE WHITE	YES	YES	NO	YES	NO
ECLIPSE	NO	NO	YES	STEAM ONLY	YES
SOFT KNIT	YES	YES	YES	YES	YES
SHEER	YES	YES	YES	YES	YES
VINYL & ROLLABLE					
	SOLVENT	SOAPY WATER (Dawn)	WINDEX		
FLATMAXX	ONLY ON WHITE	YES	NO		
SCRIM 13OZ/ 18OZ	ONLY ON WHITE	YES	NO		
VINLY 20OZ	ONLY ON WHITE	YES	NO		
MELINEX	NO	YES	NO		
MURAL PANELS	NO	YES	YES		
UV RIDGED	NO	YES	YES		

SETUP NOTES

Redesign of this exhibit without approval by Orbus may result in dangerous and unsafe structures. Nimlok disclaims any responsibility for redesigned exhibits it does not approve in writing.



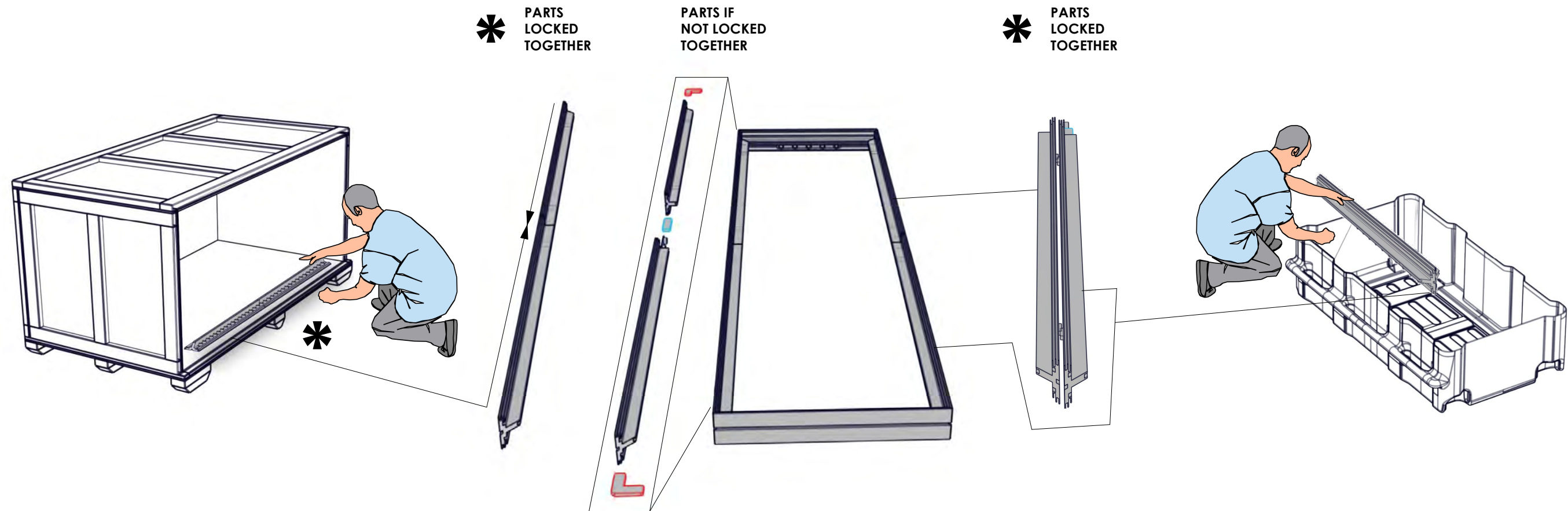

Parts and components such as panels and extrusions are manufactured to metric sizing. Where ever possible sizes have been noted in feet and inches as well as in metric. Below is the imperial to metric sizing table for reference. "Nominal" refers to approximate size.

NOTE: PARTS MAY COME PRE-ASSEMBLED FOR PACKING PURPOSES.



METRIC TO IMPERIAL DIMENSION

2400mm = (94.50")	1200mm = (47.25")
2100mm = (82.67")	900mm = (35.43")
1800mm = (70.87")	600mm = (23.62")
1500mm = (59.05")	300mm = (11.81")

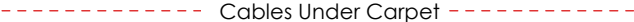
-  Internet Connection
-  Phone Line
-  Main Electric Drop (Point Of Distribution)
-  Electrical Outlet
-  Sharp Edges
-  Cables Under Carpet

HELPFUL SETUP QR CODES



**SCAN QR CODES
WITH YOUR PHONE
CAMERA**

6096mm
[240.000"]

6093mm
[239.882"]

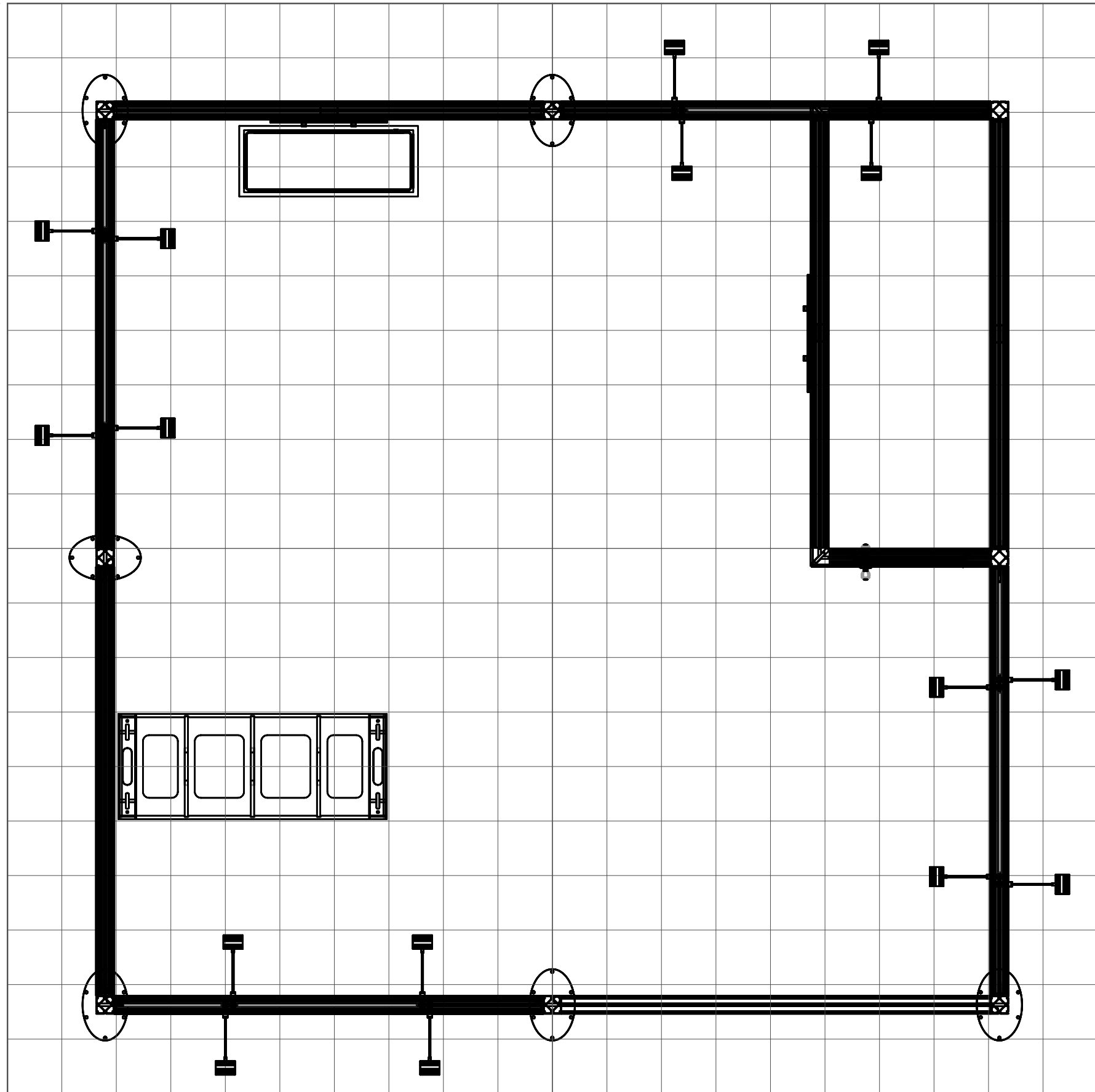

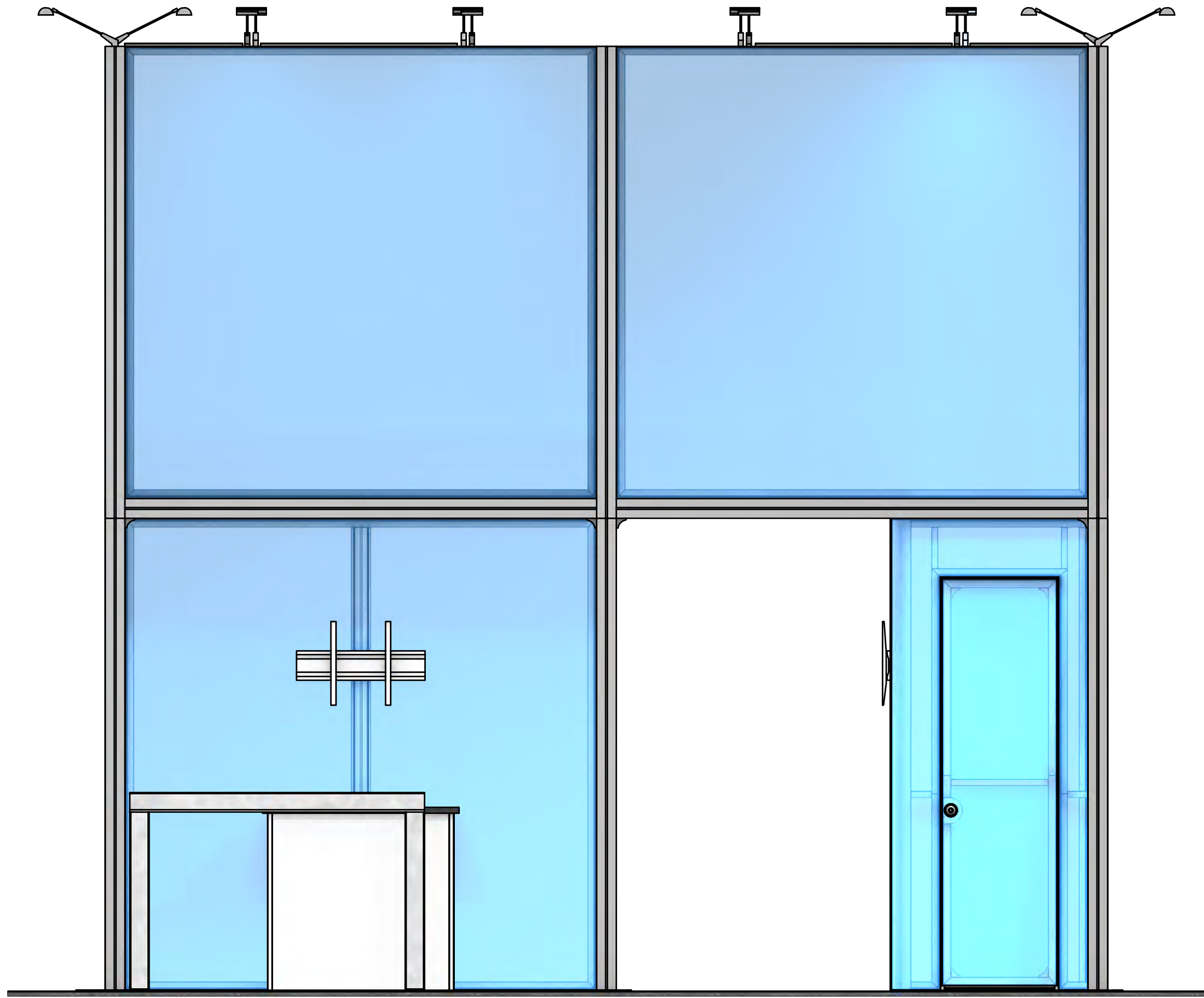

FP

SETUP#	#	DESCRIPTION
A4	1	2400MM LENGTH OF PM4S2-WITH STOPS AT 315MM BOTH SIDES
A12	2	2400MM LENGTH OF PHFC4 EXTRUSION-WITH MITRE CUT BOTH ENDS
A5	1	2310MM LENGTH OF PM4R8-WITH CAM LOCKS BOTH ENDS
A13	2	2400MM LENGTH OF PHFC4 EXTRUSION-WITH MITRE CUT BOTH ENDS-WITH SIDE LOCKS
CB9	4	90 DEGREE JOINER

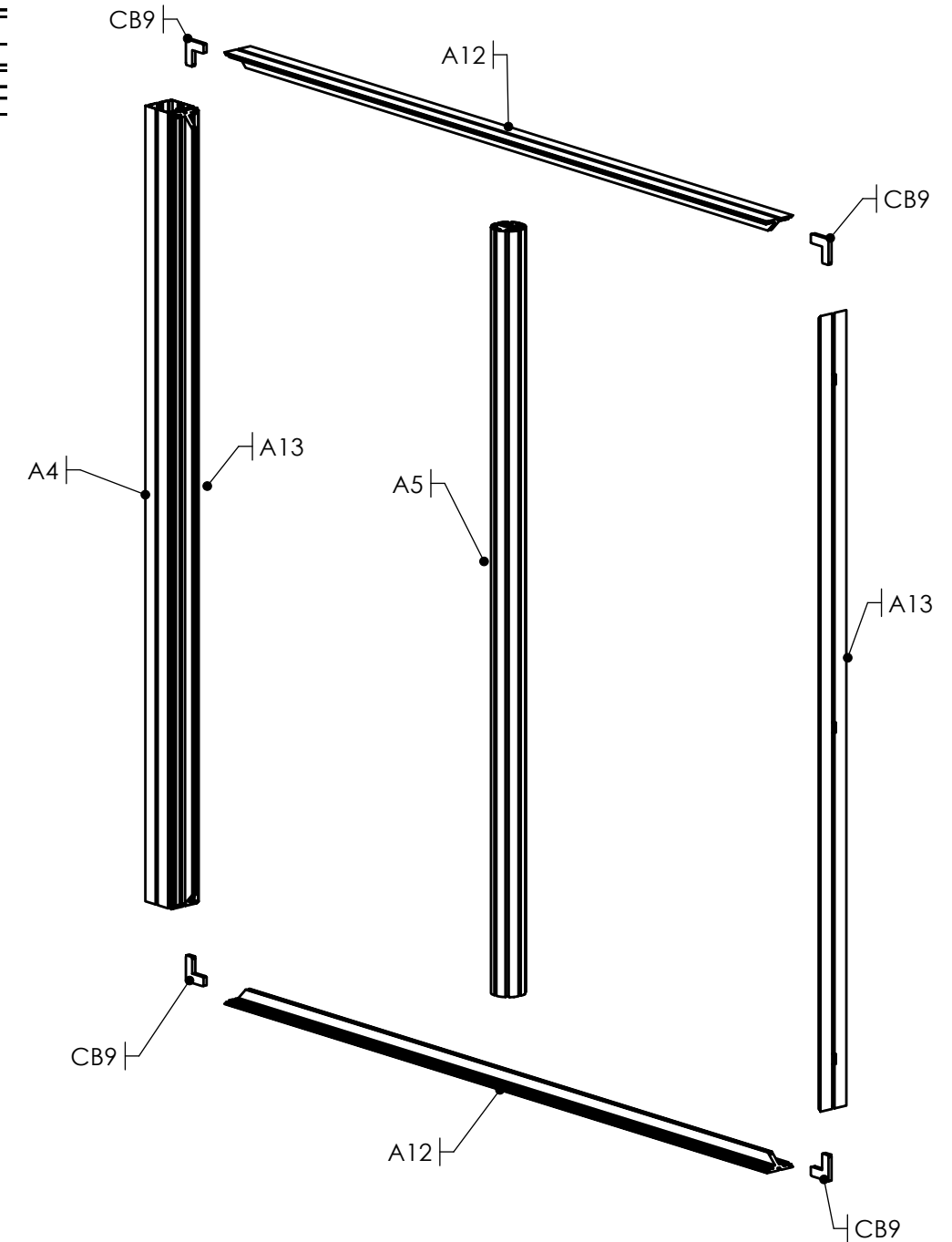
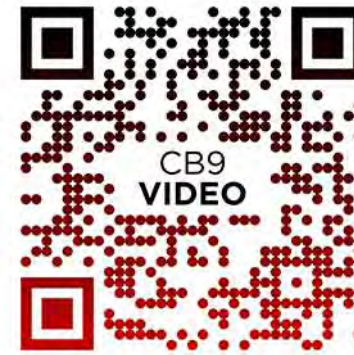
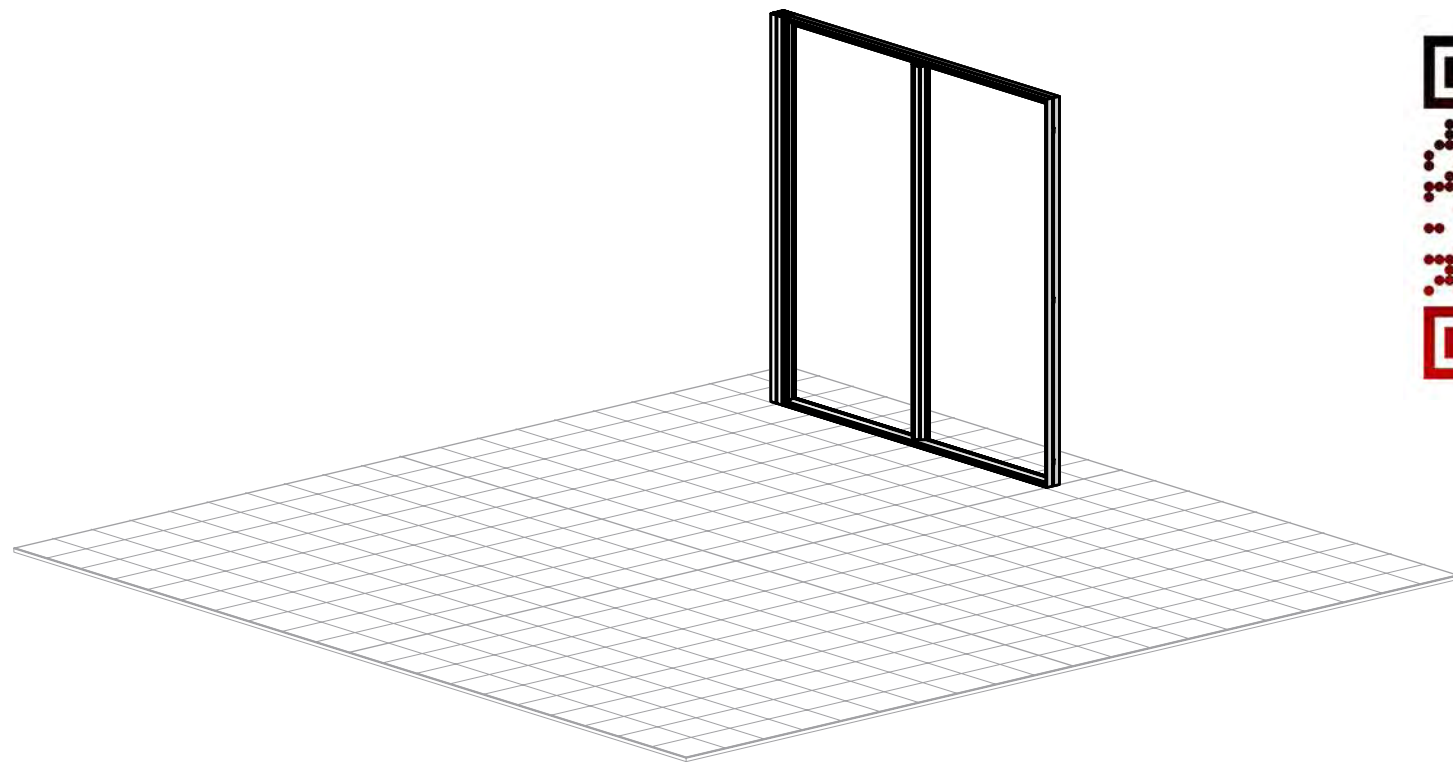
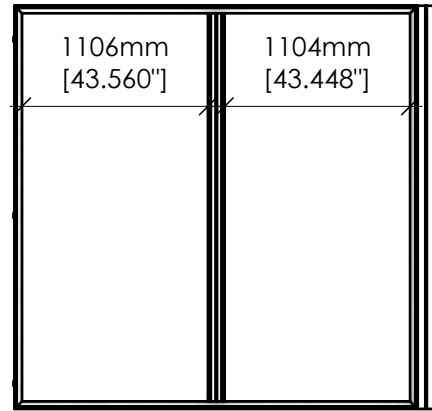
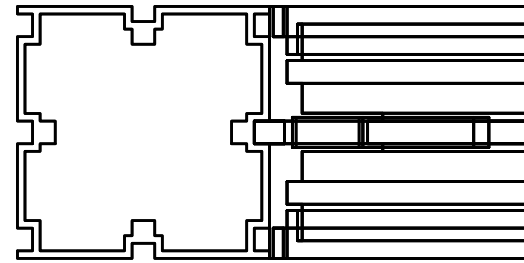

COMPONENTS
IN THIS STEP:
(Not to scale)



SETUP#	#	DESCRIPTION
A9	2	900MM LENGTH OF PHFC4 EXTRUSION-WITH CAM LOCK 1 END-MITRE CUT 1 END
A13	1	2400MM LENGTH OF PHFC4 EXTRUSION-WITH MITRE CUT BOTH ENDS-WITH SIDE LOCKS
PMFC4-90	4	PLASTIC MOLDED END CAP FOR THE PMFC4-90-B EXTRUSION
A14	2	2386MM OF PMFC4-90-B EXTRUSION -WITH STOPS AT 315MM
A11	2	2389MM LENGTH OF PHFC4 EXTRUSION-WITH CAM LOCKS BOTH ENDS
A5	1	2310MM LENGTH OF PM4R8-WITH CAM LOCKS BOTH ENDS
CB9	2	90 DEGREE JOINER

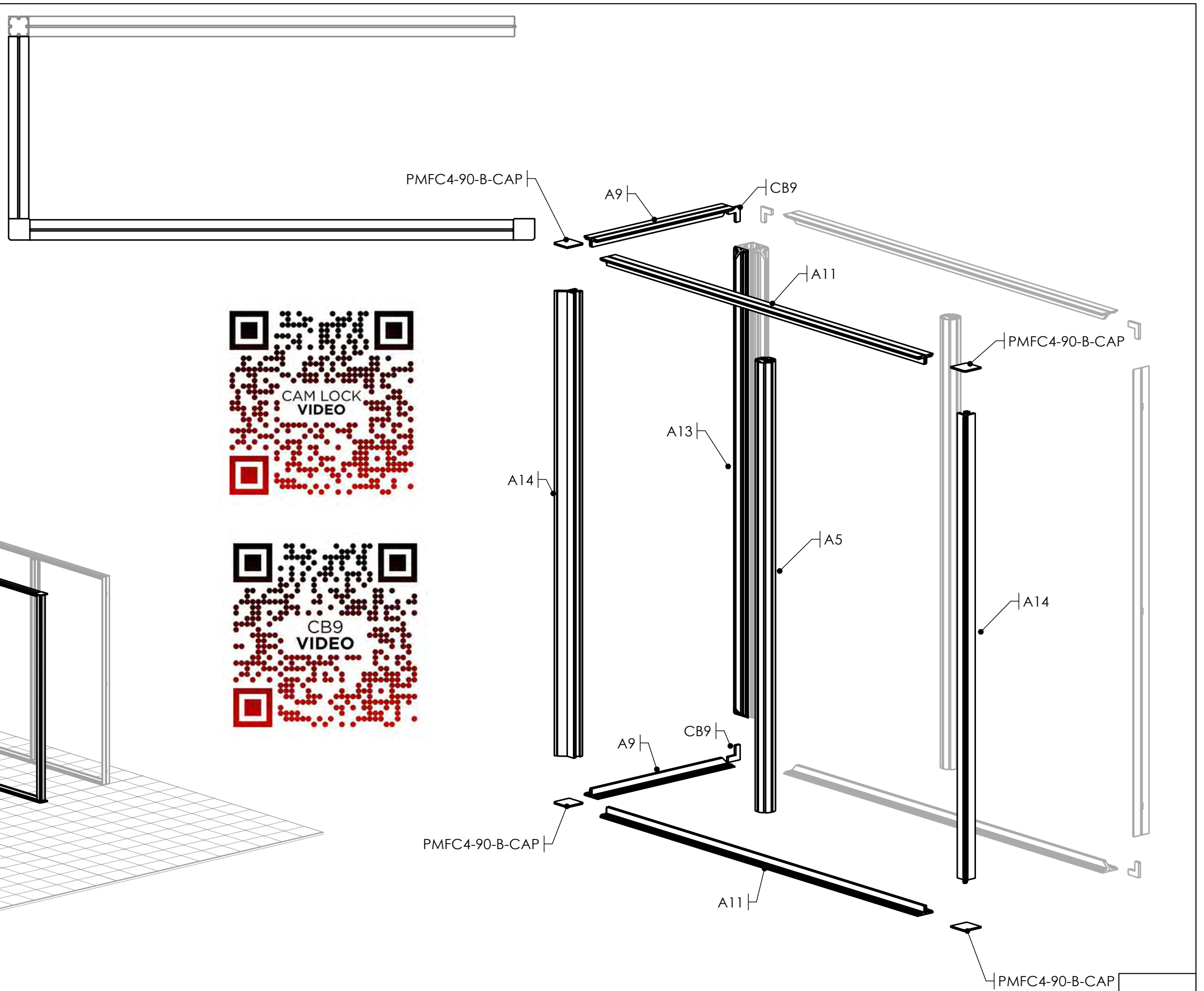
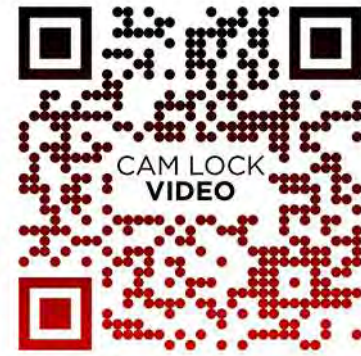
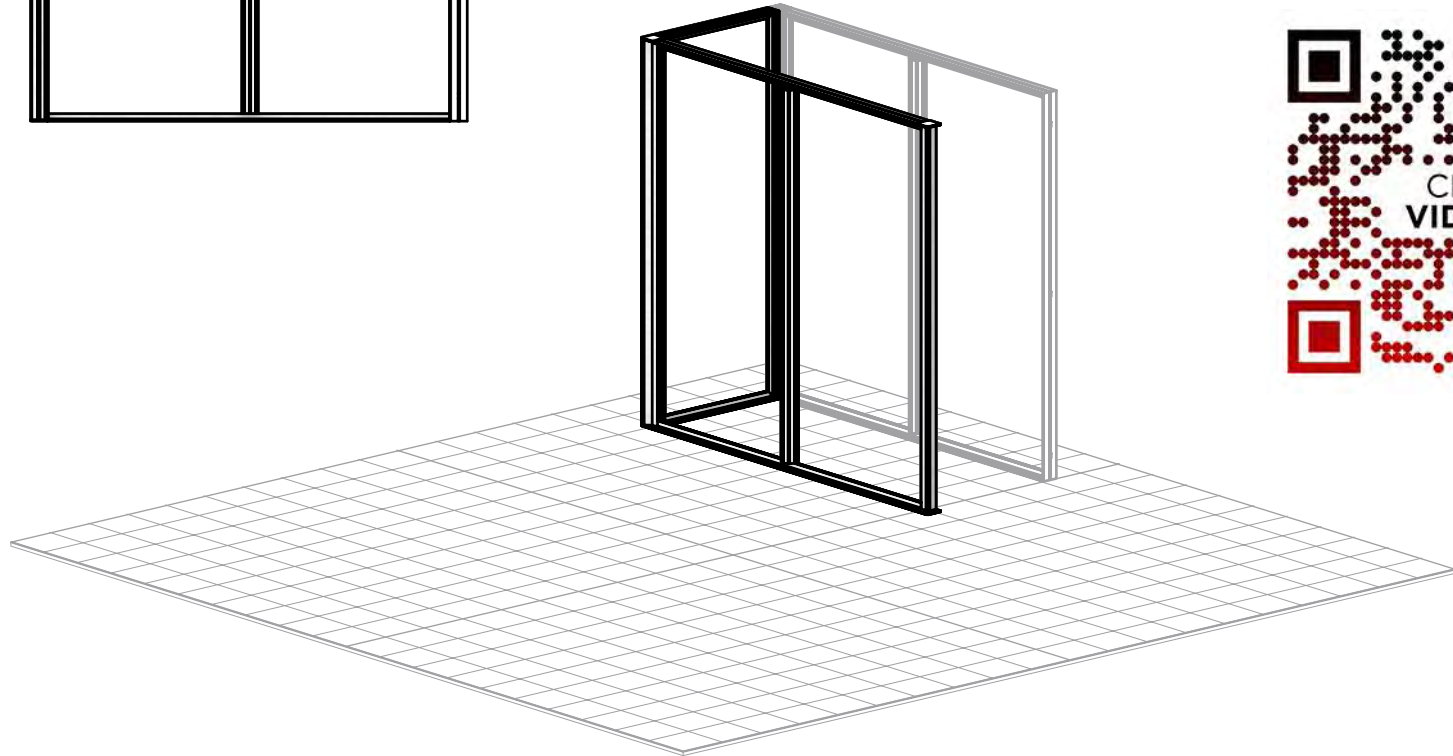
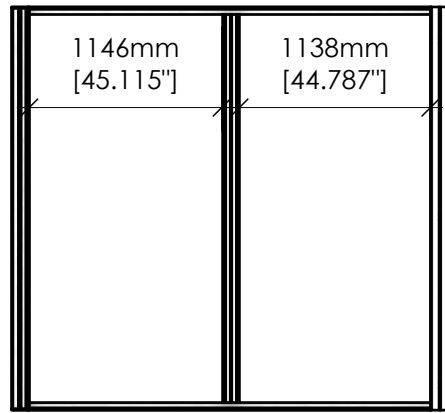

COMPONENTS
IN THIS STEP:
(Not to scale)



SETUP#	#	DESCRIPTION
A4	1	2400MM LENGTH OF PM4S2-WITH STOPS AT 315MM BOTH SIDES
CB9	1	90 DEGREE JOINER
	1	VF DOOR HINGE
VF-FCD-90	1	VECTOR FRAME FABRIC CHANNEL DOOR 900MM X 2400MM X 100MM FRAME LEFT SPLIT DOOR
A7	1	2386MM CUT DOWN FROM 2400MM LENGTH OF FC EXTRUSION
A8	1	900MM LENGTH OF PHFC4 EXTRUSION-WITH CAM LOCKS BOTH ENDS
A2	2	210MM CUT DOWN FROM 300MM LENGTH OF PH1 EXTRUSION-WITH CAM LOCKS BOTH ENDS
A1	2	105MM CUT DOWN FROM 300MM LENGTH OF PH1 EXTRUSION-WITH CAM LOCKS BOTH ENDS

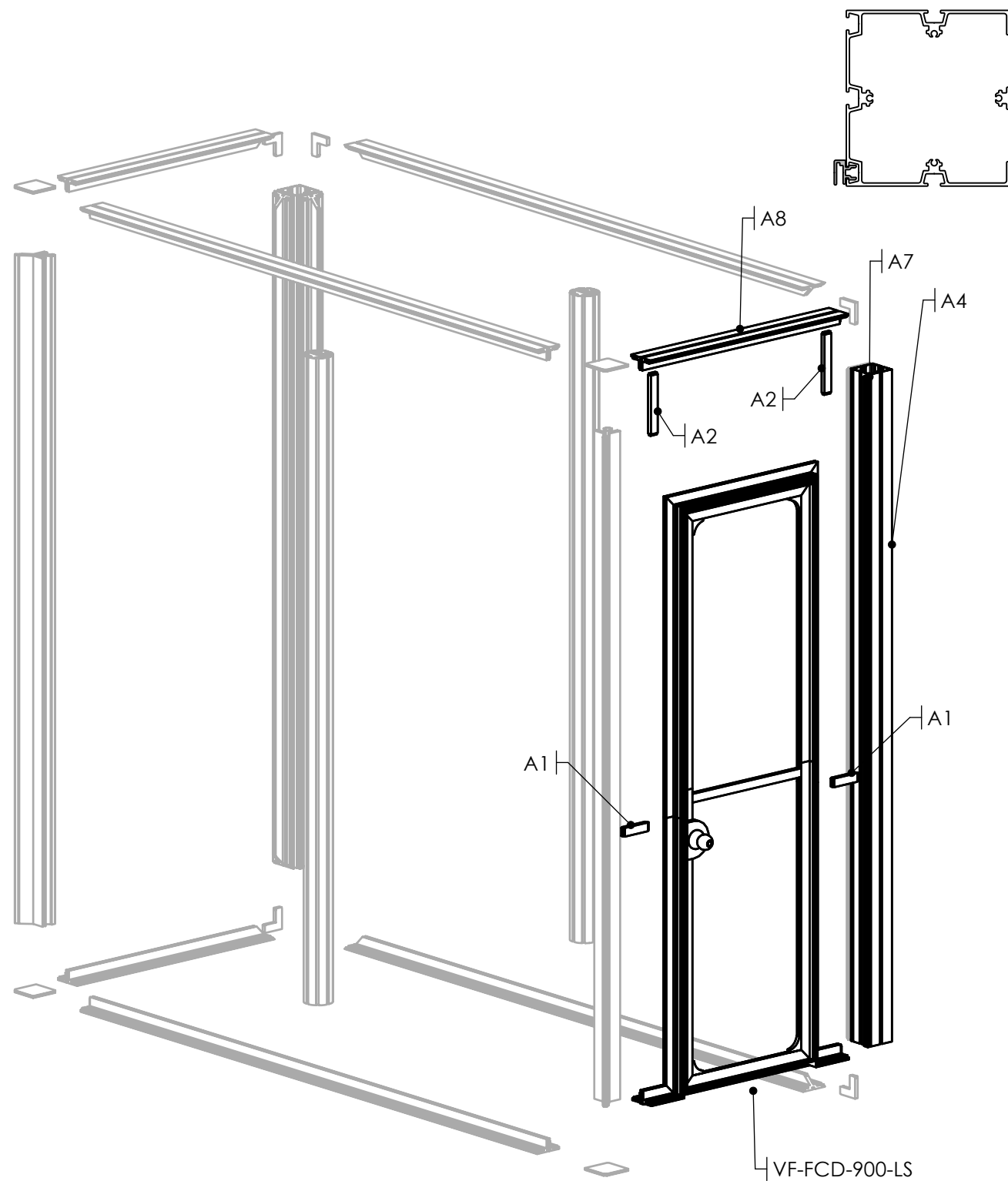
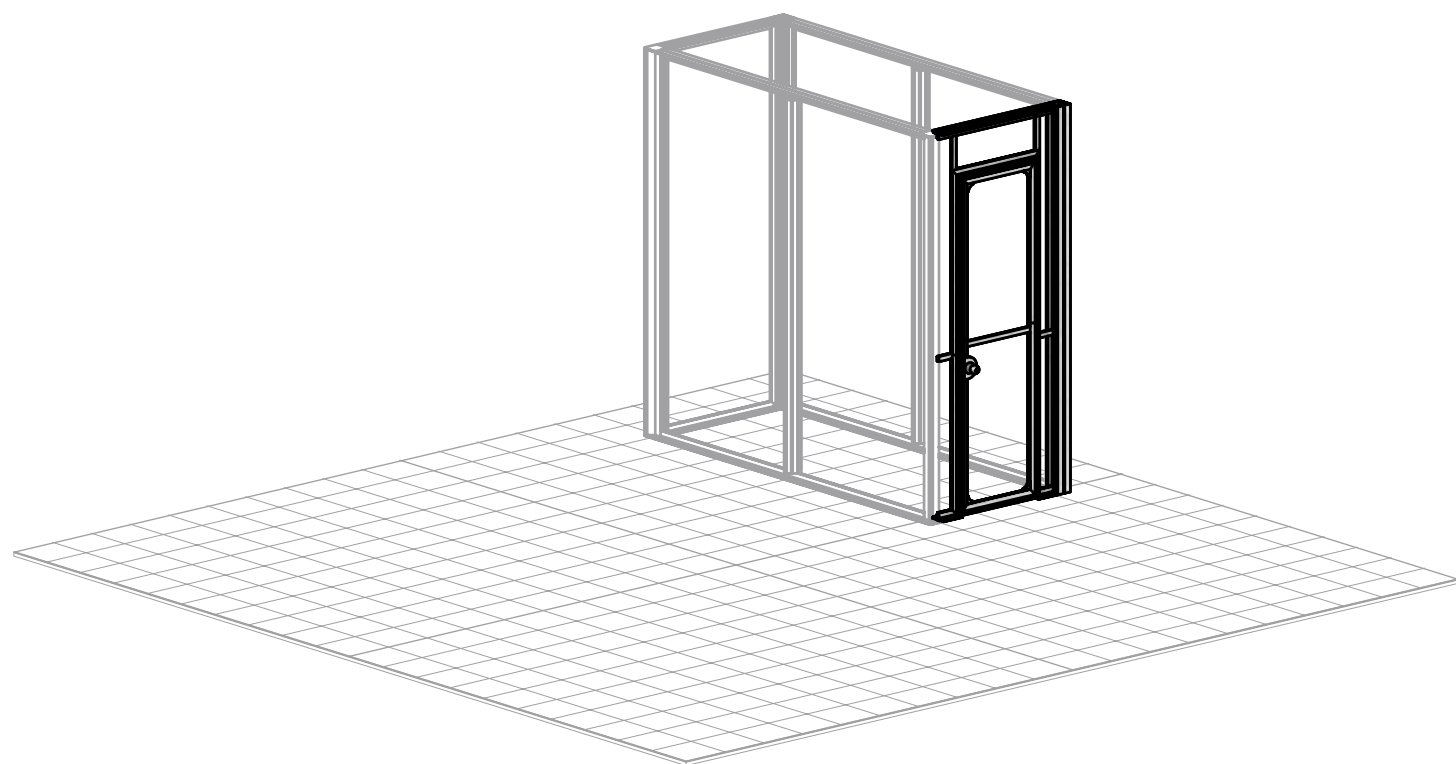

COMPONENTS
IN THIS STEP:
(Not to scale)



101 (PH1)



340 (PHFC4)



302 (FC)



241 (PM4S2)

SETUP#	#	DESCRIPTION
A12	2	2400MM LENGTH OF PHFC4 EXTRUSION-WITH MITRE CUT BOTH ENDS
A5	1	2310MM LENGTH OF PM4R8-WITH CAM LOCKS BOTH ENDS
A13	2	2400MM LENGTH OF PHFC4 EXTRUSION-WITH MITRE CUT BOTH ENDS-WITH SIDE LOCKS
CB9	4	90 DEGREE JOINER

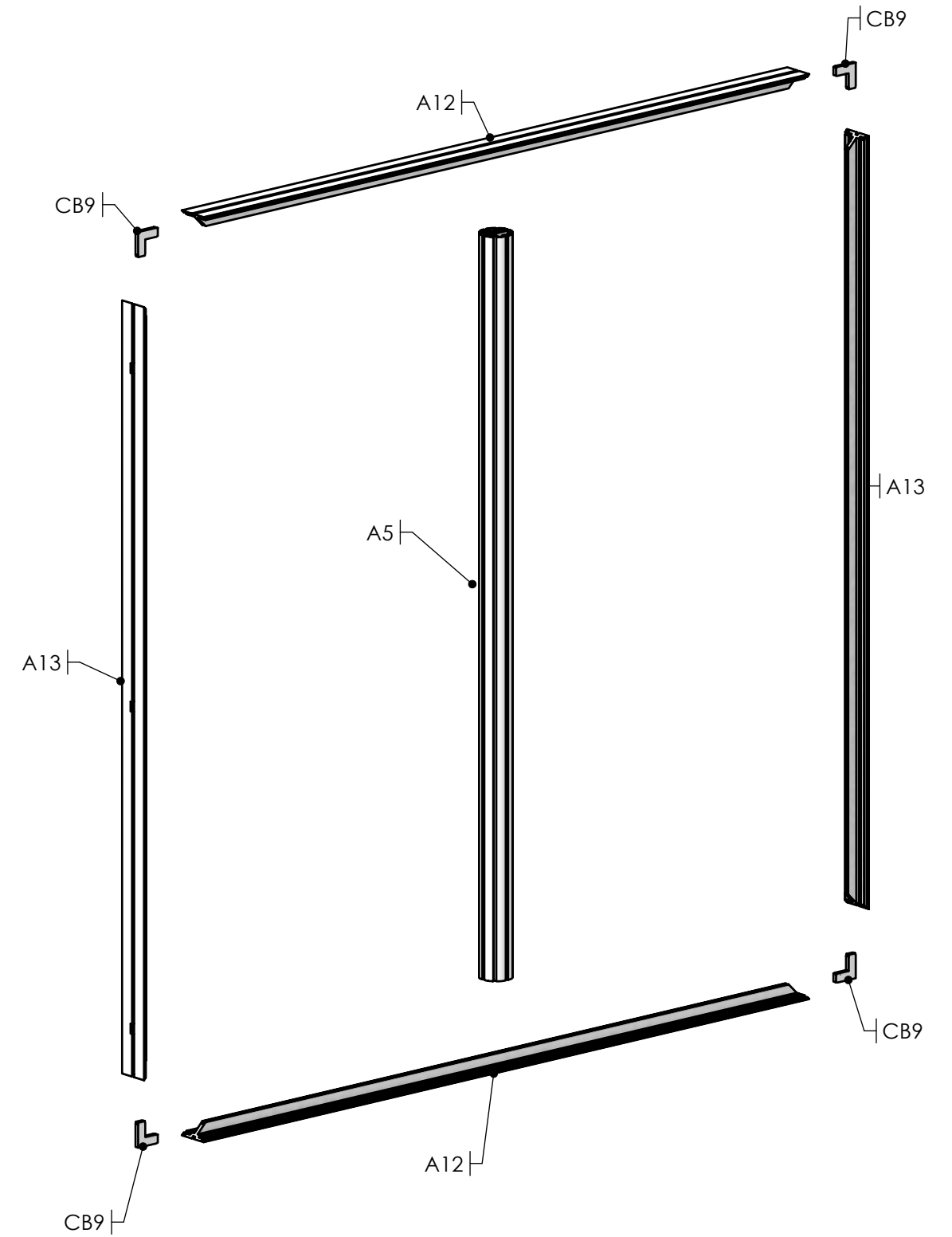
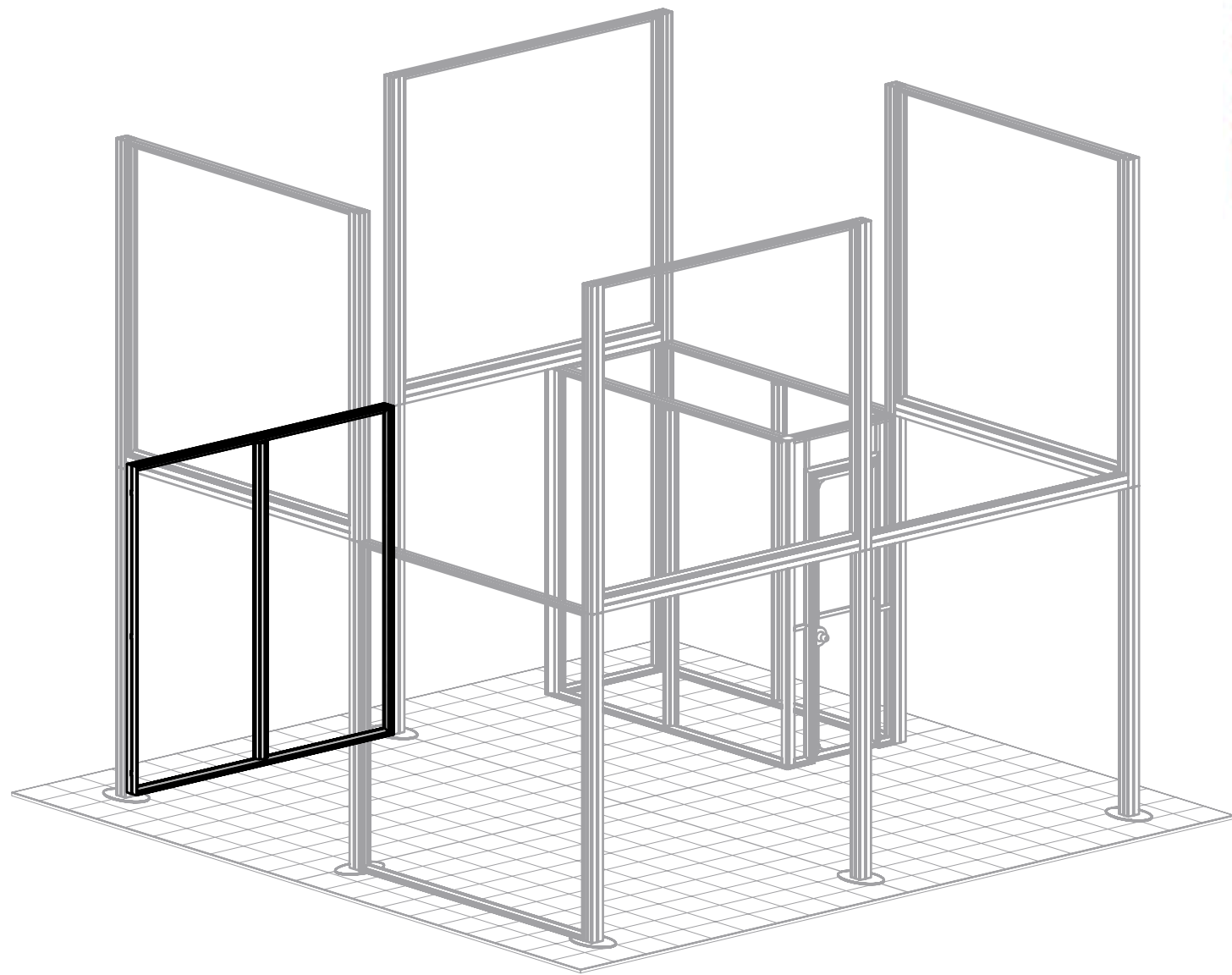
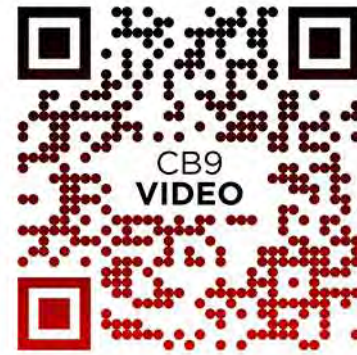
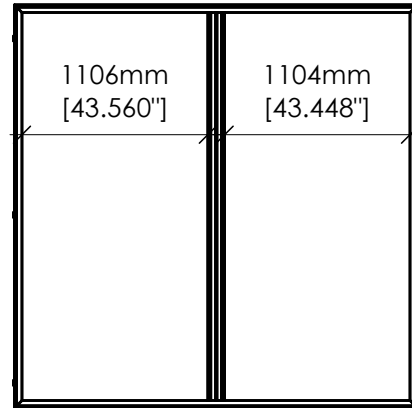

COMPONENTS
IN THIS STEP:
(Not to scale)



242 (PM4R8)



340 (PHFC4)

SETUP#	#	DESCRIPTION
A12	10	2400MM LENGTH OF PHFC4 EXTRUSION-WITH MITRE CUT BOTH ENDS
A10	8	2300MM LENGTH OF PHFC4 EXTRUSION-WITH MITRE CUT BOTH ENDS-WITH SIDE LOCKS
CB9	20	90 DEGREE JOINER
A13	2	2400MM LENGTH OF PHFC4 EXTRUSION-WITH MITRE CUT BOTH ENDS-WITH SIDE LOCKS

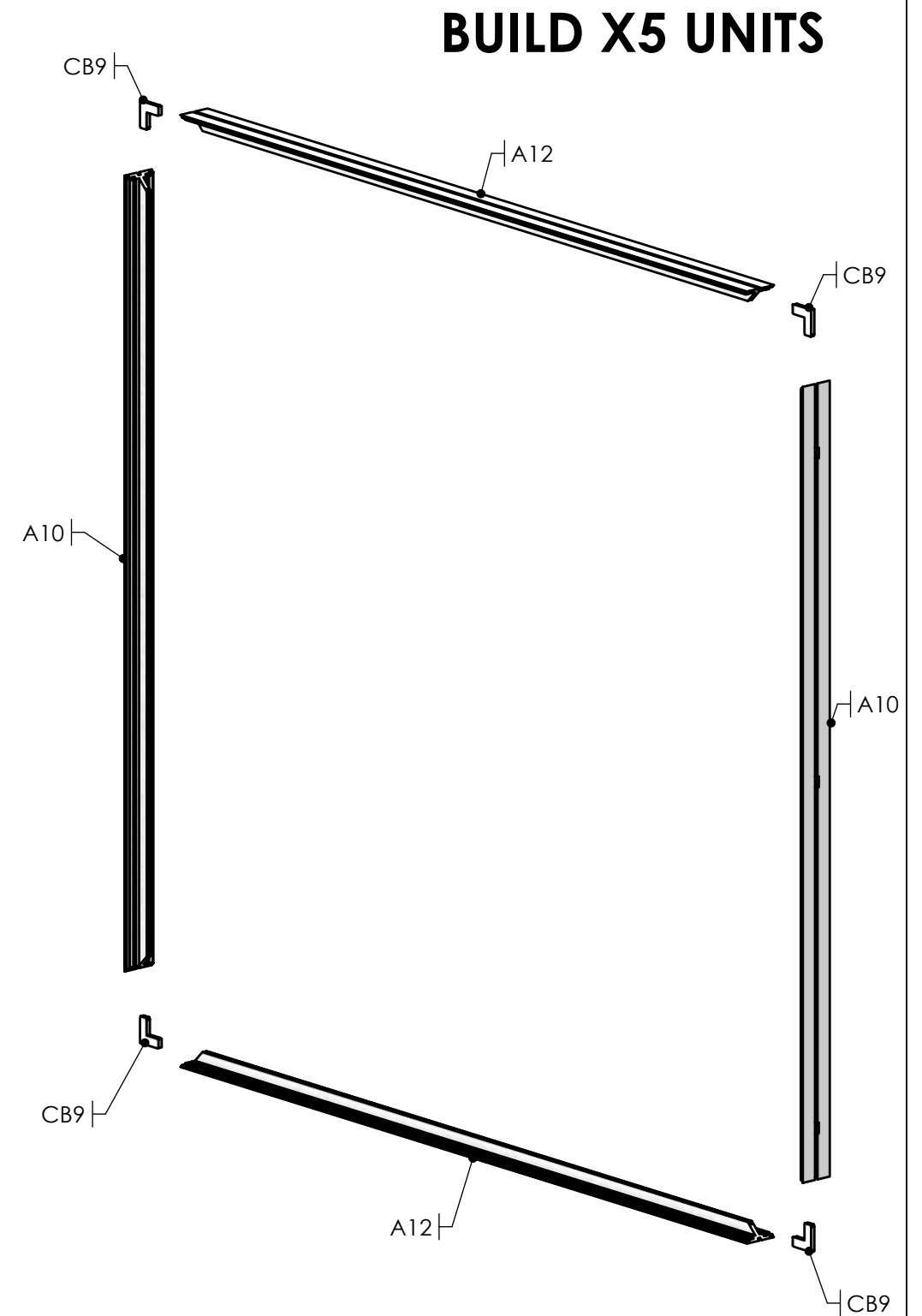
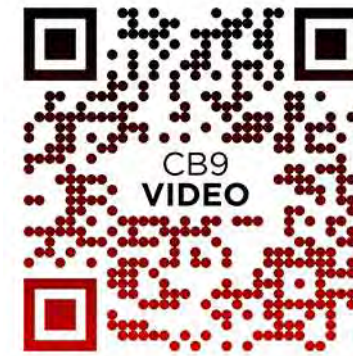
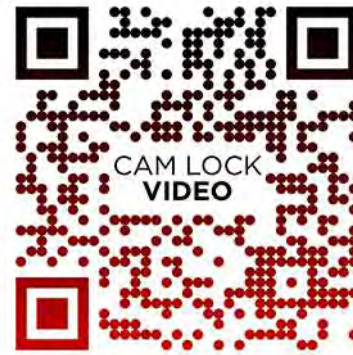
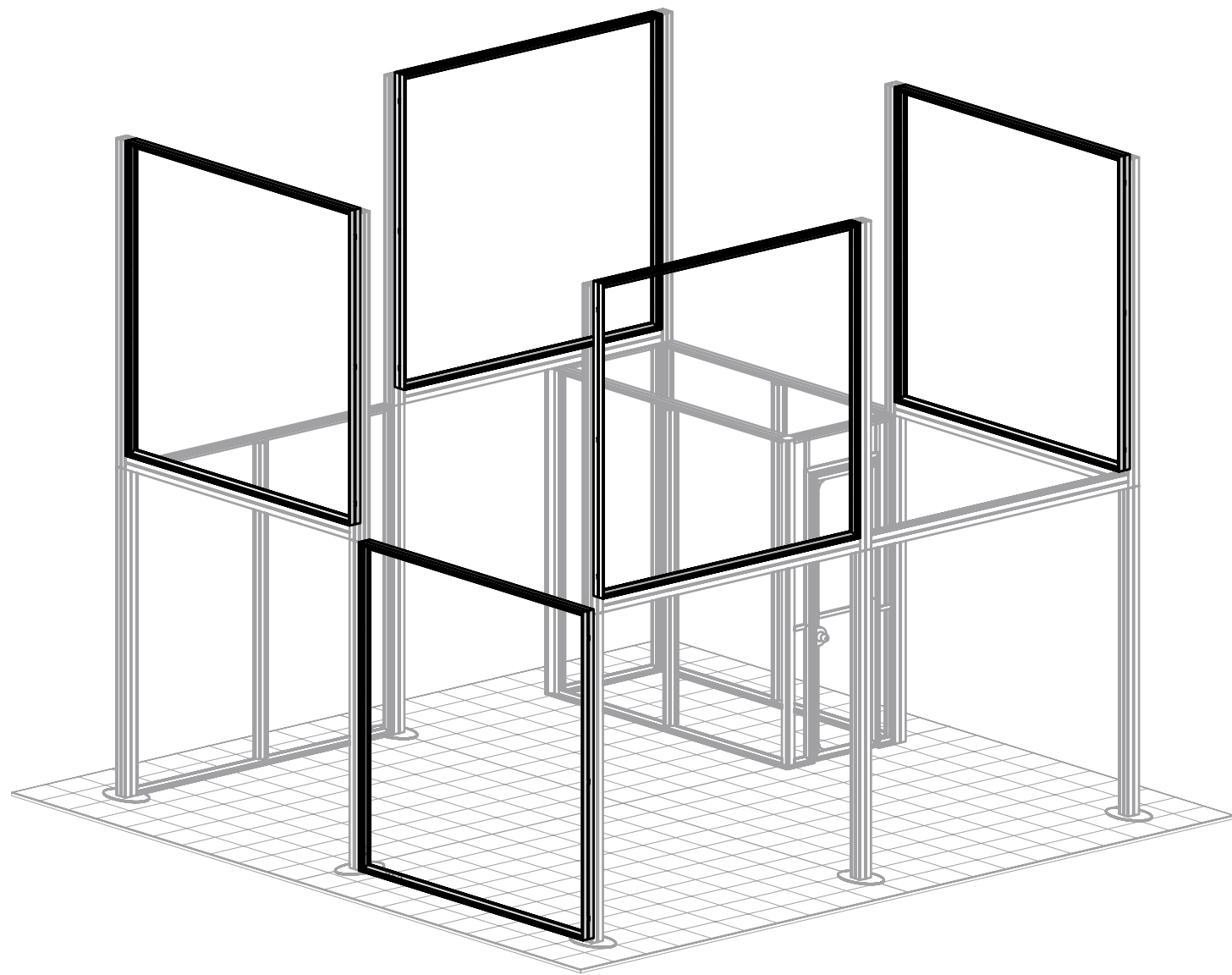

COMPONENTS
IN THIS STEP:
(Not to scale)



102 (PH2)

SETUP#	#	DESCRIPTION
A3	5	2400MM LENGTH OF PM4S2-WITH CAM LOCKS BOTH ENDS
A4	14	2400MM LENGTH OF PM4S2-WITH STOPS AT 315MM BOTH SIDES
A6	8	600MM 4-WAY INTERNAL CONNECTION EXTRUSION W/ 8 TENSION GLIDE
PM4BP1	6	15 3/4" X 9 7/8" ALUMINUM BASE PLATE

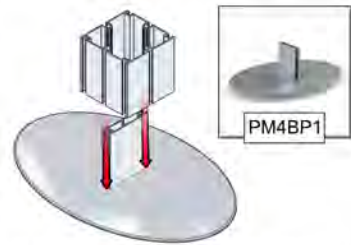

Slide the EXTRUSION onto the upright PH2. The EXTRUSION will rest on the base plate. Once the EXTRUSION is attached to the base plate, you can move both into the proper position within the booth.

LOCK FRAMES IN PLACE

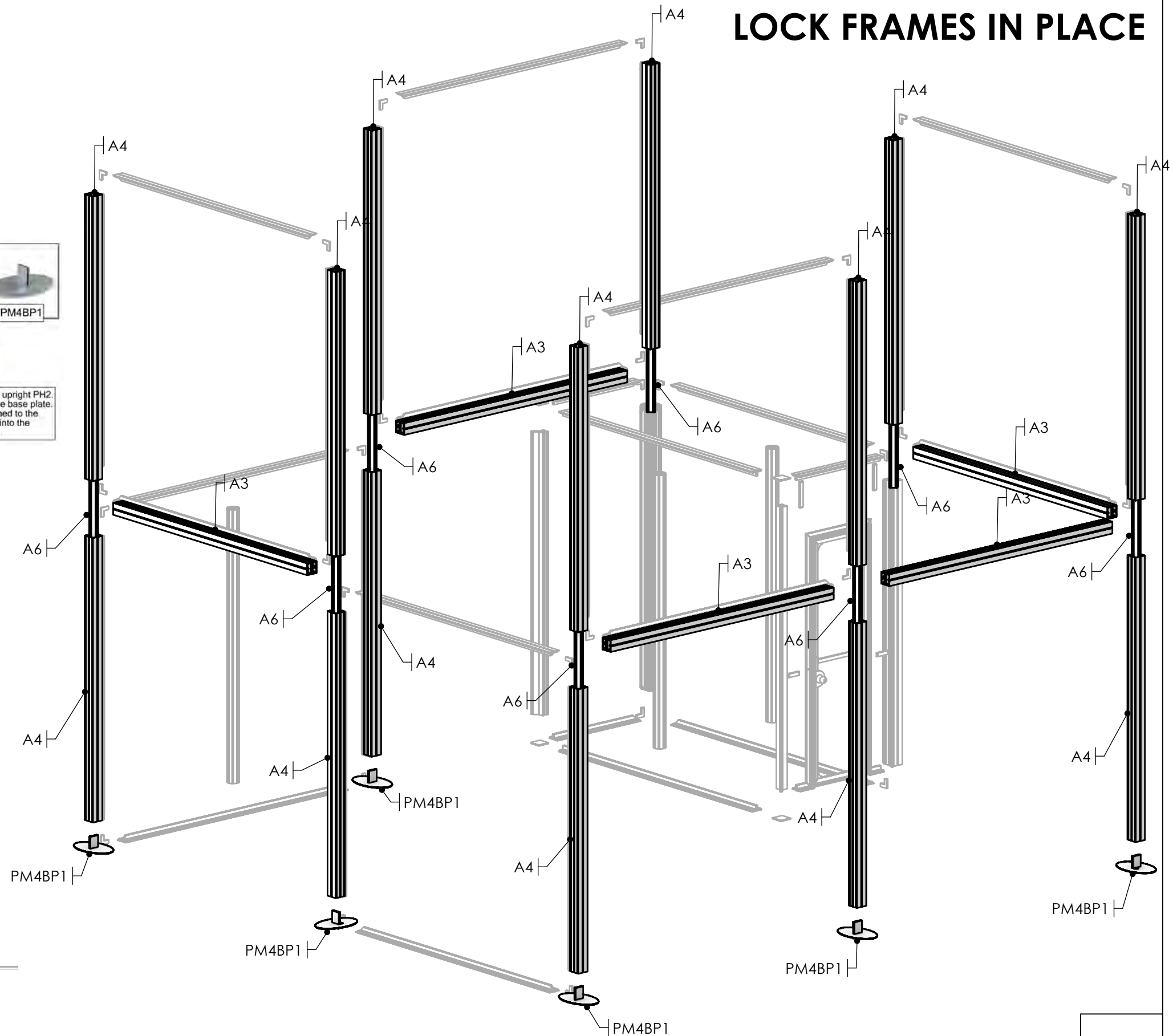
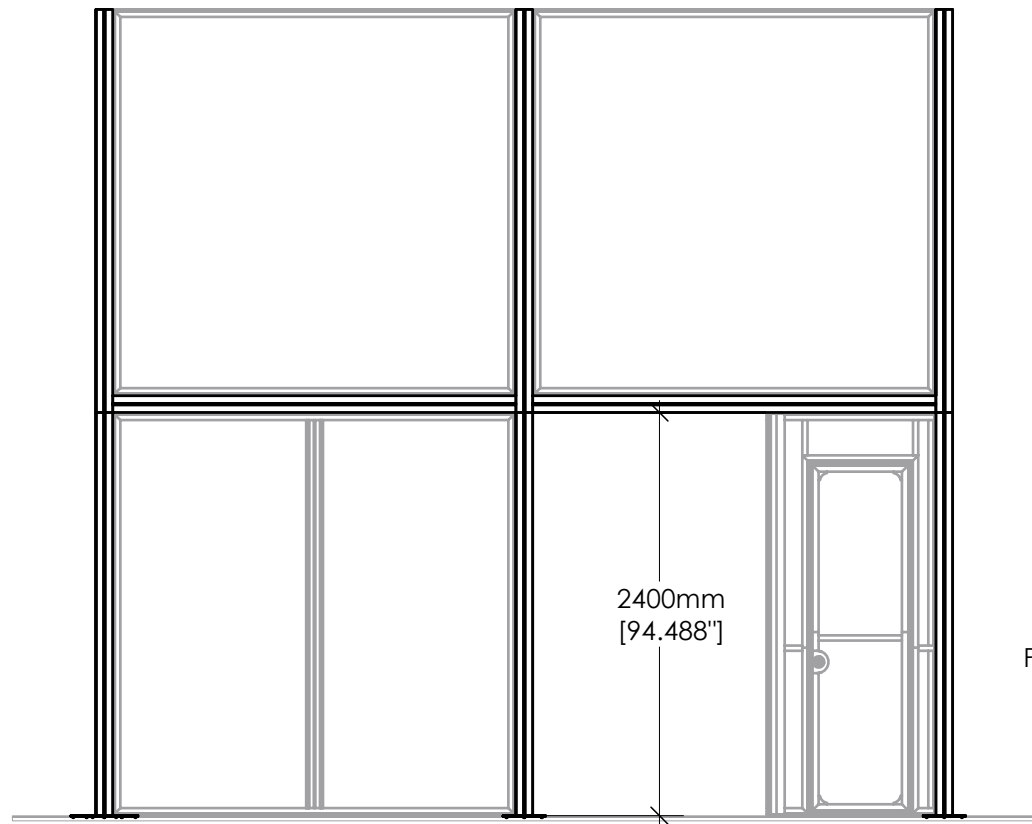

COMPONENTS IN THIS STEP:
(Not to scale)

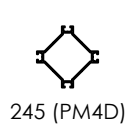
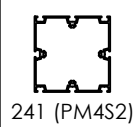

SETUP#	#	DESCRIPTION
C3	1	GRAPHIC (C3) (105.97 w X 98.37 h total size) 101.97 w X 94.37 h finish size, Dye-sub print on Eclipse Blockout Stretch, single sided, sewn with FCE-2 silicone beading around perimeter & pull tab in bottom right corner
C2	1	GRAPHIC (C2) (43.37 w X 98.37 h total size) 39.37 w X 94.37 h finish size, Dye-sub print on Eclipse Blockout Stretch, single sided, sewn with FCE-2 silicone beading around perimeter & pull tab in bottom right corner
C4	1	GRAPHIC (C4) (43.37 w X 98.37 h total size) 39.37 w X 94.37 h finish size, Dye-sub print on Eclipse Blockout Stretch, single sided, sewn with FCE-2 silicone beading around perimeter & pull tab in bottom right corner
C5	1	GRAPHIC (C5) (26.95 w X 85.38 h total size) 22.95 w X 81.38 h finish size, Dye-sub print on Eclipse Blockout Stretch, single sided, sewn with FCE-2 silicone beading around perimeter & pull tab in bottom right corner
C5	1	LINER (C5) (26.95 w X 85.38 h total size) 22.95 w X 81.38 h finish size, Opaque Liner, sewn with FCE-2 silicone beading around perimeter & pull tab in bottom right corner
C1	1	GRAPHIC (C1) (98.37 w X 98.37 h total size) 94.37 w X 94.37 h finish size, Dye-sub print on Eclipse Blockout Stretch, single sided, sewn with FCE-2 silicone beading around perimeter & pull tab in bottom right corner
CBE-50	9	CORNER PRESSURE FIT CONNECTOR

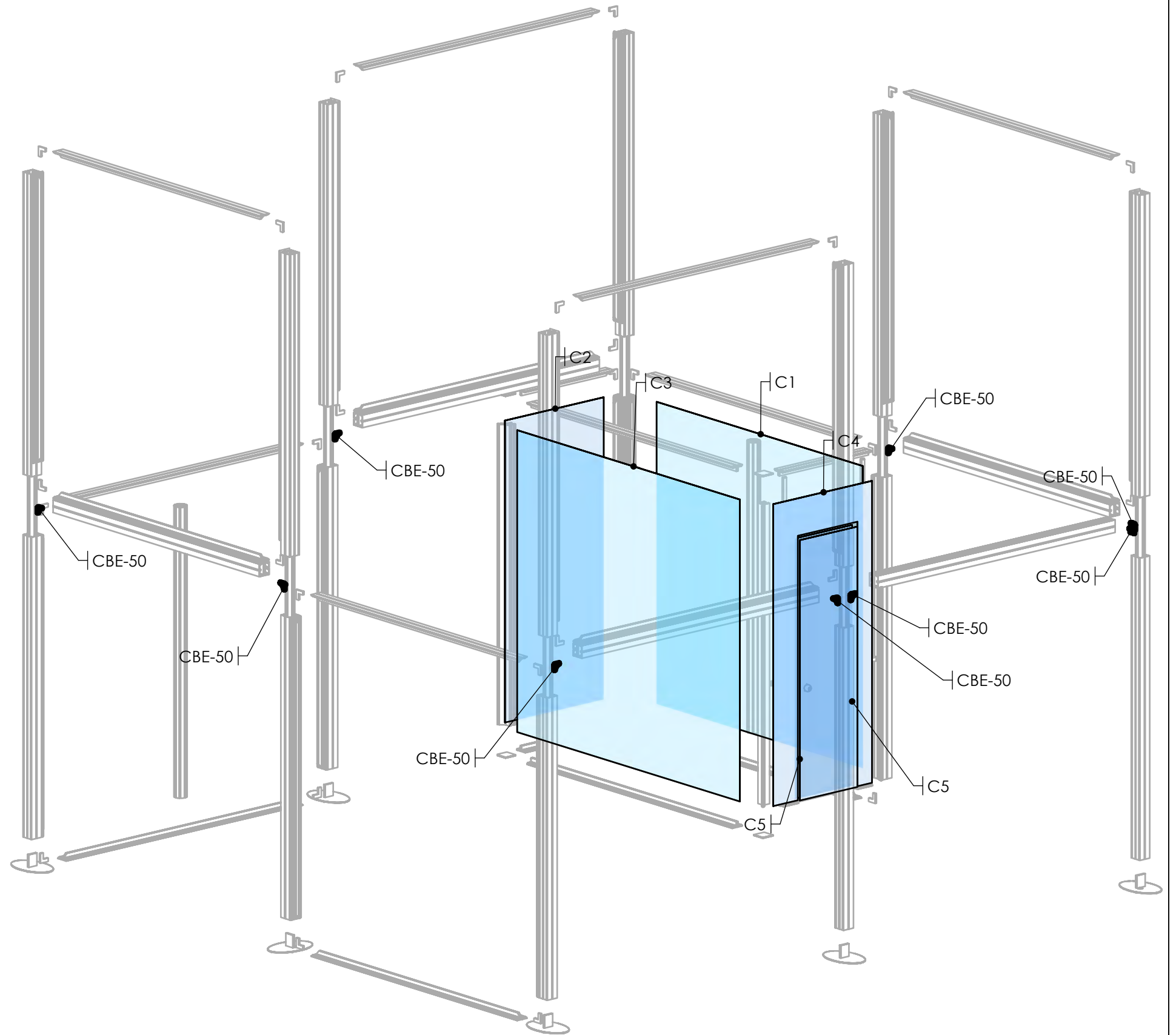

SETUP#	#	DESCRIPTION
A2	1	GRAPHIC (A2) (98.37 w X 94.43 h total size) 94.37 w X 90.43 h finish size, Dye-sub print on Eclipse Blockout Stretch, single sided, sewn with FCE-2 silicone beading around perimeter & pull tab in bottom right corner
B2	1	GRAPHIC (B2) (98.37 w X 94.43 h total size) 94.37 w X 90.43 h finish size, Dye-sub print on Eclipse Blockout Stretch, single sided, sewn with FCE-2 silicone beading around perimeter & pull tab in bottom right corner
D2	1	GRAPHIC (D2) (98.37 w X 94.43 h total size) 94.37 w X 90.43 h finish size, Dye-sub print on Eclipse Blockout Stretch, single sided, sewn with FCE-2 silicone beading around perimeter & pull tab in bottom right corner
E2	1	GRAPHIC (E2) (98.37 w X 94.43 h total size) 94.37 w X 90.43 h finish size, Dye-sub print on Eclipse Blockout Stretch, single sided, sewn with FCE-2 silicone beading around perimeter & pull tab in bottom right corner
D4	1	GRAPHIC (D4) (98.37 w X 98.37 h total size) 94.37 w X 94.37 h finish size, Dye-sub print on Eclipse Blockout Stretch, single sided, sewn with FCE-2 silicone beading around perimeter & pull tab in bottom right corner
E4	1	GRAPHIC (E4) (98.37 w X 98.37 h total size) 94.37 w X 94.37 h finish size, Dye-sub print on 2oz. Sheer, single sided, sewn with silicone beading around perimeter & pull tab in bottom right corner

INSIDE GRAPHICS

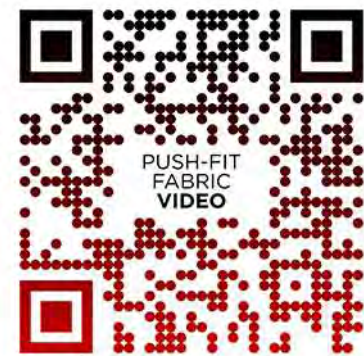
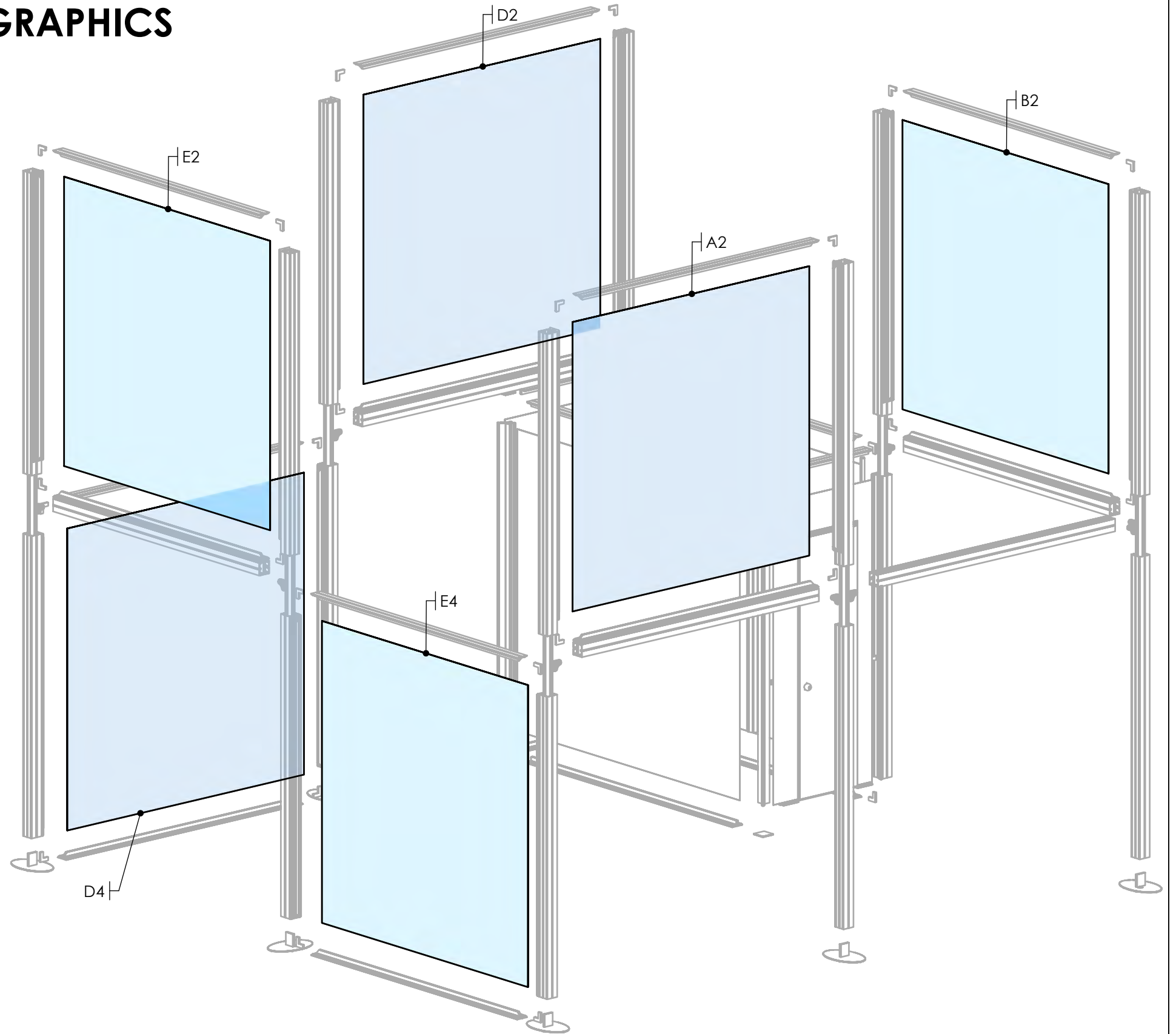

SETUP#	#	DESCRIPTION
A1	1	GRAPHIC (A1) (98.37 w X 94.43 h total size) 94.37 w X 90.43 h finish size, Dye-sub print on Eclipse Blockout Stretch, single sided, sewn with FCE-2 silicone beading around perimeter & pull tab in bottom right corner
B1	1	GRAPHIC (B1) (98.37 w X 94.43 h total size) 94.37 w X 90.43 h finish size, Dye-sub print on Eclipse Blockout Stretch, single sided, sewn with FCE-2 silicone beading around perimeter & pull tab in bottom right corner
D1	1	GRAPHIC (D1) (98.37 w X 94.43 h total size) 94.37 w X 90.43 h finish size, Dye-sub print on Eclipse Blockout Stretch, single sided, sewn with FCE-2 silicone beading around perimeter & pull tab in bottom right corner
E1	1	GRAPHIC (E1) (98.37 w X 94.43 h total size) 94.37 w X 90.43 h finish size, Dye-sub print on Eclipse Blockout Stretch, single sided, sewn with FCE-2 silicone beading around perimeter & pull tab in bottom right corner
E3	1	GRAPHIC (E3) (98.37 w X 98.37 h total size) 94.37 w X 94.37 h finish size, Dye-sub print on 2oz. Sheer, single sided, sewn with silicone beading around perimeter & pull tab in bottom right corner
D3	1	GRAPHIC (D3) (98.37 w X 98.37 h total size) 94.37 w X 94.37 h finish size, Dye-sub print on Eclipse Blockout Stretch, single sided, sewn with FCE-2 silicone beading around perimeter & pull tab in bottom right corner

OUTSIDE GRAPHICS

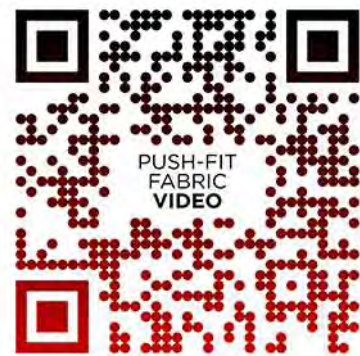
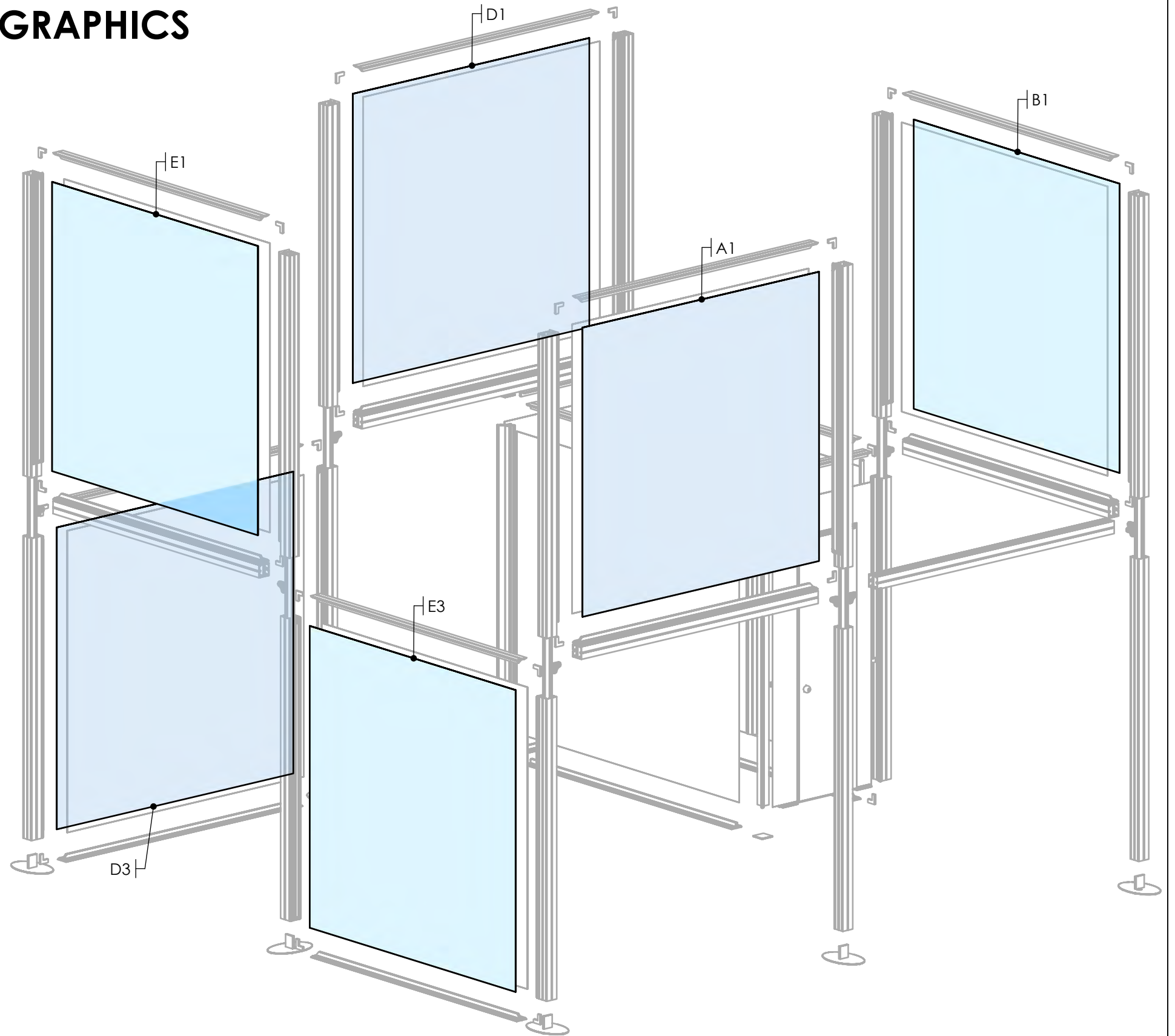

SETUP#	#	DESCRIPTION
EXT-LG-MB	2	Large LCD Monitor mount, 37" - 70" size, 110 Lb. max. weight, Tilting-with extrusion mounted hardware

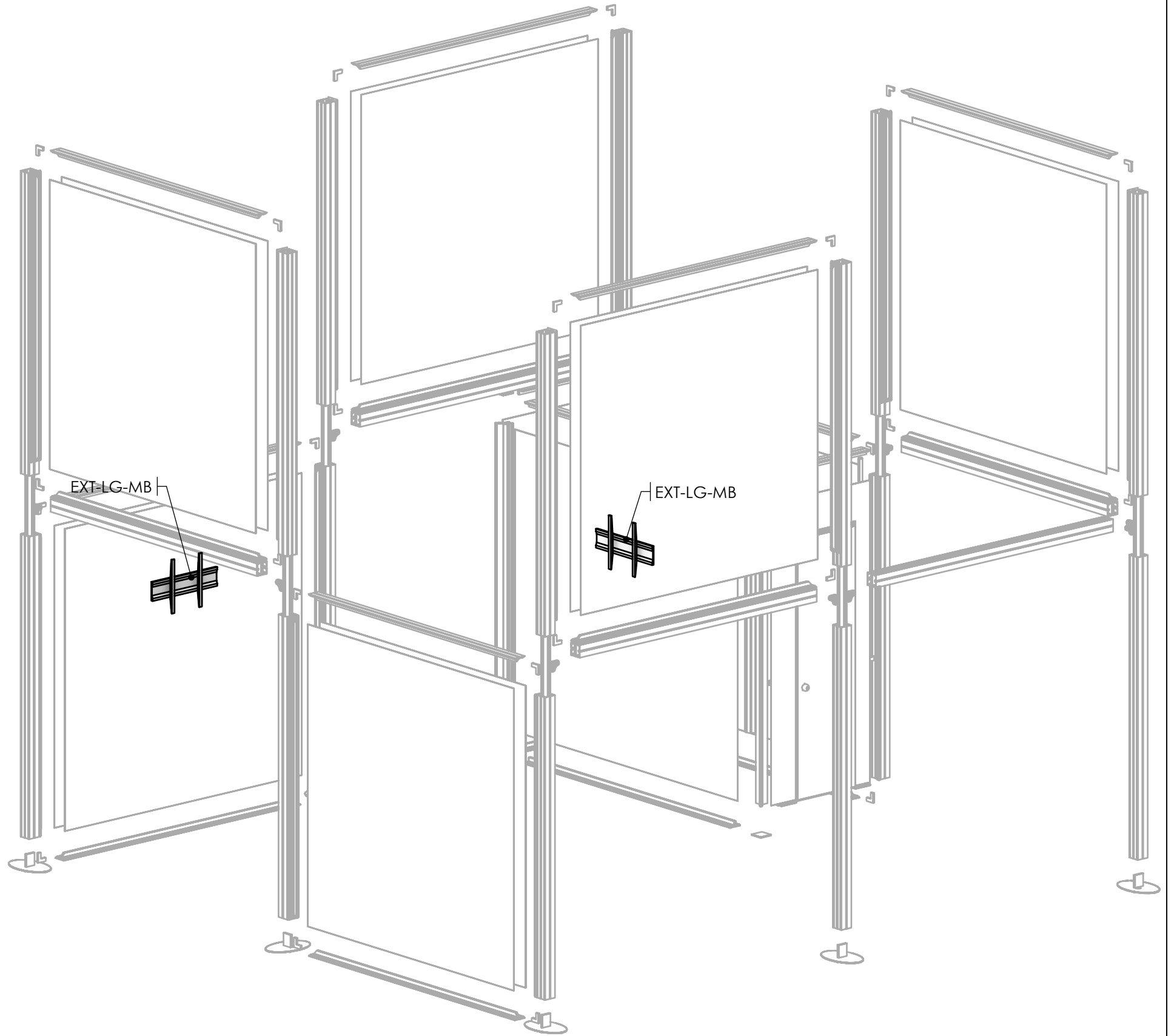
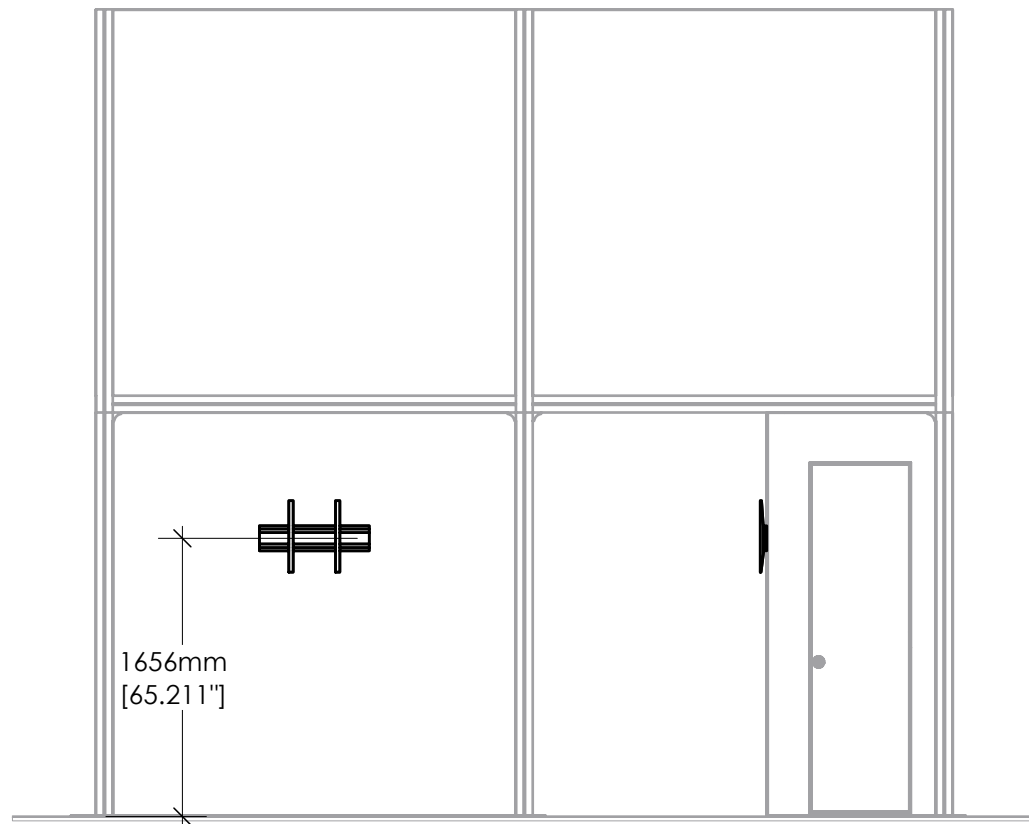

COMPONENTS
IN THIS STEP:
(Not to scale)

SETUP#	#	DESCRIPTION
LUM-LED2	16	25 WATT SILVER LED STEM LIGHT (REPLACES 200 W HALOGEN)
346-1000	4	1000MM WME EXTRUSION
346-600	4	600MM WME EXTRUSION

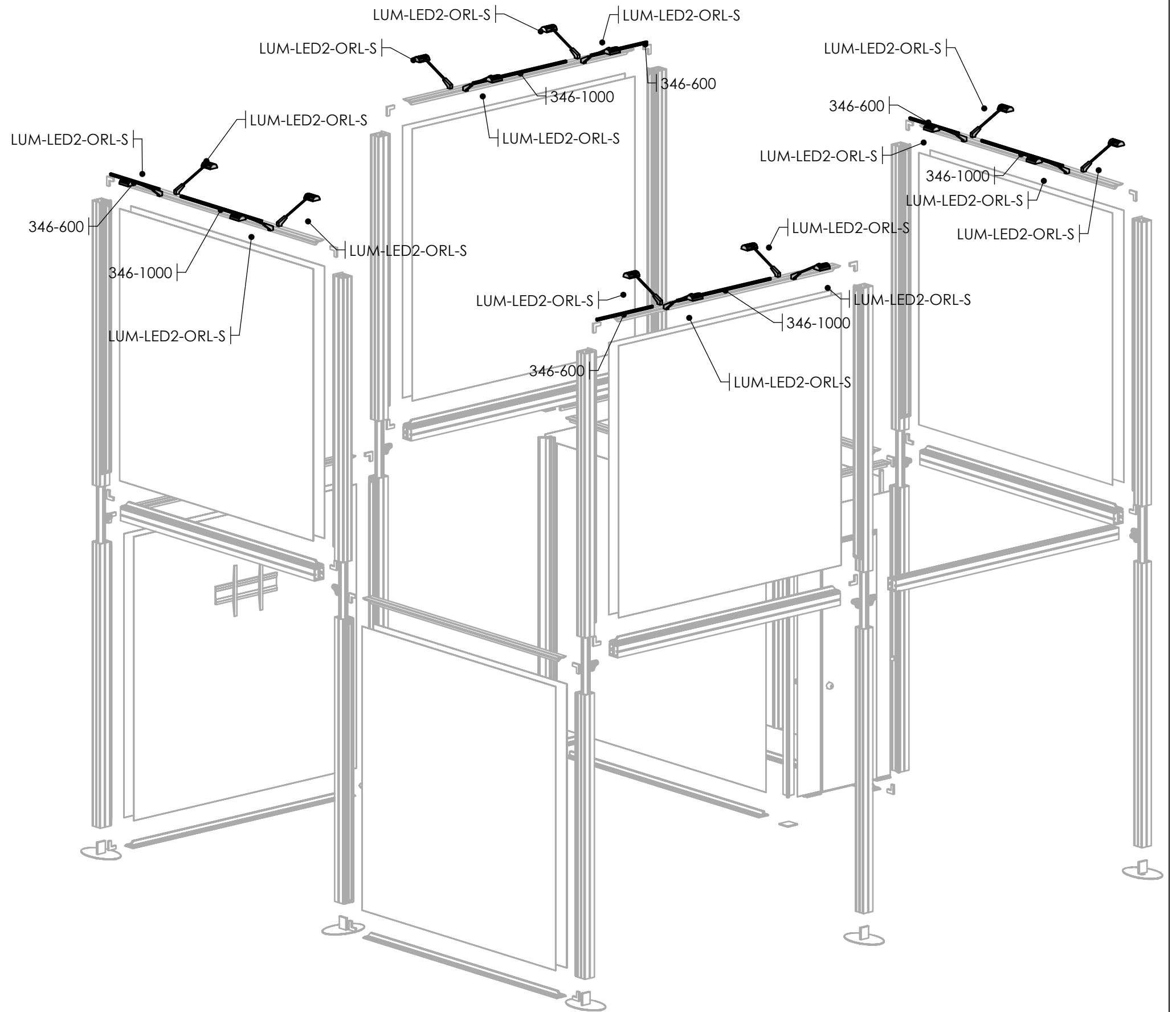
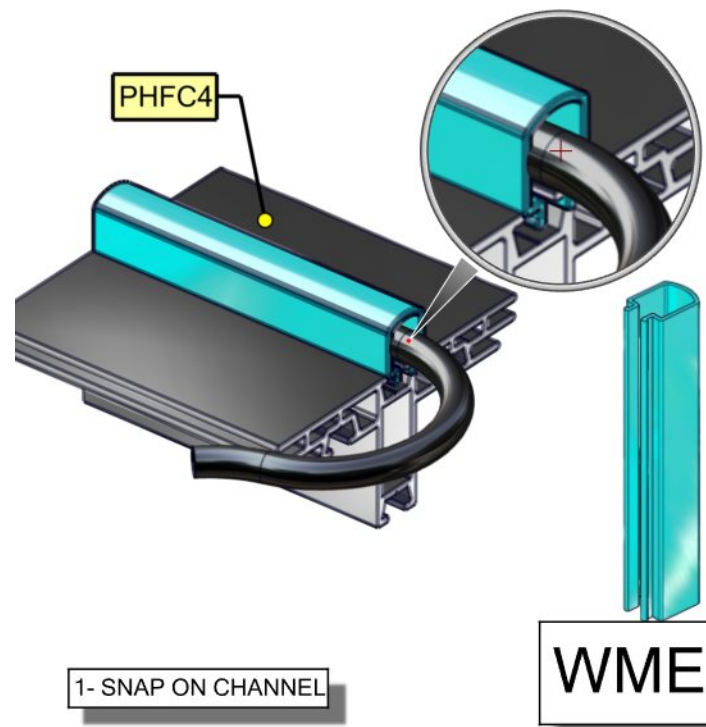

COMPONENTS
IN THIS STEP:
(Not to scale)



SETUP#	#	DESCRIPTION
409-900	4	900MM LENGTH OF L90S EXTRUSION
A16	1	900MM W X 900MM H LAMINATE PANEL
A15	2	300MM W X 900MM H LAMINATE PANEL
A17	1	900MM W X 900MM V LAMINATED PANEL CABINET DOOR

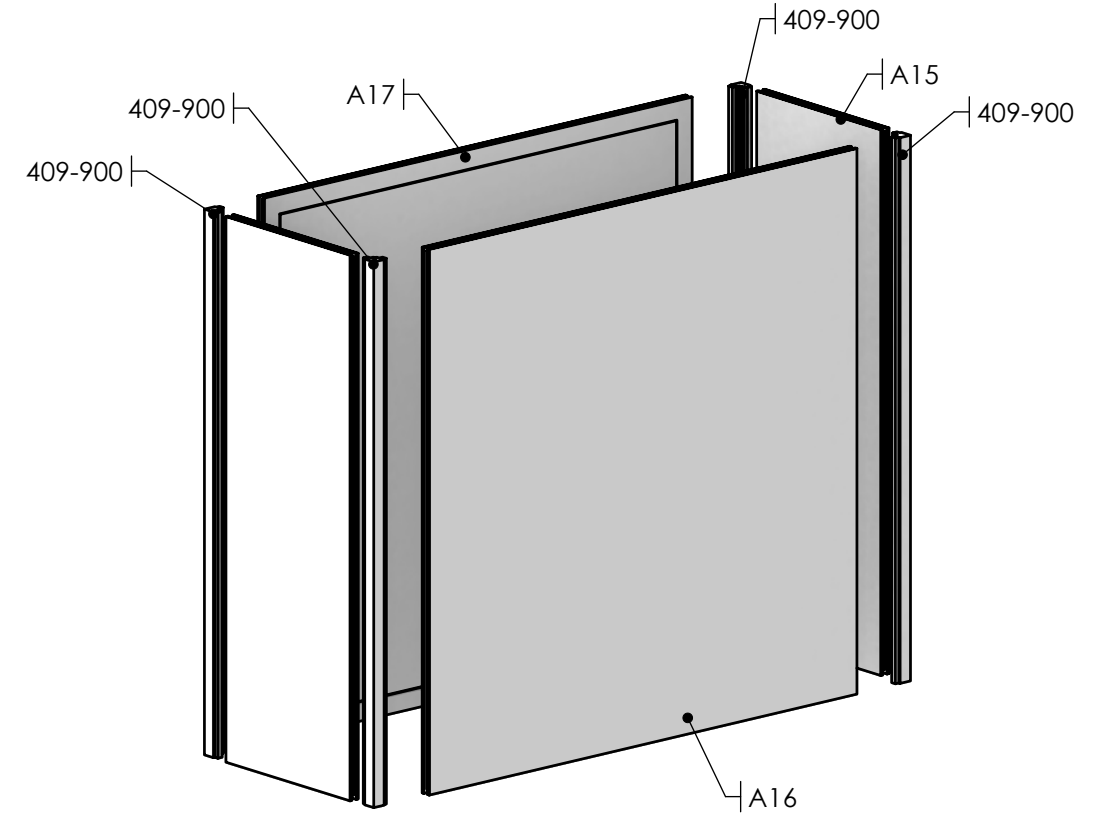
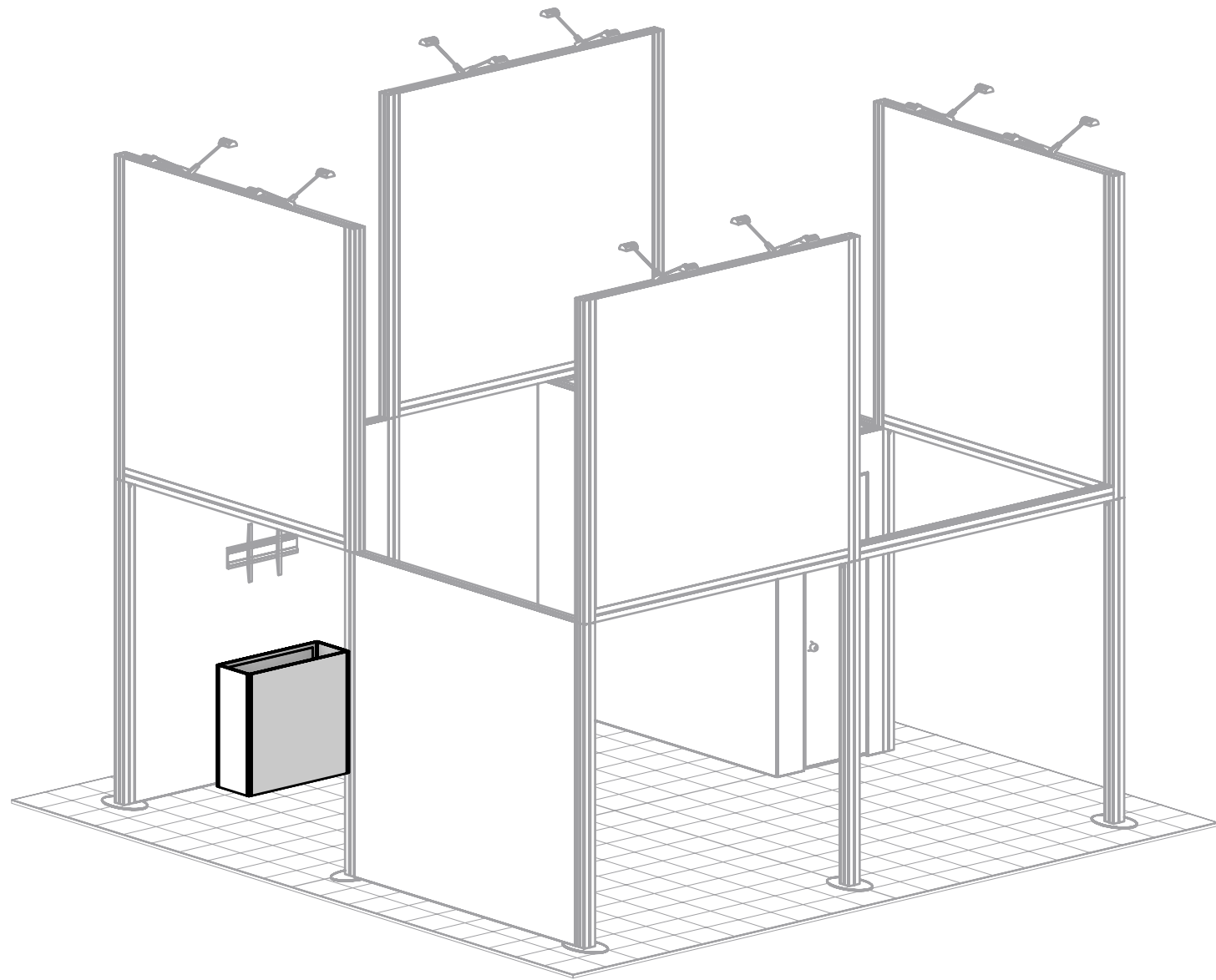

COMPONENTS
IN THIS STEP:
(Not to scale)



SETUP#	#	DESCRIPTION
CT-31L	1	1000mm X 394mm 30MM LAMINATE COUNTER TOP

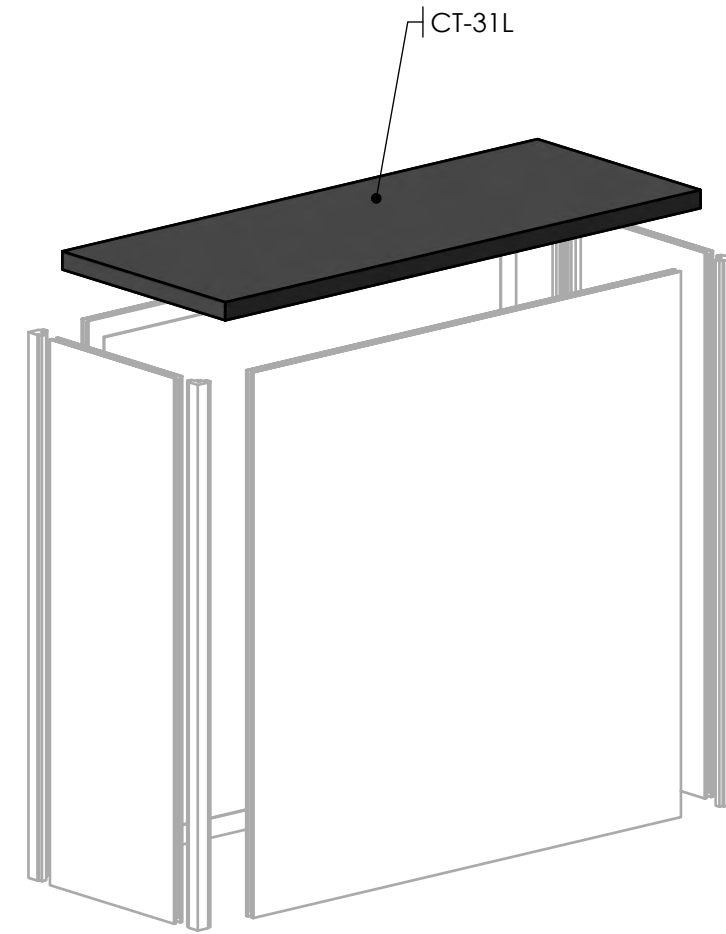
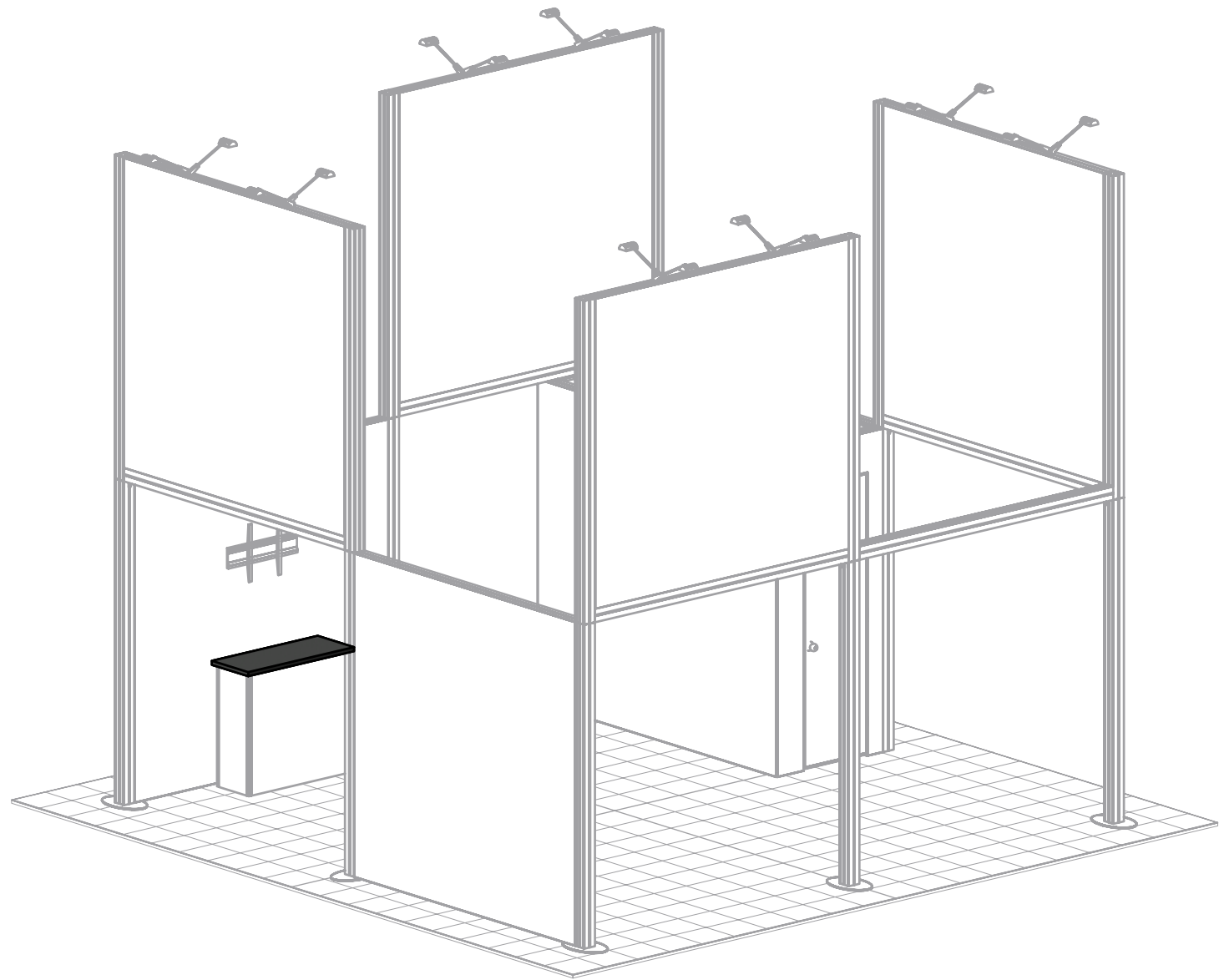

SETUP#	#	DESCRIPTION
PANEL 1	1	900MM X 588MM WOOD PANEL
PANEL 2	1	900MM X 588MM WOOD PANEL
PANEL 3	1	1500MM X 588MM WOOD PANEL

