

# LUMIÈRE CONFIGURATION - F

LUMIÈRE LIGHT WALL

PRODUCT CODE: LLW20X15F



On frame On graphic

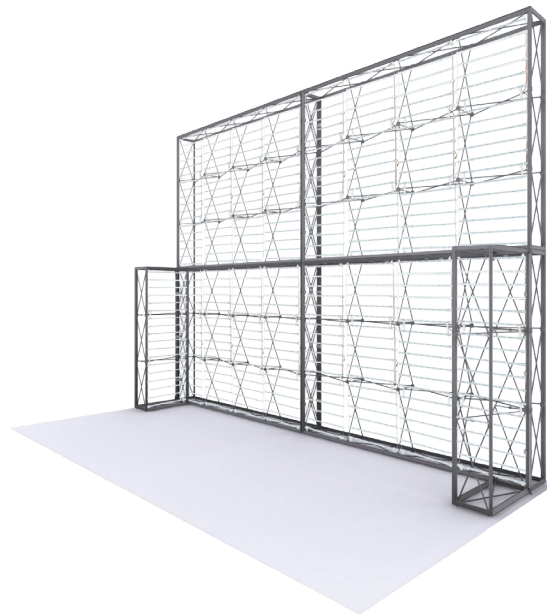

Straight Connector



L Link Connector

## PRODUCT DESCRIPTION

Illuminate your message with the Lumiere Light Wall! Lumiere ladder lights make backlit graphics pop on this innovative combo display of silicone-edge graphics and portable RPL fabric pop ups. Plus, the Lumiere shrinks down in size: simply collapse the geometric frame and the SEG bungeed channel bars, and fold or roll the fabrics graphics. Setup requires 1 person and 5-10 minutes. SEG portability is easy and stylish.

<b>DISPLAY DIMENSION</b>	236.2" W x 177" H x 44.5" D
<b>GRAPHIC DIMENSIONS</b>	
<b>4X3 MAIN GRAPHICS</b>	118.5" W x 89" H (8 Graphic)
<b>4X3 END CAP GRAPHICS</b>	14.25" W x 89" H (4 Graphics)
<b>1X3 MAIN GRAPHICS</b>	30.5" W x 89" H (4 Graphics)
<b>1X3 END CAP GRAPHICS</b>	14.25" W x 89" H (2 Graphics)

## GRAPHIC MATERIAL

UV Backlit Fabric

## GRAPHIC FINISHING

Silicone beading is sewn around the perimeter of the fabric graphic. Silicone beading is hidden from view once installed.

## DISPLAY CONSTRUCTION

Aluminum Frame

## LADDER LIGHTS SPECIFICATION

<b>EACH LIGHT BEAD</b>	1.0W
<b>ANGLE</b>	170°
<b>OPERATING VOLTAGE</b>	DC12V/24V
<b>TOTAL WATTAGE</b>	1890W
<b>TOTAL AMPERAGE</b>	81A

## TRANSFORMER SPECIFICATION

<b>OUTPUT</b>	24V/3.75A
<b>INPUT</b>	AC100-240V/1.3A

## SHIPPING WEIGHTS & DIMENSIONS

Lumiere Ladder Lights - 4 Units (4 boxes total)	
Shipping Weight	29 lbs
Shipping Dimensions	14" L x 12.5" W x 32.5" H
Lumiere Ladder Lights - 2 Units	
Shipping Weight	16 lbs
Shipping Dimensions	13" L x 9.5" W x 36.25" H
4x3 Lumiere Light Wall (4 boxes total)	
Shipping Weight	35 lbs (frame only) (each box) 39 lbs (with graphics) (each box)
Shipping Dimensions	34" L x 14" W x 9" H (each box)
1x3 Lumiere Light Wall (2 boxes total)	
Shipping Weight	20 lbs (frame only) (each box) 24 lbs (with graphics) (each box)
Shipping Dimensions	34" L x 14" W x 9" H (each box)

## GRAPHIC TURN AROUND TIME

6 business days after proof approval

<b>AVAILABILITY</b>	CA and PA
---------------------	-----------

**Please Note:** Lumiere Ladder Light sets are placed on the front side of the frame only. They are not double-sided and may not be used as so.

# LUMIÈRE CONFIGURATION - F

LUMIÈRE LIGHT WALL

PRODUCT CODE: LLW20X15F

## AVAILABLE ACCESSORIES



La Caja Case



Genie Counter Case



Internal Showcase



Lumiere Jumper Cable\*



Qty 4 -Stabilization Feet

**\*Note:** Lumiere Jumper Cable is used to connect the Lumiere Ladder Lights between the Internal Showcase.

# LUMIÈRE CONFIGURATION - F

LUMIÈRE LIGHT WALL

PRODUCT CODE: LLW20X15F

## PARTS LIST



Qty 4 - 4x3 Pop Up Frame



Qty 2 - 1x3 Pop Up Frame



Qty 16 - 4 Section  
Channel Bars



Qty 24 - 3 Section  
Channel Bars



Qty 8 - 1 Section  
Channel Bars

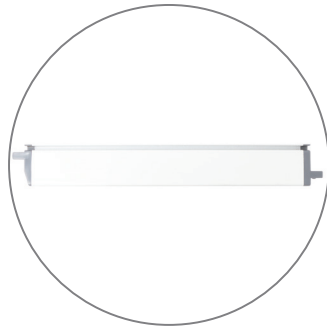

Qty 24 - End Cap  
Channel Bars



Qty 6 - Carry Bags



Qty 10 - Channel Bar Bags



Qty 28 - Straight  
Connectors



Qty 6 - L Link  
Connectors

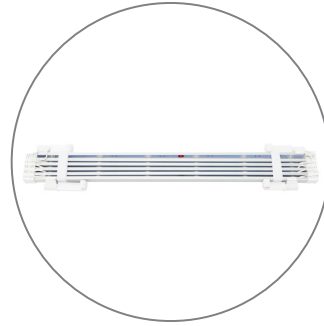

Qty 18 - Ladder Light Sets



Qty 18 - Transformers



Qty 18 - Transformer  
Power Cords



Qty 18 - Ladder Light  
Travel Bags

# LUMIÈRE CONFIGURATION - F

LUMIÈRE LIGHT WALL

PRODUCT CODE: LLW20X15F

## SET UP INSTRUCTIONS 1/2

### Set Up Pop Up Frame



**a.** Place frame with the adjustable feet facing down.

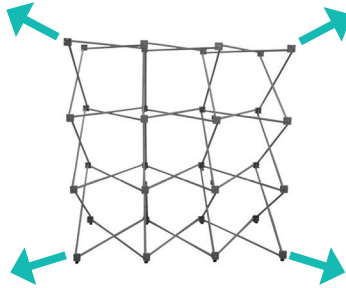

**b.** Expand the frame.

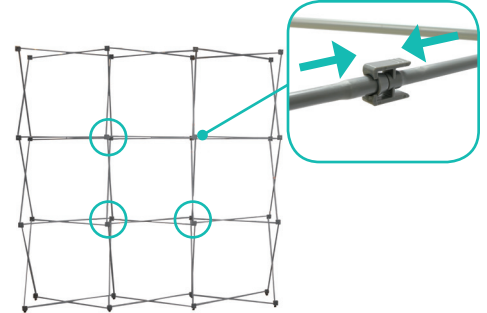

**c.** Close frame by pushing the outside of the frame until male and female ends connect.

### Insert Channel Bars

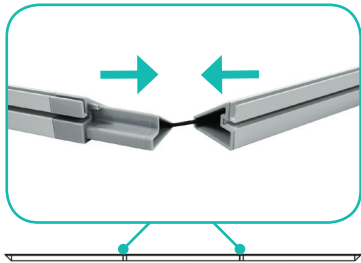

**a.** Expand each channel bar. Follow bungee to connect.

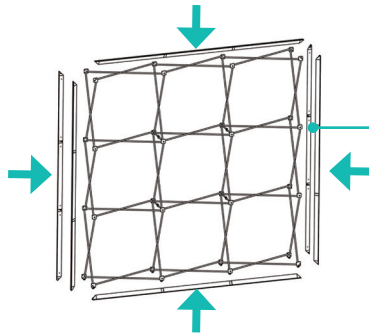

**b.** Attach channel bars to frame.

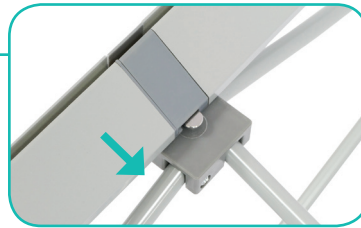

**c.** Slide channels bars onto frame, from top to bottom, then secure onto metal peg.



**d.** Attach the top and bottom end-caps on each side of the frame.

### Unfold The Hooks



**a.** Locate each hook.



**b.** Turn each hook outward.



**c.** Twist each hook to face the front of the ladder light.

# LUMIÈRE CONFIGURATION - F

LUMIÈRE LIGHT WALL

PRODUCT CODE: LLW20X15F

## SET UP INSTRUCTIONS 2/2

### Hook Ladder Lights



a. Hang ladder lights from top "x" bar. **Note:** Make sure to follow label that says "UP" or "DOWN".



b. Hang ladder lights in each section of the frame until reaching the bottom of the frame.

### Connect Ladder Lights



a. Connect each ladder light together using the barrel connectors.



b. Connect bottom set of lights to the LED Driver using the barrel connectors



c. Insert power cord to the LED Driver. Plug other side into your main power outlet.

### Install Graphic



a. In each corner, insert the silicone edge beading into the groove.



b. Then insert the remainder of the beading. Repeat blackout installation for the back frame.



c. Then repeat graphic installation on the end caps for each side.

# LUMIÈRE CONFIGURATION - F

LUMIÈRE LIGHT WALL

PRODUCT CODE: LLW20X15F

## SET UP INSTRUCTIONS

### Connecting Wall

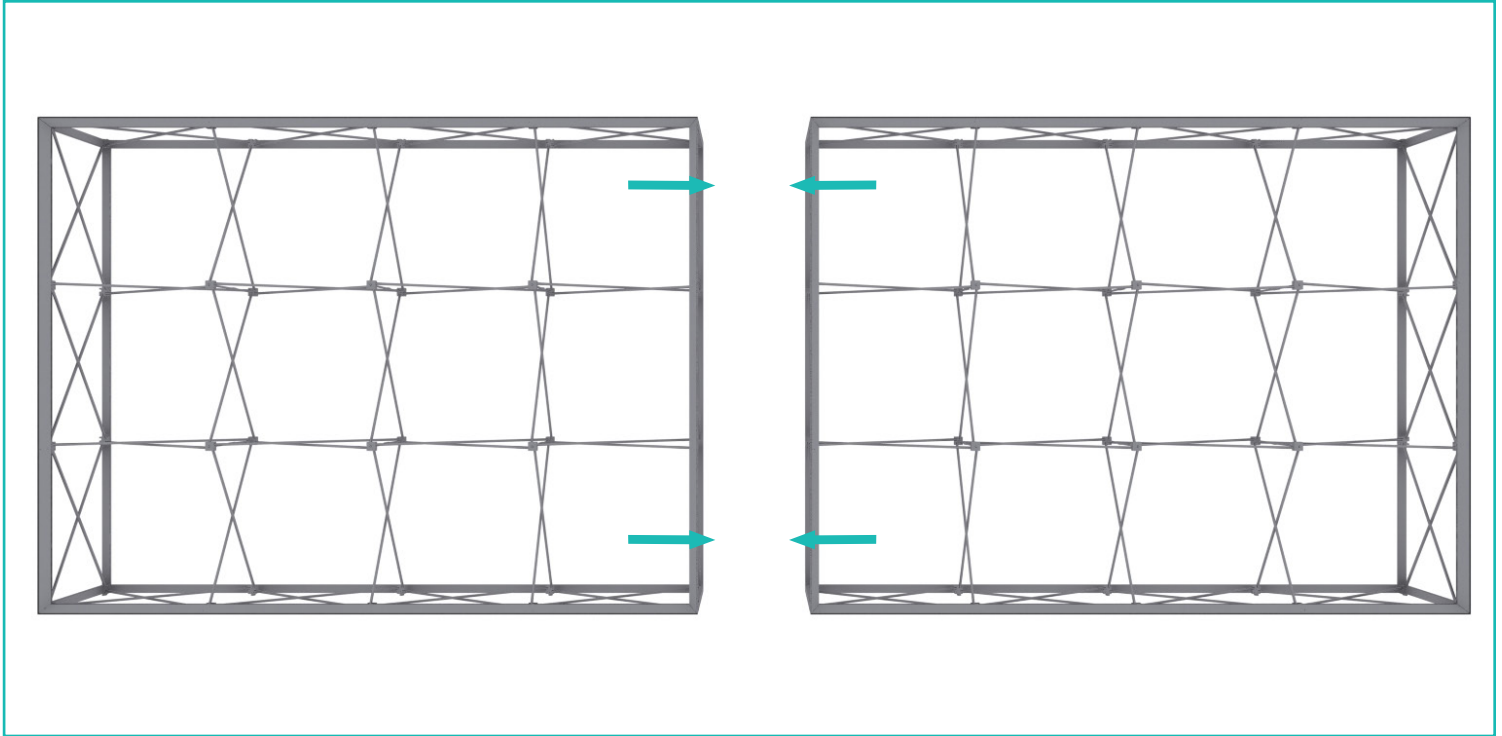

Place the (2) 4x3 frames side by side.

**Note:** Rendering shown without graphics for clarity.

### Straight Connection



**1**  
\*Starting from behind, make sure the frames are flushed next to each other.

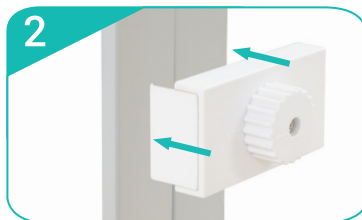

**2**  
Slide Straight Connector onto the channel bars of both frames.

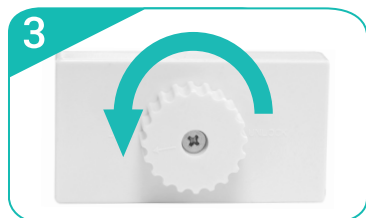

**3**  
Turn dial to the left to lock the Straight Connector in place. Repeat for each vertical sections (6 total).

**Note:** Repeat process when frames are stack together (6 total).



**4**

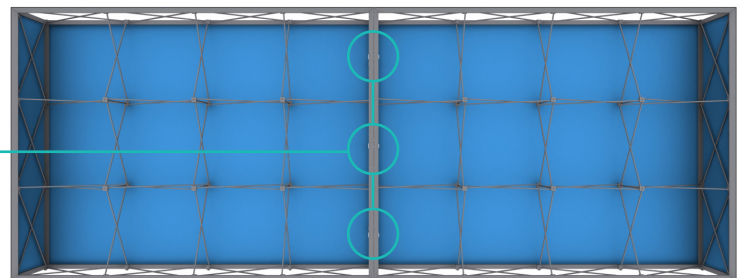

\*Back side of the 4x3's shown above.

# LUMIÈRE CONFIGURATION - F

LUMIÈRE LIGHT WALL

PRODUCT CODE: LLW20X15F

## SET UP INSTRUCTIONS

### Connecting Top Walls

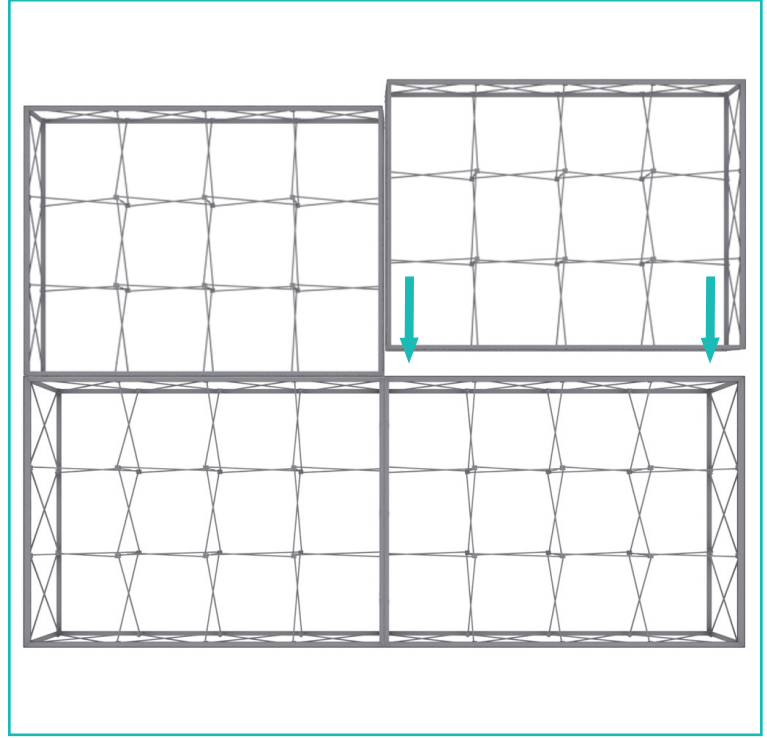
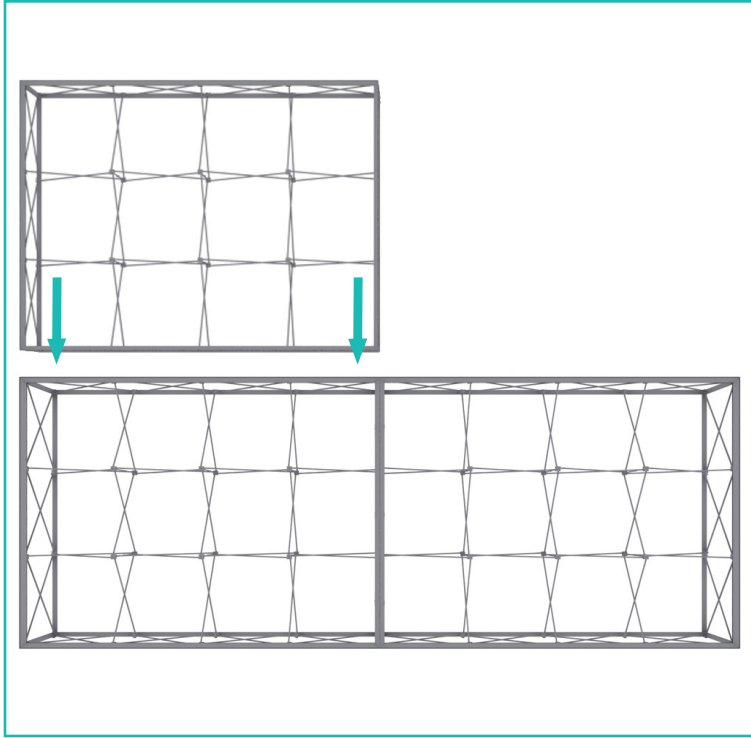

Place the 4x3 frames on top of the 4x3 frames.

**Note:** 2 people are required to hold each side of the top frame while the third person secures with the Straight Connectors. Repeat process for other top frame.

**Note:** Rendering shown without graphics for clarity. 4x3 front side graphics must be installed first before placing the frames on top.

### Straight Connection



\*Starting from behind, make sure the frames are flushed next to each other.

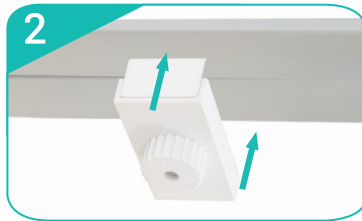

Slide Straight Connector onto the channel bars of both frames.

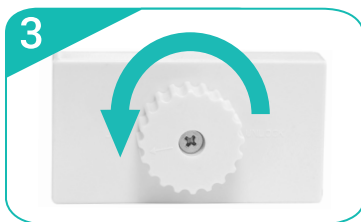

Turn dial to the left to lock the Straight Connector in place. Repeat for each vertical sections (8 total).

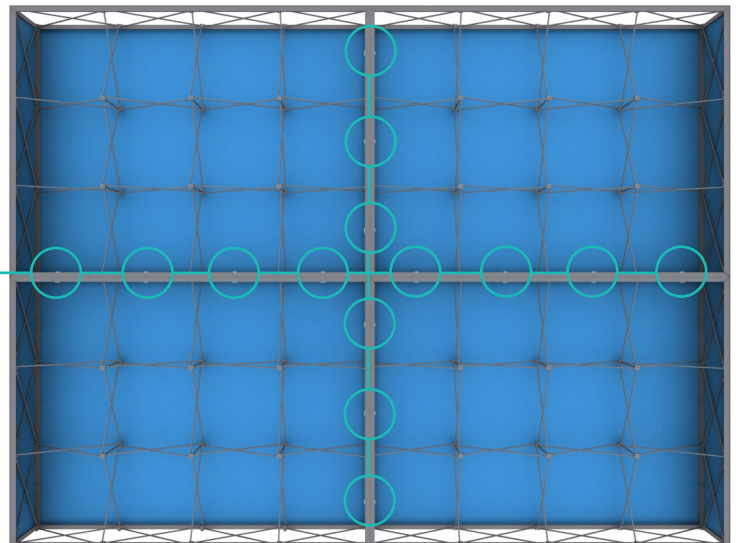

\*Back side of the stacked 4x3 frames shown above.

# LUMIÈRE CONFIGURATION - F

LUMIÈRE LIGHT WALL

PRODUCT CODE: LLW20X15F

## SET UP INSTRUCTIONS

### Connecting Return Walls

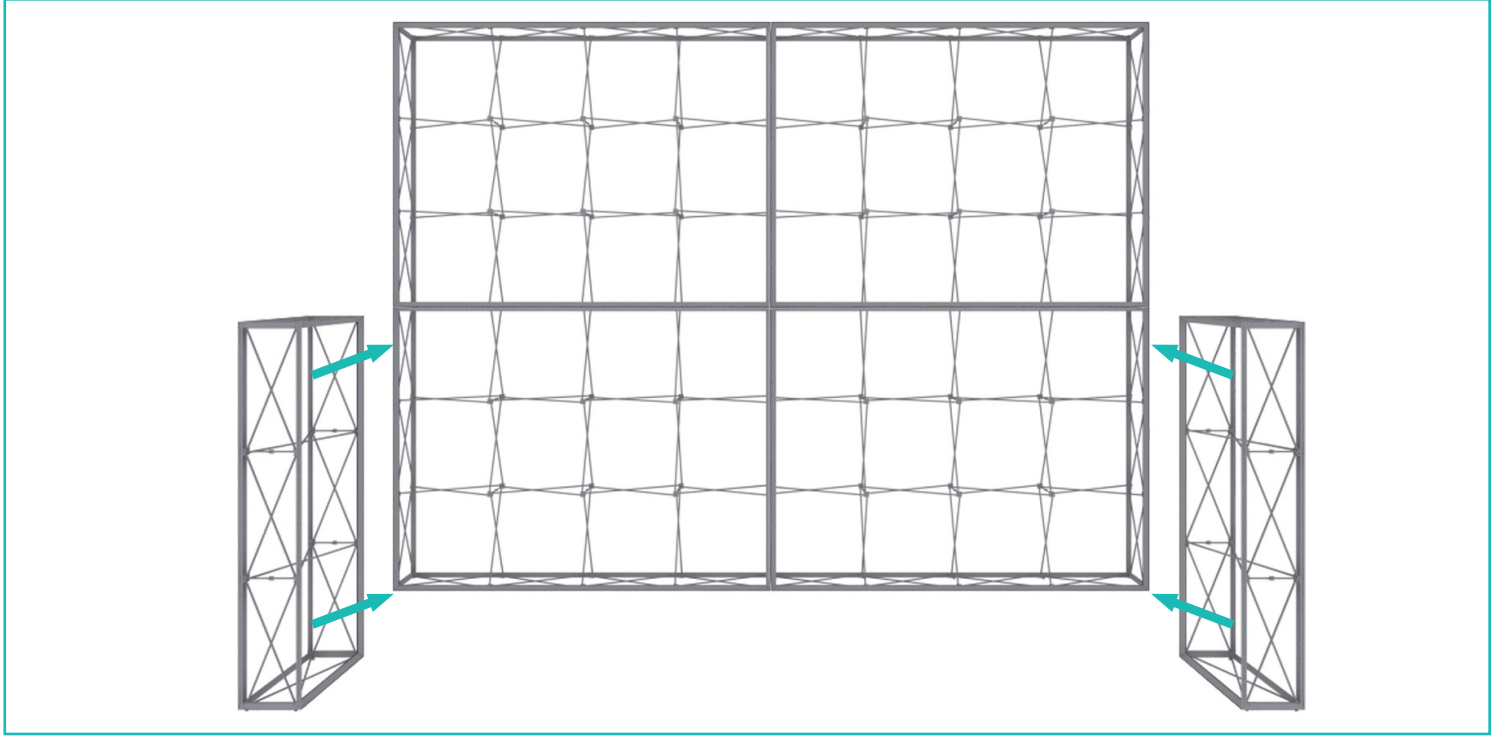

Adjoin the 1x3 frame perpendicular (90° angle) to the front side of the 4x3 frame.

**Note:** Rendering shown without graphics for clarity. 4x3 front side graphic must be installed before connecting frames.

### L Link Connection



\*Starting from behind, pull the 4x3 graphic away to make space for L Connector.



Slide L Connector onto the channel bars of both frames.

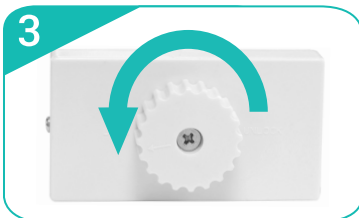

Turn dial to the left to lock the L Connector in place. Repeat for each vertical section (6 total).

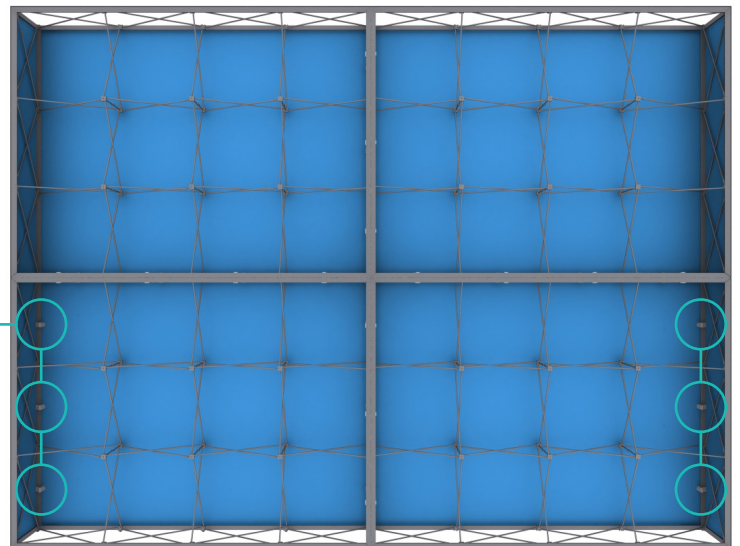

\*Back side of 4x3 shown above.



# LUMIÈRE CONFIGURATION - F

LUMIÈRE LIGHT WALL

PRODUCT CODE: LLW20X15F

## TEMPLATE GUIDE

### Front View

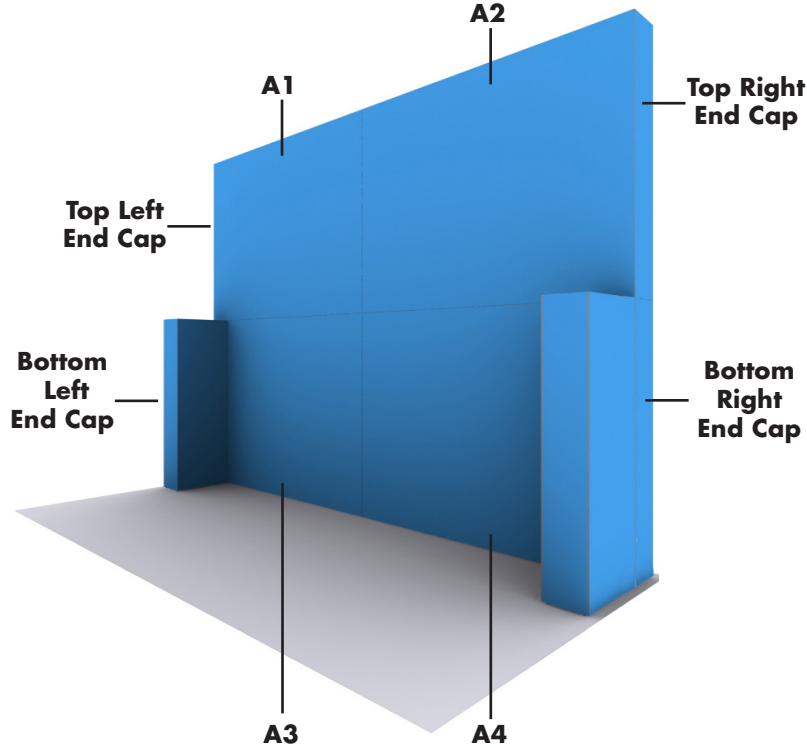

<p><b>TOP LEFT END CAP</b></p>	<p><b>A1 - LUMIERE CONFIGURATION F (4x3 TOP LEFT FRONT GRAPHIC)</b> Non-Backlit / Backlit</p> <p>Print Size (with bleed): 118.5" x 89" Yellow Safe Area: 112.5" x 83.5" Finished Size: 117.5" x 88" End Cap Print Size (with bleed): 14.25" x 89" End Cap Yellow Safe Area: 9.5" x 83.5" Finished Size: 13.375" x 88"</p> <p>Keep all your important graphics within top, left, and bottom dimensions in the yellow safe zone. Blue area will print</p> <p><b>DISCLAIMER:</b> Any continuous artwork may not line up properly</p> <p><b>TEMPLATE ARE AT 1/2 SCALE</b></p>	<p><b>A2 - LUMIERE CONFIGURATION F (4x3 TOP RIGHT FRONT GRAPHIC)</b> Non-Backlit / Backlit</p> <p>Print Size (with bleed): 118.5" x 89" Yellow Safe Area: 112.5" x 83.5" Finished Size: 117.5" x 88" End Cap Print Size (with bleed): 14.25" x 89" End Cap Yellow Safe Area: 9.5" x 83.5" Finished Size: 13.375" x 88"</p> <p>Keep all your important graphics within top, right, and bottom dimensions in the yellow safe zone. Blue area will print</p> <p><b>DISCLAIMER:</b> Any continuous artwork may not line up properly</p> <p><b>TEMPLATE ARE AT 1/2 SCALE</b></p>	<p><b>TOP RIGHT END CAP</b></p>
<p><b>BOTTOM LEFT END CAP</b></p>	<p><b>A3 - LUMIERE CONFIGURATION F (4x3 BOTTOM LEFT FRONT GRAPHIC)</b> Non-Backlit / Backlit</p> <p>Print Size (with bleed): 118.5" x 89" Yellow Safe Area: 98" x 83.5" Finished Size: 117.5" x 88" End Cap Print Size (with bleed): 14.25" x 89" End Cap Yellow Safe Area: 9.5" x 83.5" Finished Size: 13.375" x 88"</p> <p>Keep all your important graphics within top, left, and bottom dimensions in the yellow safe zone. Blue area will print</p> <p><b>DISCLAIMER:</b> Any continuous artwork may not line up properly</p> <p><b>TEMPLATE ARE AT 1/2 SCALE</b></p>	<p><b>A4 - LUMIERE CONFIGURATION F (4x3 BOTTOM RIGHT FRONT GRAPHIC)</b> Non-Backlit / Backlit</p> <p>Print Size (with bleed): 118.5" x 89" Yellow Safe Area: 98" x 83.5" Finished Size: 117.5" x 88" End Cap Print Size (with bleed): 14.25" x 89" End Cap Yellow Safe Area: 9.5" x 83.5" Finished Size: 13.375" x 88"</p> <p>Keep all your important graphics within top, right, and bottom dimensions in the yellow safe zone. Blue area will print</p> <p><b>DISCLAIMER:</b> Any continuous artwork may not line up properly</p> <p><b>TEMPLATE ARE AT 1/2 SCALE</b></p>	<p><b>BOTTOM RIGHT END CAP</b></p>

# LUMIÈRE CONFIGURATION - F

LUMIÈRE LIGHT WALL

PRODUCT CODE: LLW20X15F

## TEMPLATE GUIDE

### Back View

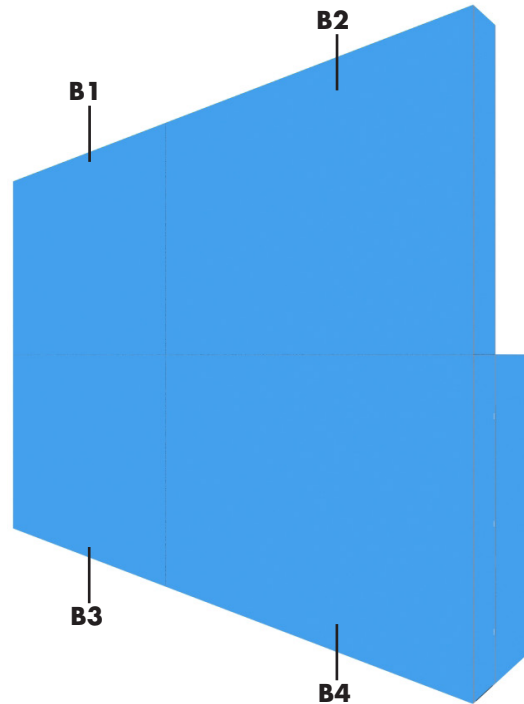

**B1 - LUMIERE  
CONFIGURATION F  
(4x3 TOP LEFT BACK GRAPHIC)  
Non-Backlit / Backlit**

Print Size (with bleed): 118.5" x 89"  
Yellow Safe Area: 112.5" x 83.5"  
Finished Size: 117.5" x 88"  
End Cap Print Size (with bleed): 14.25" x 89"  
End Cap Yellow Safe Area: 9.5" x 83.5"  
Finished Size: 13.375" x 88"

Keep all your important graphics  
(such as logos, text, and contact information)  
in the yellow safe zone.  
Blue area will print

**DISCLAIMER:**  
Any continuous artwork may not line up properly  
**TEMPLATE ARE AT 1/2 SCALE**

**B2 - LUMIERE  
CONFIGURATION F  
(4x3 TOP RIGHT BACK GRAPHIC)  
Non-Backlit / Backlit**

Print Size (with bleed): 118.5" x 89"  
Yellow Safe Area: 112.5" x 83.5"  
Finished Size: 117.5" x 88"  
End Cap Print Size (with bleed): 14.25" x 89"  
End Cap Yellow Safe Area: 9.5" x 83.5"  
Finished Size: 13.375" x 88"

Keep all your important graphics  
(such as logos, text, and contact information)  
in the yellow safe zone.  
Blue area will print

**DISCLAIMER:**  
Any continuous artwork may not line up properly  
**TEMPLATE ARE AT 1/2 SCALE**

**B3 - LUMIERE  
CONFIGURATION F  
(4x3 BOTTOM LEFT BACK GRAPHIC)  
Non-Backlit / Backlit**

Print Size (with bleed): 118.5" x 89"  
Yellow Safe Area: 112.5" x 83.5"  
Finished Size: 117.5" x 88"  
End Cap Print Size (with bleed): 14.25" x 89"  
End Cap Yellow Safe Area: 9.5" x 83.5"  
Finished Size: 13.375" x 88"

Keep all your important graphics  
(such as logos, text, and contact information)  
in the yellow safe zone.  
Blue area will print

**DISCLAIMER:**  
Any continuous artwork may not line up properly  
**TEMPLATE ARE AT 1/2 SCALE**

**B4 - LUMIERE  
CONFIGURATION F  
(4x3 BOTTOM RIGHT BACK GRAPHIC)  
Non-Backlit / Backlit**

Print Size (with bleed): 118.5" x 89"  
Yellow Safe Area: 112.5" x 83.5"  
Finished Size: 117.5" x 88"  
End Cap Print Size (with bleed): 14.25" x 89"  
End Cap Yellow Safe Area: 9.5" x 83.5"  
Finished Size: 13.375" x 88"

Keep all your important graphics  
(such as logos, text, and contact information)  
in the yellow safe zone.  
Blue area will print

**DISCLAIMER:**  
Any continuous artwork may not line up properly  
**TEMPLATE ARE AT 1/2 SCALE**

# LUMIÈRE CONFIGURATION - F

LUMIÈRE LIGHT WALL

PRODUCT CODE: LLW20X15F

## TEMPLATE GUIDE

### Front View

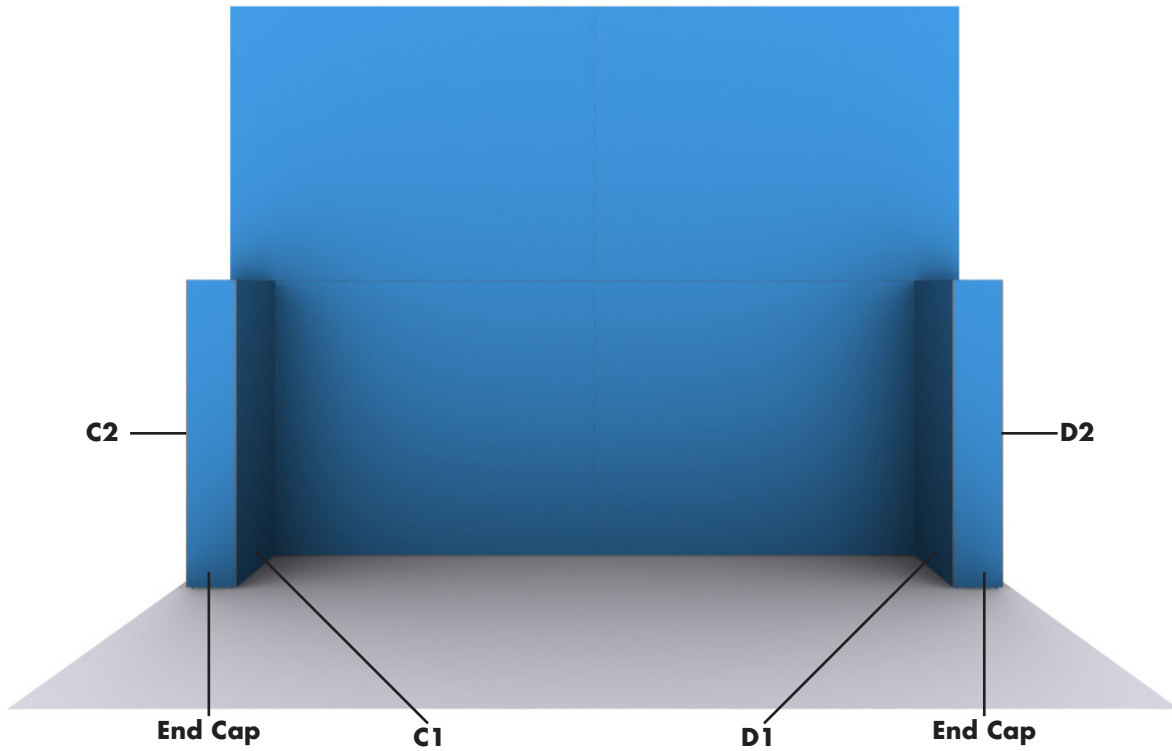

<p><b>C2 - LUMIERE CONFIGURATION F (1x3 LEFT RETURN WALL GRAPHIC) Non-Backlit / Backlit</b></p> <p>Print Size (with bleed): 31.5" x 89" Yellow Safe Area: 25.5" x 83.5" Finished Size: 30.5" x 88" End Cap Print Size (with bleed): 14.25" x 89" End Cap Yellow Safe Area: 9.5" x 83.5" Finished Size: 13.375" x 88"</p> <p>Keep all your important graphics such as logos, text, and contact information in the yellow safe zone. Blue area will print</p> <p><b>DISCLAIMER:</b> Any continuous artwork may not line up properly</p> <p><b>TEMPLATE ARE AT 1/2 SCALE</b></p>	<p><b>END CAP</b></p>	<p><b>C1 - LUMIERE CONFIGURATION F (1x3 LEFT RETURN WALL GRAPHIC) Non-Backlit / Backlit</b></p> <p>Print Size (with bleed): 31.5" x 89" Yellow Safe Area: 25.5" x 83.5" Finished Size: 30.5" x 88" End Cap Print Size (with bleed): 14.25" x 89" End Cap Yellow Safe Area: 9.5" x 83.5" Finished Size: 13.375" x 88"</p> <p>Keep all your important graphics such as logos, text, and contact information in the yellow safe zone. Blue area will print</p> <p><b>DISCLAIMER:</b> Any continuous artwork may not line up properly</p> <p><b>TEMPLATE ARE AT 1/2 SCALE</b></p>
---	-----------------------	---

Ver-1011.17

<p><b>D1 - LUMIERE CONFIGURATION F (1x3 RIGHT RETURN WALL GRAPHIC) Non-Backlit / Backlit</b></p> <p>Print Size (with bleed): 31.5" x 89" Yellow Safe Area: 25.5" x 83.5" Finished Size: 30.5" x 88" End Cap Print Size (with bleed): 14.25" x 89" End Cap Yellow Safe Area: 9.5" x 83.5" Finished Size: 13.375" x 88"</p> <p>Keep all your important graphics such as logos, text, and contact information in the yellow safe zone. Blue area will print</p> <p><b>DISCLAIMER:</b> Any continuous artwork may not line up properly</p> <p><b>TEMPLATE ARE AT 1/2 SCALE</b></p>	<p><b>END CAP</b></p>	<p><b>D2 - LUMIERE CONFIGURATION F (1x3 RIGHT RETURN WALL GRAPHIC) Non-Backlit / Backlit</b></p> <p>Print Size (with bleed): 31.5" x 89" Yellow Safe Area: 25.5" x 83.5" Finished Size: 30.5" x 88" End Cap Print Size (with bleed): 14.25" x 89" End Cap Yellow Safe Area: 9.5" x 83.5" Finished Size: 13.375" x 88"</p> <p>Keep all your important graphics such as logos, text, and contact information in the yellow safe zone. Blue area will print</p> <p><b>DISCLAIMER:</b> Any continuous artwork may not line up properly</p> <p><b>TEMPLATE ARE AT 1/2 SCALE</b></p>
--	-----------------------	--

Ver-1011.17