

MODCO23-20x10G





MOD-FRM-992x2418
Qty.10



MOD-LD992X2418-BLACK
Qty.1



MOD-FRM-310x992
Qty.4



MOD-FRM-992x992
Qty.2



MOD-CTR-BM-992x434-WHT
Qty.1



MOD-FRM-992x2418-LV-BLK
Qty.2



MOD-PCWP-A
Qty.6

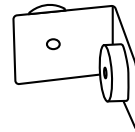

MOD-90D-CON
Qty.10

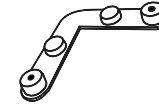

MOD-SM90D-CON
Qty.12

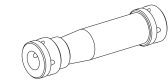

MOD-CLA-CON
Qty.6

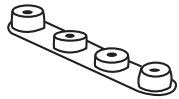

MOD-180D-CON
Qty.6



MOD-PC
Qty.56



MOD-CP-992x2418
Qty.5



MOD-CP-3100 (992mm)
Qty.4

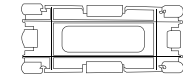

MOD-CC
Qty.33



MOD-CTR-DOORS-992X992
Qty.2



MOD-SWP-992X2418-WHT
Qty.2



MOD-LV90D-CON
Qty.2



MOD-LV180D-CON
Qty.2



MOD-180D-LV-CON
Qty.3



MOD-PNL-BM-984x301-WHT
Qty.4



MOD-SHELF-KIT-350mm
Qty.4



MOD-PCTV
Qty.4



MOD-FRM-992x992-LV-BLACK
Qty.2

CONNECTIONS

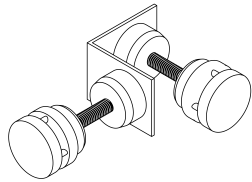

MOD-90D-CON + MOD-PC

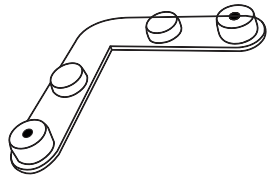
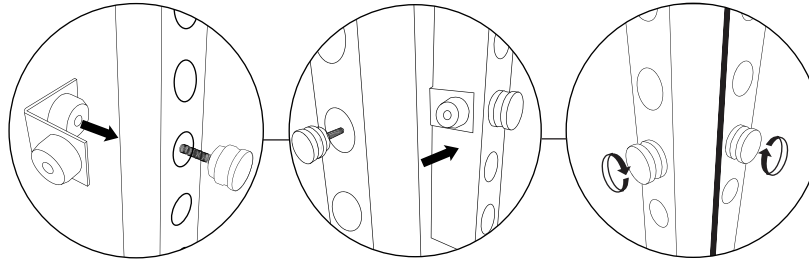

MOD-SM90D-CON / MOD-PC

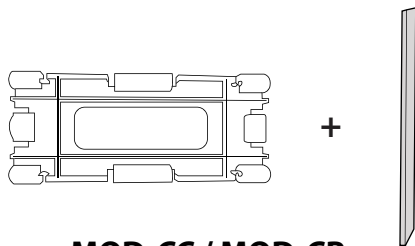
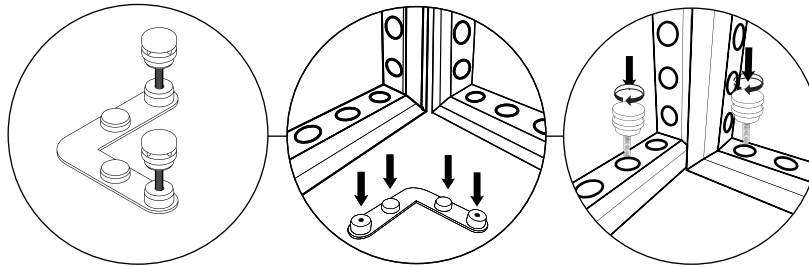

MOD-CC / MOD-CP

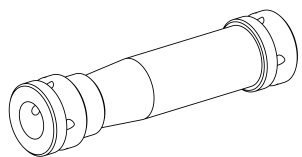
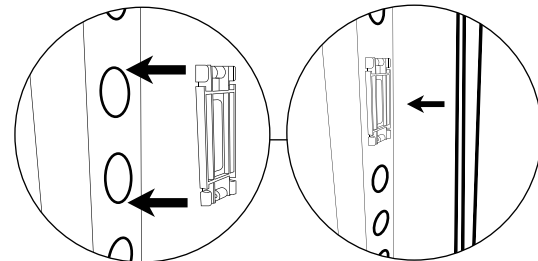

MOD-CLA-CON

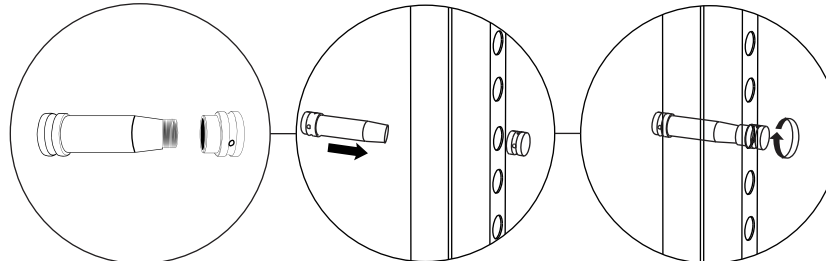

CONNECTIONS

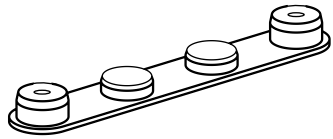

MOD-180D-CON / MOD-PC

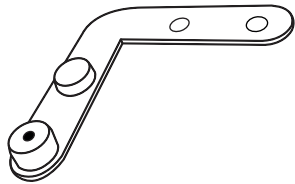
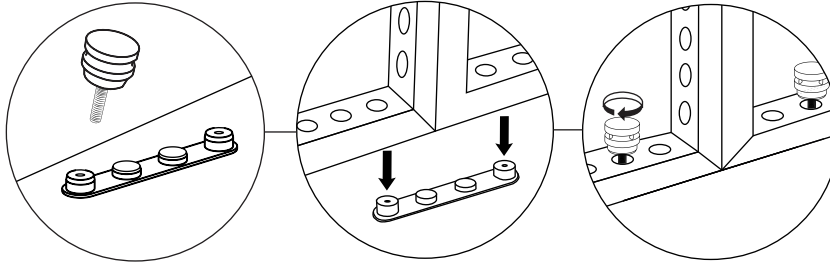

MOD-SM90-LV-CON / MOD-PC / WINGNUTS

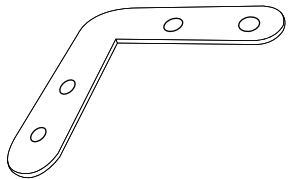
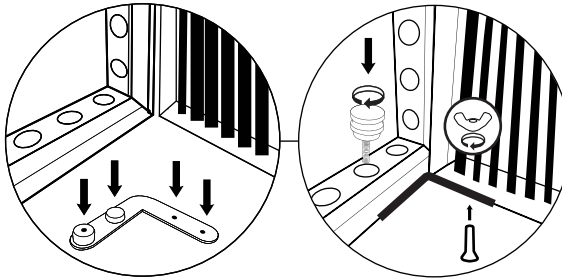

MOD-LV90D-CON / WINGNUTS

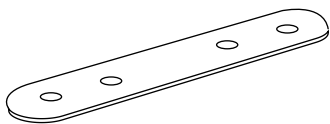
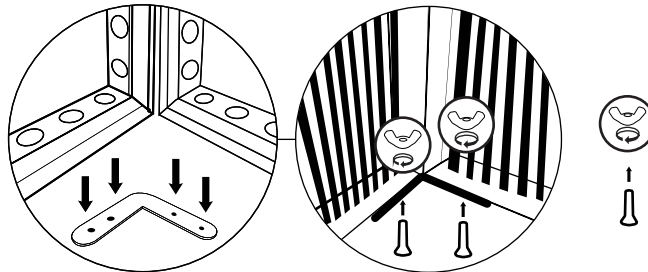

MOD-LV180D-CON / WINGNUTS

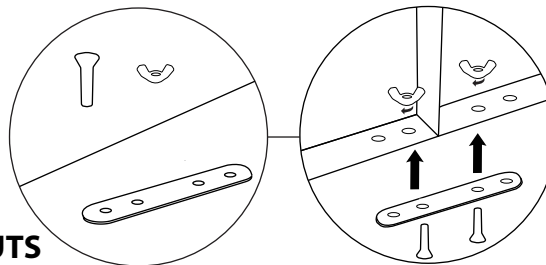

CONNECTIONS

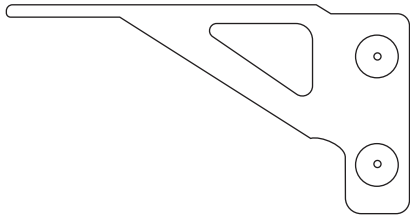

MOD-SHELF-KIT-350MM

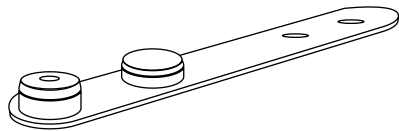
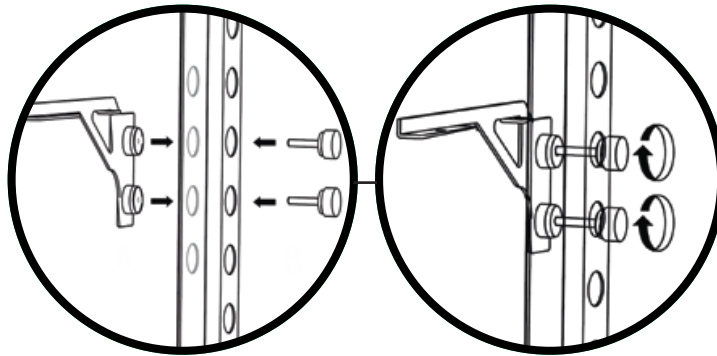

MOD-180D-LV-CON / MOD-PC / WINGNUTS

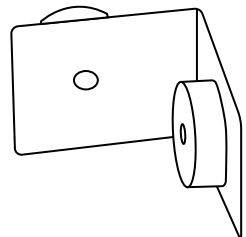
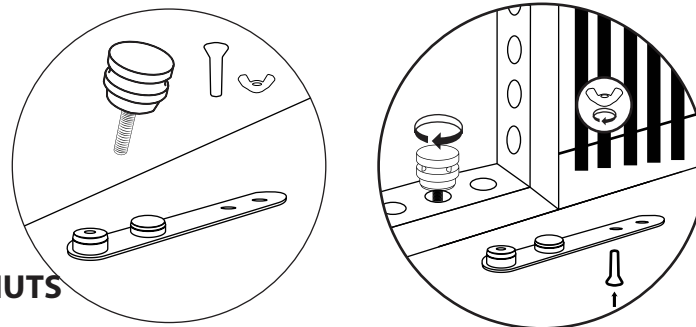

+

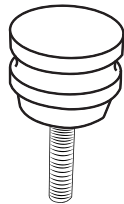

+

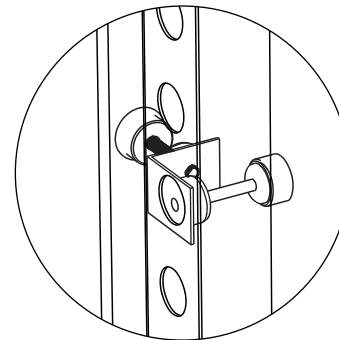
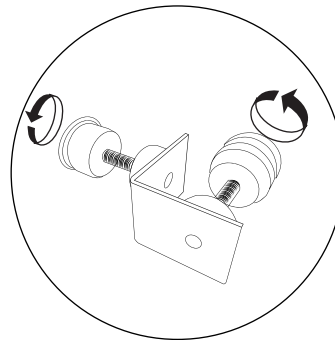
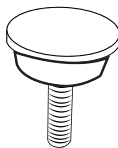

MOD-90D-CON / MOD-PC / MOD-PCWP-A

*Same as (C) but MOD-PCWP-A will be inside of door jam

1

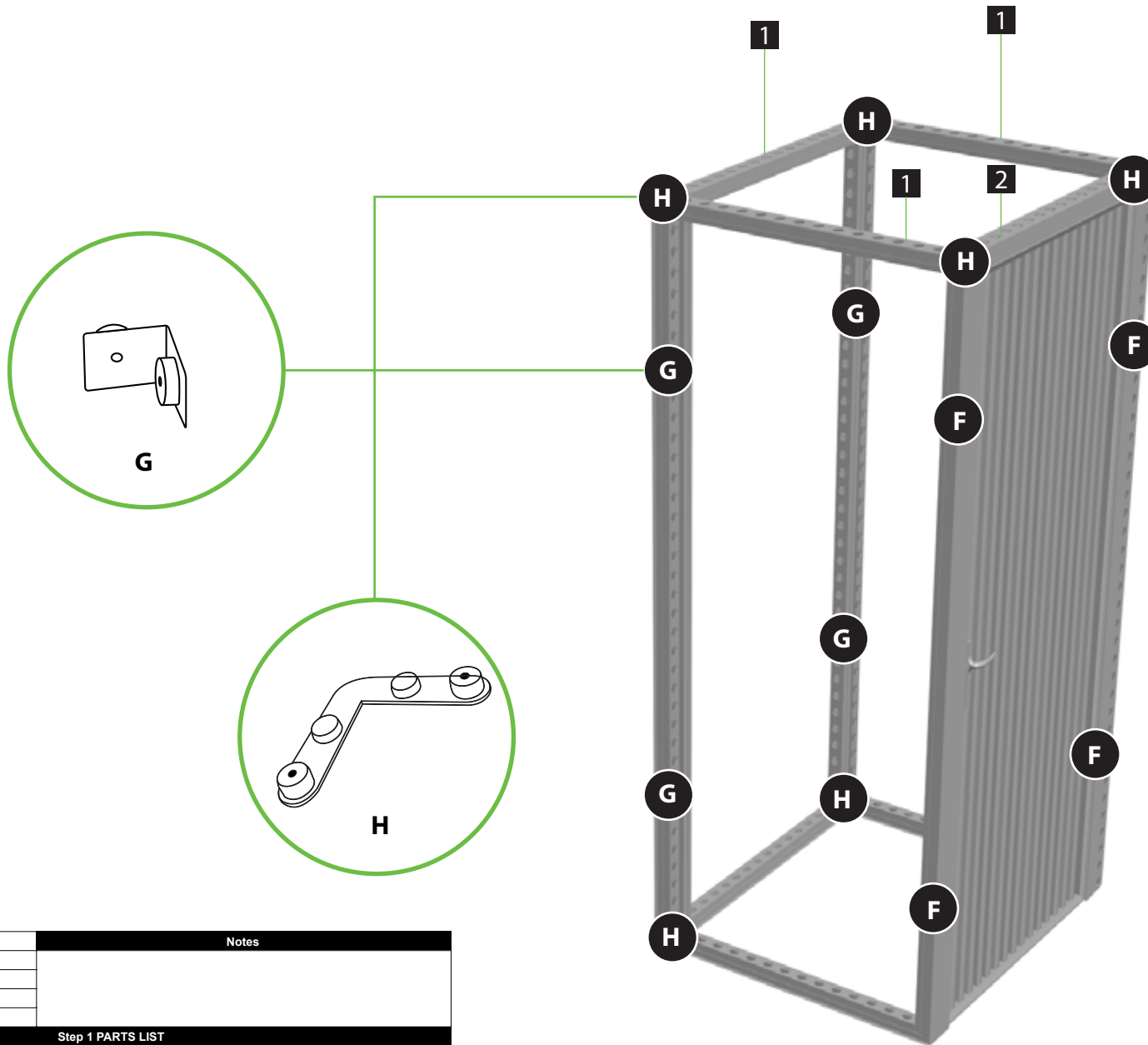

Name:	Joey F.	Notes	
Date:	Jul 3 2024		
SKU build:	MODCO23-20x10G		
Location:	MX / PA		
QC build:	h/a (Standard)		
Step 1 PARTS LIST			
REF	QTY	PART NO.	DESCRIPTION
1	3	MOD-FRM-992x2418	Straight Frame, Corner Screw Connect 992mm x 2418mm
2	1	MOD-LD992x2418-BLACK	Louver Door Frame, 992mm x 2418mm
F	6	MOD-PCWP-A	90 degree connector, for Louver to M frame
G	8	MOD-90D-CON	Modco 90° Connector
H	6	MOD-SM90D-CON	L-Shaped Modco 90° Connector
K	22	MOD-PC	Modco Pin Connector

2

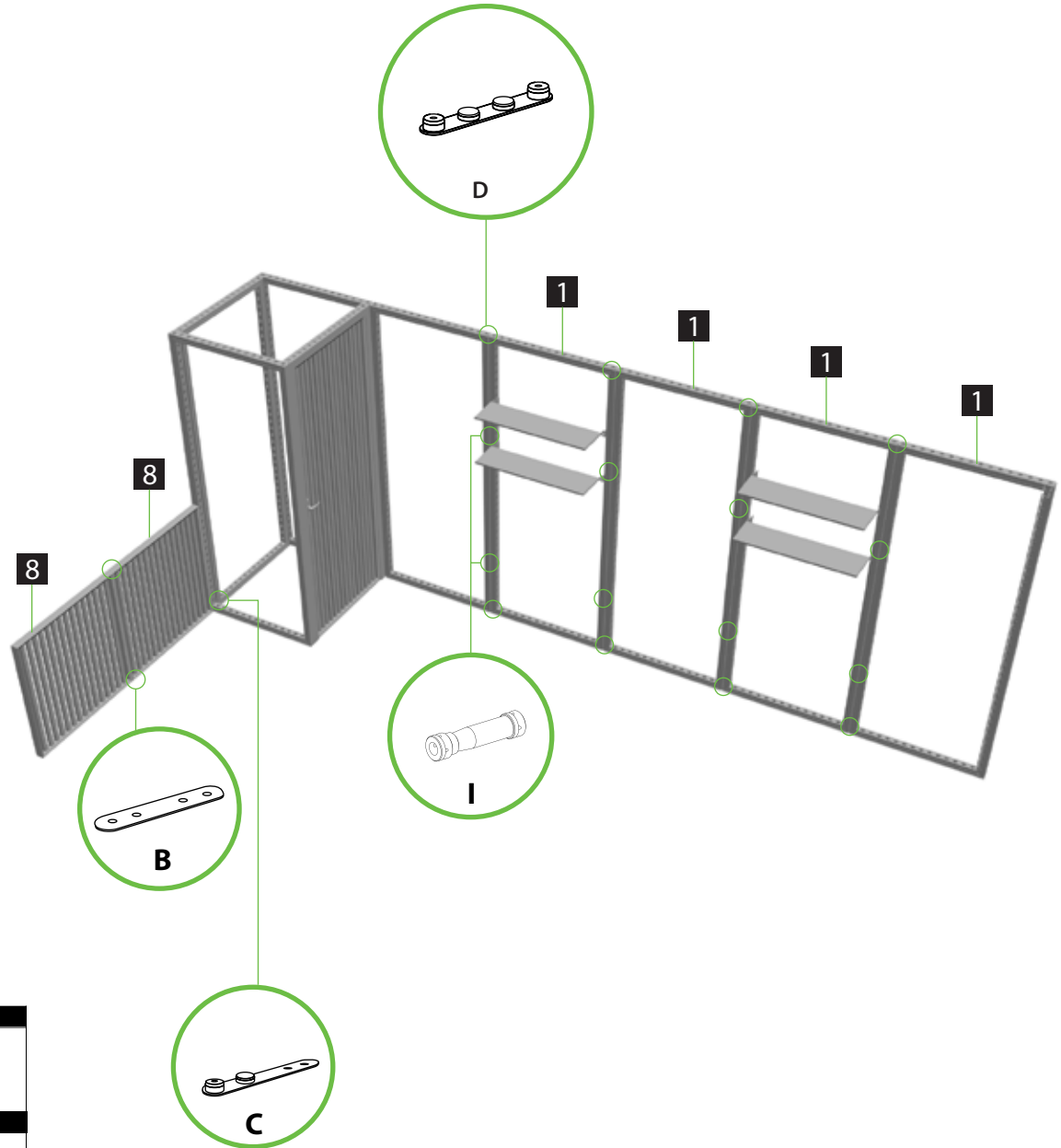
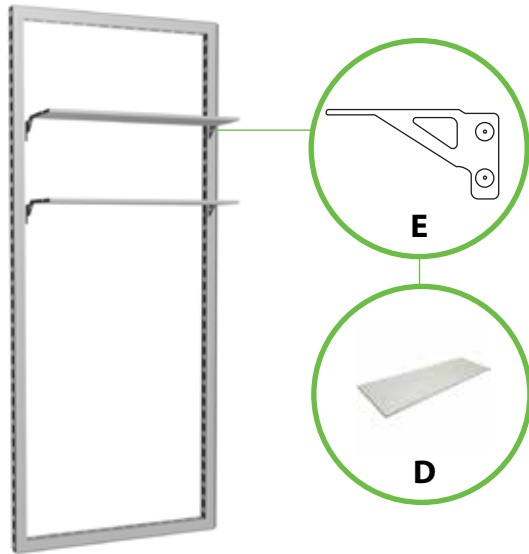

Name: Joey F.	Notes
Date: Jul 3 2024	• Shelving brackets may come pre-installed onto frames.
SKU build: MODCO23-20x10G	
Location: MX / PA	
QC build: n/a (Standard)	

Step 2 PARTS LIST			
REF	QTY	PART NO.	DESCRIPTION
1	5	MOD-FRM-992x2418	Straight Frame, Corner Screw Connect 992mm x 2418mm
8	2	MOD-FRM-992x992-LV-BLACK	Louver Frame, 992mm x 992mm
J	8	MOD-180D-CON	Modco 180° Connector
I	10	MOD-CLA-CON	Modco Clamp Connector
E	4	MOD-SHELF-KIT-350mm	Modco Shelf Bracket (Pair)
D	4	MOD-PNL-BM-984x301-WHT	Modco White Shelf Panel
B	2	MOD-LV180D-CON	Modco Louver to Louver, 180° Connector
K	33	MOD-PC	Modco Pin Connector
O	4	MOD-PCTV	Modco Pin Connector 100mm
C	1	MOD-180D-LV-CON	Modco Louver to M-frame, 180° Connector

3

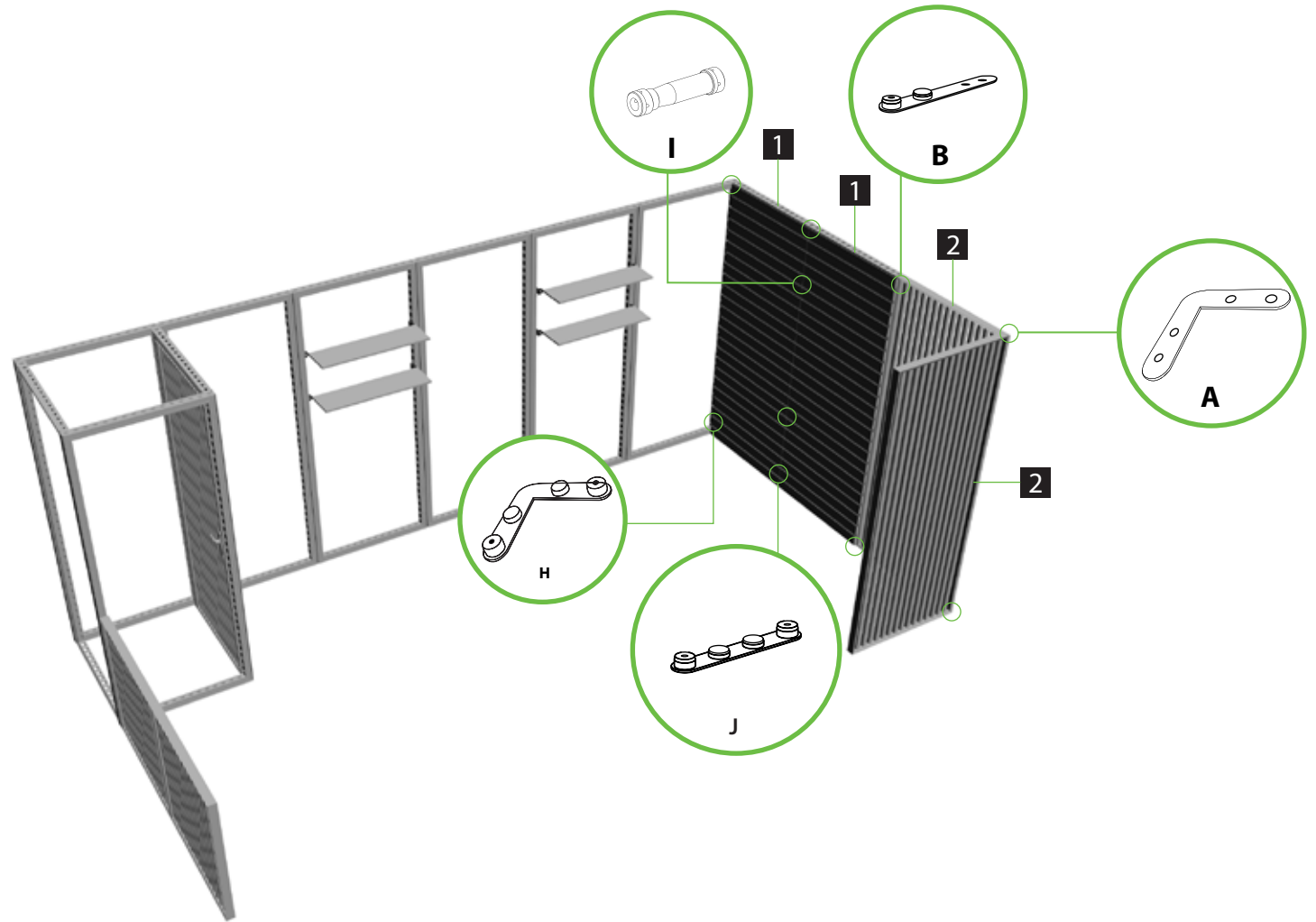

Name: Joey F.	Notes
Date: Jul 3 2024	• Slatwalls (REF 7) are pre-installed on 992mm x 2418mm frames using MOD-PNL-CON-B (Qty.8) and MOD-PCWP-A (Qty.8)
SKU build: MODCO23-20x10G	
Location: MX / PA	
QC build: n/a (Standard)	

Step 3 PARTS LIST			
REF	QTY	PART NO.	DESCRIPTION
1	2	MOD-FRM-992x2418	Straight Frame, Corner Screw Connect 992mm x 2418mm
8	2	MOD-FRM-992x2418-LV-BLACK	Louver Frame, 992mm x 992mm
H	2	MOD-SM90D-CON	L-Shaped Modco 90° Connector
J	2	MOD-180D-CON	Modco 180° Connector
G	2	MOD-90D-CON	Modco 90° Connector
I	2	MOD-CLA-CON	Modco Clamp Connector
7	2	MOD-SWP-992x2418-WHT	Modco Slatwall Panel 992mm x 2418mm
A	2	MOD-LV90D-CON	Modco Louver to Louver, 90° Connector
B	2	MOD-LV180D-CON	Modco Louver to Louver, 180° Connector
K	14	MOD-PC	Modco Pin Connector
C	2	MOD-180D-LV-CON	Modco L-Shaped 90° Connector to Louver
N/A	8	MOD-PNL-CON-B	Modco Panel Connector
N/A	8	MOD-PCWP-A	Modco Flathead Pin Connector

4

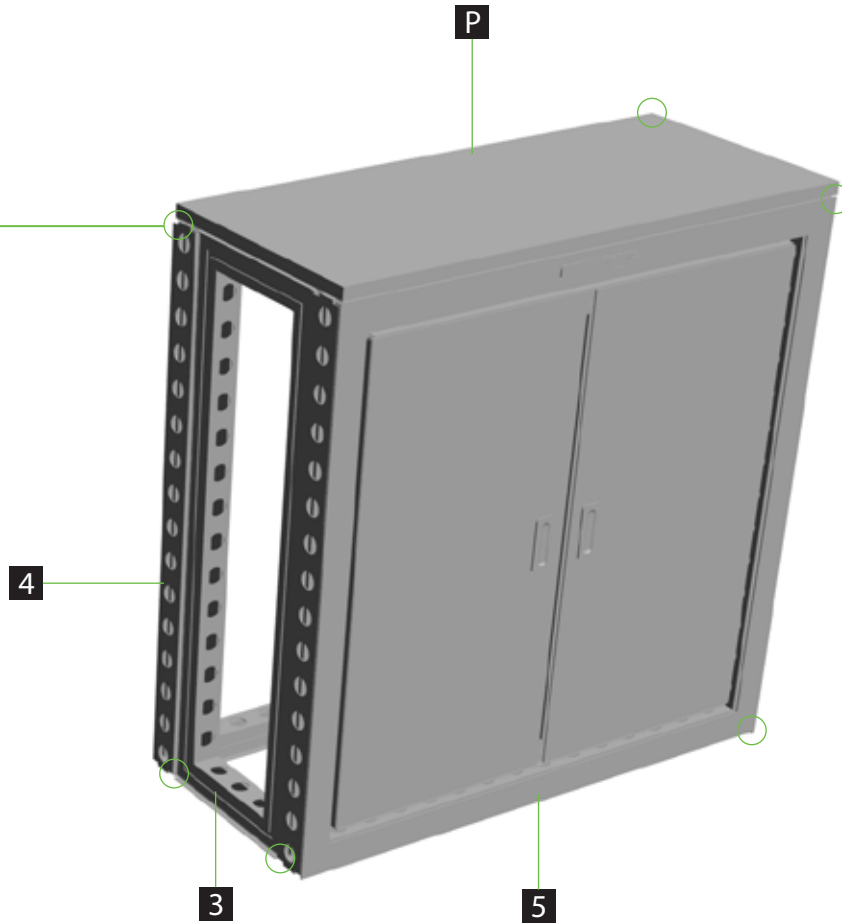
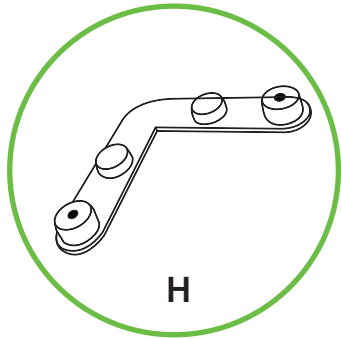

Name: Joey F.		Notes	
Date: Jul 3 2024		• Counter is independent - It does not attach to the main build.	
SKU build: MODCO23-20x10G		• Countertop does not require any hardware.	
Location: MX / PA		• Parts list is for a total of (2) counters.	
QC build: h/a (Standard)			
Step 4 PARTS LIST			
REF	QTY	PART NO.	DESCRIPTION
3	4	MOD-FRM-310x992	Straight Frame, 310mm x 992mm
4	2	MOD-FRM-992x992	Straight Frame, 992mm x 992mm
P	1	MOD-CTR-BM-992x434-WHT	White Counter Top Panel
H	16	MOD-SM90D-CON	L-Shaped 90° Connector
K	32	MOD-PC	Pin Connector
5	2	MOD-CTR-DOORS-992X992	Counter Doorset

5

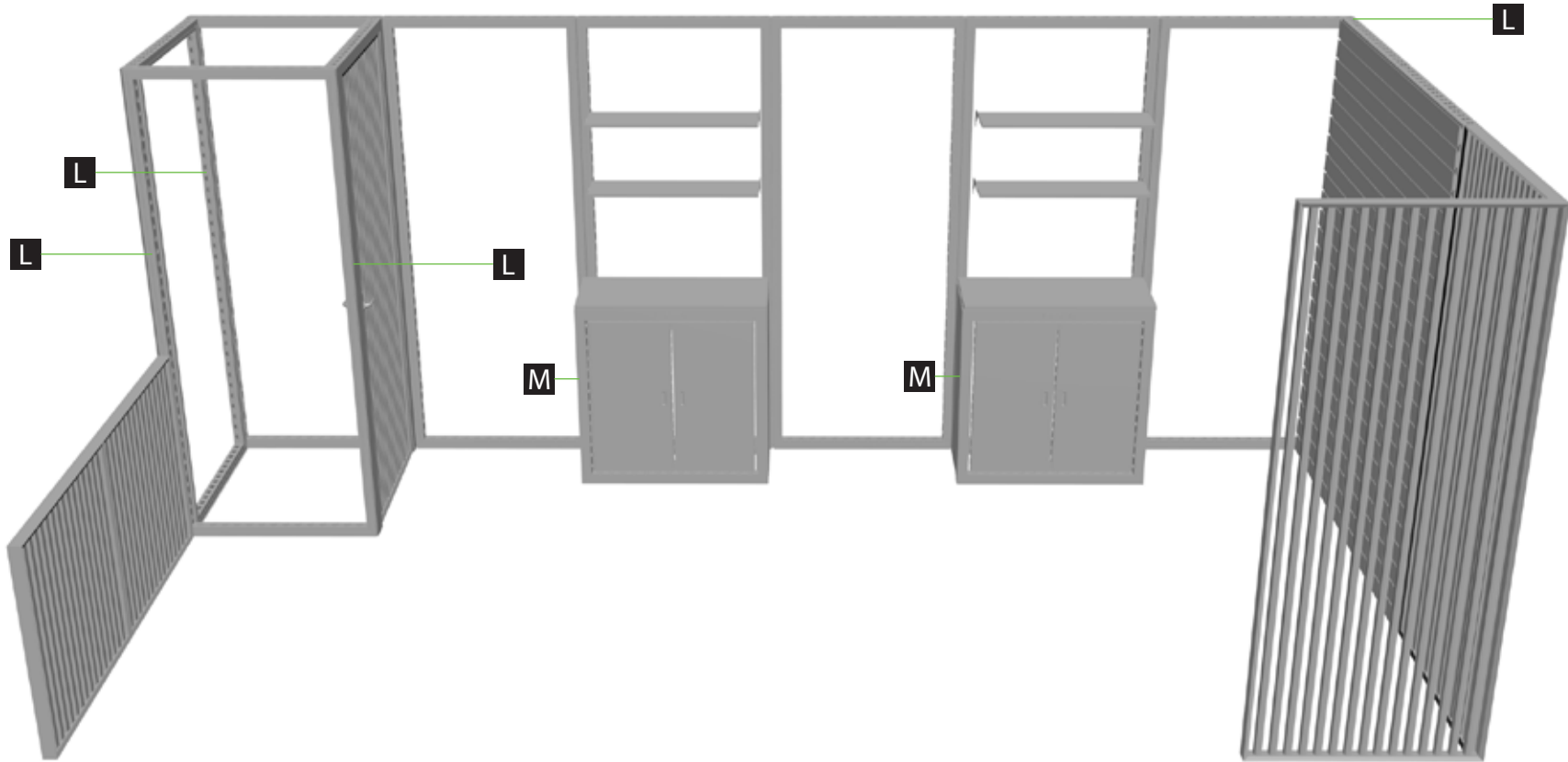



Name:	Joey F.	
Date:	Jul 3 2024	* Each counter uses (4) 992mm cover profiles.
SKU build:	MODCO23-20x10G	
Location:	MX / PA	
QC build:	n/a (Standard)	

REF	QTY	PART NO.	DESCRIPTION
L	4	MOD-CP-992x2418	Cover Profile 992mm (Total of 4)
M	8	MOD-CP-3100 (992mm)	Cover Profile 992mm (Total of 8)
N	36	MOD-CC	Cover Profile Clip Connector

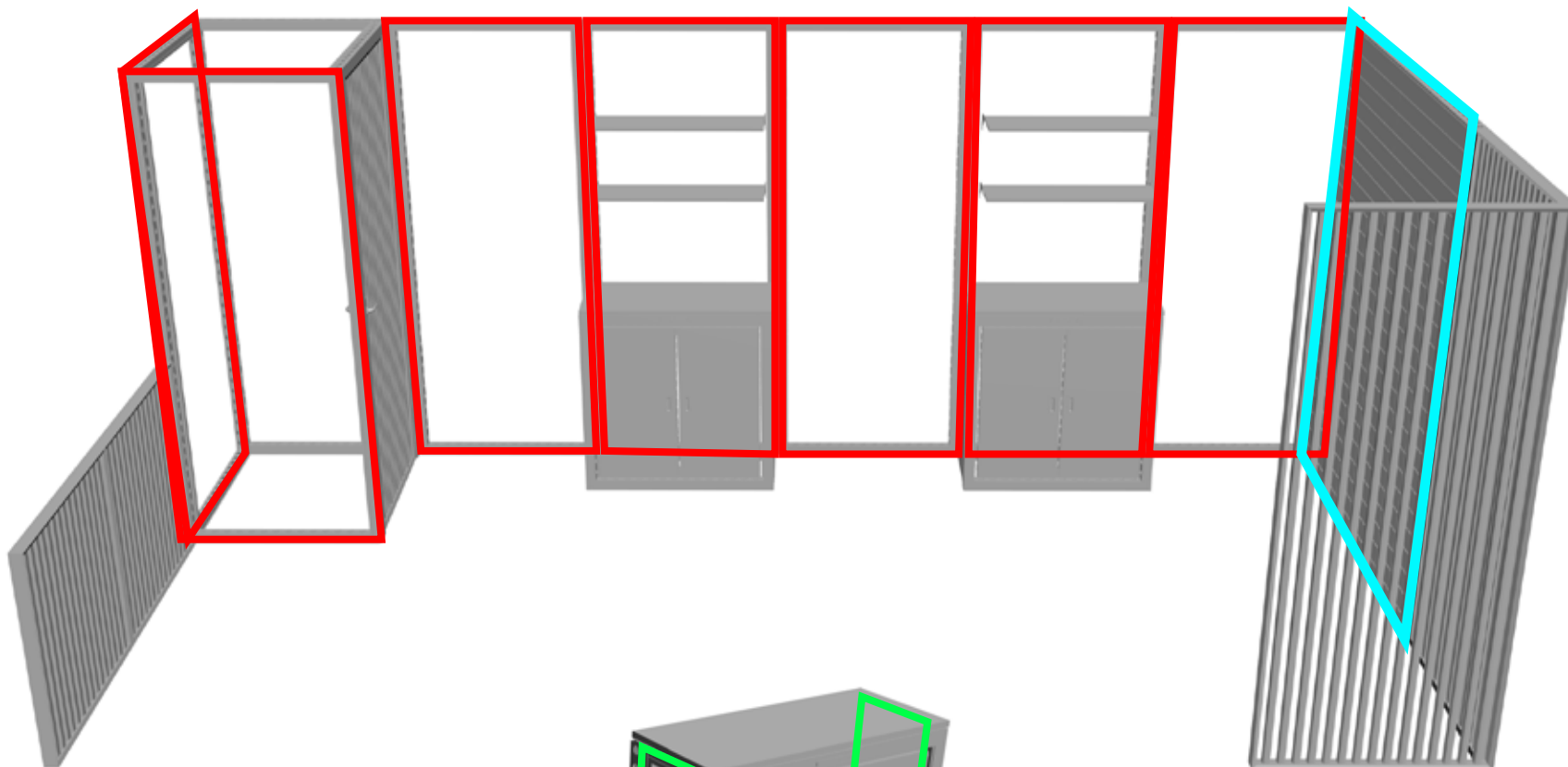
GRAPHIC REFERENCE



-  310 x 992 Qty.4
-  992 x 2418 Qty.7
-  1984 x 2418 Qty.1

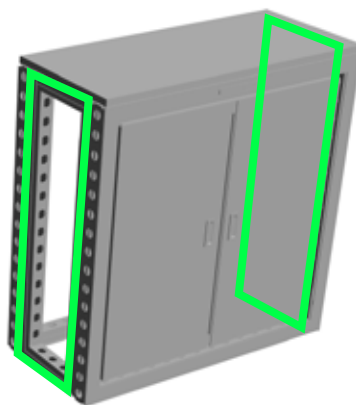

GRAPHIC INSTALL



Place graphic over the front of the frame.



Begin inserting SEG beading at each corner.

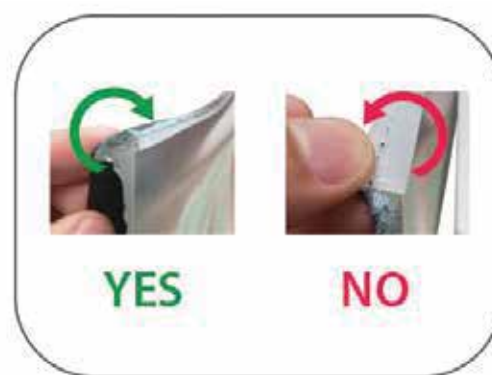

Insert the silicone beading with the fabric folded over. The silicone beading should not be exposed.

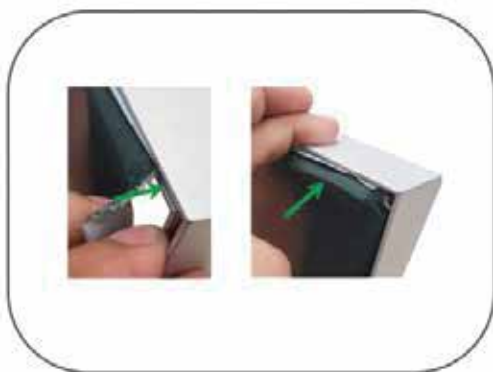

Using your fingers, push both fabric and silicone beading completely into the extrusions channel.



Continue to push in the remaining silicone beading on each side.



Check the perimeter of the frame for any excess beading that hasn't been pushed in. Graphic should be taut.