

MODCO25-10x10G

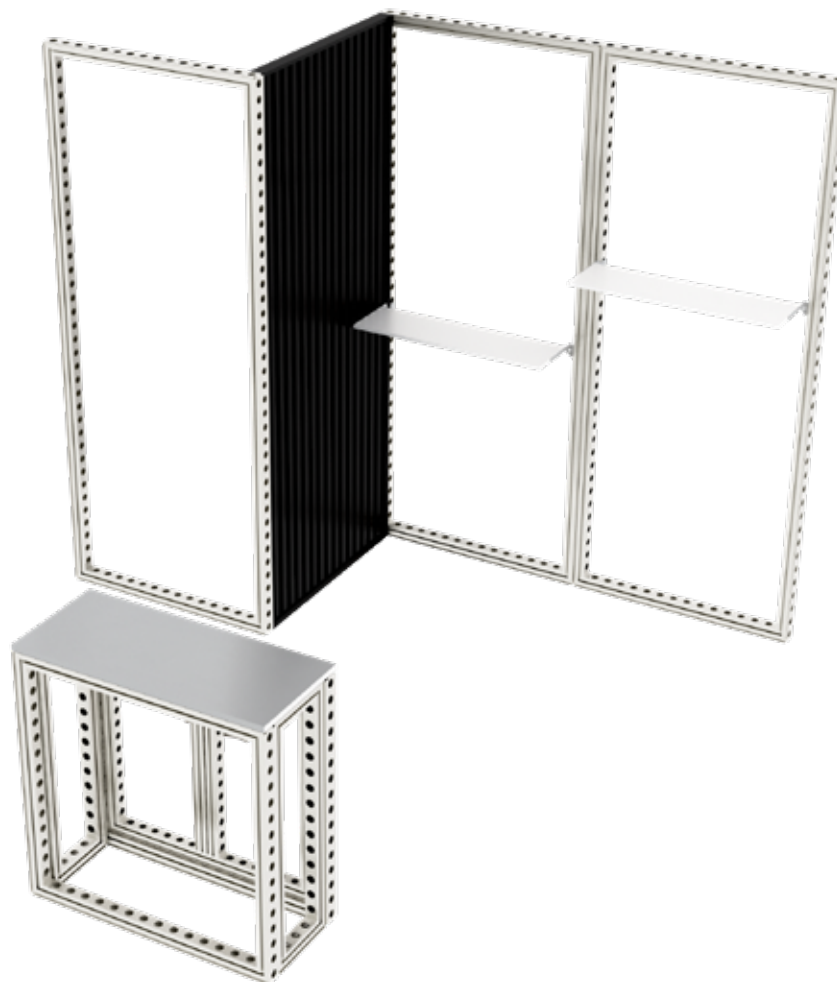

PARTS LIST



MOD-FRM-992x2418
Qty.3



MOD-SM90-LV-CON
Qty.4



MOD-FRM-310x992
Qty.2

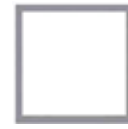

MOD-FRM-992x992
Qty.1



MOD-PNL-BM-984x301-WHT
Qty.2



MOD-FRM-992x2418-LV-BLK
Qty.1



MOD-SHELF-KIT-350mm
Qty.2



MOD-PCTV
Qty.4

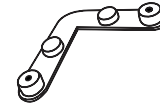

MOD-SM90D-CON
Qty.8



MOD-PCWP-A
Qty.4

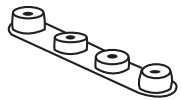

MOD-180D-CON
Qty.2



MOD-PC
Qty.32



MOD-CP-992x2418
Qty.4



MOD-CP-3100 (992mm)
Qty.4

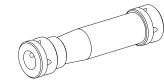

MOD-CLA-CON
Qty.2



MOD-CTR-DOORS-992X992
Qty.1



MOD-CTR-BM-992x434-WHT
Qty.1

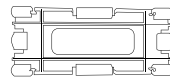

MOD-CC
Qty.20

CONNECTIONS

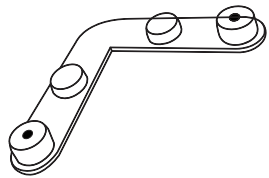

MOD-SM90D-CON / MOD-PC

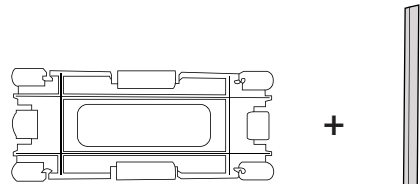
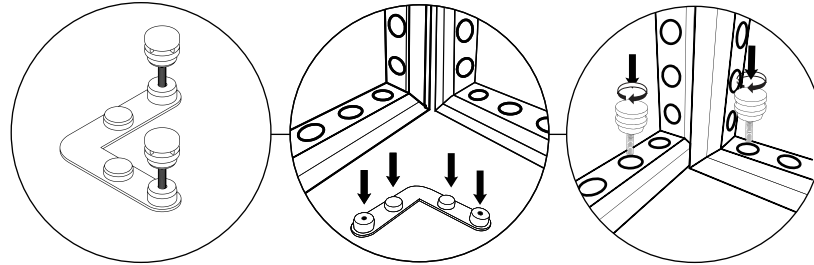

MOD-CC / MOD-CP

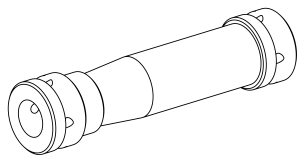
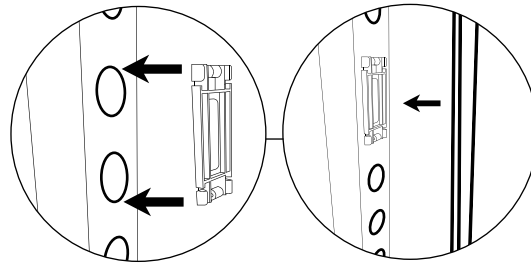

MOD-CLA-CON

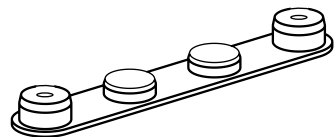
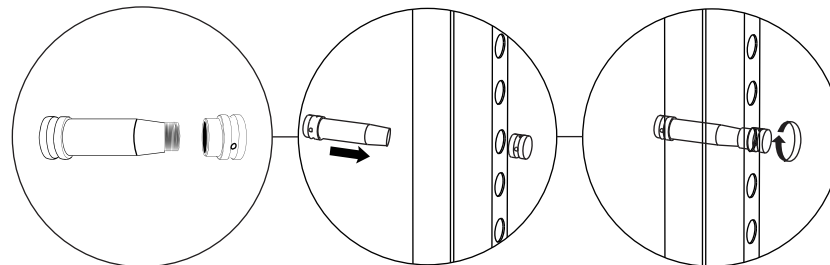

MOD-180D-CON / MOD-PC

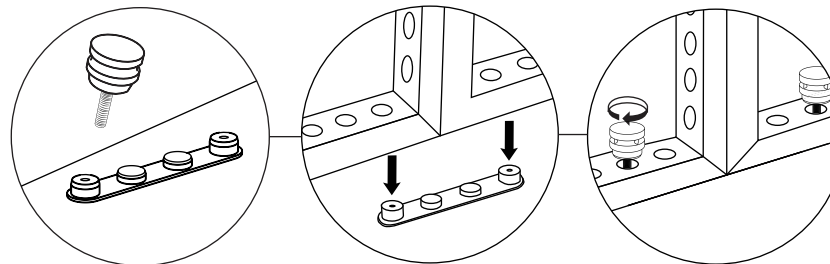

CONNECTIONS

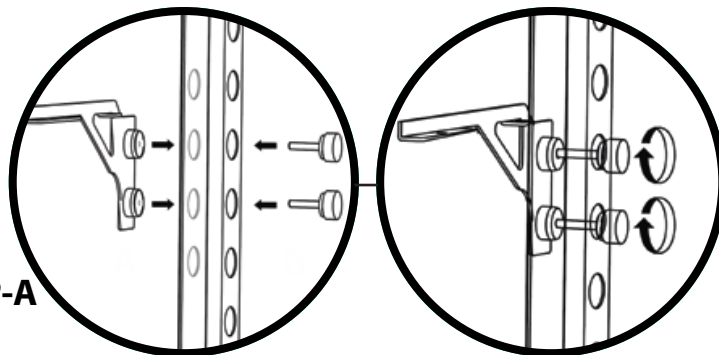
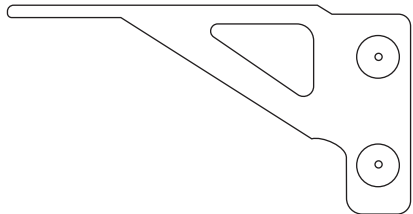

MOD-SHELF-KIT-350MM / MOD-PCWP-A

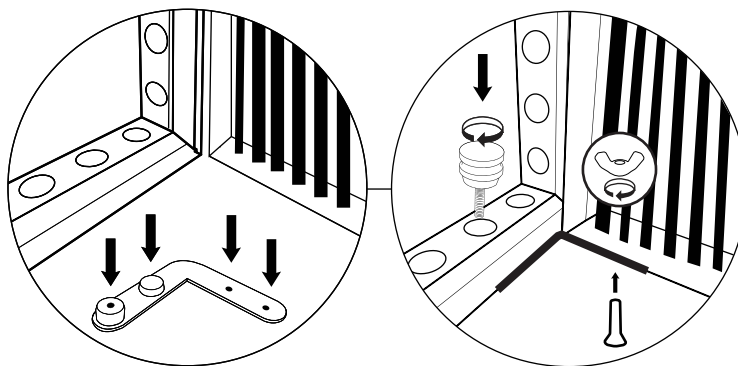
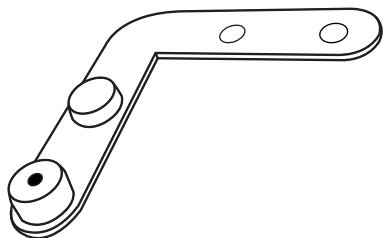

MOD-SM90-LV-CON / MOD-PC / WINGNUTS

1

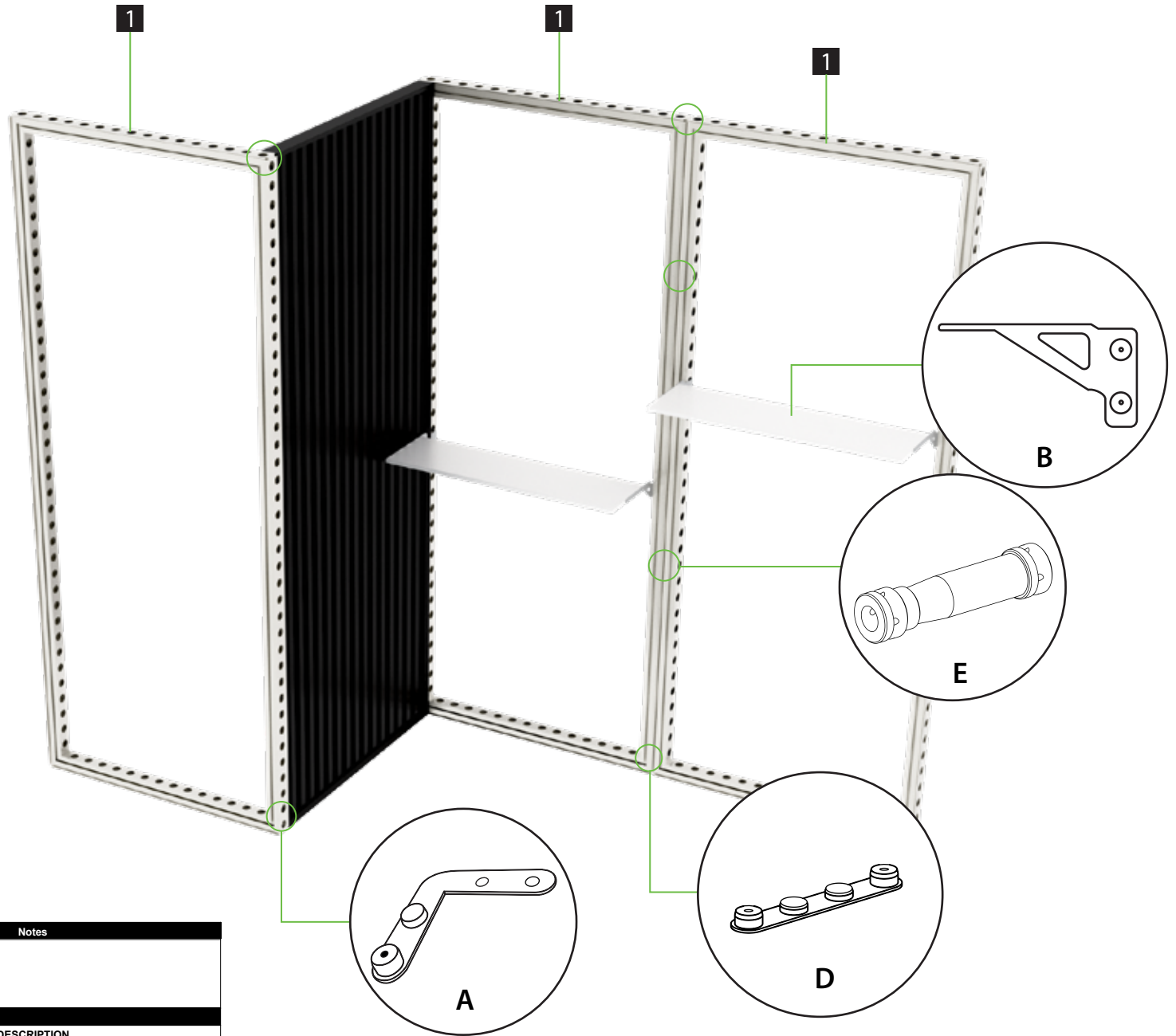

Name:	Joey F.	Notes	
Date:	Jul 11 2024		
SKU build:	MODCO25-10x10G		
Location:	MX / PA		
QC build:	n/a (Standard)		
Step 1 PARTS LIST			
REF	QTY	PART NO.	DESCRIPTION
1	3	MOD-FRM-992x2418	Straight Frame, Corner Screw Connect 992mm x 2418mm
2	1	MOD-FRM-992x2418-LV-BLK	Louver Frame, 992mm x 2418mm
A	4	MOD-SM90D-LV-CON	90 degree connector, for Louver to M frame
B	2	MOD-SHELF-KIT-350mm	Modco Shelf Bracket (Pair)
C	2	MOD-PNL-BM-984x301-WHT	Modco White Shelf Panel
D	2	MOD-180D-CON	180° Connector
E	2	MOD-CLA-CON	Clamp Connector
F	8	MOD-PC	Pin Connector
G	8	MOD-PCWP-A	Modco Flat Head Pin Connector

2

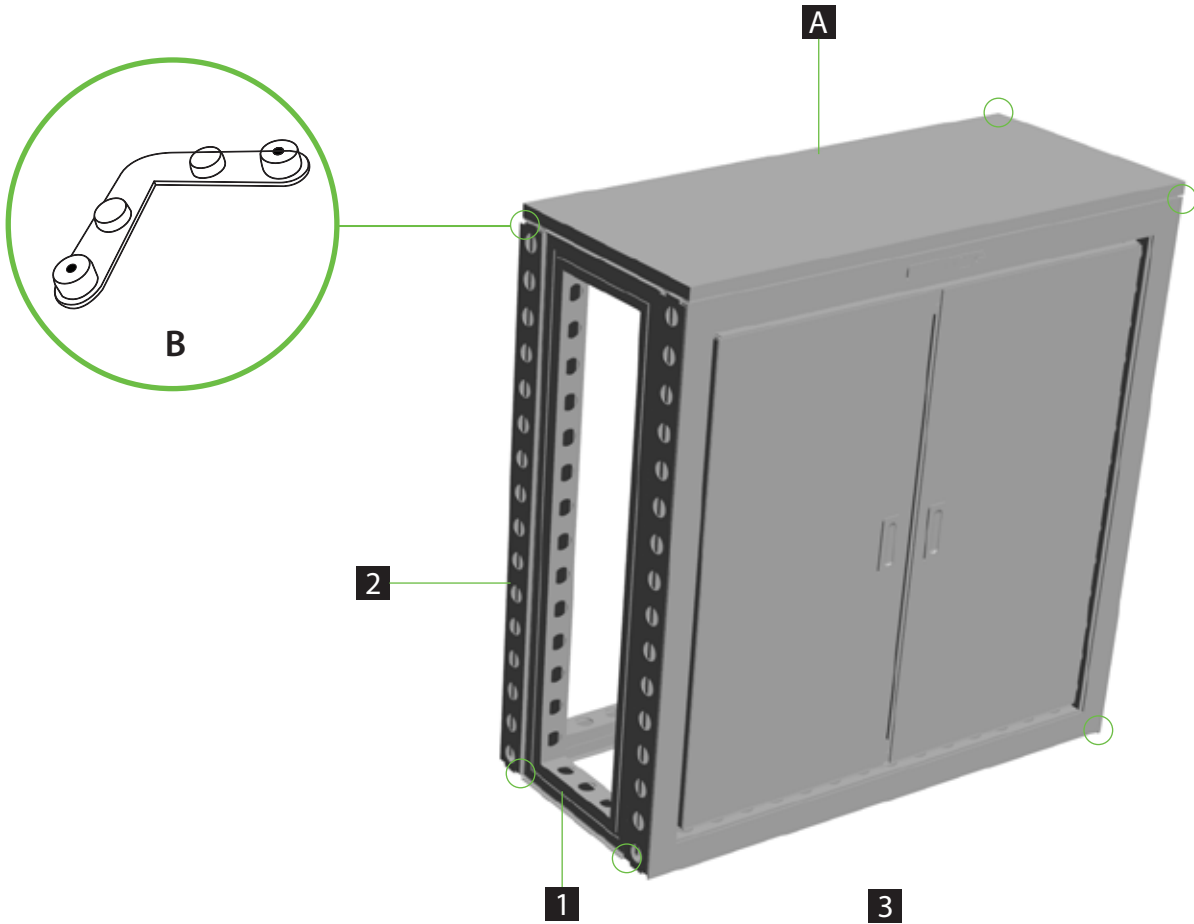

Name:	Joey F.	Notes
Date:	Jul 11 2024	<ul style="list-style-type: none"> • Counter is independent - It does not attach to the main build. • Countertop does not require any hardware
SKU build:	MODCO25-10x10G	
Location:	MX / PA	
QC build:	n/a (Standard)	

Step 2 PARTS LIST			
REF	QTY	PART NO.	DESCRIPTION
1	2	MOD-FRM-310x992	Straight Frame, 310mm x 992mm
2	1	MOD-FRM-992x992	Straight Frame, 992mm x 992mm
A	1	MOD-CTR-BM-992x434-WHT	White Counter Top Panel
B	8	MOD-SM90D-CON	L-Shaped 90° Connector
C	16	MOD-PC	Pin Connector
3	1	MOD-CTR-DOORS-992X992	Counter Doorset

3

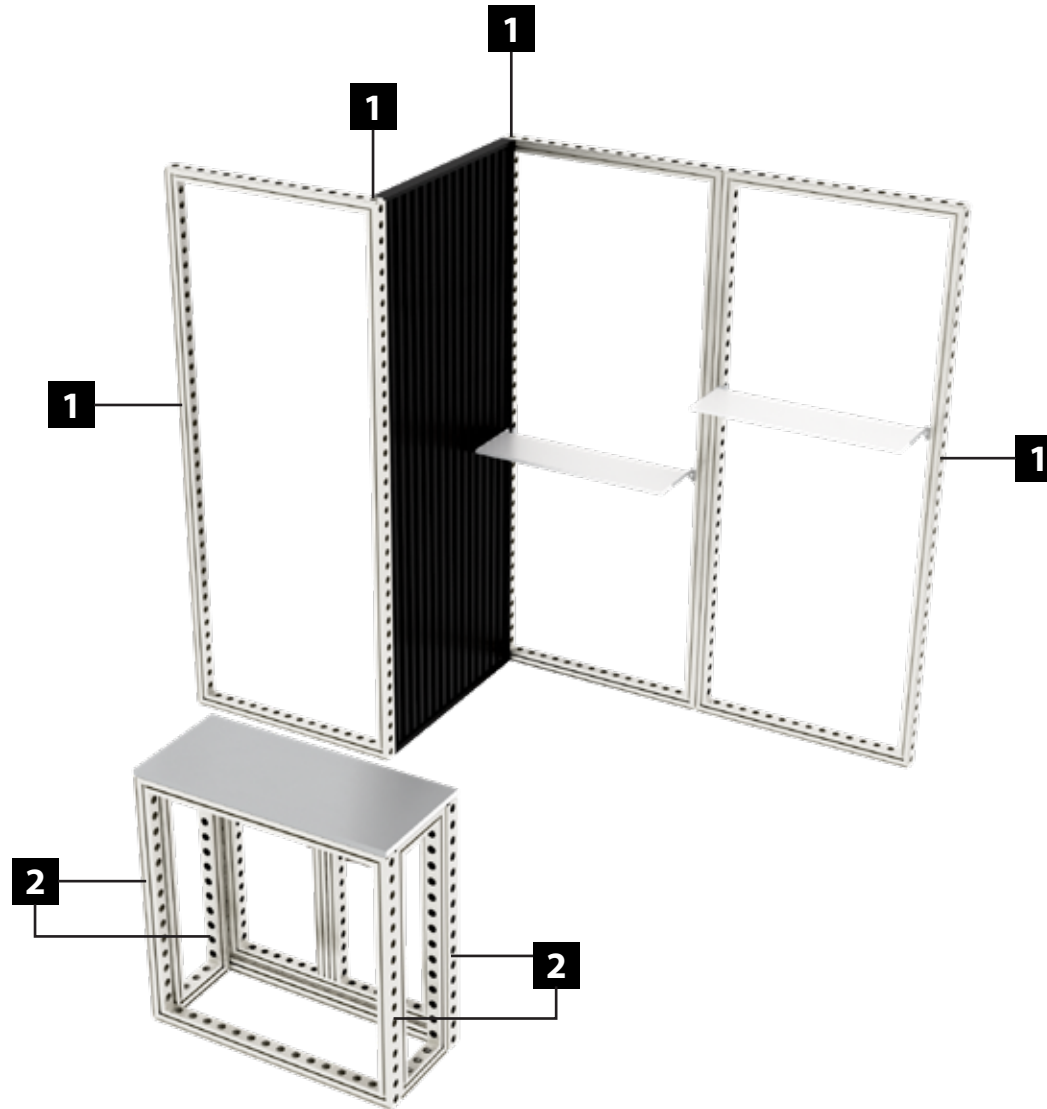



Name:	Joey F.
Date:	Jul 11 2024
SKU build:	MODCO25-10x10G
Location:	MX / PA
QC build:	n/a (Standard)

Step 3 PARTS LIST

REF	QTY	PART NO.	DESCRIPTION
1	4	MOD-CP-992x2418	Cover Profile 992mm (Total of 4)
2	4	MOD-CP-3100 (992mm)	Cover Profile 992mm (Total of 4)
3	20	MOD-CC	Cover Profile Clip Connector

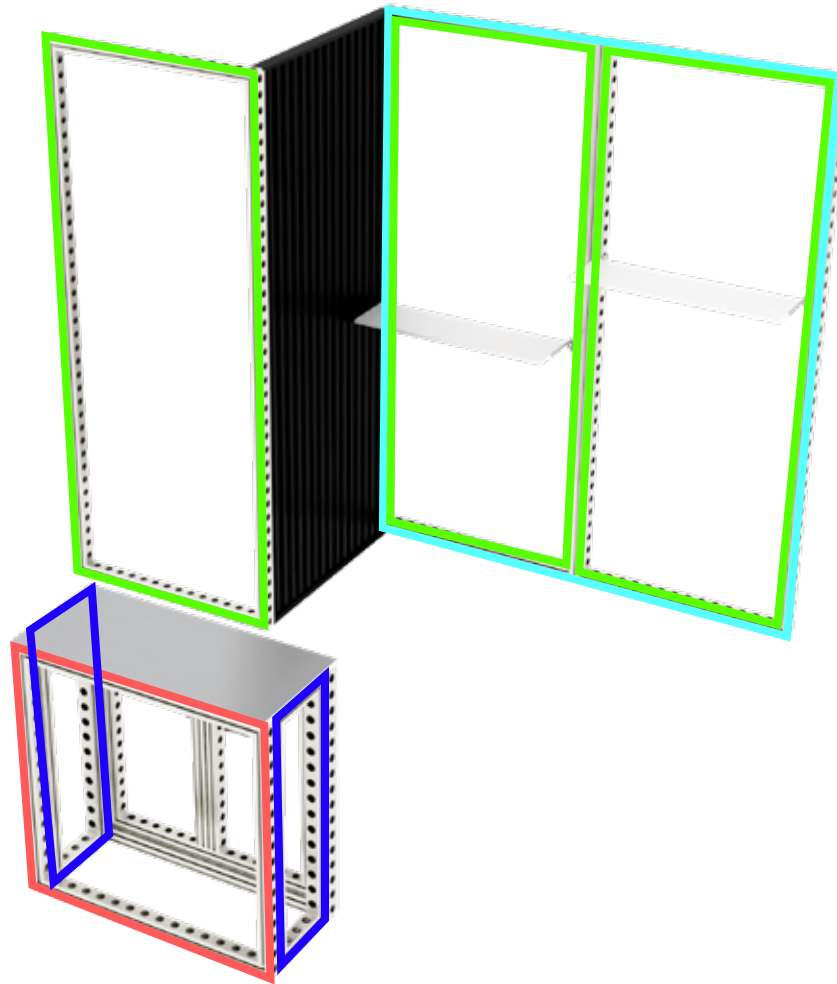
GRAPHIC REFERENCE



 310 x 992 Qty.2

 992 x 992 Qty.1

 992 x 2418 Qty.4

 1984 x 2418 Qty.1 (BACK)

GRAPHIC INSTALL



Place graphic over the front of the frame.



Begin inserting SEG beading at each corner.

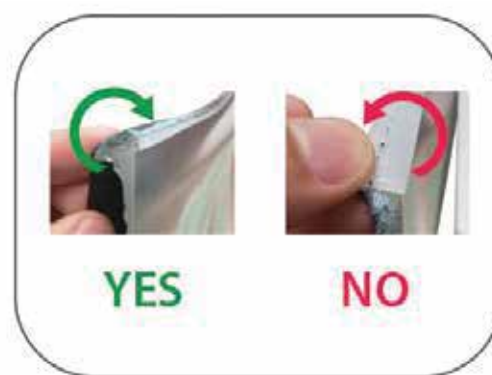

Insert the silicone beading with the fabric folded over. The silicone beading should not be exposed.

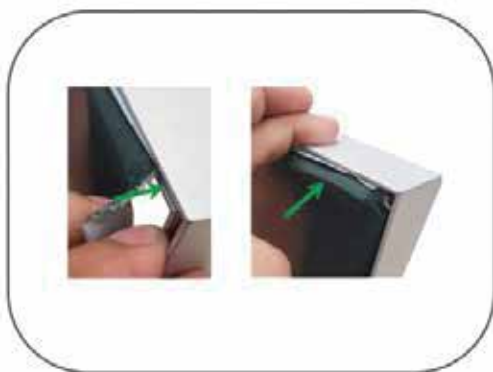

Using your fingers, push both fabric and silicone beading completely into the extrusions channel.



Continue to push in the remaining silicone beading on each side.



Check the perimeter of the frame for any excess beading that hasn't been pushed in. Graphic should be taut.