

MODCO 28-20 X 10

MODCO MODULAR EXHIBITS

PRODUCT CODE: MODCO28-20x10-G



Frame & Graphic

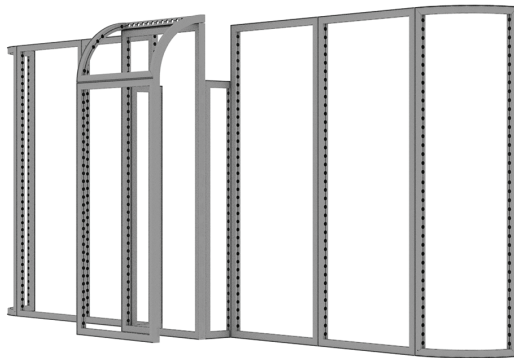

PRODUCT DESCRIPTION

Modco® Modular Display 28 is a three-dimensional pre-designed tower exhibit booth, ideal for a peninsula booth space. Stylish and lively, this booth is built using tool-free perforated modular aluminum frames along with rounded corners. Multiple size frames connect using tool-less pin connectors.

DISPLAY DIMENSIONS		234"W X 95"H X 60"D
GRAPHIC SIZES	SIZE	QTY
	12.12"W x 79.25"H	2
	79.25 x 96.25"H	2
	39"W x 31.25"H	1
	31.25"W x 96.25"H	2
	39"W x 96.25"H	1
	39"W x 79.25"H	1
TOTAL		9

GRAPHIC MATERIAL

Stretch Fabric w/ Integrated Block Out

GRAPHIC FINISHING

Silicone beading is sewn around the perimeter of the fabric graphic. Silicone beading is hidden from view once installed.

DISPLAY CONSTRUCTION

Aluminum frame and components

SHIPPING WEIGHTS & DIMENSIONS (FREIGHT ONLY)

Shipping Weight	909lbs w/ crate
Shipping Dimensions	102"L x 45"W x 58"H

GRAPHIC TURN AROUND TIME

4 business days after proof approval

AVAILABILITY	PFC / PA
--------------	----------

Parts List Key

FRAMES			
REF #	QTY	PART NO.	DESCRIPTION
A	5	MOD-FRM-992x2418	Straight Frame, Corner Screw Connect 992mm x 2418mm
B	2	MOD-FRM-310x1984	Straight Frame, Corner Screw Connect 310mm x 1984mm
C	1	MOD-FRM-992x1984	Straight Frame, Corner Screw Connect 992mm x 1984mm
D	1	MOD-CRVFRM-774x992	1/4 Curved Frame, welded 774mm x 992mm
E	2	MOD-CRVFRM-774x2418	1/4 Curved Frame, welded 774mm x 2418mm

CONNECTORS, ACCESSORIES & COVER PROFILES			
REF #	QTY	PART NO.	DESCRIPTION
1	10	MOD-CLA-CON	Clamp Connector
2	3	MOD-CRV-180DCR	Modco Curve 180° (Right)
3	3	MOD-CRV-180DCL	Modco Curve 180° Connector (Left)
4	24	MOD-PC	Pin Connector
5	10	MOD-90D-CON	90° Connector
6	2	MOD-CP-992x2418	Cover Profile for Frame 992x2418. Flat Model. Anodized
7	2	MOD-CP-3100	Cover Profile 78" length
8	10	MOD-CC	Clip Connector Cover Connects Cover Profile
9	2	MOD-CP-774	Curved Cover profile 774mm(R1/4)
10	4	MOD-PCWP-B	Pin connector(use with profile cover)
11	4	MOD-SN-28MM	28mm screw nut
12	4	MOD-180D-CON	180° Connector

PARTS REFERENCE

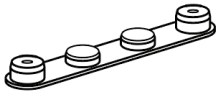

180° Connector
MOD-180D-CON
Qty.8



28mm Screw Nut
MOD-SN28MM
Qty.4



Pin Connector
MOD-PC
Qty.24

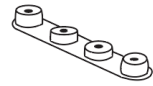

180° Curved Connector
MOD-CRV-180DCL Qty.3
MOD-CRV-180DCR Qty.3

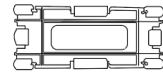

Clip Connector
MOD-CC
Qty.10

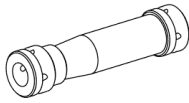

Clamp Connector
MOD-CLA-CON
Qty.10

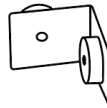

90° Connector
MOD-90D-CON
Qty.10



1/4 Curved Cover Profile
MOD-CP-774
Qty.2



78" Cover Profile
MOD-CP-3100
Qty.2



95" Cover Profile
MOD-CP-3100
Qty.2



774 x 2418 Curved
MOD-CRVFRM-774x992
Qty.2



992 x 1984
MOD-FRM-992x1984
Qty.1



992 x 2418
MOD-FRM-992x2418
Qty.s



310 x 1984
MOD-FRM-310x1984
Qty.2

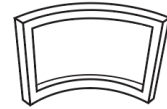

774 x 992
MOD-CRVFRM-774x992
Qty.1

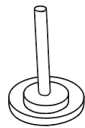

Pin Connector for Profile Cover
MOD-PCWP-B
Qty.4

INSTRUCTIONS

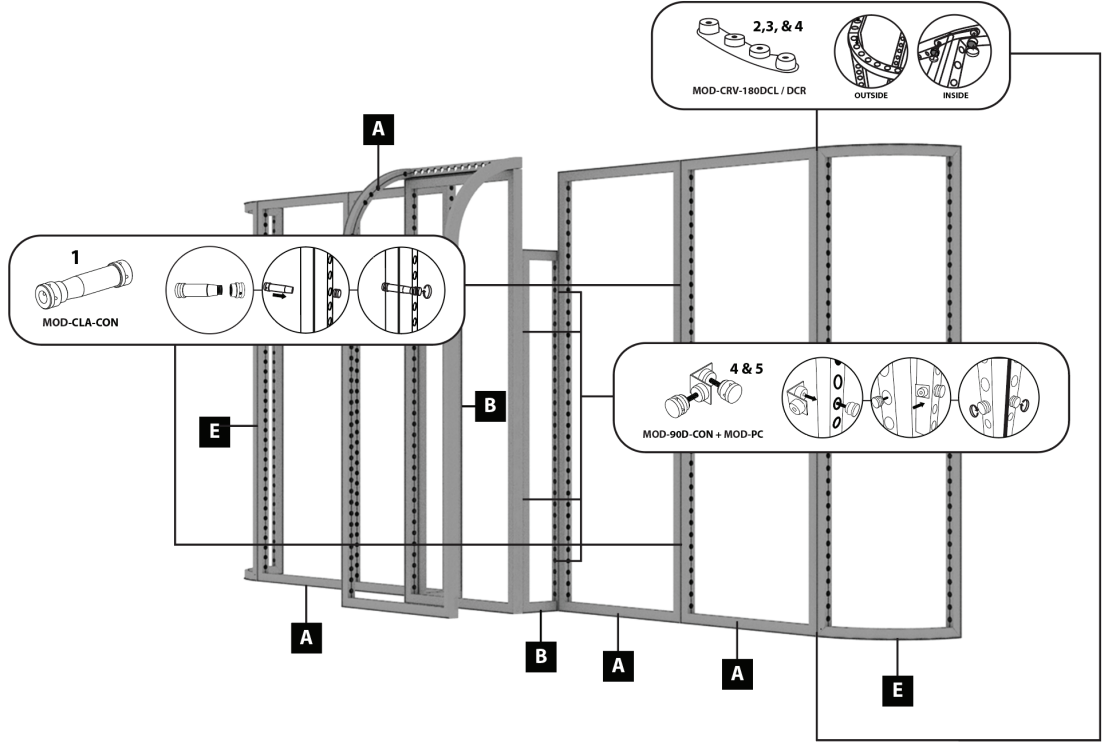
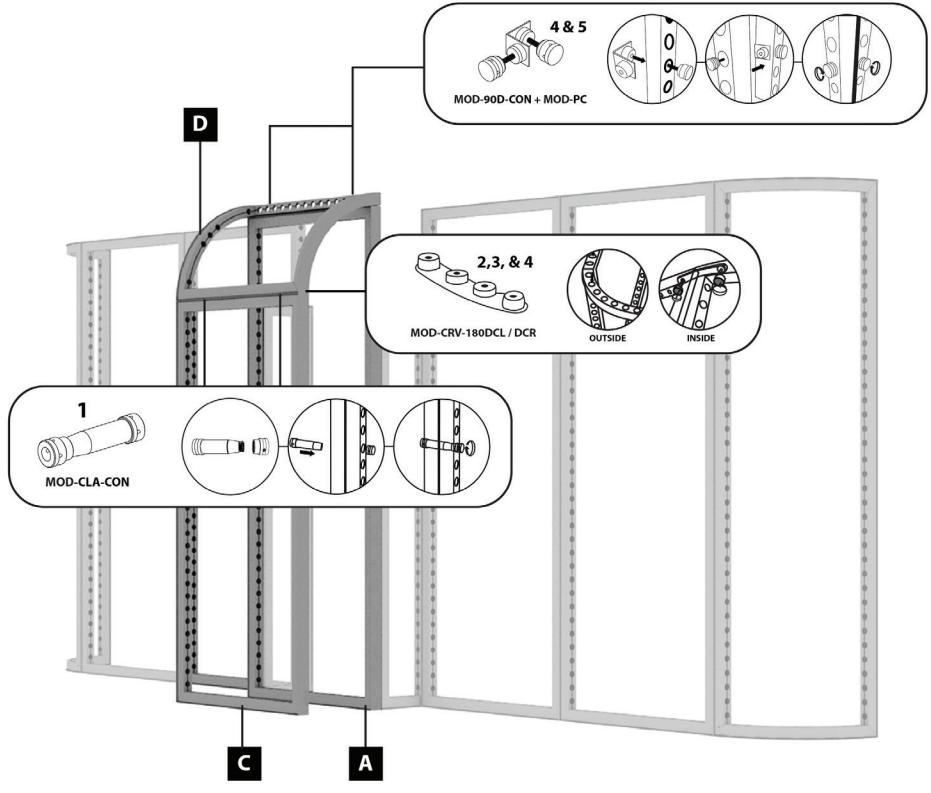

INSTRUCTIONS

Cover Profiles

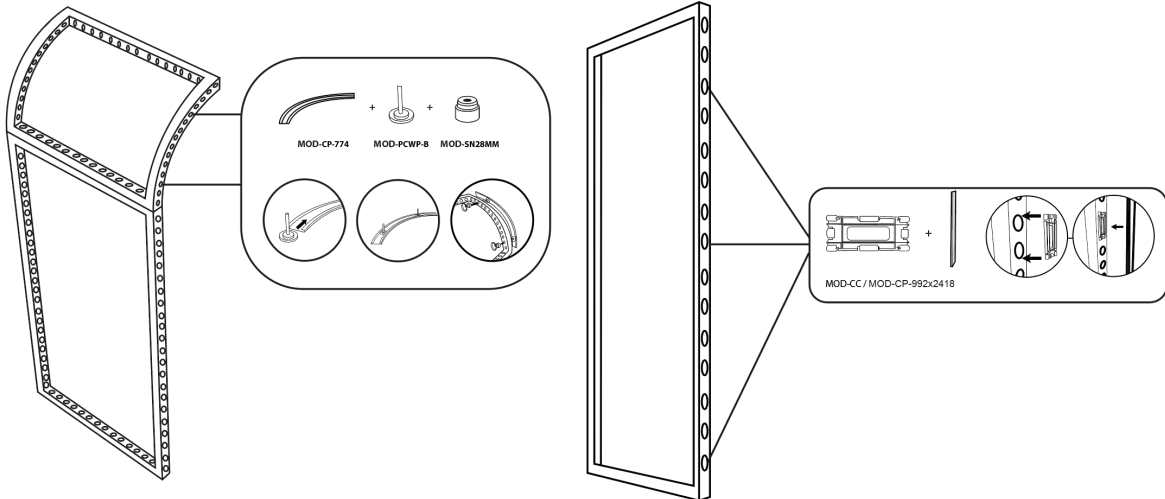

GRAPHIC REFERENCES



Place graphic over the front of the frame.



Begin inserting SEG beading at each corner.

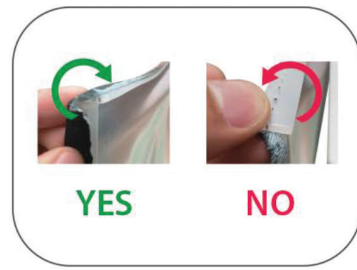

Insert the silicone beading with the fabric folded over. The silicone beading should not be exposed.

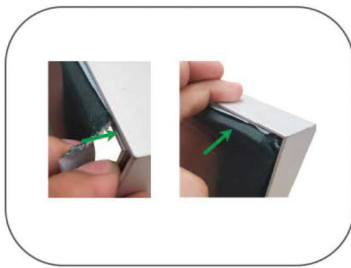

Using your fingers, push both fabric and silicone beading completely into the extrusions channel.

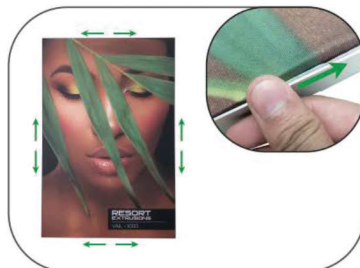

Continue to push in the remaining silicone beading on each side.



Check the perimeter of the frame for any excess beading that hasn't been pushed in. Graphic should be taut.