

MODCO 30 - 10X10

MODCO MODULAR EXHIBITS
PRODUCT CODE: MODCO30-10x10G



Frame & Graphic



PRODUCT DESCRIPTION

Modco® Modular Display 30 is a three-dimensional pre-designed backwall exhibit booth, ideal for a peninsula booth space. Stylish and lively, this booth is built using tool-free perforated modular aluminum frames along with rounded corners. Multiple size frames connect using tool-less pin connectors.

DISPLAY DIMENSIONS	117"W X 96"H X 96"D	
GRAPHIC SIZES	SIZE	QTY
	79.25"W x 96.25"H	1
	118.25 x 96.25"H	1
	39"W x 96.25"H	3
	58.5"W x 39"H	2
TOTAL	7	

GRAPHIC MATERIAL

Stretch Fabric w/ Integrated Block Out

GRAPHIC FINISHING

Silicone beading is sewn around the perimeter of the fabric graphic. Silicone beading is hidden from view once installed.

DISPLAY CONSTRUCTION

Aluminum frame and components

SHIPPING WEIGHTS & DIMENSIONS (FREIGHT ONLY)

Shipping Weight	204lbs w/ pallet
Shipping Dimensions	96"L x 40"W x 23"H

GRAPHIC TURN AROUND TIME

4 business days after proof approval

AVAILABILITY	PFC / PA
--------------	----------

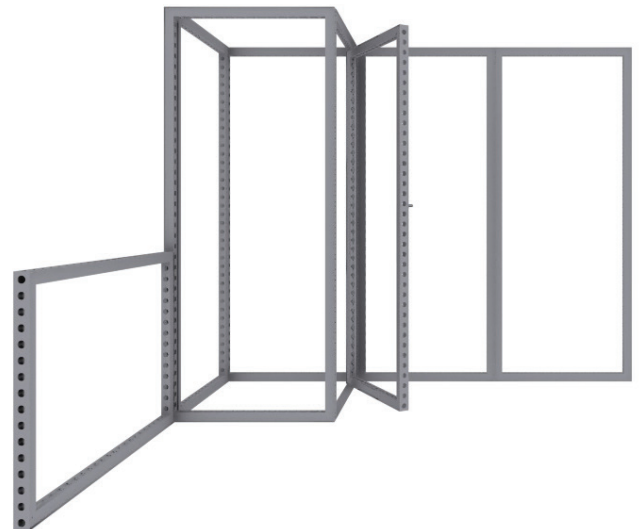

PARTS REFERENCE

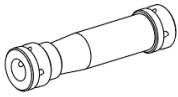

MOD-CLA-CON
Qty.2

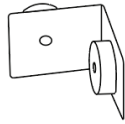

MOD-90D-CON
Qty.8

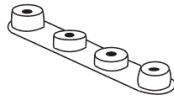

MOD-180D-CON
Qty.4

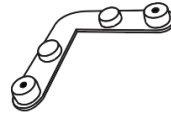

MOD-SM90D-CON
Qty.4



MOD-FRM-992x2418
Qty.5



MOD-PC
Qty.36



MOD-FRM-992x1488
Qty.1

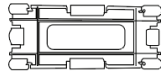

MOD-CC
Qty.16



MOD-CP-992x2418
Qty.4



MOD-CP-3100 (39")
Qty.1

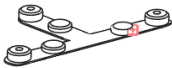

MOD-T90D-CON
Qty.1



MOD-DSWL-992x2418
Qty.1



MOD-CP-3100 (55")
Qty.1



MOD-PCWP-A
Qty.6

INSTRUCTIONS

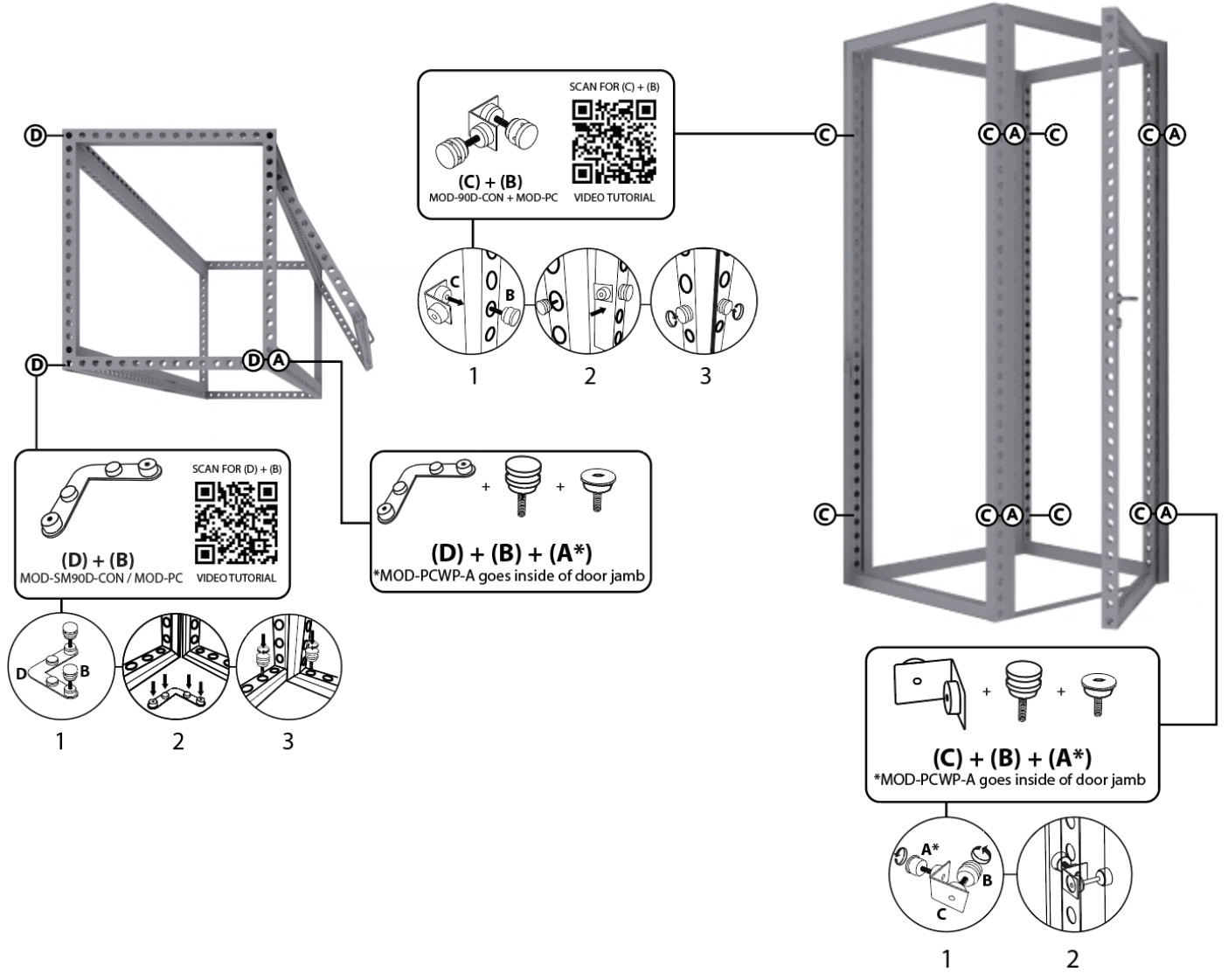

SCAN FOR (C) + (B)

(C) + (B)
MOD-90D-CON + MOD-PC VIDEO TUTORIAL

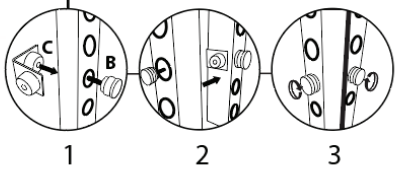

SCAN FOR (D) + (B)

(D) + (B)
MOD-SM90D-CON / MOD-PC VIDEO TUTORIAL

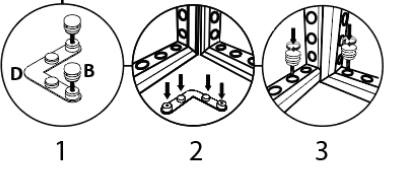

(D) + (B) + (A*)
*MOD-PCWP-A goes inside of door jamb

(C) + (B) + (A*)
*MOD-PCWP-A goes inside of door jamb

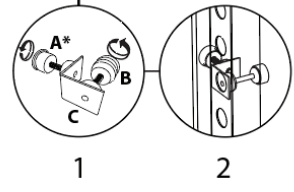

INSTRUCTIONS

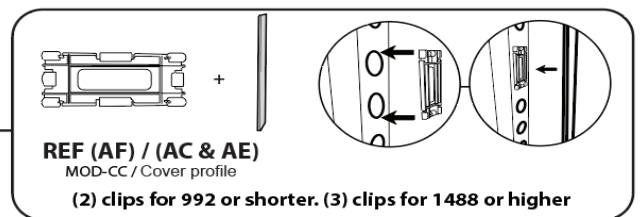
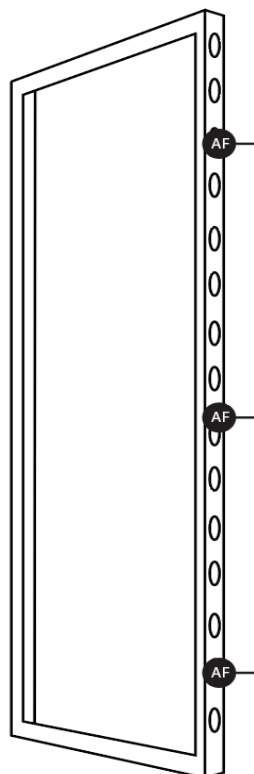
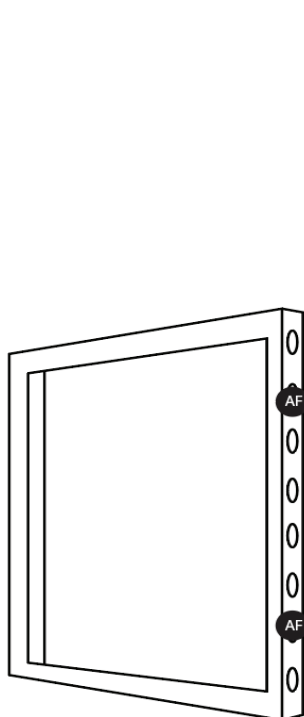
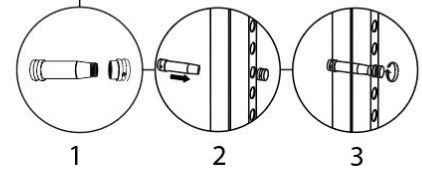
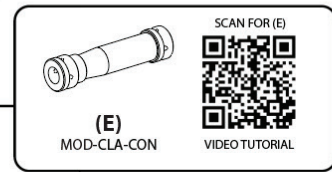
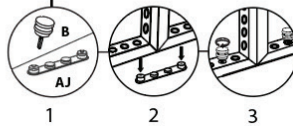
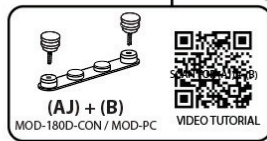
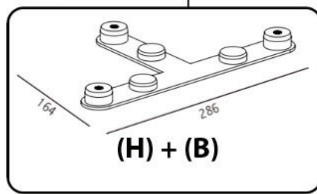
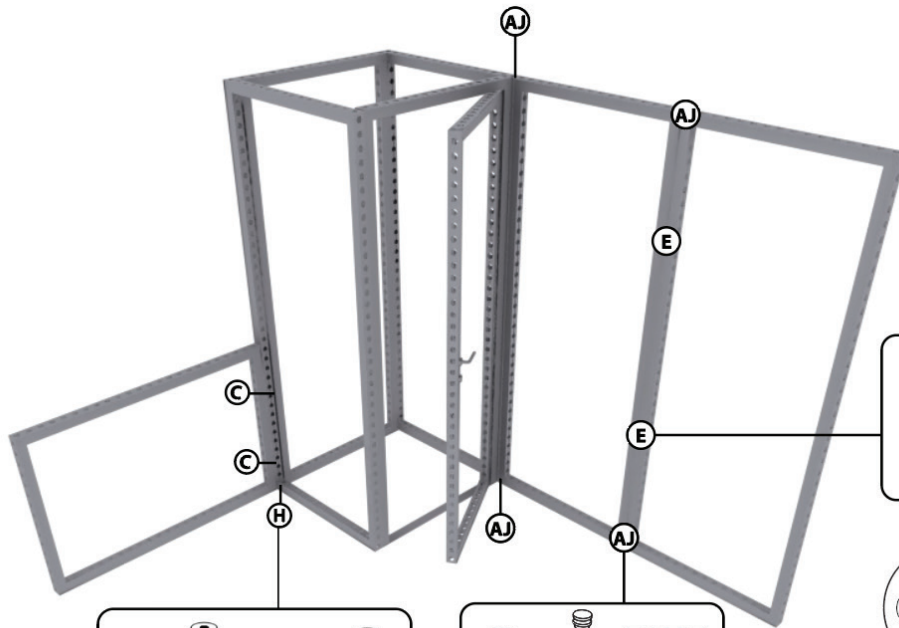

GRAPHIC REFERENCES



Place graphic over the front of the frame.

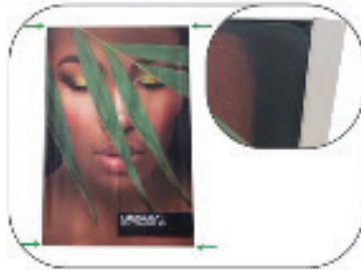

Begin inserting SEG beading at each corner.

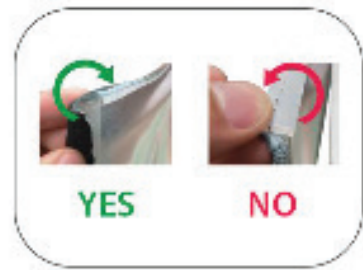

Insert the silicone beading with the fabric folded over. The silicone beading should not be exposed.

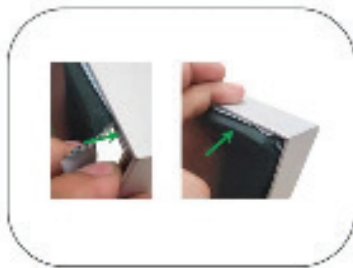

Using your fingers, push both fabric and silicone beading completely into the extrusions channel.

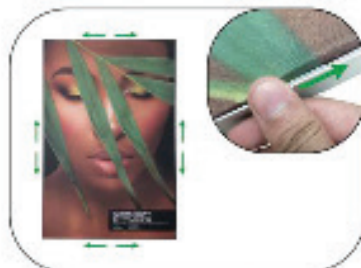

Continue to push in the remaining silicone beading on each side.



Check the perimeter of the frame for any loose beading that hasn't been pushed in. Graphic should be taut.

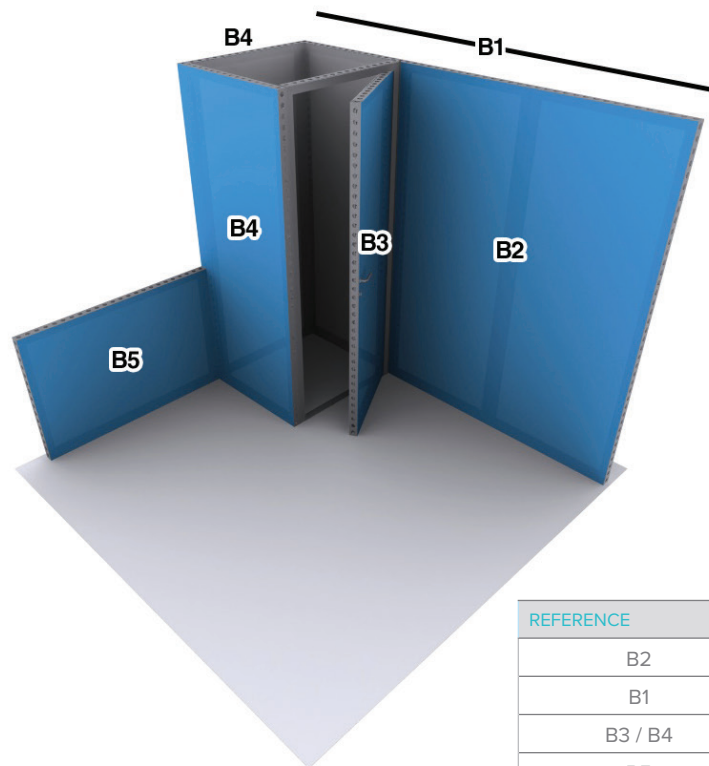

REFERENCE	SIZE	QTY
B2	79.25"W x 96.25"H	1
B1	118.25 x 96.25"H	1
B3 / B4	39"W x 96.25"H	3
B5	58.5"W x 39"H	2