

**MODCO 32 - 10 x 20G**

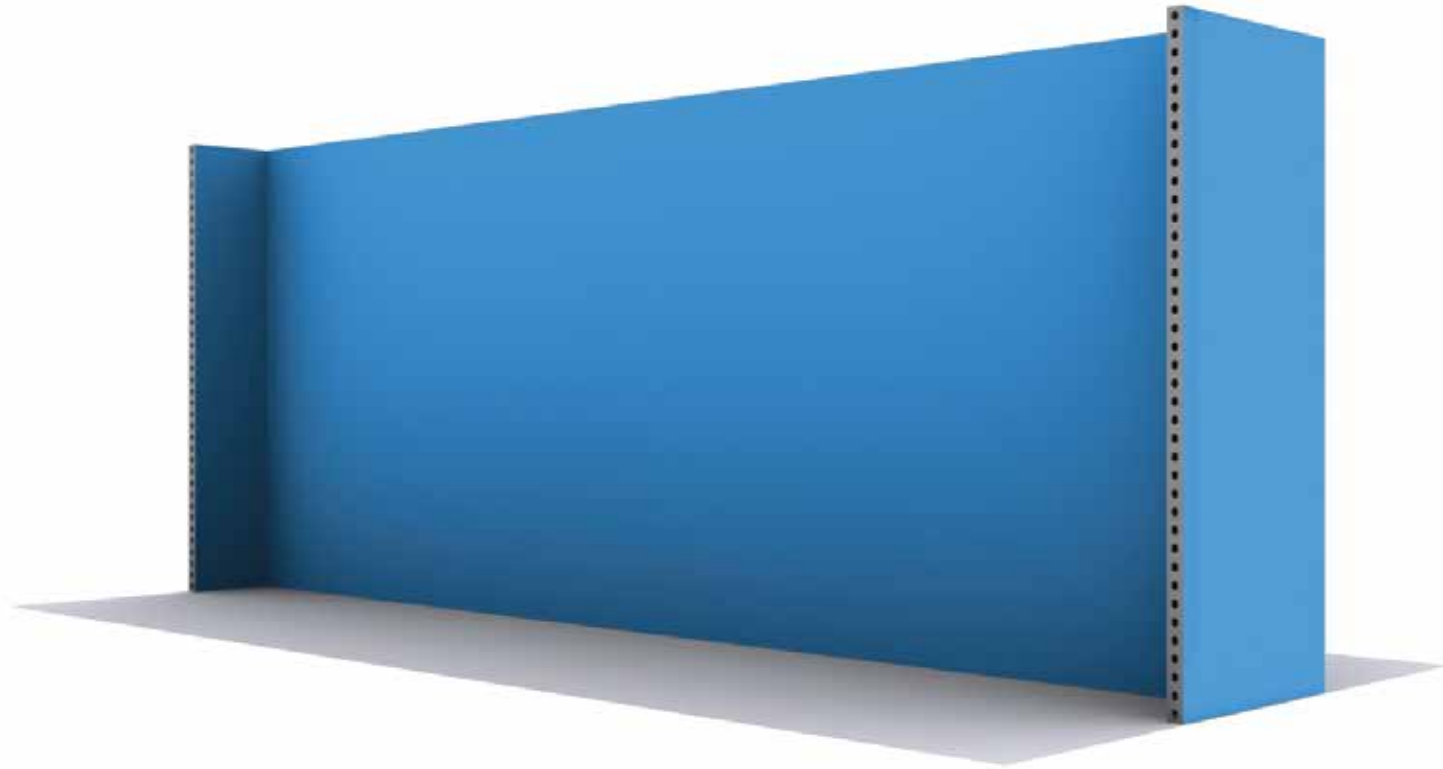

# Backwall / Returns

- Use letter in REF column and parts list for reference.

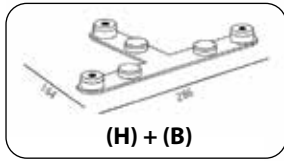

992 x 2418 FRAME

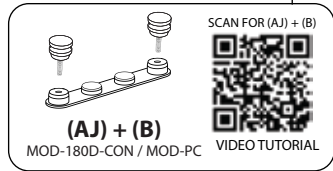
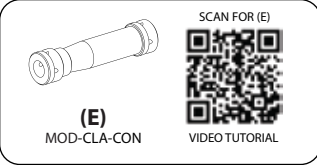
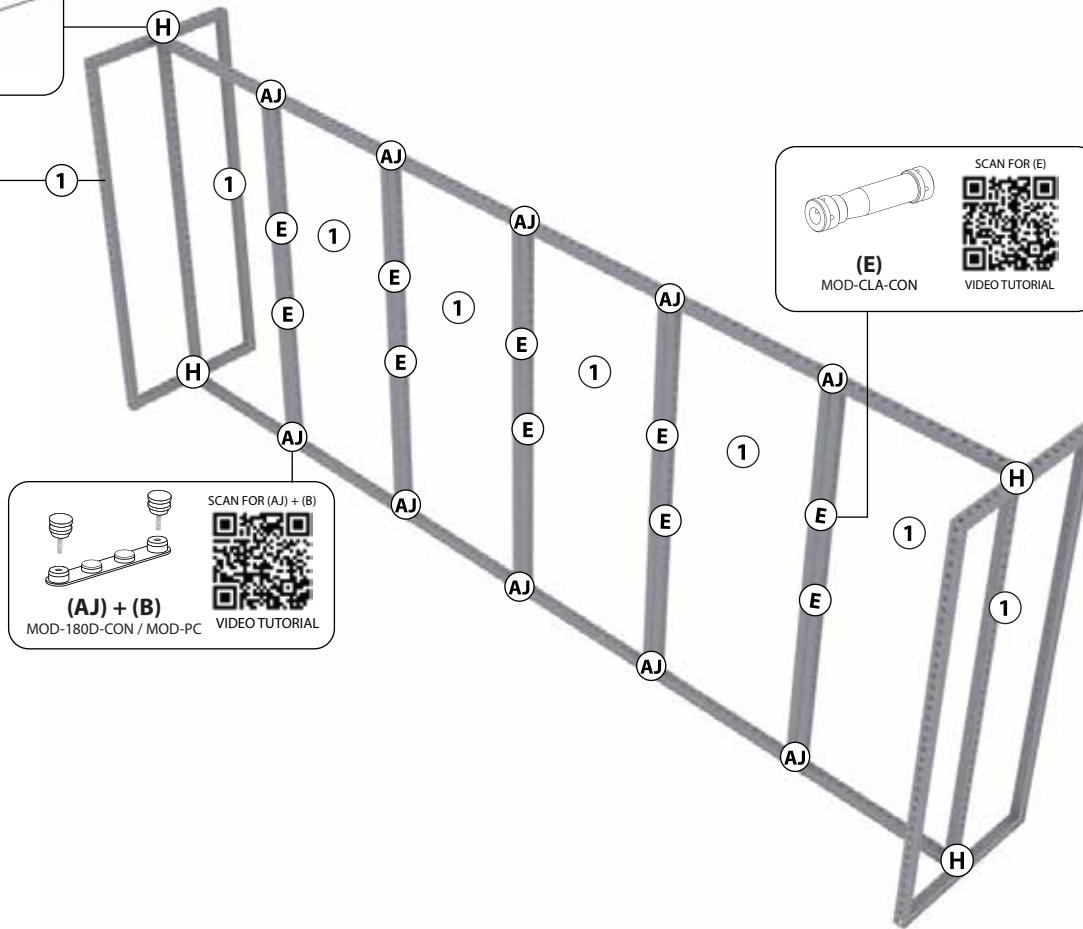

## CONFIGURATION PARTS LIST

REF	QTY	PART NO.	DESCRIPTION
1	8	MOD-FRM-992x2418	Straight Frame, Corner Screw Connect 992mm x 2418mm
E	10	MOD-CLA-CON	Clamp Connector (additional 2 added)
AJ	10	MOD-180D-CON	180 Degree Connector(additional 2 added)
B	32	MOD-PC	Pin Connector (additional 2 added)
H	4	MOD-T-90DCON	T Shape 3 Way 90 Degree Connector (additional 2 added)

# Cover Profiles

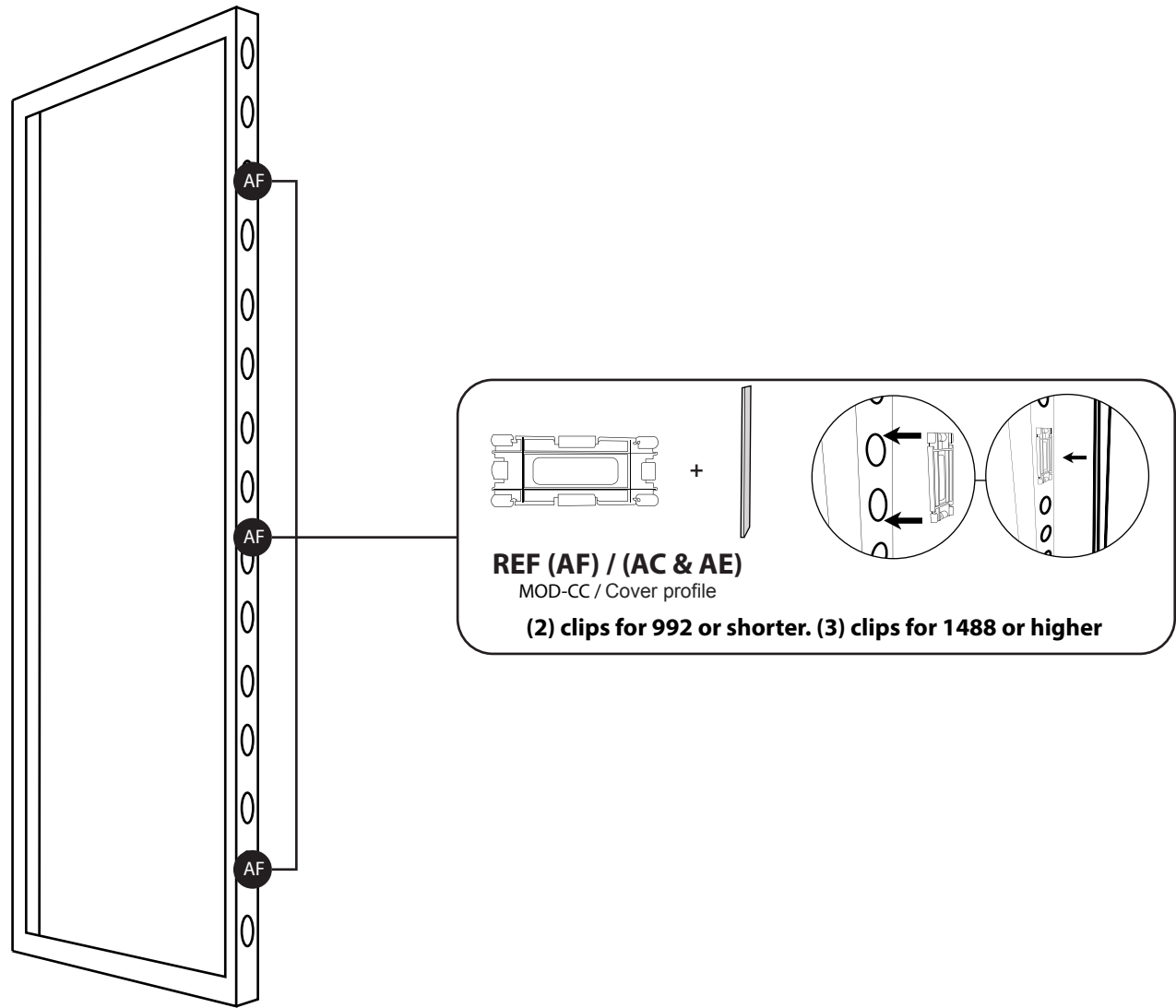

## COVER PROFILES LIST

AC	4	MOD-CP-992x2418	Cover Profile for Frame 992x2418. Flat Model. Anodized
AF	12	MOD-CC	Clip Connector Cover Connects Cover Profile
AL	28	MOD-FP	Modco Frame Protector

# GRAPHIC INSTALL



Place graphic over the front of the frame.



Begin inserting SEG beading at each corner.

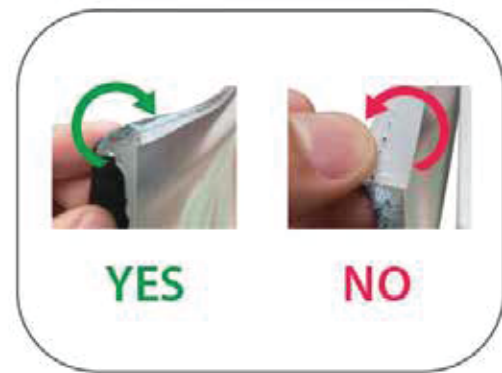

Insert the silicone beading with the fabric folded over. The silicone beading should not be exposed.

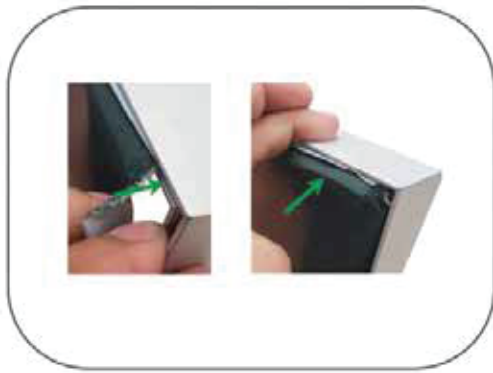

Using your fingers, push both fabric and silicone beading completely into the extrusions channel.



Continue to push in the remaining silicone beading on each side.



Check the perimeter of the frame for any excess beading that hasn't been pushed in. Graphic should be taut.

# PARTS LIST

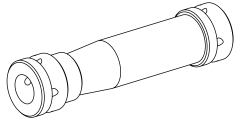

**Clamp Connector**  
MOD-CLA-CON  
Qty.10

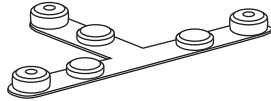

**T Connector**  
MOD-T-90DCON  
Qty.4

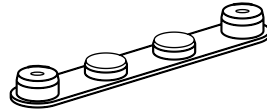

**180° Connector**  
MOD-180D-CON  
Qty.10

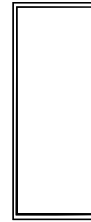

**992 x 2418**  
MOD-FRM-992x2418  
Qty.8



**95" Cover Profile**  
MOD-CP-992x2418  
Qty.4

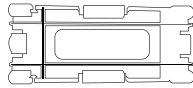

**Clip Connector**  
MOD-CC  
Qty.12

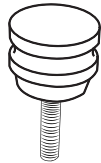

**Pin Connector**  
MOD-PC  
Qty.32