

# MODCO 32 - 20 X 10

MODCO MODULAR EXHIBITS  
 PRODUCT CODE: MODCO32-20x10G



## PRODUCT DESCRIPTION

Modco® Modular Display 32 is a three-dimensional pre-designed backwall exhibit, ideal for a 20' booth space. Stylish and lively, this booth is built using tool-free perforated modular aluminum frames along with rounded corners. Multiple size frames connect using tool-less pin connectors making setup a breeze!

DISPLAY DIMENSIONS		234"W X 95"H X 39"D	
GRAPHIC SIZES	SIZE	QTY	
	39"W x 96.25"H	4	
	234" x 96.25"H	2	
TOTAL		6	

## GRAPHIC MATERIAL

Stretch Fabric w/ Integrated Block Out

## GRAPHIC FINISHING

Silicone beading is sewn around the perimeter of the fabric graphic. Silicone beading is hidden from view once installed.

## DISPLAY CONSTRUCTION

Aluminum frame and components

## SHIPPING WEIGHTS & DIMENSIONS (FREIGHT ONLY)

Shipping Weight	393lbs w/ pallet
Shipping Dimensions	96"L x 40"W x 26"H

## GRAPHIC TURN AROUND TIME

4 business days after proof approval

AVAILABILITY	PFC / PA
--------------	----------

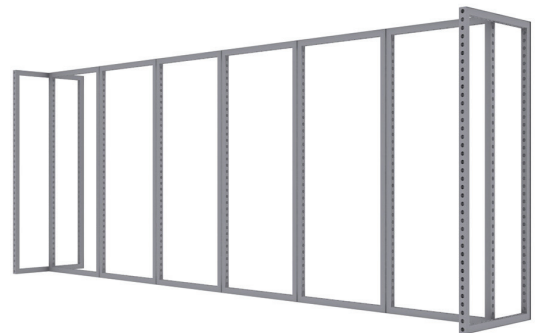

## PARTS REFERENCE

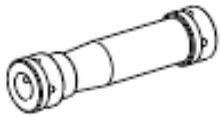

**Clamp Connector**  
MOD-CLA-CON  
Qty.10



**T Connector**  
MOD-T-90DCON  
Qty.4



**180° Connector**  
MOD-180D-CON  
Qty.10



**992 x 2418**  
MOD-FRM-992x2418  
Qty.8



**95° Cover Profile**  
MOD-CP-992x2418  
Qty.4



**Clip Connector**  
MOD-CC  
Qty.12



**Pin Connector**  
MOD-PC  
Qty.32

## INSTRUCTIONS

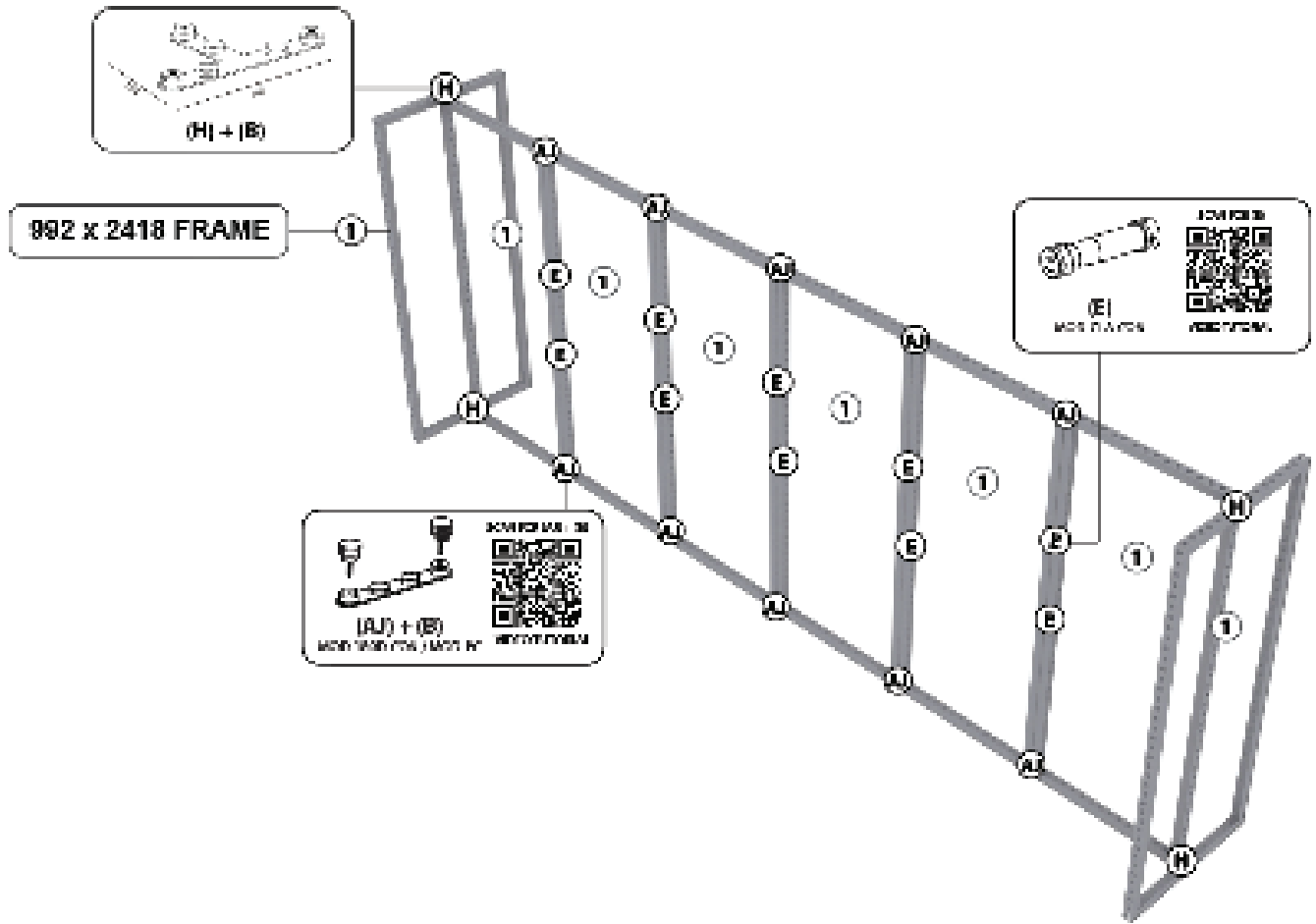

CONFIGURATION PARTS LIST			
HLI	QTY	PART NO.	DESCRIPTION
I	8	MOD I 992x2418	Straight Frame, Corner Screw Connect 992mmx2418mm
L	10	MOD CLA CON	Clamp Connector (additional 2 added)
AJ	10	MOD I 80D CON	180 Degree Connector (additional 2 added)
B	32	MOD I 7C	Pin Connector (additional 2 added)
I	4	MOD I 90U CON	I Shape 3 Way 90 Degree Connector (additional 2 added)

## INSTRUCTIONS

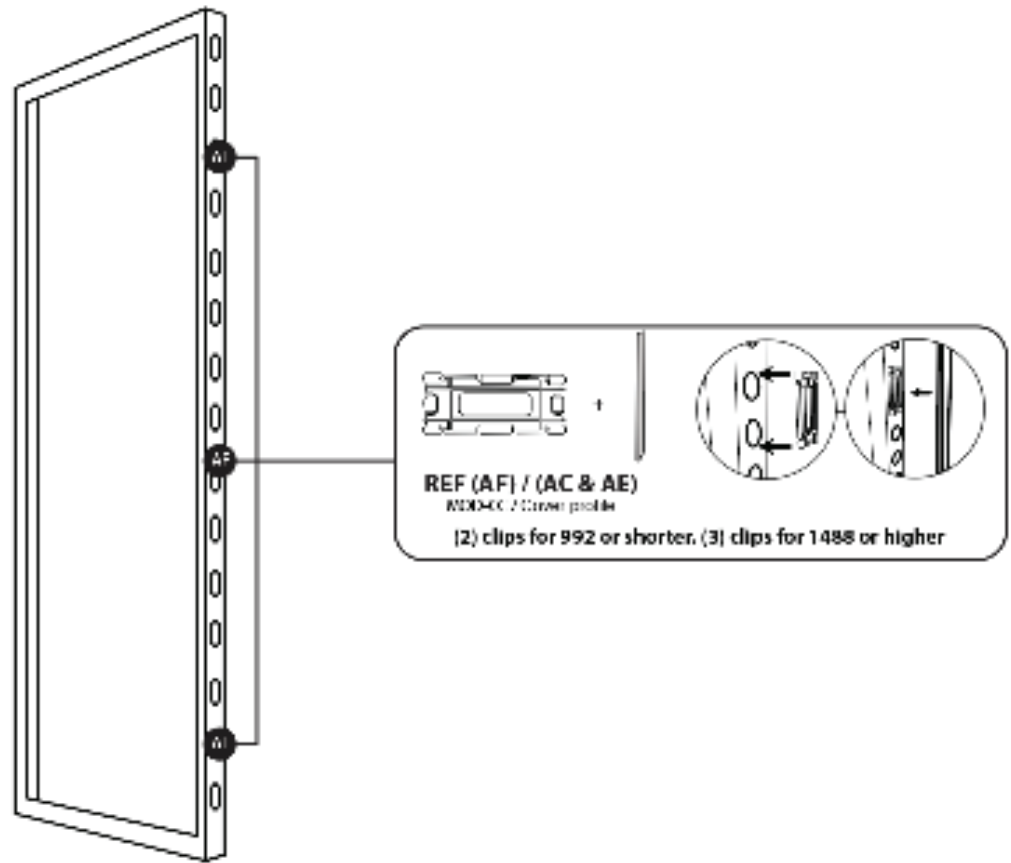

COVER PROFILES LIST			
AC	4	MOD CP 992x2410	Cover Profile for frame 992x2410, Flat Model, Anodized
AF	12	MOD CC	Clip Connector, Cover Connector, Cover Profile
AI	20	MOD FI*	Modular Frame Protector

## GRAPHIC REFERENCES



Place graphic over the front of the frame.

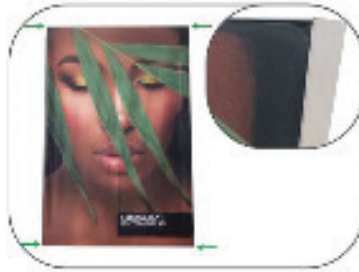

Begin inserting SEG beading at each corner.

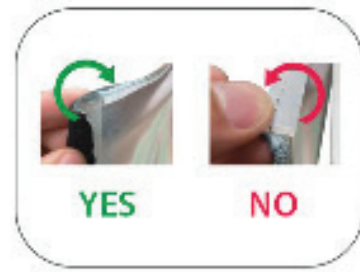

Insert the silicone beading with the fabric folded over. The silicone beading should not be exposed.

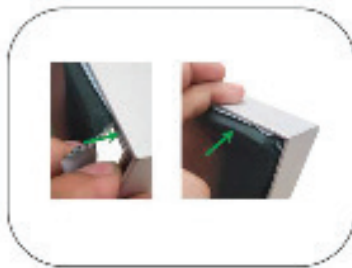

Using your fingers, push both fabric and silicone beading completely into the extrusions channel.

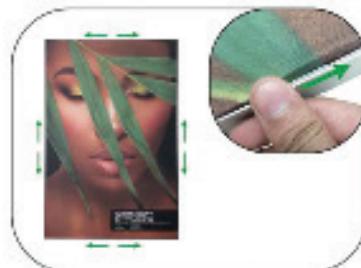

Continue to push in the remaining silicone beading on each side.



Check the perimeter of the frame for any loose beading that hasn't been pushed in. Graphic should be tight.