

MODCO 33 - 20 X 10

MODCO MODULAR EXHIBITS
 PRODUCT CODE: MODCO33-20x10G



PRODUCT DESCRIPTION

Modco® Modular Display 33 is a three-dimensional pre-designed backwall exhibit, ideal for a 20' booth space. Stylish and lively, this booth is built using tool-free perforated modular aluminum frames along with rounded corners. Multiple size frames connect using tool-less pin connectors making setup a breeze!

DISPLAY DIMENSIONS		234"W X 96.25"H X 98.6"D	
GRAPHIC SIZES	SIZE	QTY	
	20.5"W x 96.25"H	6	
	234"W x 96.25"H	2	
	118"W x 20.5"H	2	
	79"W x 40"H	4	
TOTAL		14	

GRAPHIC MATERIAL

Stretch Fabric w/ Integrated Block Out

GRAPHIC FINISHING

Silicone beading is sewn around the perimeter of the fabric graphic. Silicone beading is hidden from view once installed.

DISPLAY CONSTRUCTION

Aluminum frame and components

SHIPPING WEIGHTS & DIMENSIONS (FREIGHT ONLY)

Shipping Weight	511lbs w/ pallet
Shipping Dimensions	96"L x 40"W x 26"H

GRAPHIC TURN AROUND TIME

4 business days after proof approval

AVAILABILITY	PFC / PA
--------------	----------

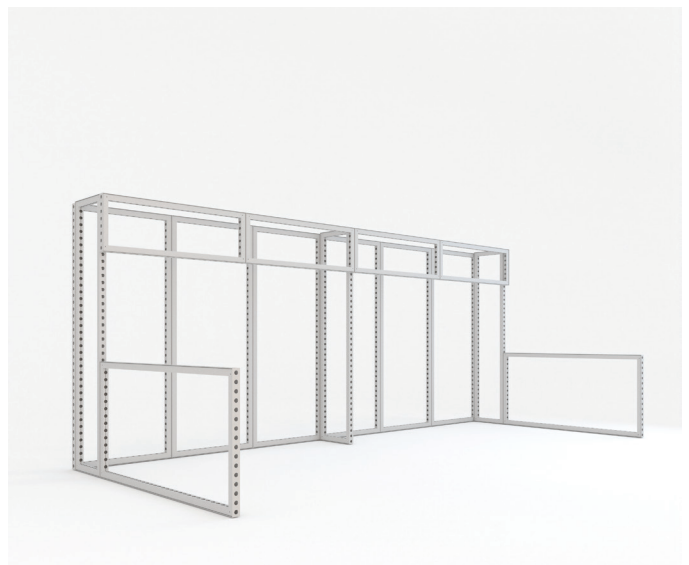

PARTS REFERENCE

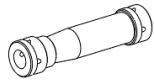

Clamp Connector
MOD-CLA-CON
Qty.20

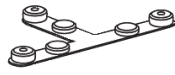

T Connector
MOD-T-90DCON
Qty.3

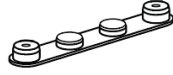

180° Connector
MOD-180D-CON
Qty.15



95° Cover Profile
MOD-CP-992x2418
Qty.2



Clip Connector
MOD-CC
Qty.33



Pin Connector
MOD-PC
Qty.74

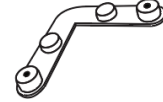

Small 90° Connector
MOD-SM90D-CON
Qty.6



992 x 2418
MOD-FRM-992x2418
Qty.6

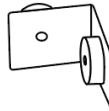

90° Connector
MOD-90D-CON
Qty.8



496 x 2418
MOD-FRM-496x2418
Qty.3



992 x 1984
MOD-FRM-992x1984
Qty.2



496 x 1488
Custom Frame
Qty.4

Qty.	Part No.	Description
6	MOD-FRM-992x2418	992 x 2418 Modco Frame
3	MOD-FRM-496x2418	496 x 2418 Modco Frame
2	MOD-FRM-992x1984	992 x 1984 Modco Frame
4	496 x 1488 Custom Frame	Qty.4 - 496mm x 1488mm - CUSTOM FRAMES
6	MOD-SM90D-CON	Large 90 degree frame connector
3	MOD-T-90DCON	T-shaped frame connector
20	MOD-CLA-CON	Clamp Connector used between two inline frames
15	MOD-180D-CON	180 degree frame connector
74	MOD-PC	Pin Connector - used for 90, 180, and T connectors.
39	MOD-CC	Clip connectors for cover profiles
68	MOD-FP	Frame Protectors - used to stack frames / NOT needed for build
10	MOD-CP-3100	Qty.2 - 496mm, Qty.2 - 992mm, Qty.2 - 1426mm, and Qty.4 - 1488mm
2	MOD-CP-992x2418	2418mm Cover Profile
8	MOD-90D-CON	Small 90 degree frame connector

PARTS REFERENCE

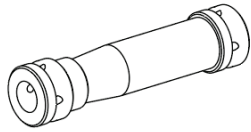

MOD-CLA-CON

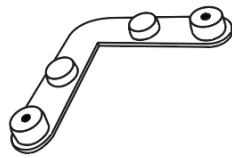
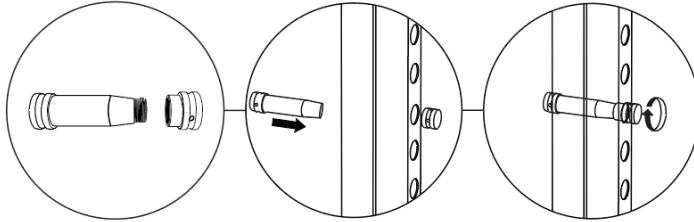

MOD-SM90D-CON / MOD-PC

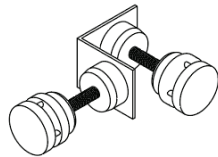
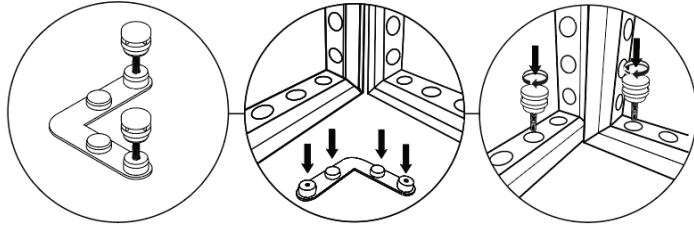

MOD-90D-CON + MOD-PC

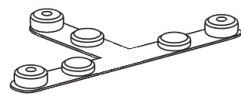
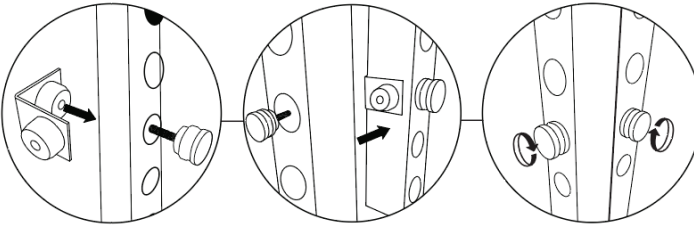

MOD-T-90D-CON

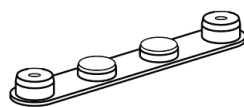
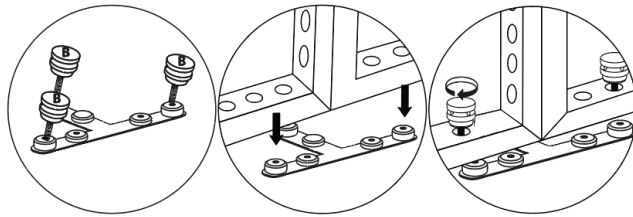

MOD-180D-CON / MOD-PC

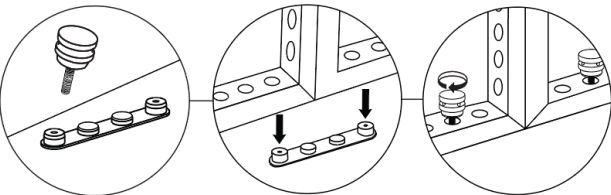

INSTRUCTIONS

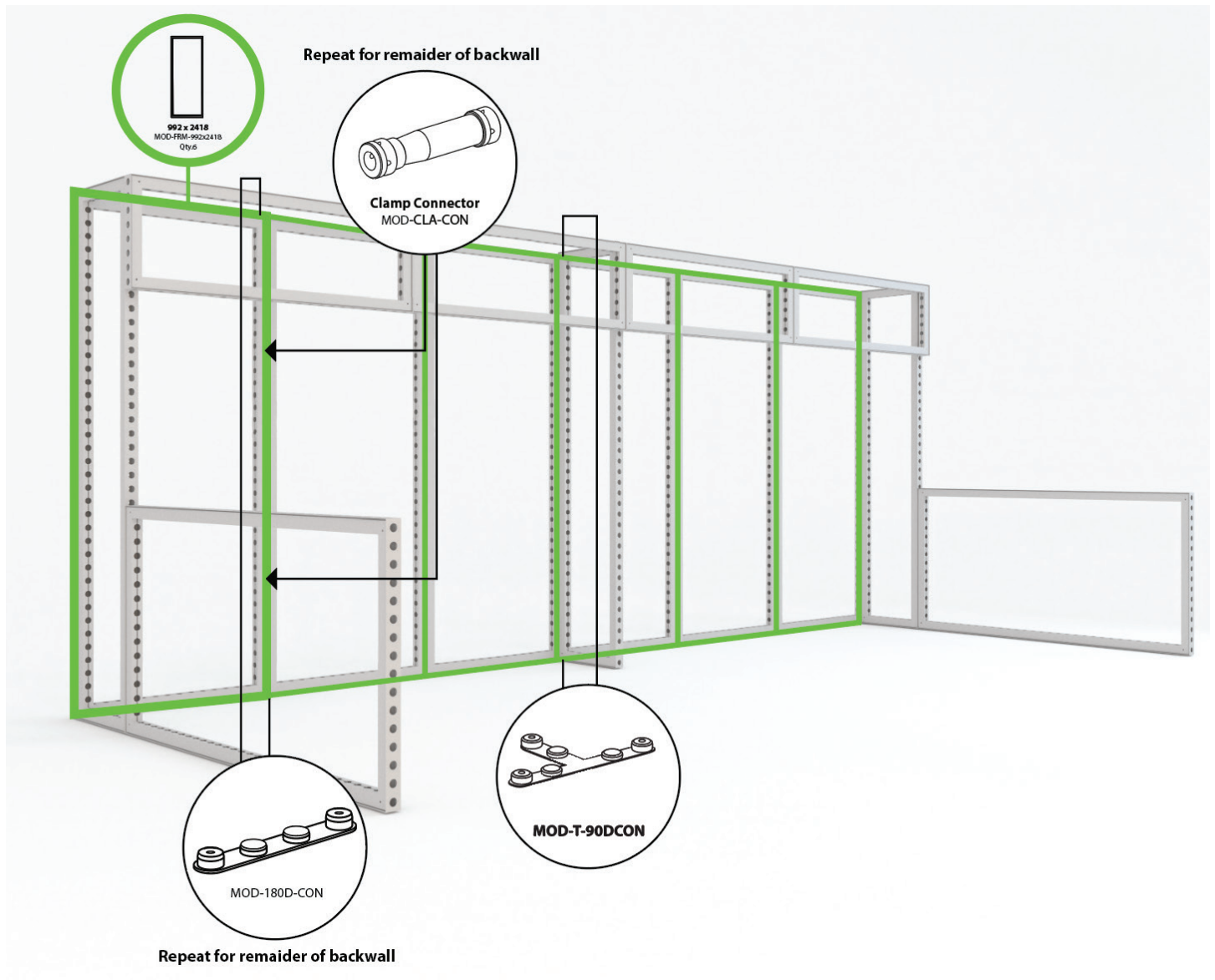

INSTRUCTIONS

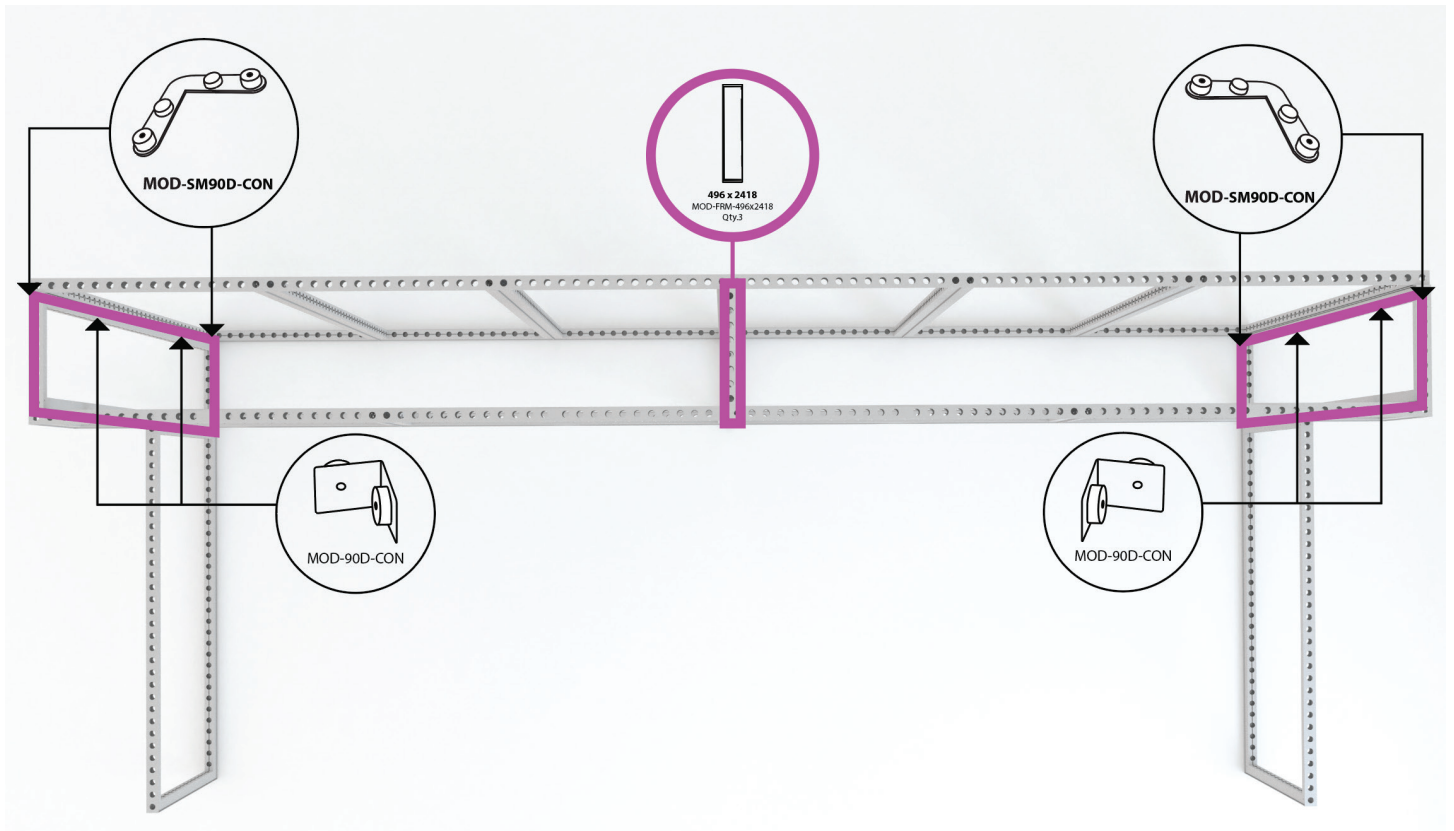

INSTRUCTIONS

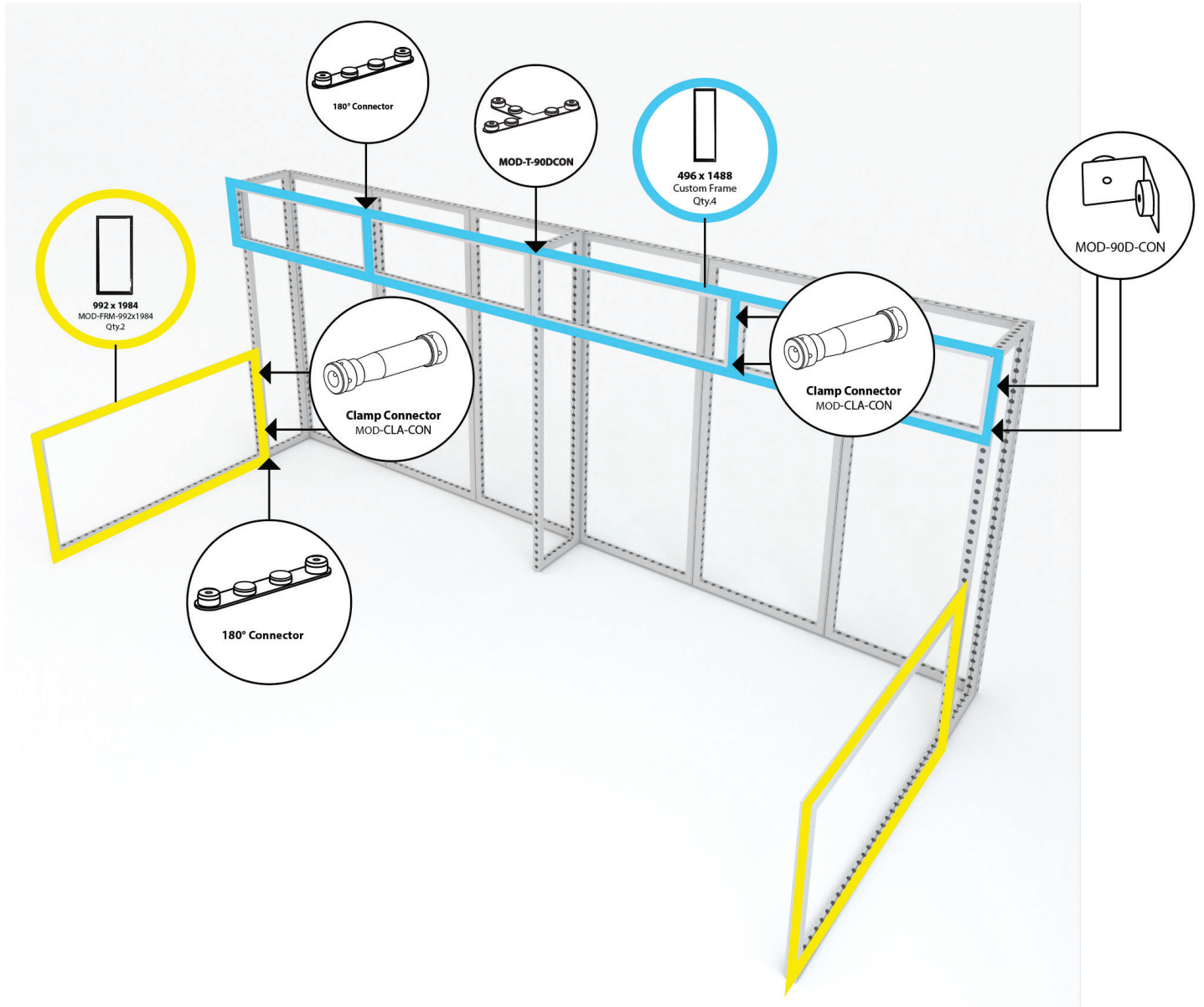

GRAPHIC REFERENCES



Place graphic over the front of the frame.

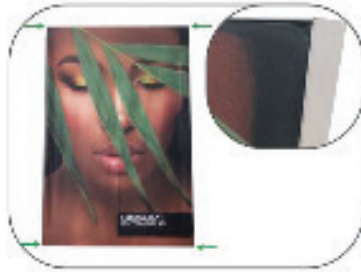

Begin inserting SEG beading at each corner.

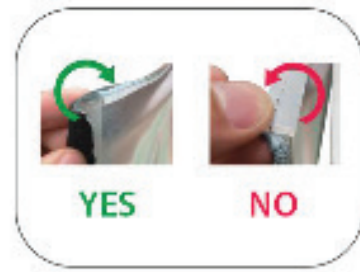

Insert the silicone beading with the fabric folded over. The silicone beading should not be exposed.

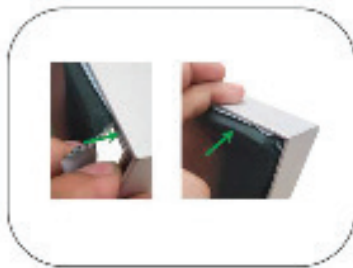

Using your fingers, push both fabric and silicone beading completely into the extrusions channel.

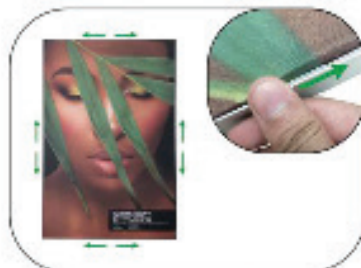

Continue to push in the remaining silicone beading on each side.



Check the perimeter of the frame for any loose beading that hasn't been pushed in. Graphic should be taut.

