

MODCO 16 - 30x10

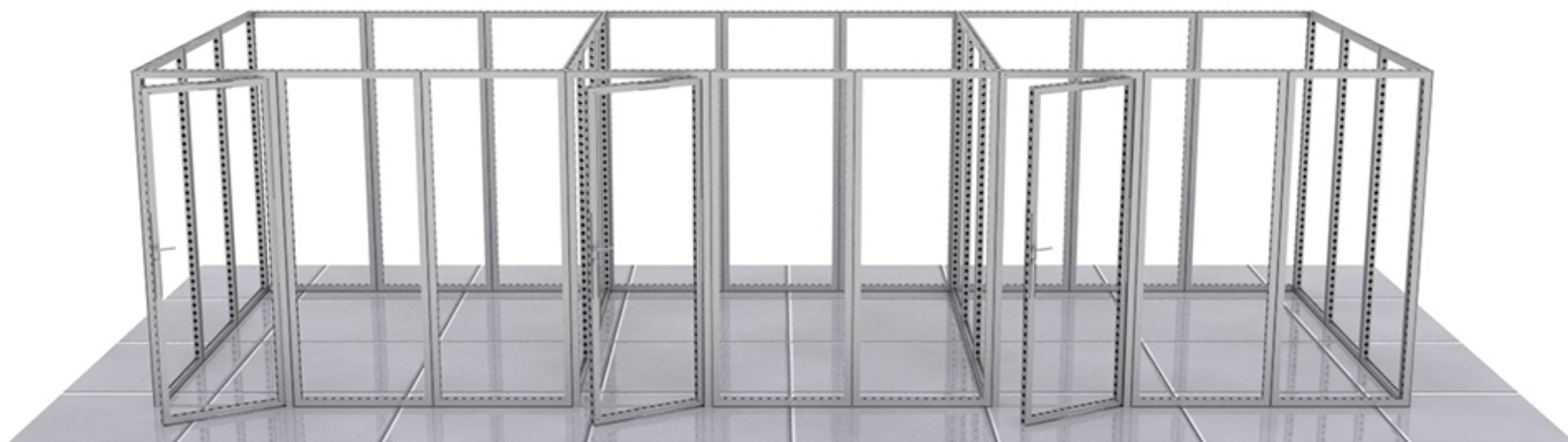

MODCO 16 - 30x10

- Use REF column to reference parts. Repeat this step until you have a total of 3 walls.

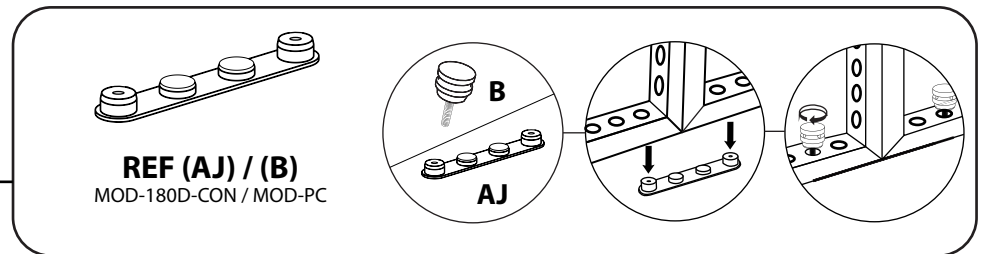
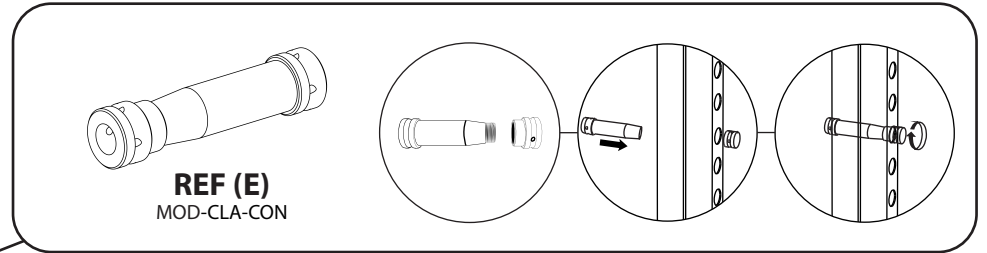
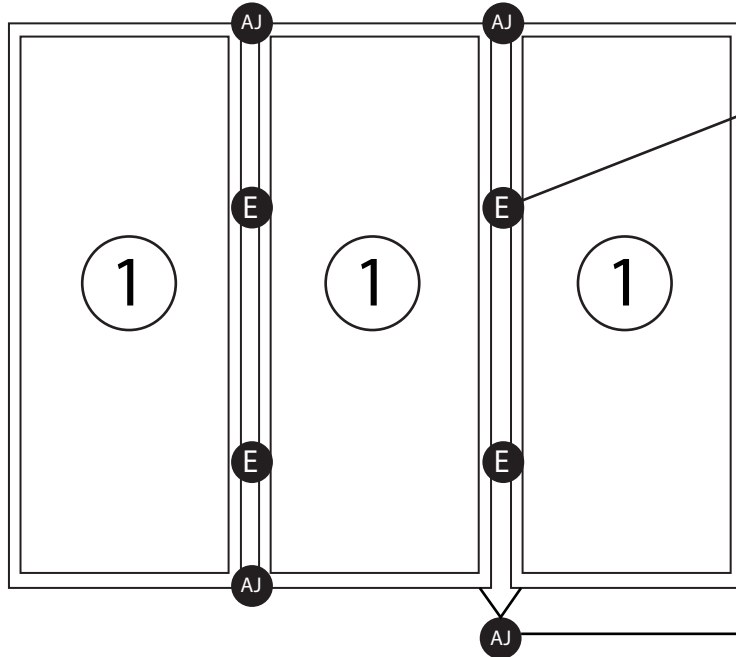

REF	QTY	PART NO.	DESCRIPTION
1	27	MOD-FRM-992x2418	Straight Frame, Corner Screw Connect 992mm x 2418mm
B	120	MOD-PC	Pin Connector
C	8	MOD-90D-CON	90° Connector
D	8	MOD-SM90D-CON	90° Connector
E	36	MOD-CLA-CON	Clamp Connector
AJ	38	MOD-180D-CON	180 Degree Connector
2	3	MOD-DSWL-992x2418	Door Set w/ Lock 992mm x 2418mm
A	2	MOD-PCWP-A	Pin Connector for Door Jamb
H	4	MOD-T-90DCON	T Shape 3 Way 90 Degree Connector Used per Set of 2pcs
AA	10	MOD-DCC-180D	Door Clamp Connector, 180 Degrees (Connect to Wall Frame)

MODCO 16 - 30x10

- Use REF column to reference parts. Connect each wall to make a 90° corner. Repeat for opposite side.

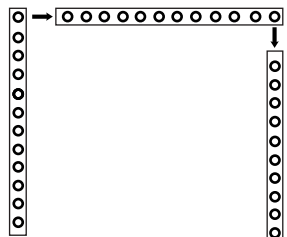
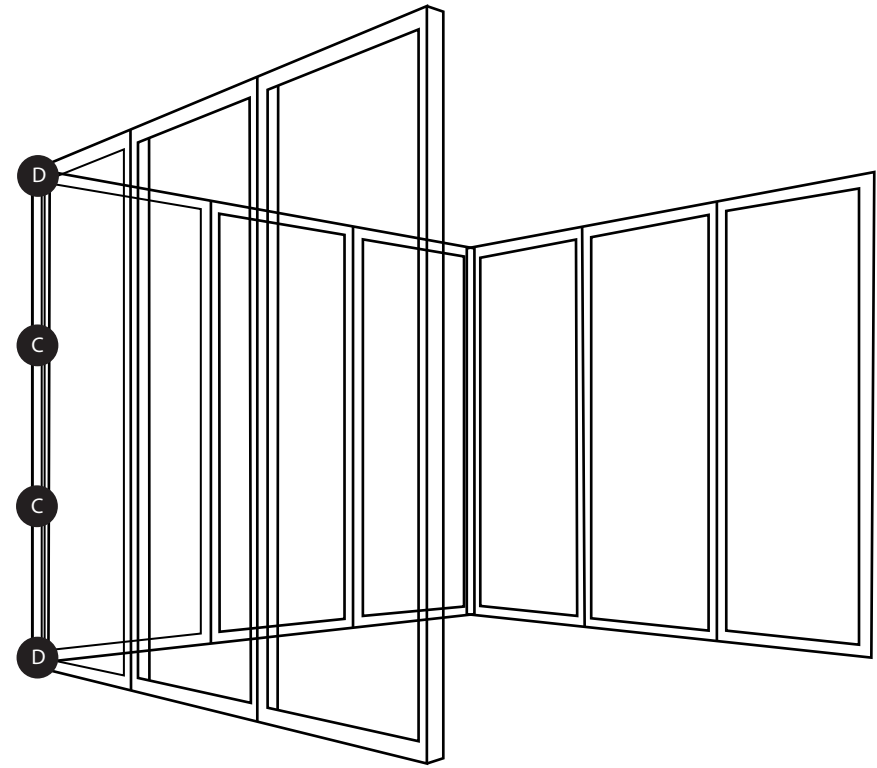
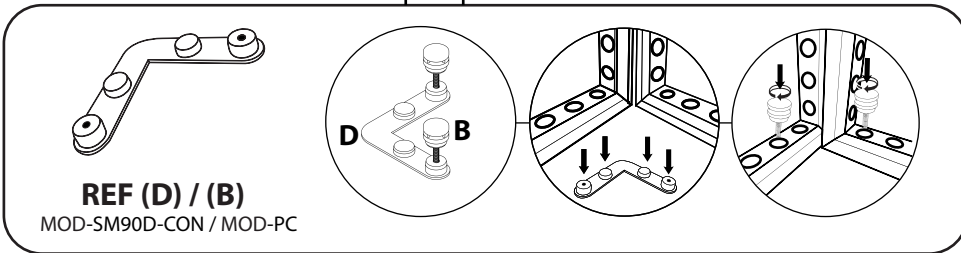
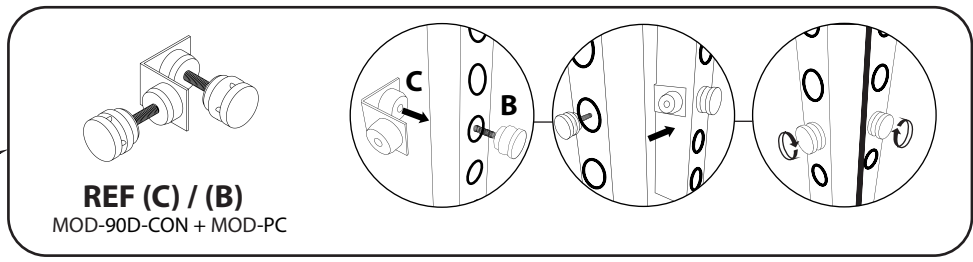
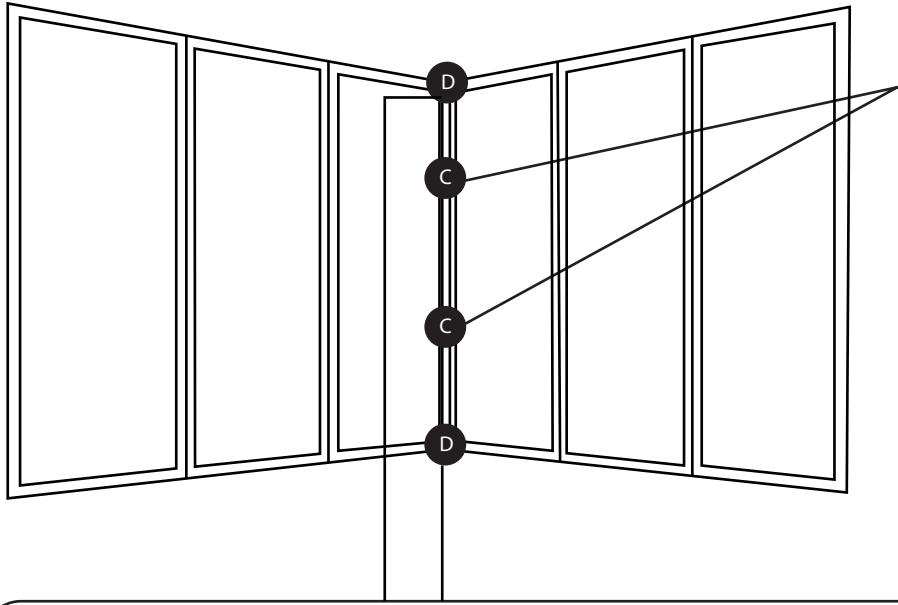

TOP VIEW OF ROOM

MODCO 16 - 30x10

- Use REF column to reference parts. Complete final side/wall including door.

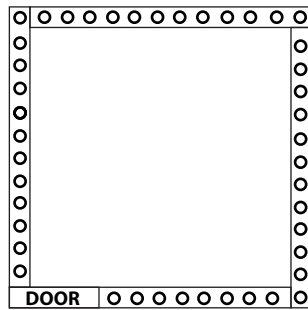
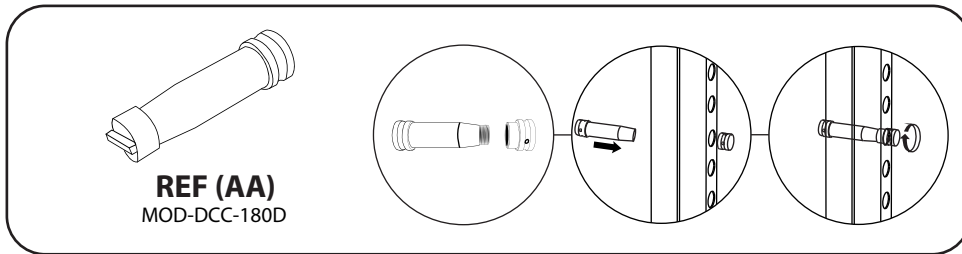
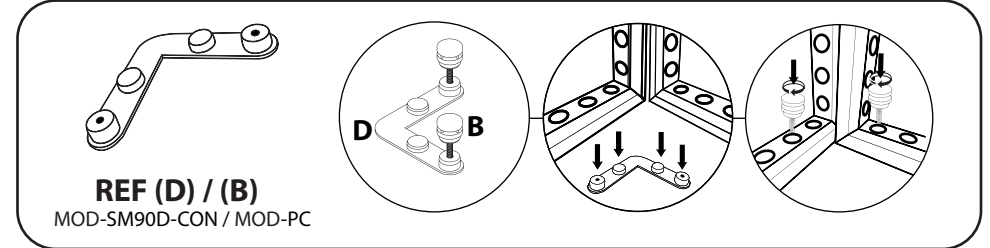

TOP VIEW OF ROOM

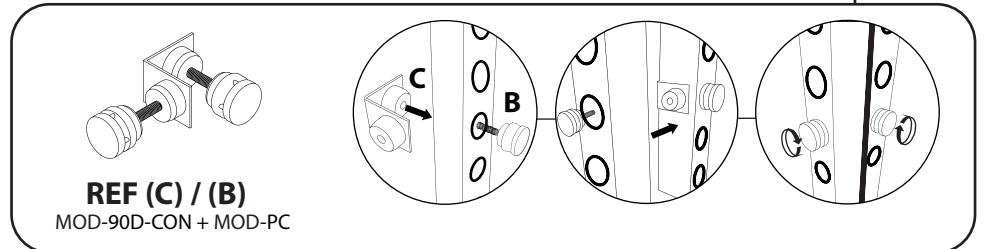
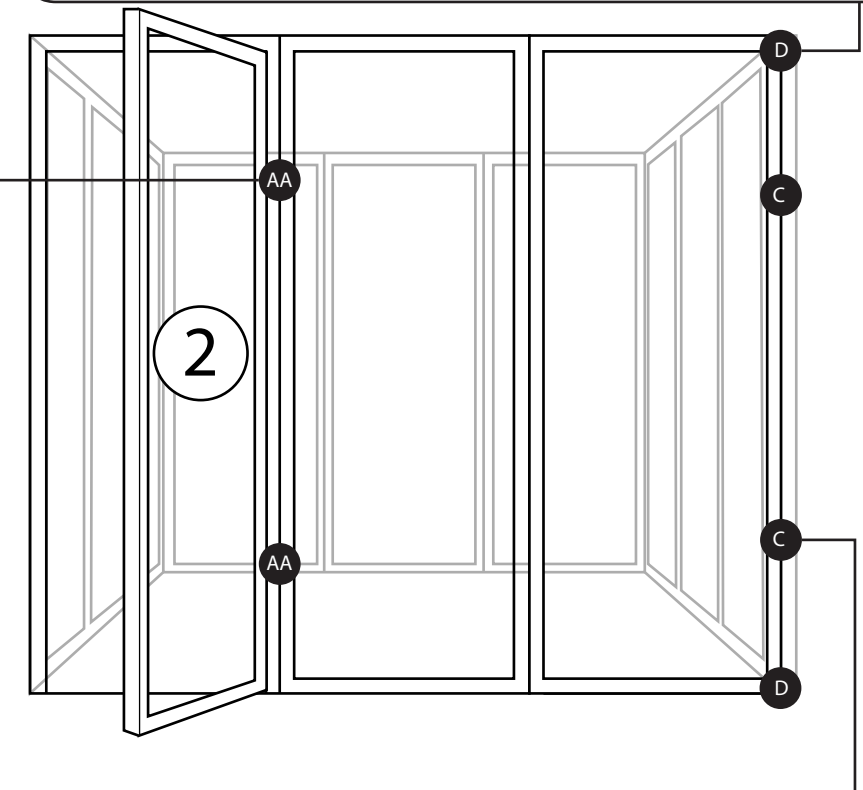

MODCO 16 - 30x10

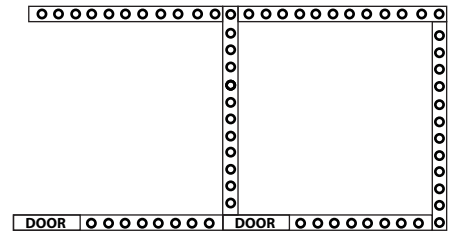
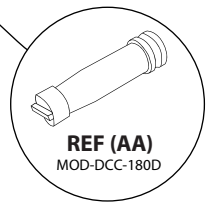
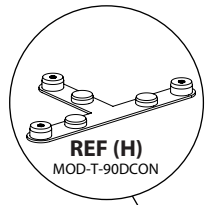
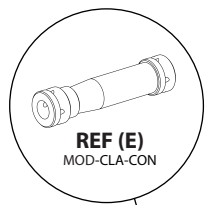
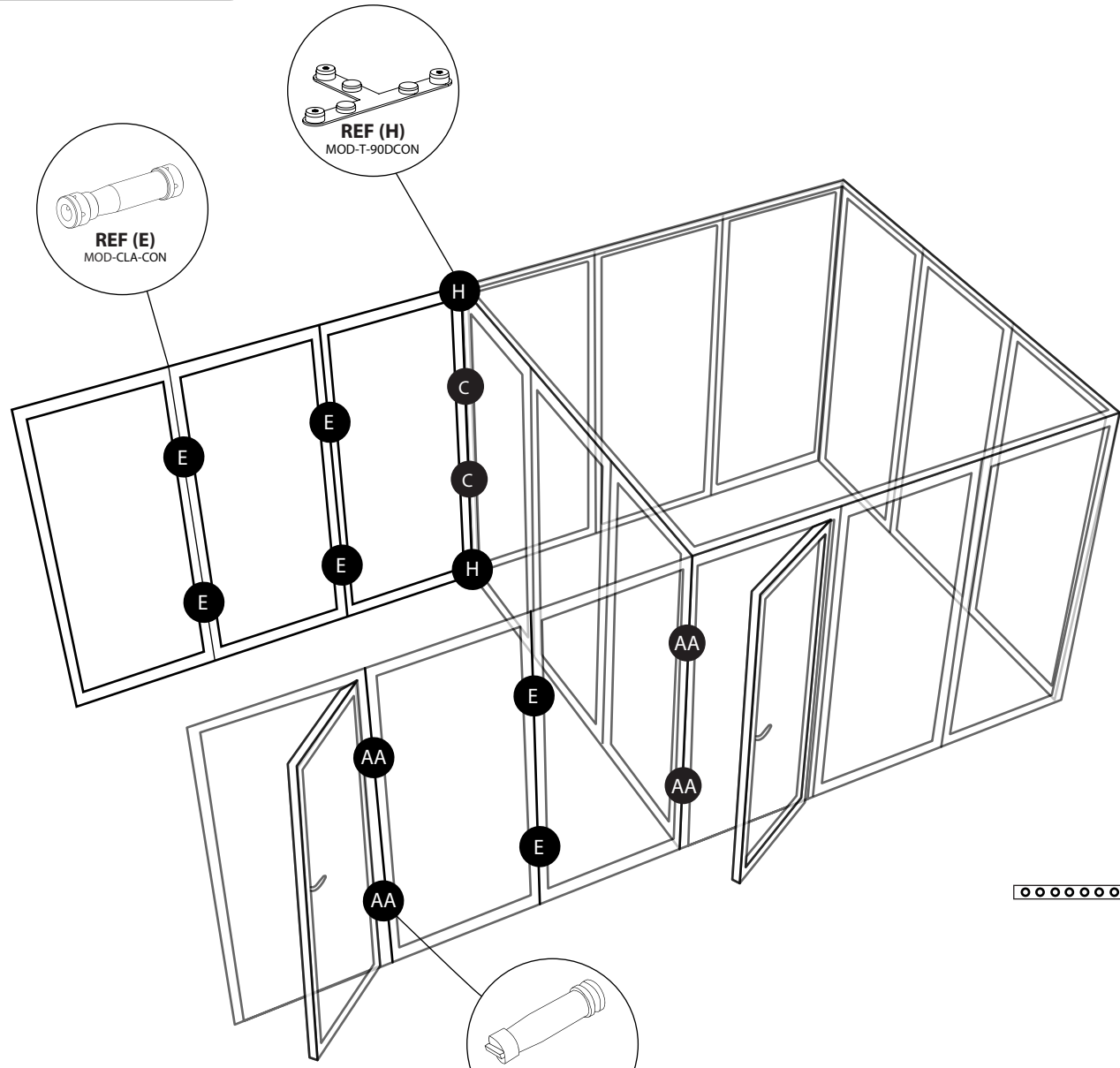

TOP VIEW OF ROOM

MODCO 16 - 30x10

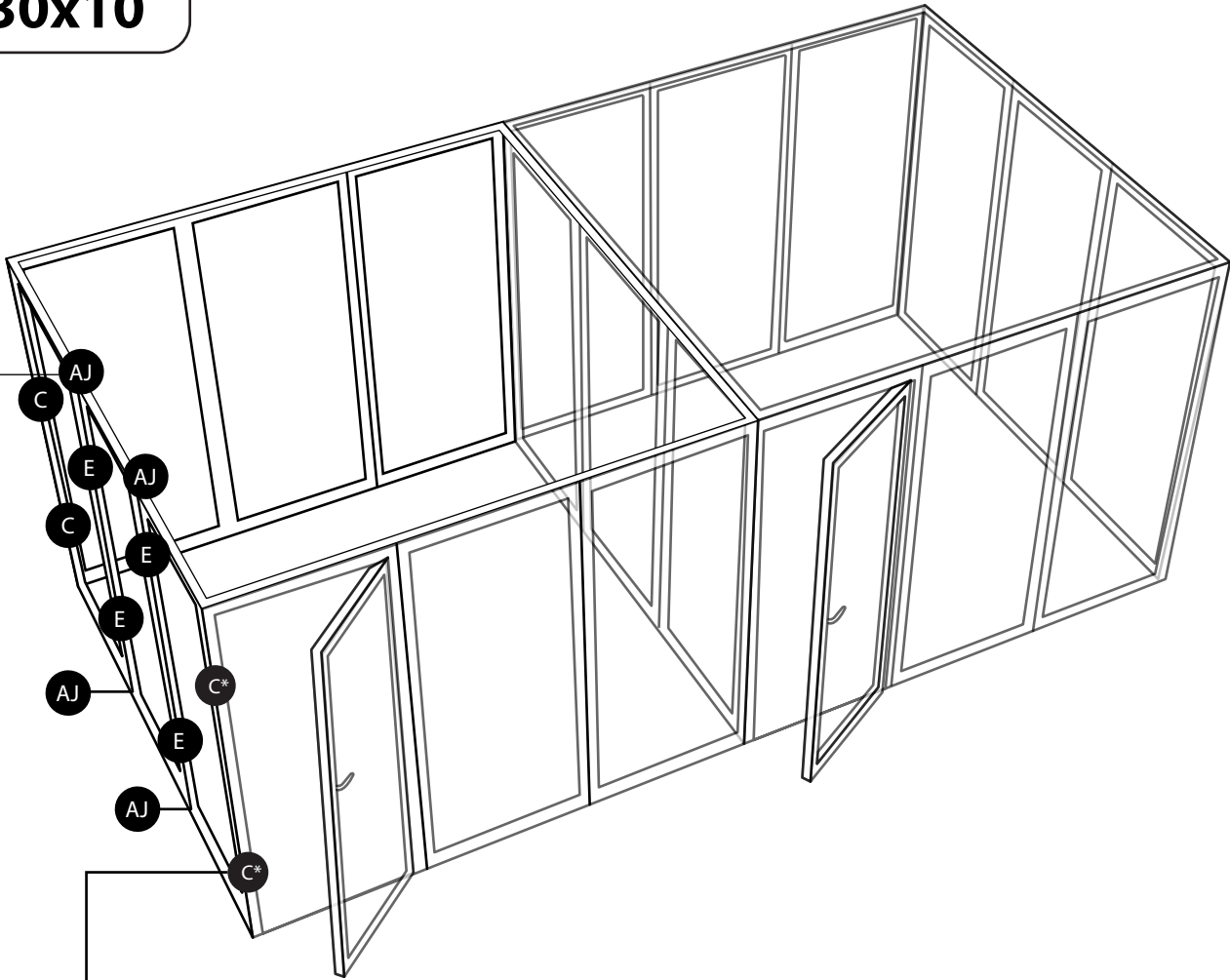
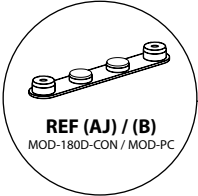

REF (C*) + (B) + (A)
*MOD-PCWP-A will be inside of door hinge

This diagram shows the assembly of a door hinge. It includes a callout for part A (a hinge plate), part B (a hinge pin), and part C* (a hinge cap). A note states that MOD-PCWP-A will be inside of the door hinge. The diagram also shows a close-up of the hinge being installed on a door edge.

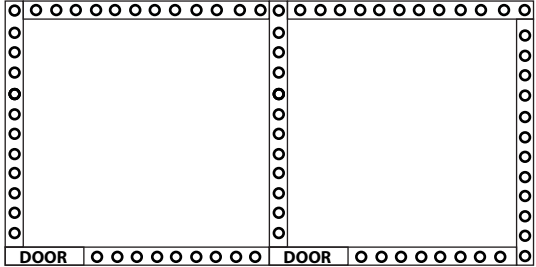

MODCO 16 - 30x10

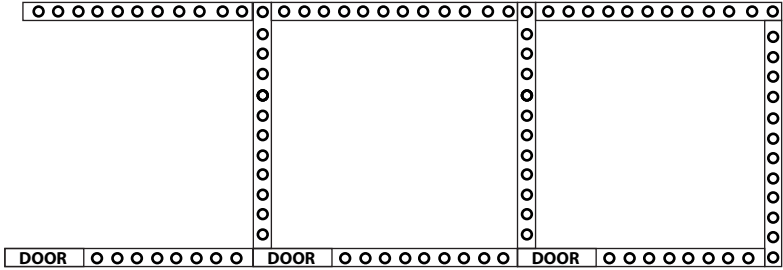
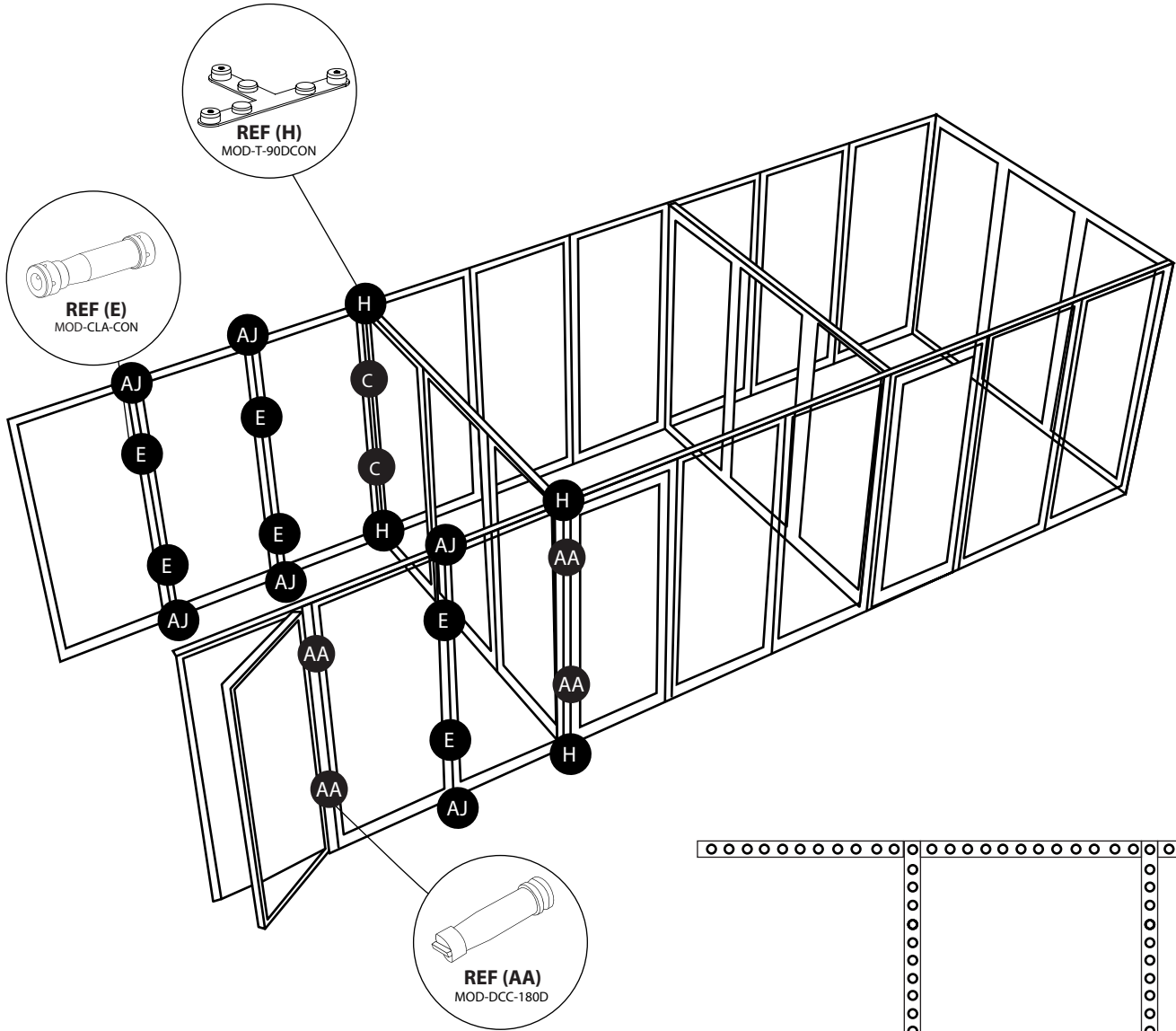

TOP VIEW OF ROOM

MODCO 16 - 30x10

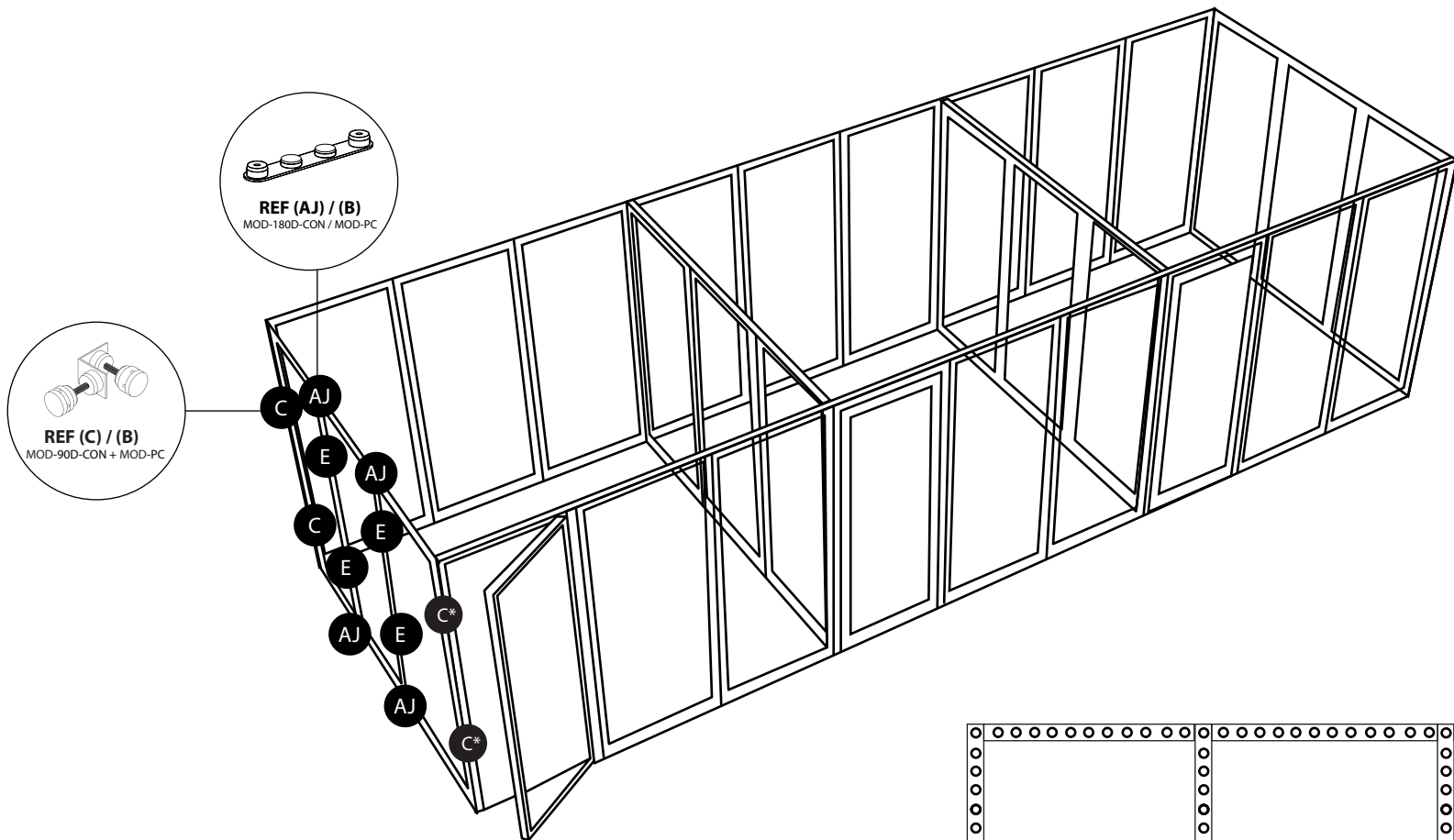

REF (AJ) / (B)
MOD-180D-CON / MOD-PC

REF (C) / (B)
MOD-90D-CON + MOD-PC

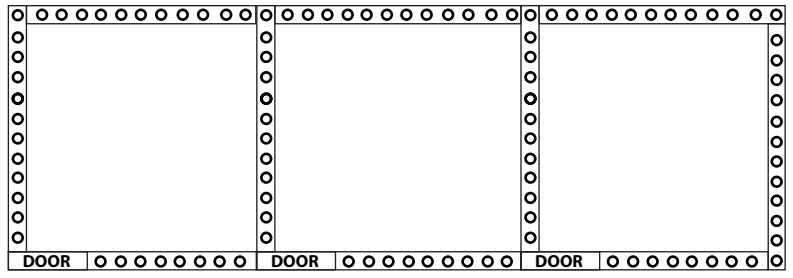

TOP VIEW OF ROOM

MODCO 16 - 30x10

- Use REF column to reference parts. Attach cover profile to each exposed side (4 sides total).

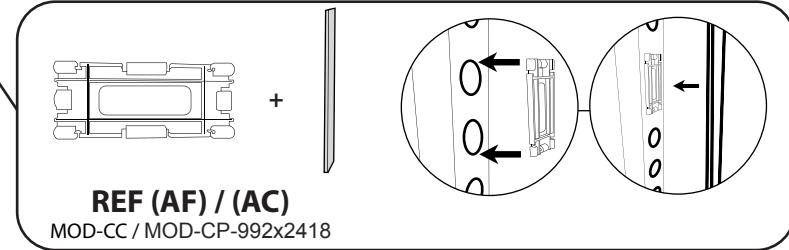
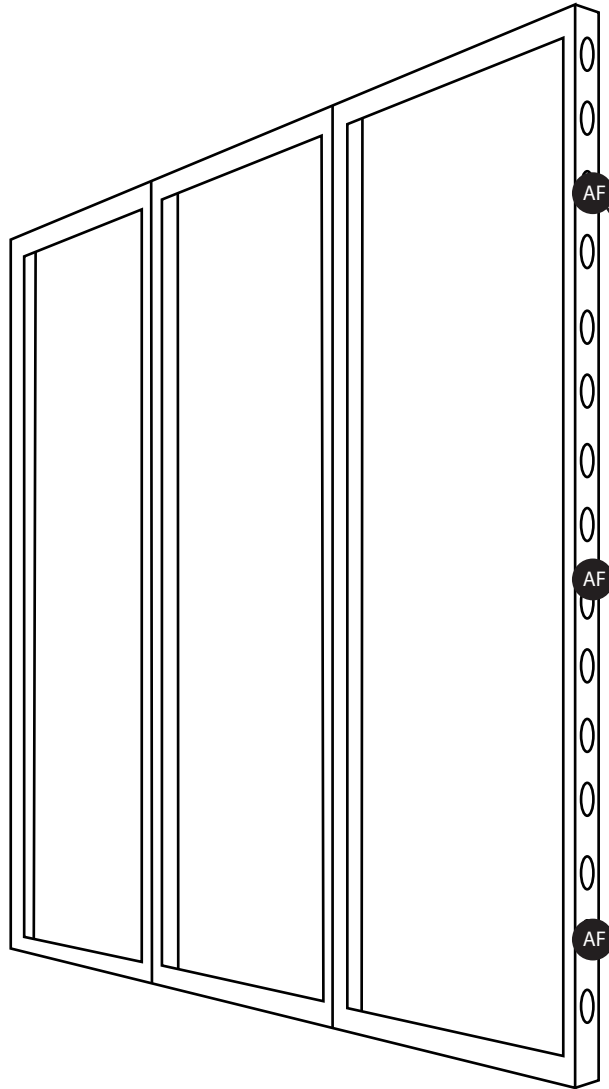

REF	QTY	PART NO.	DESCRIPTION
AC	6	MOD-CP-992x2418	Cover Profile for Frame 992x2418. Flat Model. Anodized
AF	12	MOD-CC	Clip Connector Cover Connects Cover Profile
AL	120	MOD-FP	Modco Frame Protector

GRAPHIC INSTALL



Place graphic over the front of the frame.

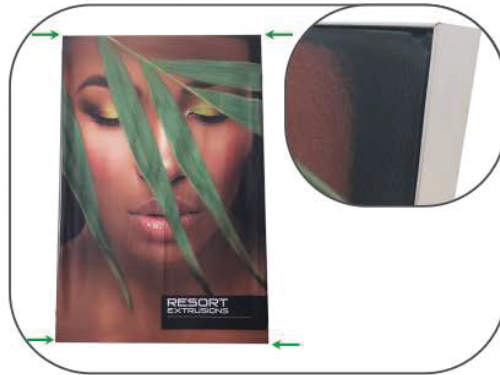

Begin inserting SEG beading at each corner.

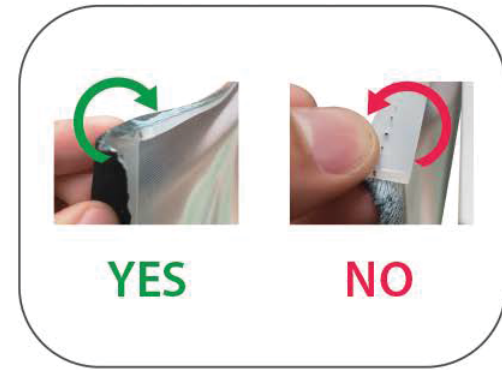

Insert the silicone beading with the fabric folded over. The silicone beading should not be exposed.

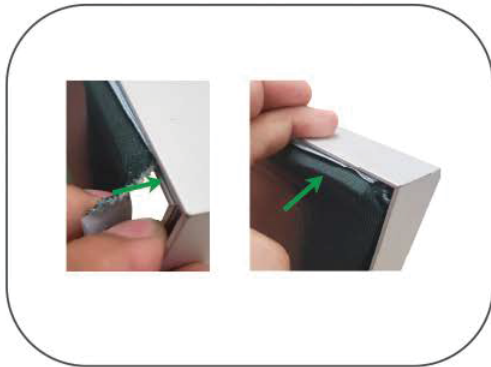

Using your fingers, push both fabric and silicone beading completely into the extrusions channel.



Continue to push in the remaining silicone beading on each side.



Check the perimeter of the frame for any excess beading that hasn't been pushed in. Graphic should be taut.