

MODCO 21 - 30 x10

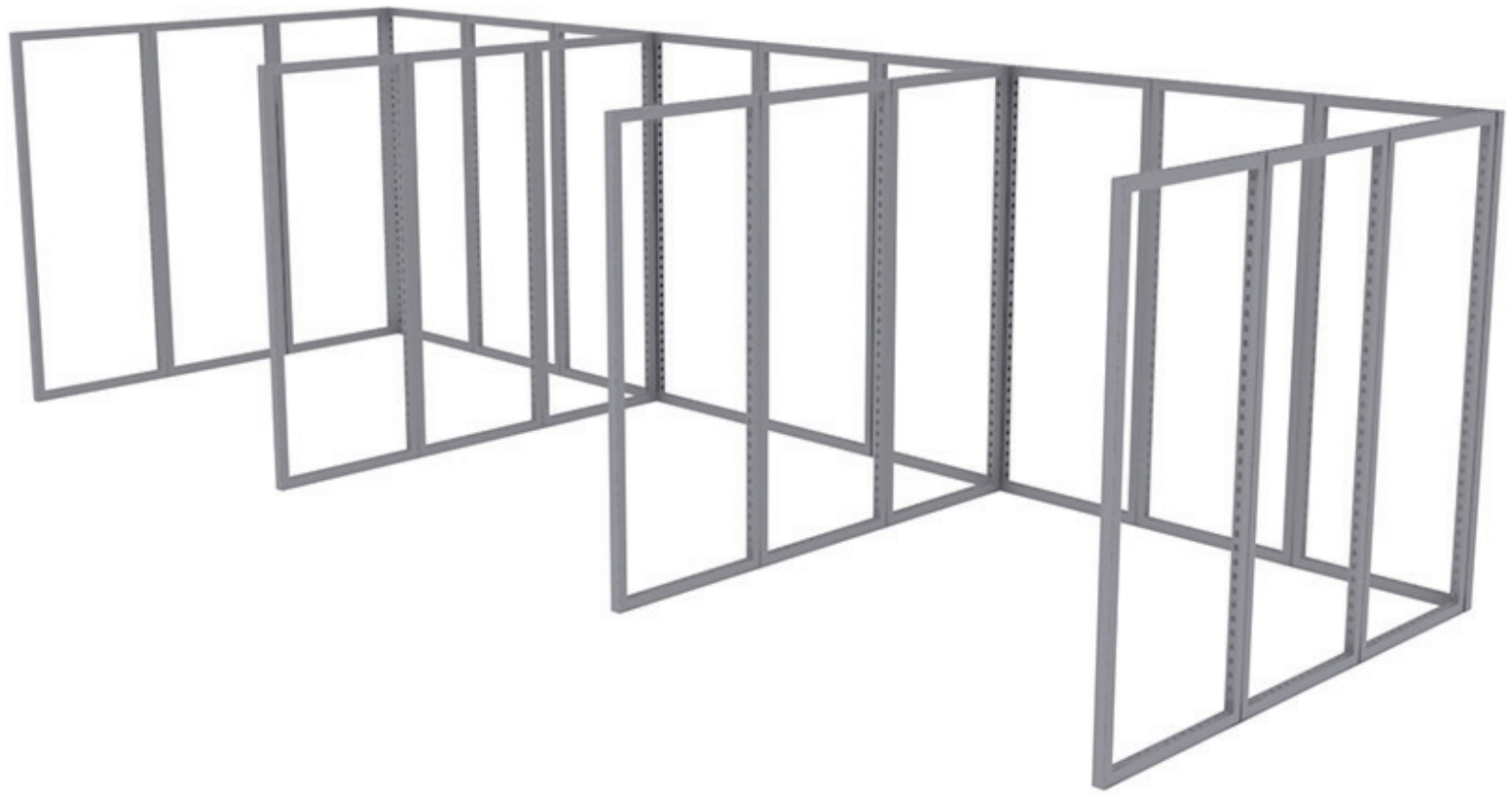

MODCO 21 - 30 x10

- Use REF column to reference parts. Repeat this step until you have a total of 3 walls.

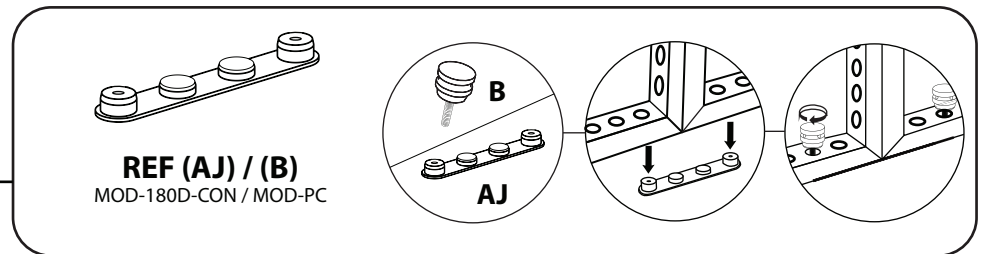
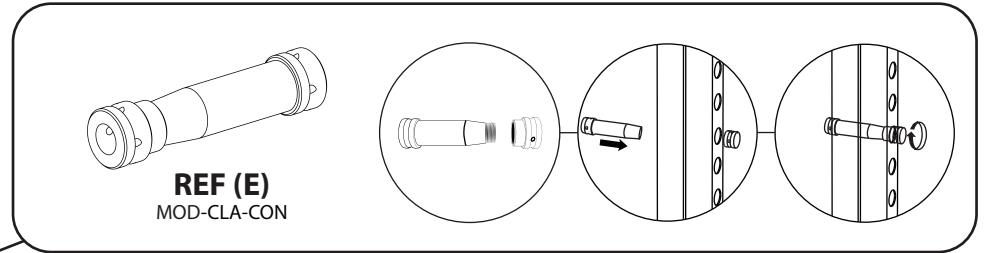
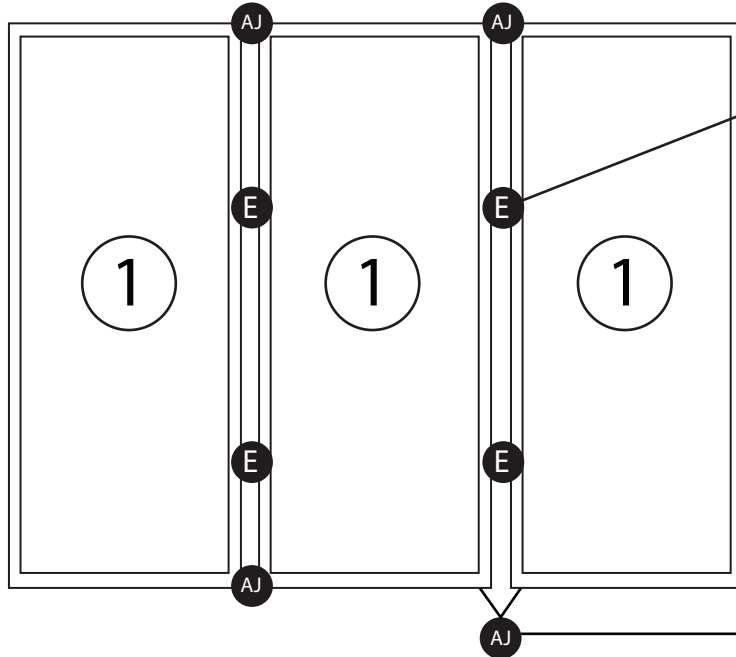

PARTS LIST

REF	QTY	PART NO.	DESCRIPTION
1	21	MOD-FRM-992x2418	Straight Frame, Corner Screw Connect 992mm x 2418mm
B	84	MOD-PC	Pin Connector
C	4	MOD-90D-CON	90° Connector
D	4	MOD-SM90D-CON	90° Connector
E	32	MOD-CLA-CON	Clamp Connector
AJ	28	MOD-180D-CON	180 Degree Connector
H	4	MOD-T-90DCON	T Shape 3 Way 90 Degree Connector Used per Set of 2pcs

MODCO 21 - 30 x10

- Use REF column to reference parts. Connect each wall to make a 90° corner. Repeat for each section.

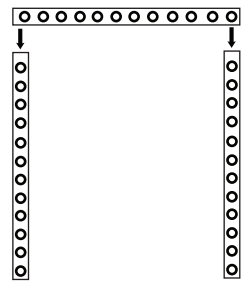
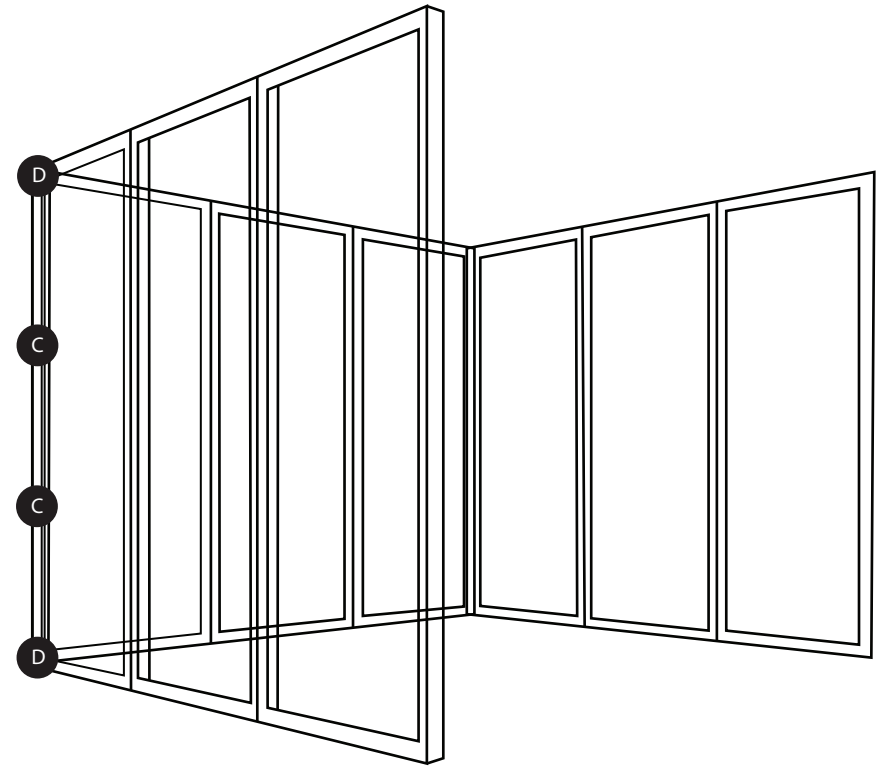
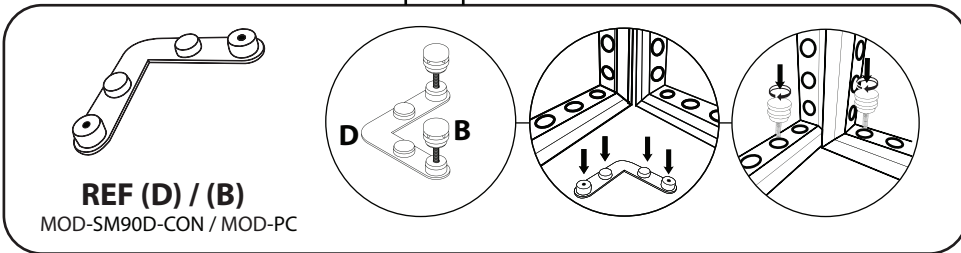
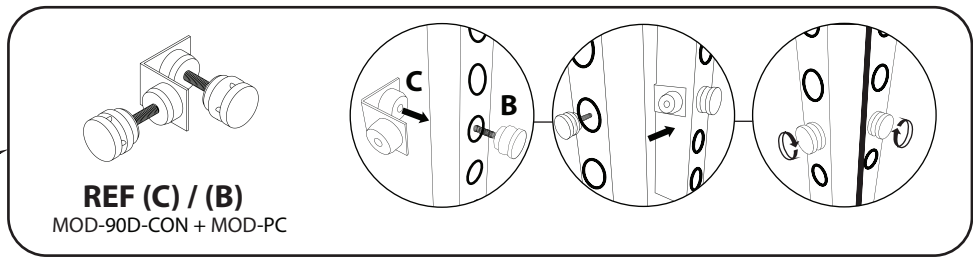
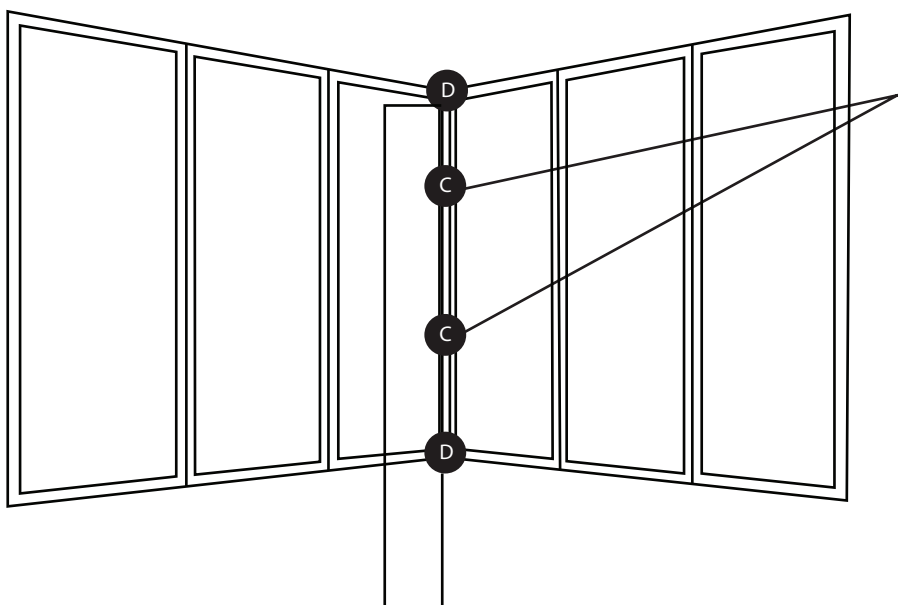

MODCO 21 - 30 x10

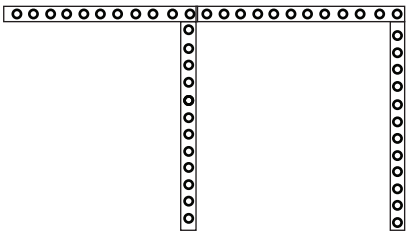
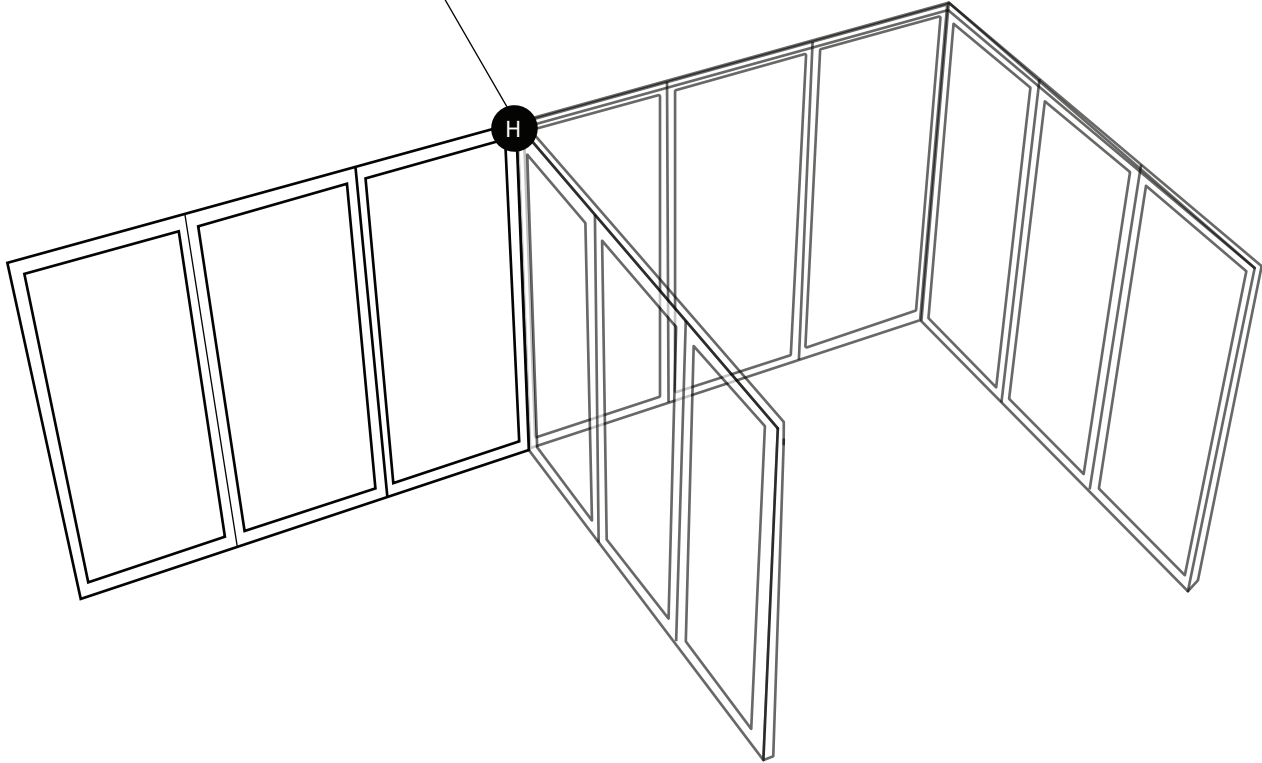
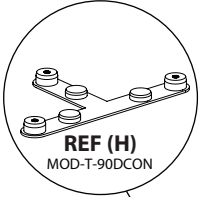

TOP VIEW OF ROOM

MODCO 21 - 30 x10

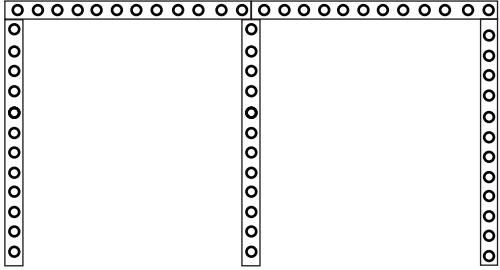
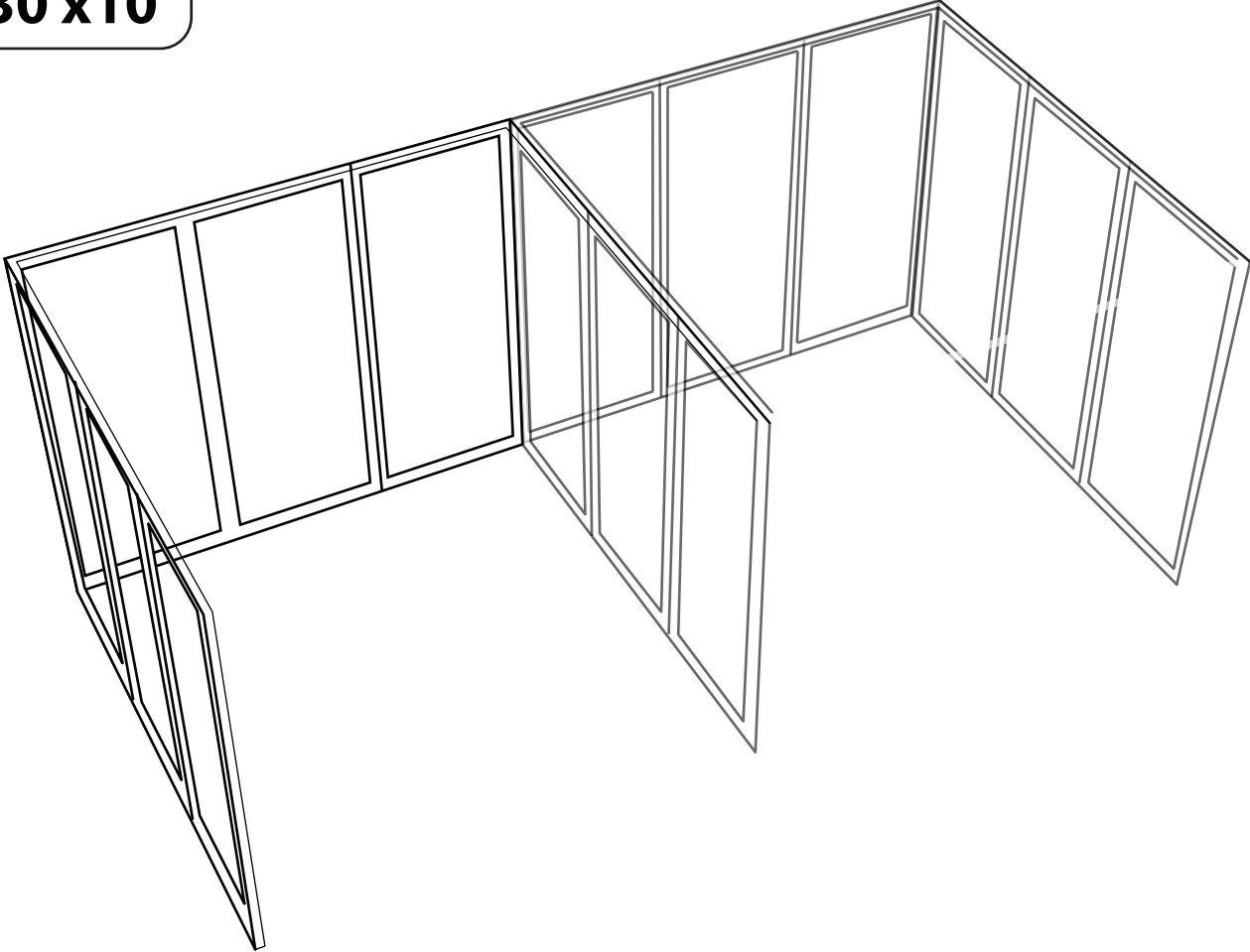

TOP VIEW OF ROOM

MODCO 21 - 30 x10

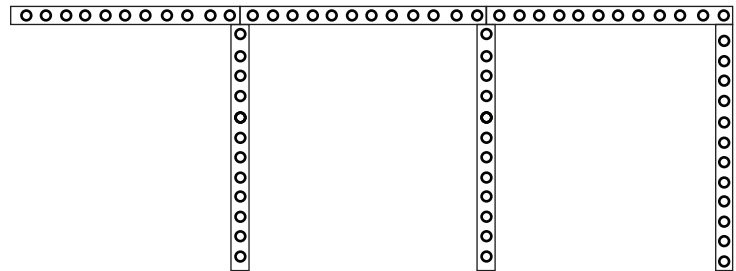
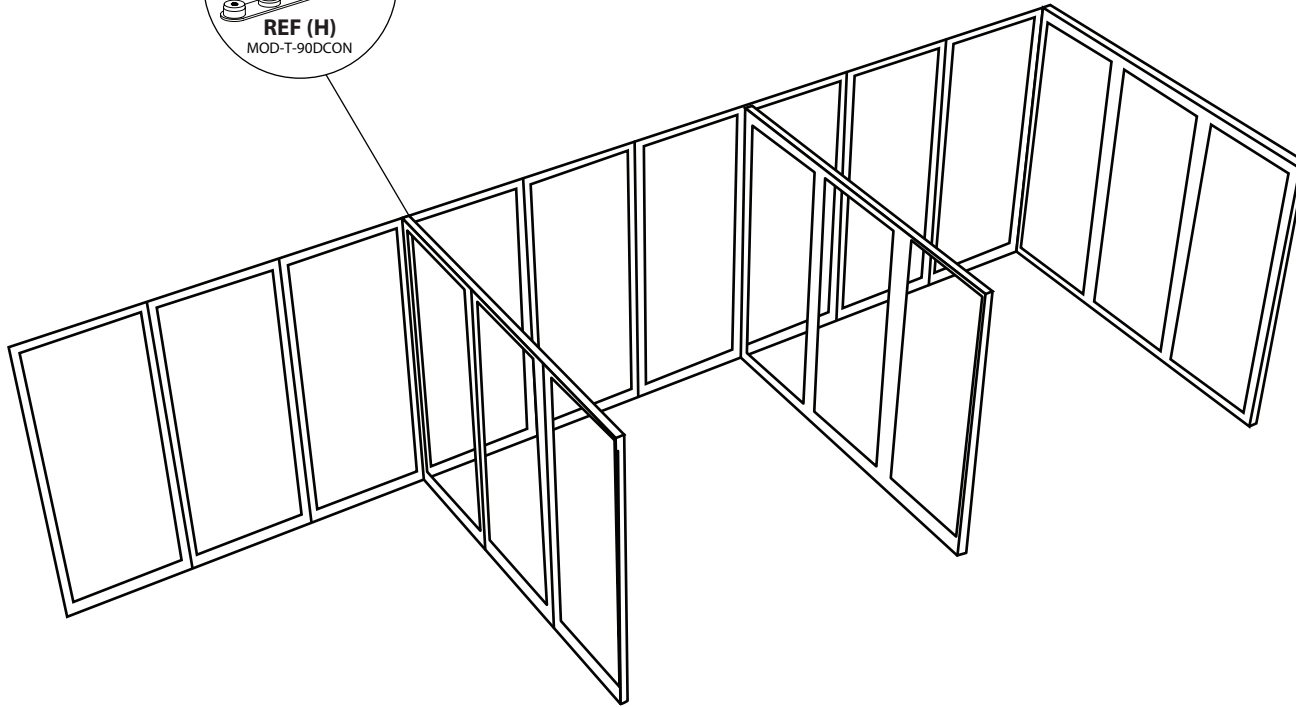
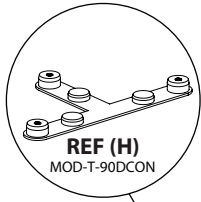

TOP VIEW OF ROOM

MODCO 21 - 30 x10

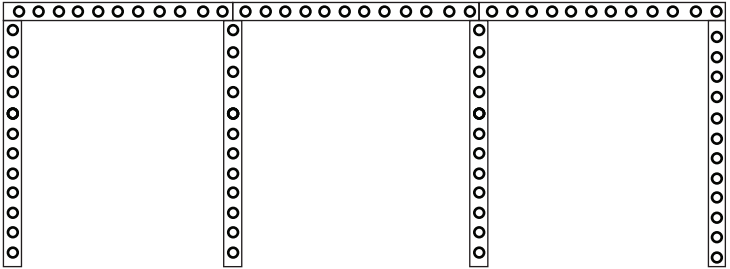
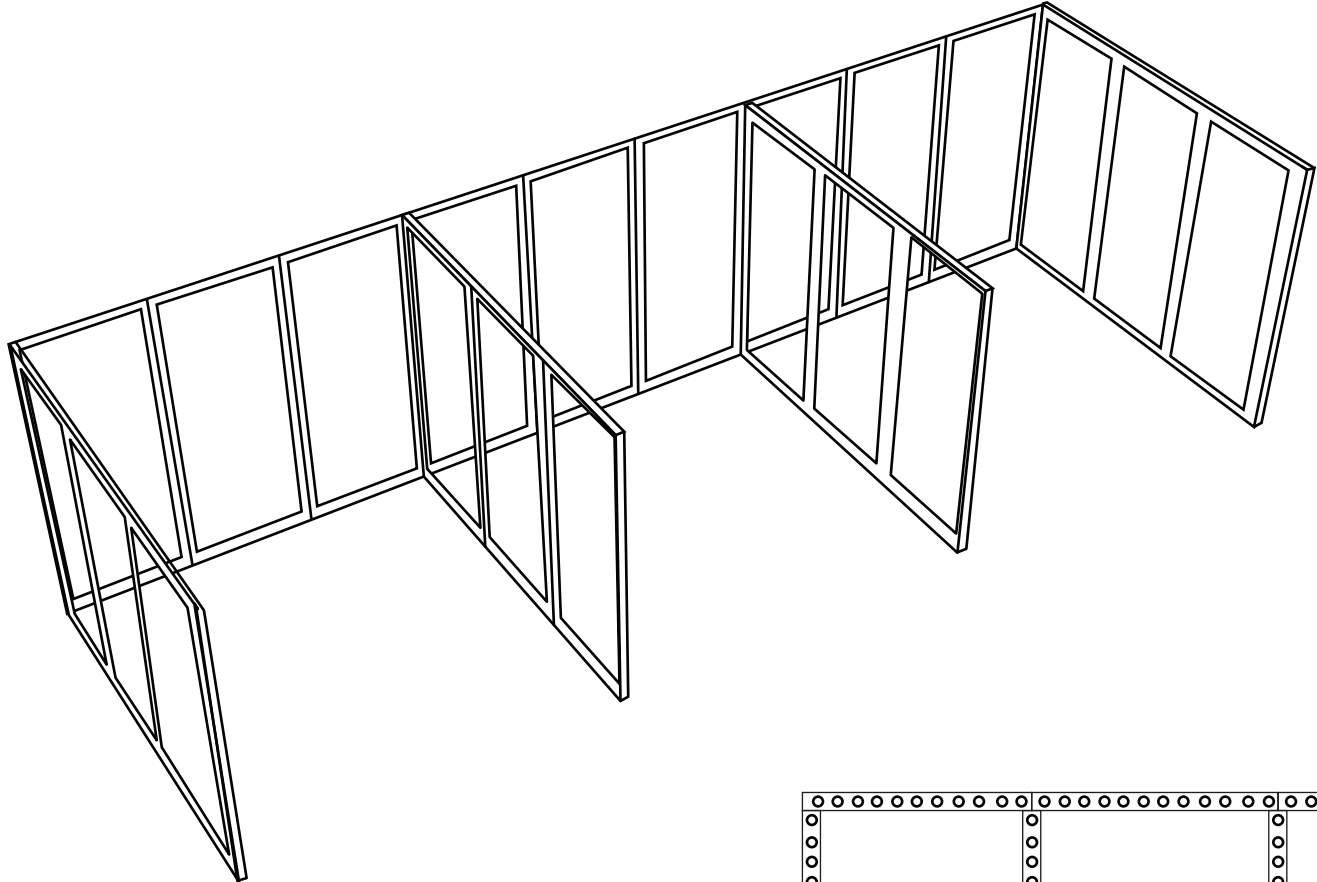

TOP VIEW OF ROOM

MODCO 21 - 30 x10

- Use REF column to reference parts. Attach cover profile to each exposed side (4 sides total).

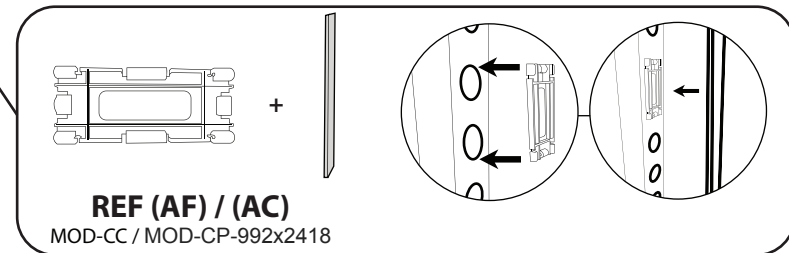
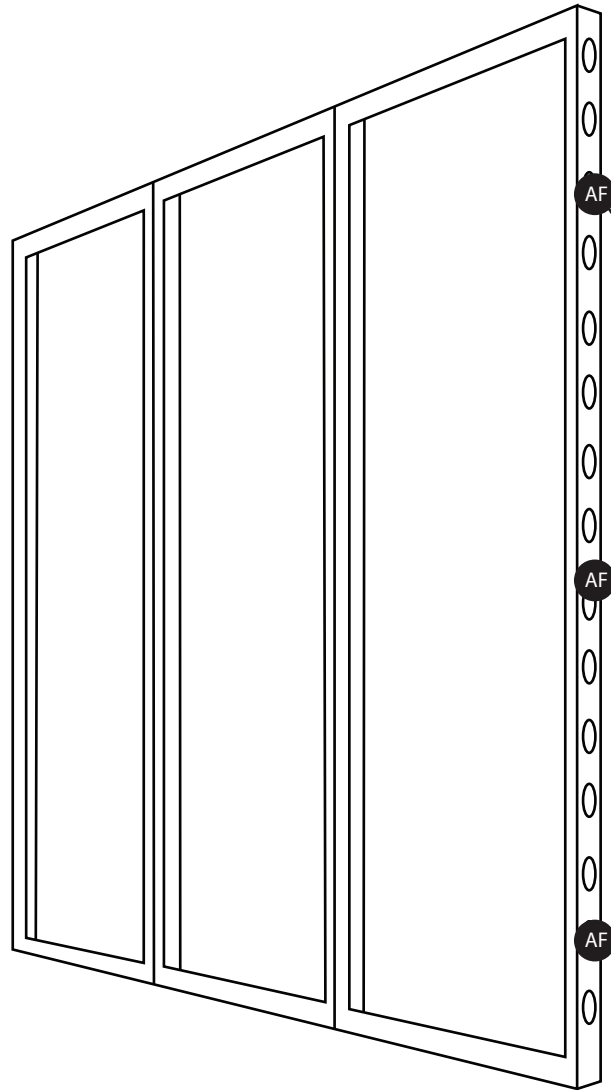

COVER PROFILES & ACCESSORIES

REF	QTY	PART NO.	DESCRIPTION
AC	6	MOD-CP-992x2418	Cover Profile for Frame 992x2418. Flat Model. Anodized
AF	18	MOD-CC	Clip Connector Cover Connects Cover Profile
AL	84	MOD-FP	Modco Frame Protector

GRAPHIC INSTALL



Place graphic over the front of the frame.



Begin inserting SEG beading at each corner.

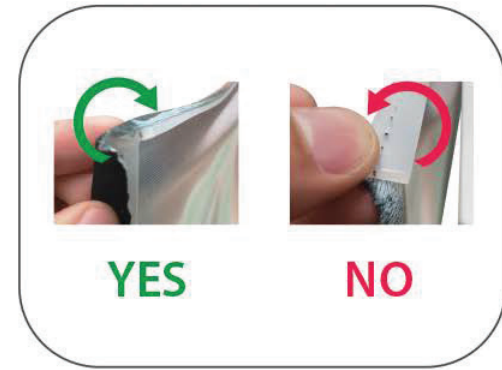

Insert the silicone beading with the fabric folded over. The silicone beading should not be exposed.

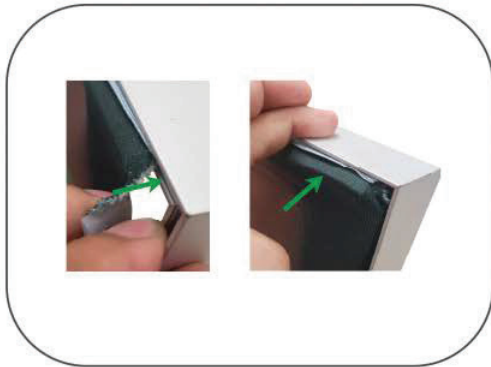

Using your fingers, push both fabric and silicone beading completely into the extrusions channel.



Continue to push in the remaining silicone beading on each side.



Check the perimeter of the frame for any excess beading that hasn't been pushed in. Graphic should be taut.