

MODCO 6A - 15X15

MODCO MODULAR EXHIBITS

PRODUCT CODE: MODCO6A-15x15G



Frame & Graphic

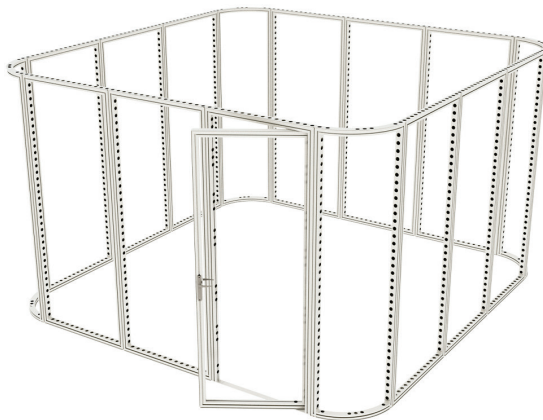

PRODUCT DESCRIPTION

Modco Modular Display 6A is a three-dimensional 15' x 15' pre-designed exhibit room. Stylish and lively, this room is built using tool-free perforated modular aluminum frames and has rounded corners. Multiple size frames connect using tool-less pin connectors. The room features a door w/ lockset and key to complete your meeting room. Perforations are completely covered for a flawless finish.

DISPLAY DIMENSIONS		180"W X 95.25"H X 180"D
GRAPHIC SIZES	SIZE	QTY
	118"W x 96.25"H	6
	79.11"W x 96.25"H	2
	31"W x 96.25"H	4
	27.75"W x 96.25"H	4
	35.25"W x 94.37"H	2
TOTAL		18

GRAPHIC MATERIAL

Stretch Fabric w/ Integrated Block Out

GRAPHIC FINISHING

Silicone beading is sewn around the perimeter of the fabric graphic. Silicone beading is hidden from view once installed.

DISPLAY CONSTRUCTION

Aluminum frame and components

SHIPPING WEIGHTS & DIMENSIONS (FREIGHT ONLY)

Shipping Weight	1073lbs w/ crate
Shipping Dimensions	102"L x 45"W x 58"H

GRAPHIC TURN AROUND TIME

4 business days after proof approval

AVAILABILITY	PFC / PA
--------------	----------

Parts List Key

FRAMES			
REF #	QTY	PART NO.	DESCRIPTION
11	1	MOD-FRM-992x2418	Straight Frame, Corner Screw Connect 992mm x 2418mm
21		MOD-DSWL-992x2418	Door Set w/ Lock 992mm x 2418mm
34		MOD-CRVFRM-774x2418	1/4 Curved Frame, welded 774mm x 2418mm
CONNECTORS, ACCESSORIES & COVER PROFILES			
REF #	QTY	PART NO.	DESCRIPTION
A2		MOD-PCWP-A	Pin Connector for Door Jamb
B6	1	MOD-PC	Pin Connector
D2	8	MOD-CLA-CON	Clamp Connector
E4		MOD-DCC-180D	Door Clamp Connector, 180 Degrees (Connect to Wall Frame)
F1	6	MOD-180D-CON	180 Degree Connector
G4	8	MOD-FP	Modco Frame Protector
H7		MOD-CRV-180DCR	Modco Curve 180 Degree Connector (Right)
I8		MOD-CRV-180DCL	Modco Curve 180 Degree Connector (Left)

PARTS REFERENCE

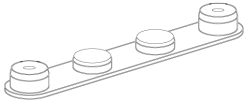

180° Connector
MOD-180D-CON
Qty.28

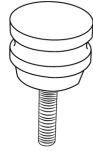

Pin Connector
MOD-PC
Qty.61

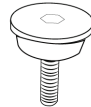

Door Pin Connector
MOD-PCWP-A
Qty.2

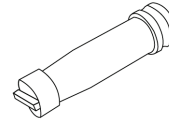

Door Clamp Connector
MOD-DCC-180D Qty.4

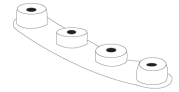

180° Curved Connector
MOD-CRV-180DCL Qty.8
MOD-CRV-180DCR Qty.7

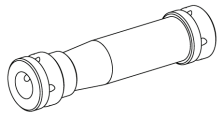

Clamp Connector
MOD-CLA-CON
Qty.28

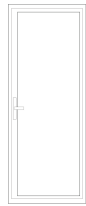

95" Door
MOD-DSWL-992x2418
Qty.1



992 x 2418
MOD-FRM-992x2418
Qty.11



774 x 2418 Curved
MOD-CRVFRM-774x992
Qty.4

INSTRUCTIONS

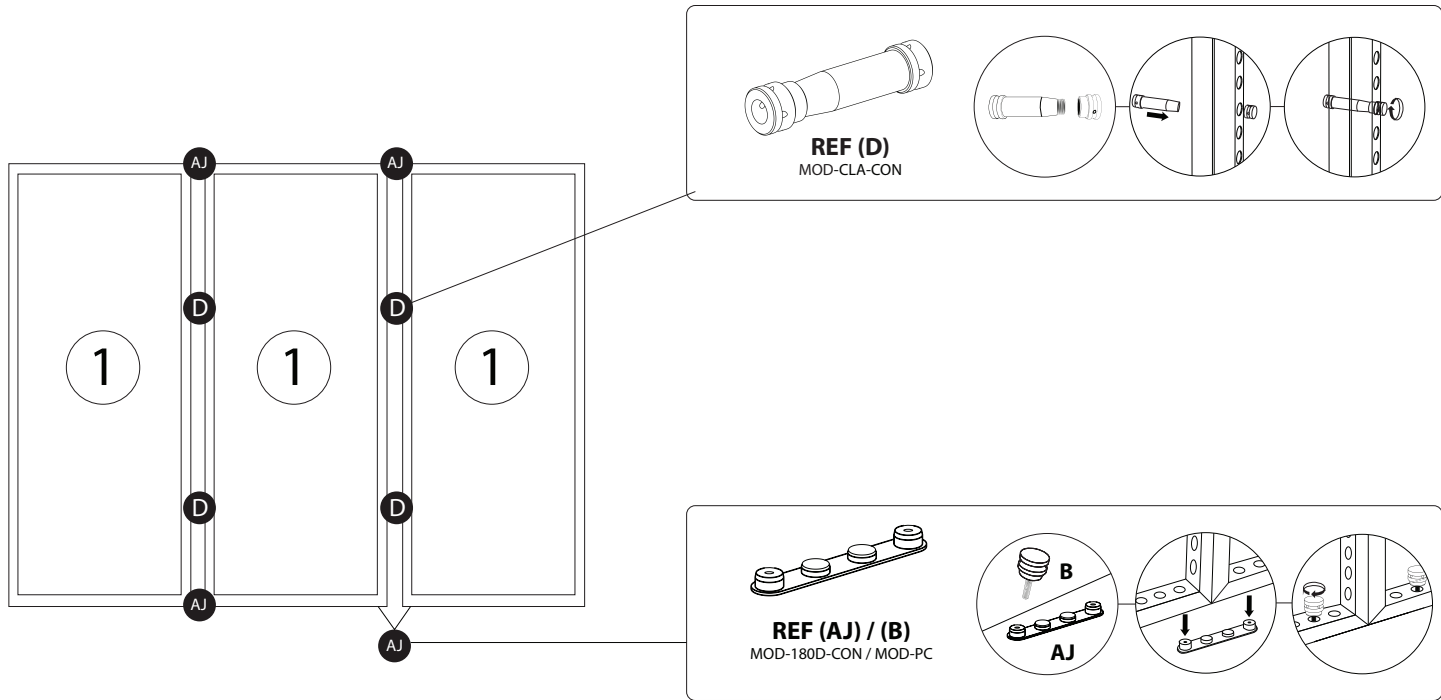

- Continue using the curved frame 'REF 3' for each corner.

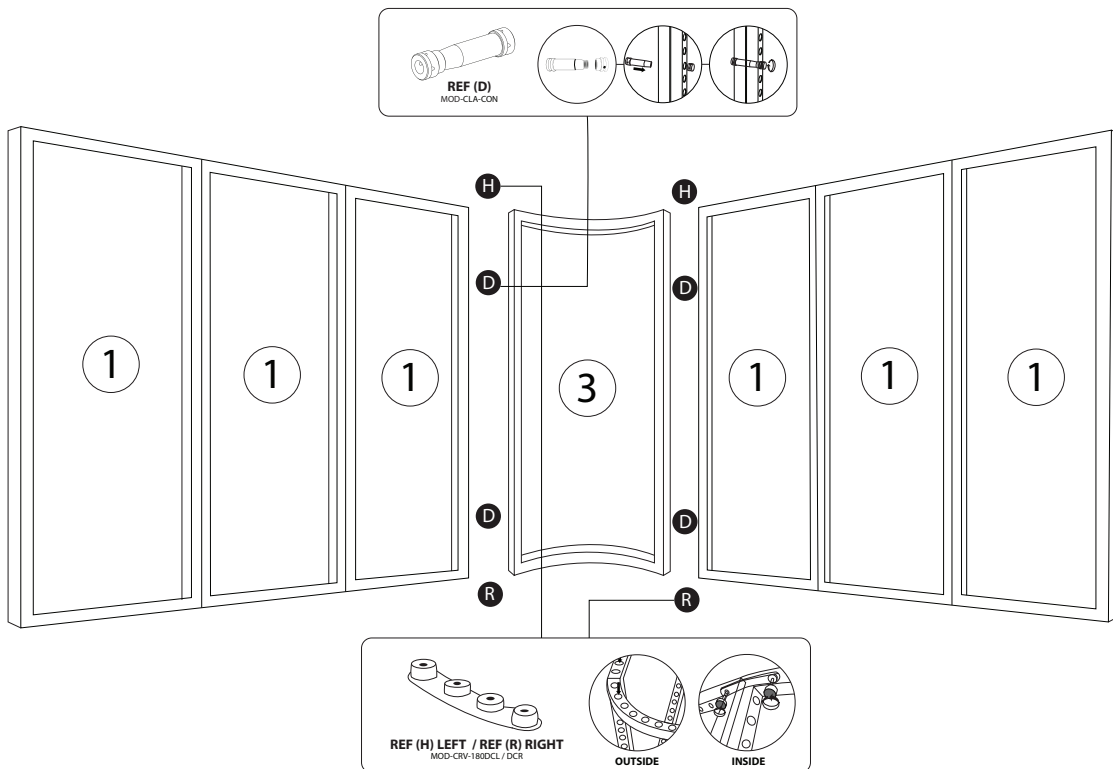





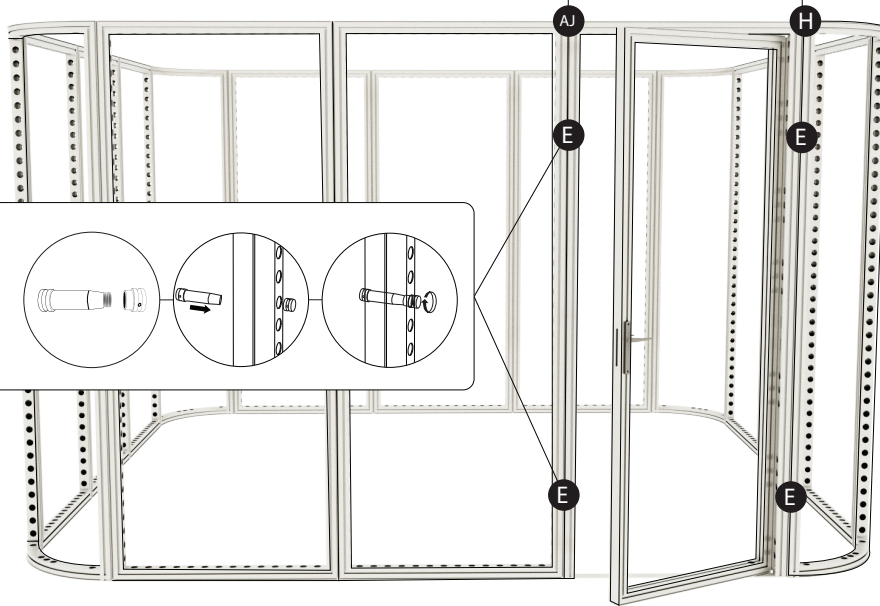
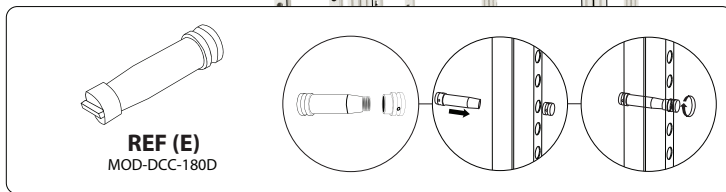
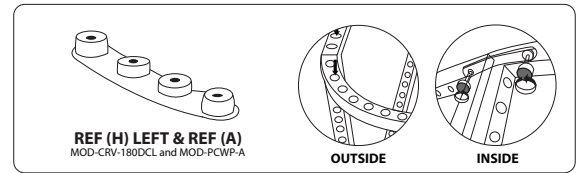
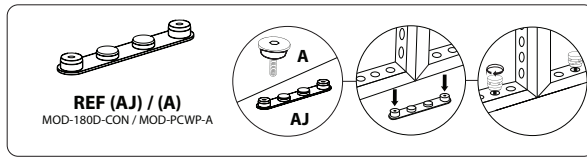

INSTRUCTIONS

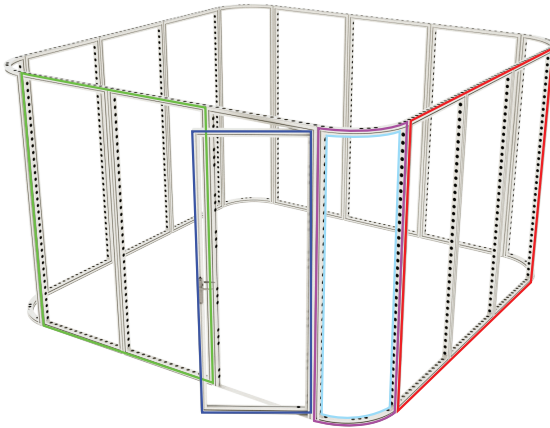
- Respective to Door corner only



GRAPHIC REFERENCES



-  2976 x 2418 INSIDE/OUTSIDE - Qty.6
-  1984 x 2418 INSIDE/OUTSIDE - Qty.2
-  774 x 2418 OUTSIDE - Qty.4
-  774 x 2418 INSIDE - Qty.4
-  992 x 2418 DOOR INSIDE/OUTSIDE - Qty.2



Place graphic over the front of the frame.



Begin inserting SEG beading at each corner.

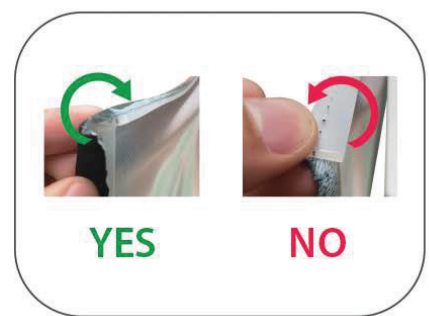

Insert the silicone beading with the fabric folded over. The silicone beading should not be exposed.

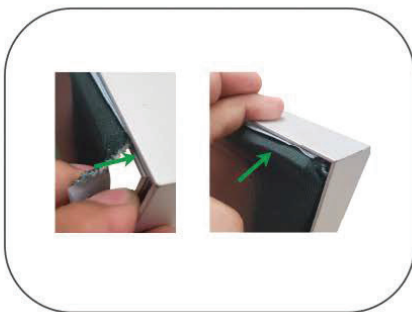

Using your fingers, push both fabric and silicone beading completely into the extrusions channel.

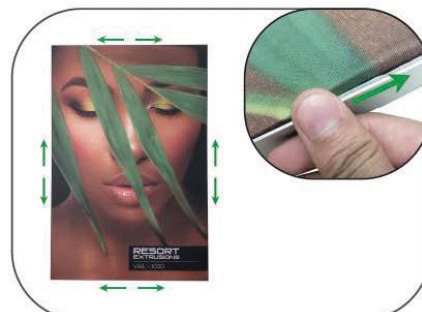

Continue to push in the remaining silicone beading on each side.

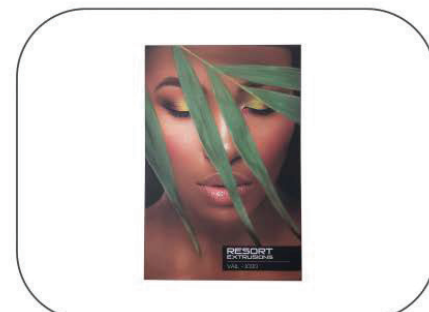

Check the perimeter of the frame for any excess beading that hasn't been pushed in. Graphic should be taut.