

MODCO30 Instructions

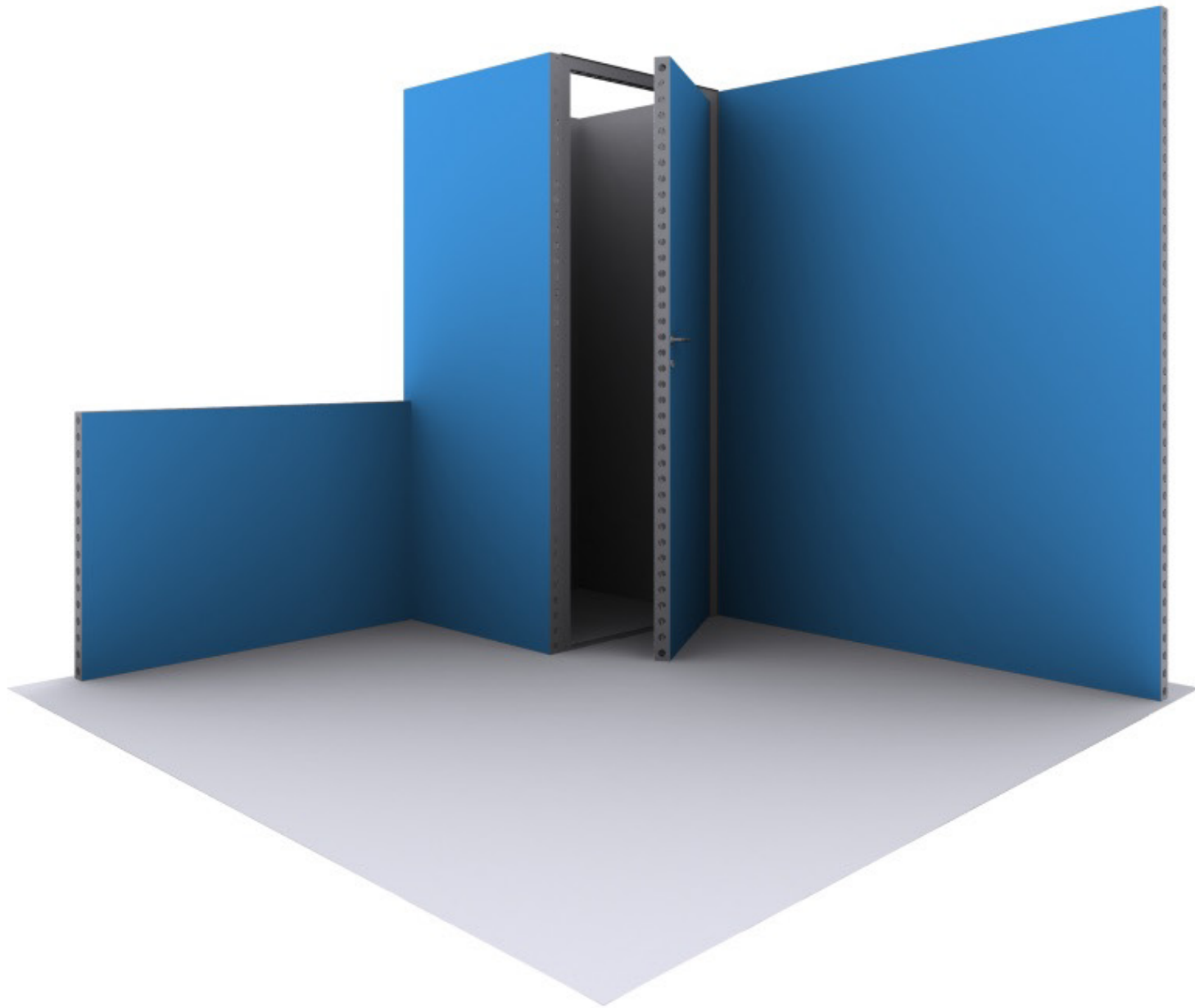

PARTS LIST

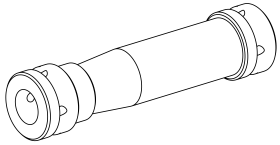

MOD-CLA-CON
Qty.2

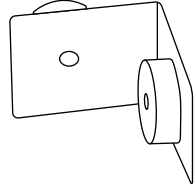

MOD-90D-CON
Qty.8

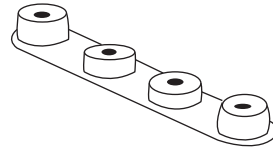

MOD-180D-CON
Qty.4

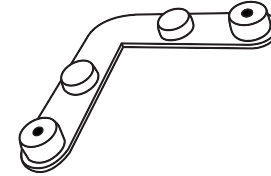

MOD-SM90D-CON
Qty.4



MOD-FRM-992x2418
Qty.5

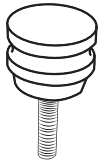

MOD-PC
Qty.36



MOD-FRM-992x1488
Qty.1

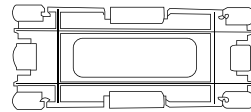

MOD-CC
Qty.16



MOD-CP-992x2418
Qty.4



MOD-CP-3100 (39'')
Qty.1

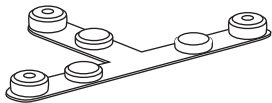

MOD-T90D-CON
Qty.1



MOD-DSWL-992x2418
Qty.1



MOD-CP-3100 (55'')
Qty.1

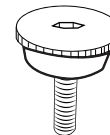

MOD-PCWP-A
Qty.6

Room and Door

- Use letter in REF column and parts list for reference.

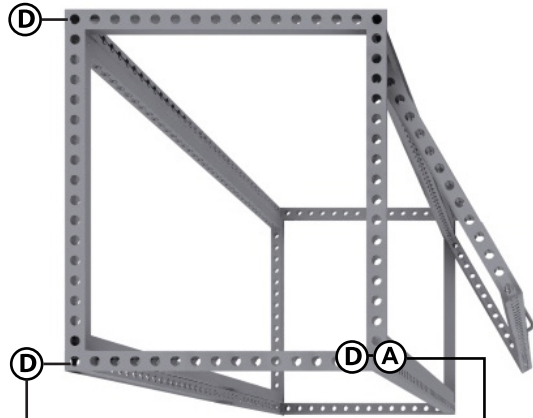

SCAN FOR (C) + (B)

(C) + (B)
MOD-90D-CON + MOD-PC VIDEO TUTORIAL

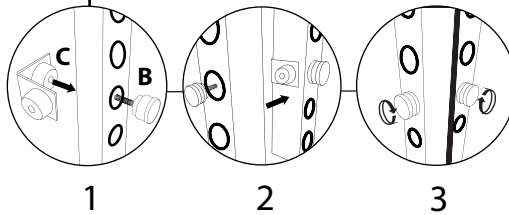

SCAN FOR (D) + (B)

(D) + (B)
MOD-SM90D-CON / MOD-PC VIDEO TUTORIAL

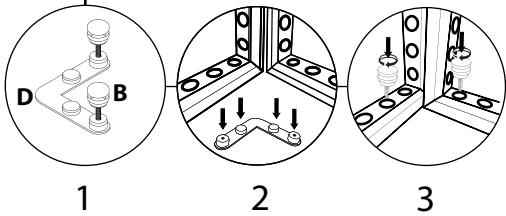

(D) + (B) + (A*)
*MOD-PCWP-A goes inside of door jamb

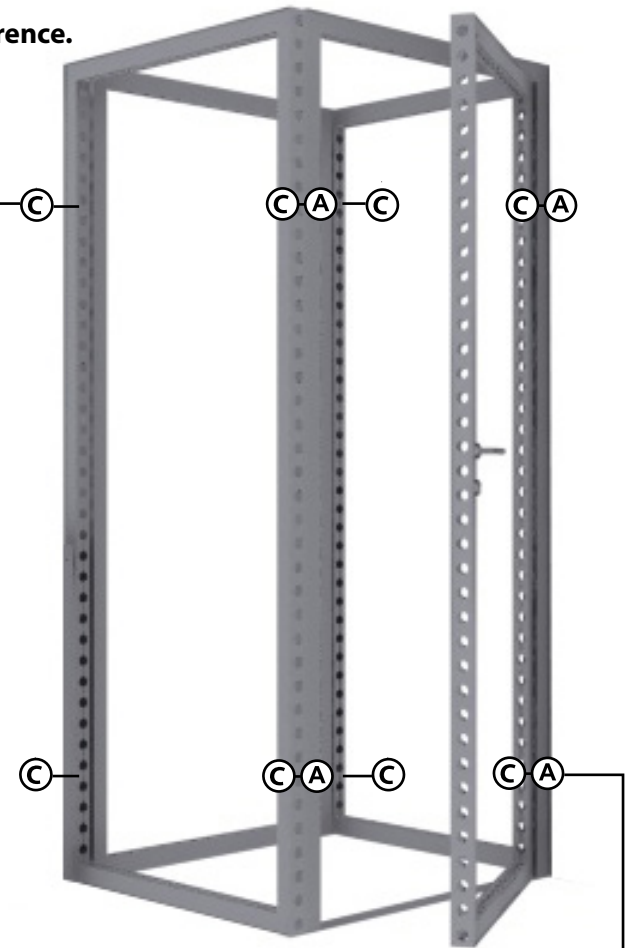

(C) + (B) + (A*)
*MOD-PCWP-A goes inside of door jamb

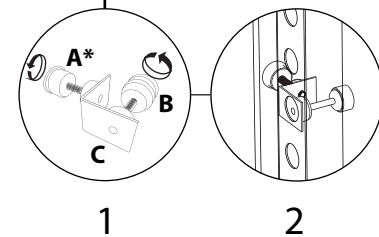

CONFIGURATION PARTS LIST

REF	QTY	PART NO.	DESCRIPTION
1	5	MOD-FRM-992x2418	Straight Frame, Corner Screw Connect 992mm x 2418mm
10	1	MOD-FRM-992x1488	Straight Frame, Corner Screw Connect 992mm x 1488mm
19	1	MOD-DSWL-992x2418	Door Set w/Lock 992mm x 2418mm
E	2	MOD-CLA-CON	Clamp Connector
C	8	MOD-90D-CON	Middle or Center 90° Connector
AJ	4	MOD-180D-CON	180 Degree Connector
D	4	MOD-SM90D-CON	Top/Bottom/Outside 90° Connector
B	36	MOD-PC	Pin Connector
A	6	MOD-PCWP-A	Pin Connector for Door Jamb
H	1	MOD-T-90DCON	T Shape 3 Way 90 Degree Connector Used per Set of 2pcs

Return and Back Wall

- Use letter in REF column and parts list for reference.

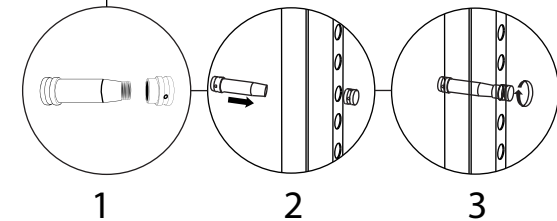
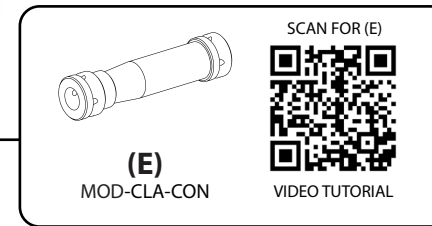
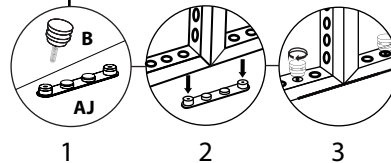
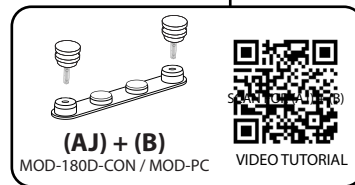
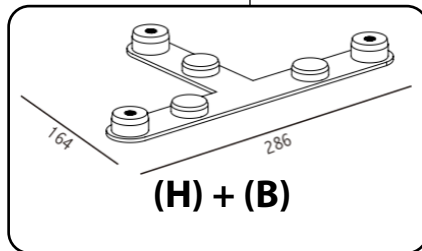
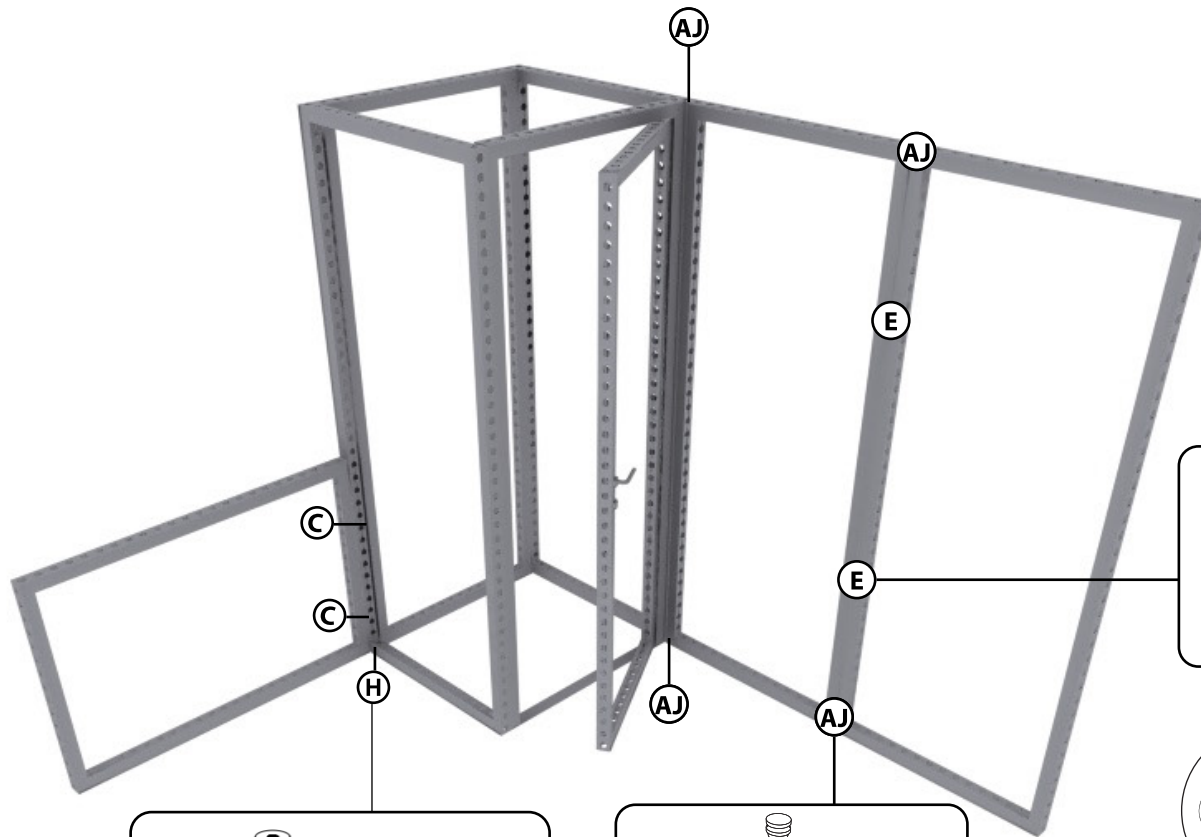

Cover Profiles

- Use letter in REF column and parts list for reference.

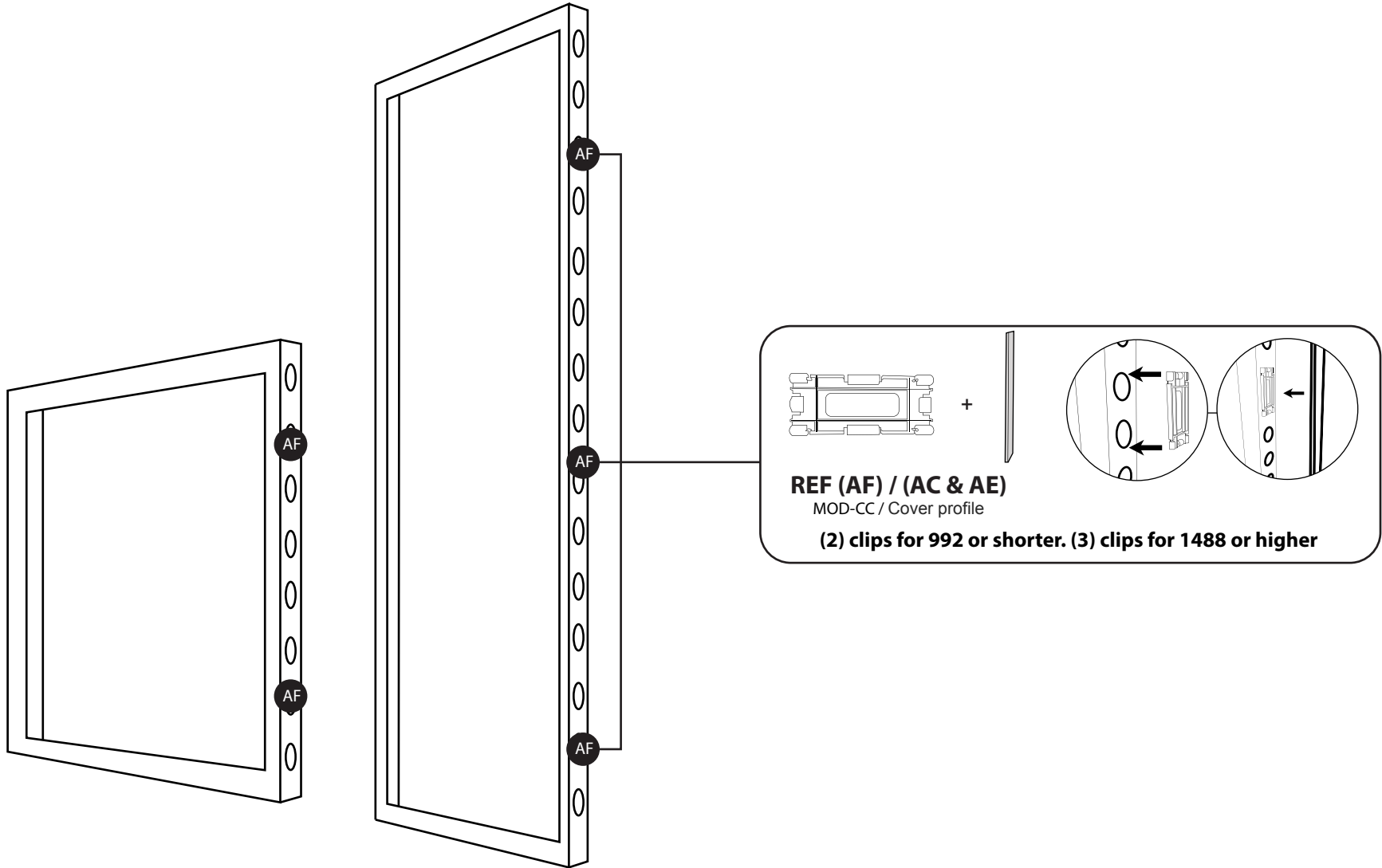

COVER PROFILES LIST

AC	4	MOD-CP-992x2418	Cover Profile for Frame 992x2418. Flat Model. Anodized
AE	2	MOD-CP-3100	39" and 55.5" Cover Profile, Bar Per 3100mm Cover Profile. Flat Model. Anodized
AF	16	MOD-CC	Clip Connector Cover Connects Cover Profile
AL	24	MOD-FP	Modco Frame Protector

Graphic Fitment Guide



Place graphic over the front of the frame.

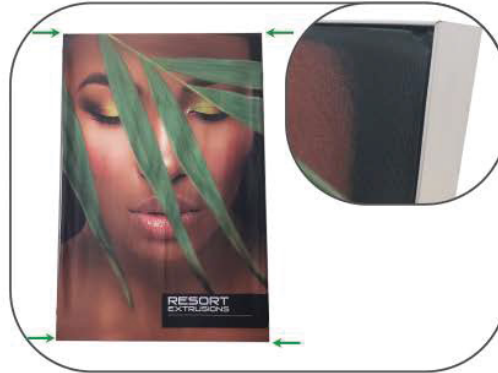

Begin inserting SEG beading at each corner.

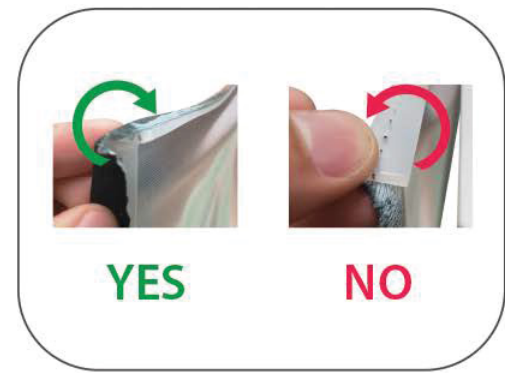

Insert the silicone beading with the fabric folded over. The silicone beading should not be exposed.

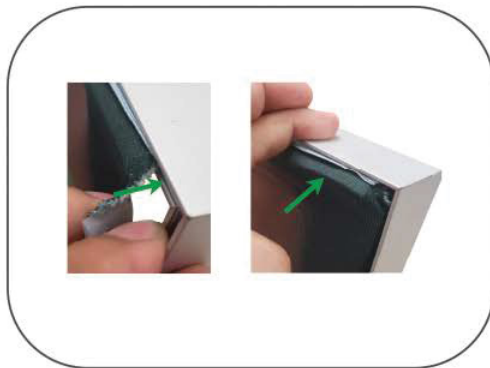

Using your fingers, push both fabric and silicone beading completely into the extrusions channel.

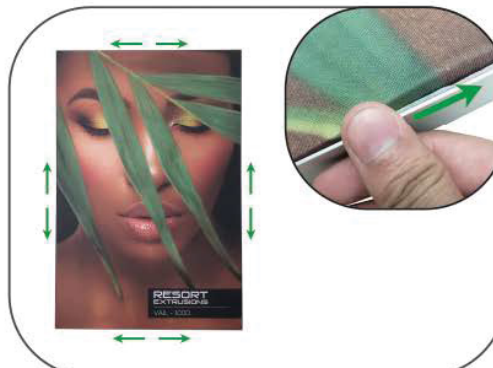

Continue to push in the remaining silicone beading on each side.

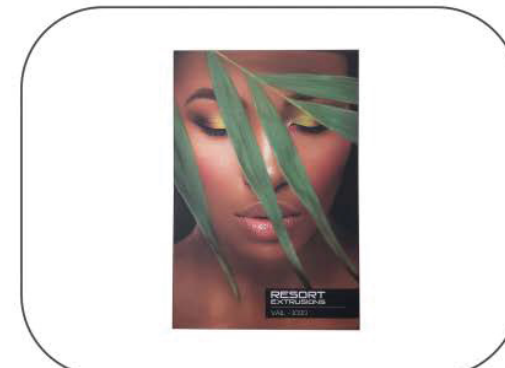

Check the perimeter of the frame for any excess beading that hasn't been pushed in. Graphic should be taut.