

# INDOOR BANNER STANDS

ONE CHOICE - KAI  
PRODUCT CODE: OC-KAI

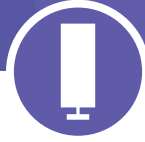

## INSTRUCTIONS

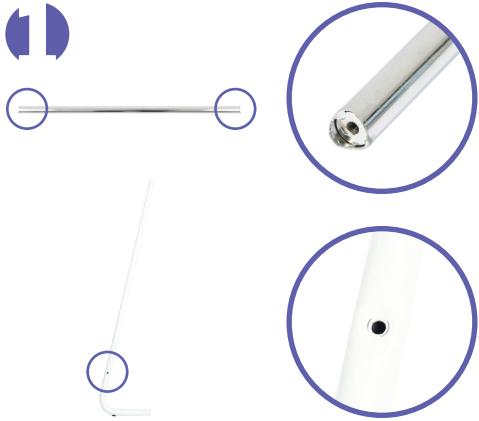

- At each end of the Bottom Support Tube, locate the screw holes. Then locate the holes on each side of the Leg Tubes.

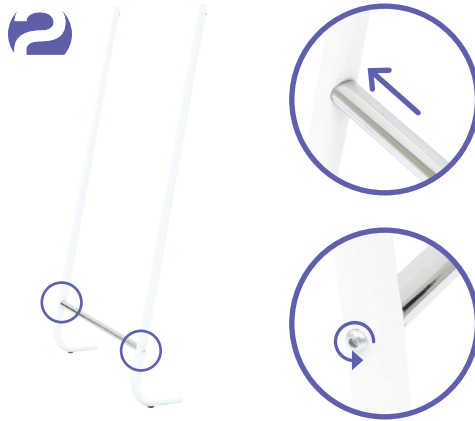

- Align the Bottom Support Tube screw holes with holes of the lower leg tubes on each side. Insert the large screws and tighten to secure with allen key.



- Connect the Bottom Tube and the bottom Leg Tubes to align holes together. Insert the screws and tighten to secure with allen key.

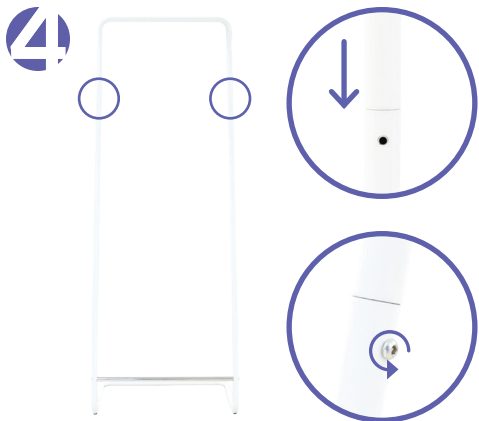

- Insert the Top Tube on top of the Leg Tubes to align holes. Insert the screws and tighten to secure with allen key.

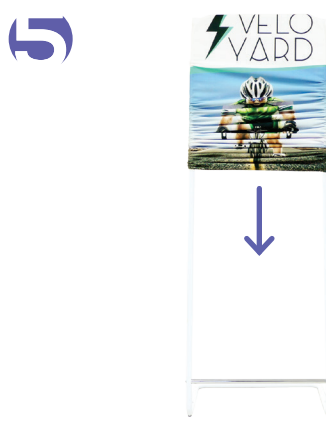

- Swiftly drape with the pillowcase graphic onto the frame. Pull down graphic to cover whole frame.

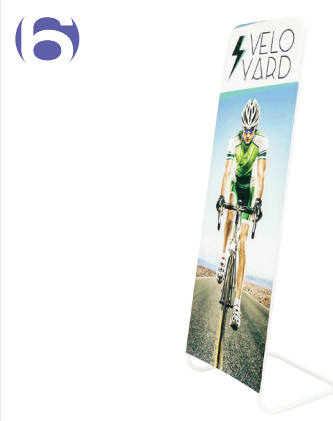

- Complete stand.

