

# 9.8 X 7.4FT. SEGO MODULAR LIGHTBOX DISPLAY

SEGO MODULAR LIGHTBOX DISPLAY  
PRODUCT CODE: SEGO-300X225X12



On frame On graphic



## PRODUCT DESCRIPTION

The advanced technology of the new SEGO modular lightbox system combines innovation with intuition. Toolless down to its feet, SEGO is designed to help heighten your display experience. Magnetic electrical connectors light up the UL certified LED lights that come pre-installed in the profiles. Electrical wires stay hidden from view. Edge-to-edge customizable SEG backlit fabric graphics cover the front and back of the aluminum frame. Portable, configurable, desirable, SEGO is a lightbox unlike the others. SEGO is so well thought out, even its durable foam cut carry bag is made distinctly to keep all parts and pieces protected and organized.

DISPLAY DIMENSIONS	118"W x 88.25"H x 16.5"D
GRAPHIC SIZE	118.625"W x 88.625"H

## GRAPHIC MATERIAL

Dye Sub Backlit Fabric

## GRAPHIC FINISHING

Silicone beading sewn onto edge of graphic

## DISPLAY CONSTRUCTION

Aluminum extrusion frame with plastic components

## SHIPPING WEIGHTS & DIMENSIONS

Shipping Weight Box 1	63 lbs (frame only)
Shipping Weight Box 2	29 lbs (frame only) 34 lbs (frame & graphic)
Shipping Dimensions	54.5"W x 15.5"H x 6.75"D (each)

## GRAPHIC TURN AROUND TIME

2 business days after proof approval (up to 6 sets)

AVAILABILITY	CA
--------------	----

## LED LIGHT SPECIFICATION

BRAND	Osram
POWER	3W
CCT (COLOR TEMP)	6800k
AVERAGE BEAM ANGEL	20 °
LM/W	130
AVG LM/M <sup>2</sup>	4800-5800
VOLTAGE INPUT	24V

## LUMENS

VOLTAGE (V)	24
POWER (W)	270
LM/W	130
TOTAL LM	35100
AVG LM	5850
CU	.8
EAV	4680

## TRANSFORMER SPECIFICATION

POWER RATE 2 TRANSFORMERS	95W, 252W
CERTIFICATES	UL, CE, GEM
VOLTAGE INPUT	100-240V
VOLTAGE OUTPUT	24V

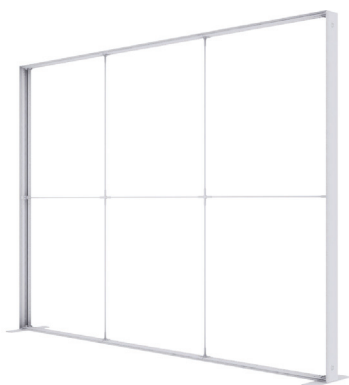

SUPPORT CONNECTION



TOOL FREE ASSEMBLY



MAGNETIC WIRE CONNECTION



CLEAN CABLE MANAGEMENT



TOOL FREE FOOT CONNECTION

# 9.8 X 7.4FT. SEGO MODULAR LIGHTBOX DISPLAY

SEGO MODULAR LIGHTBOX DISPLAY  
PRODUCT CODE: SEGO-300X225X12

## PARTS LIST

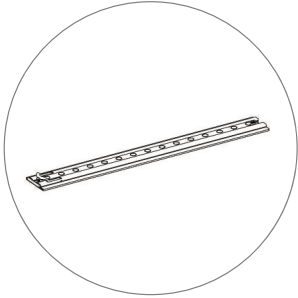

(qty 2)  
Horizontal Profile L



(qty 2)  
Vertical Profile Top

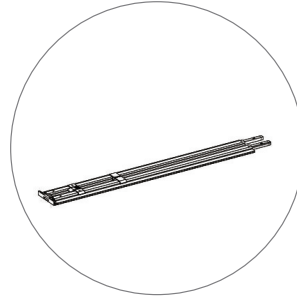

(qty 2)  
Vertical Profile Bottom

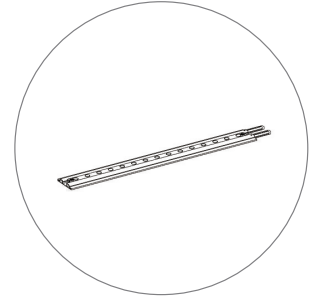

(qty 2)  
Horizontal Profile M

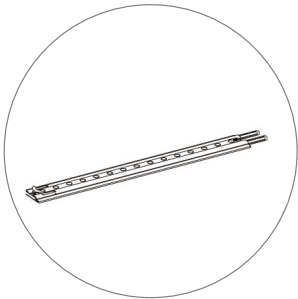

(qty 2)  
Horizontal Profile R

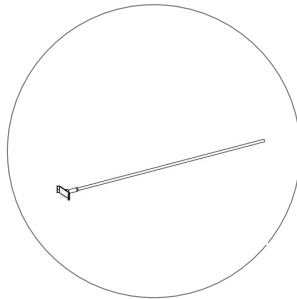

(qty 6)  
Mid Pole

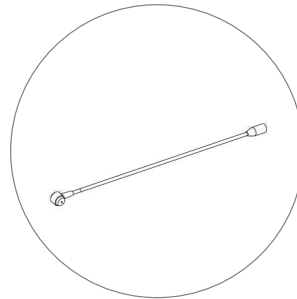

(qty 1)  
S Cable

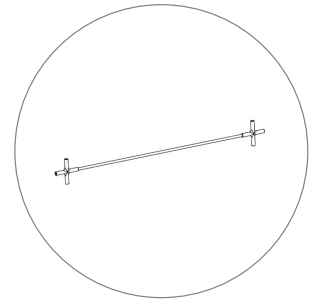

(qty 1)  
Cross Mid Pole

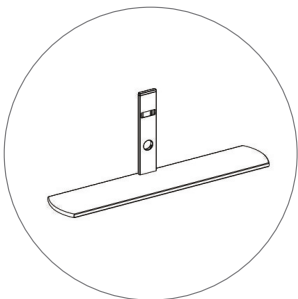

(qty 2)  
Feet

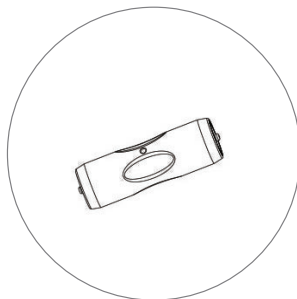

(qty 4)  
LED Connector

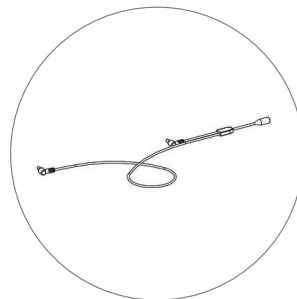

(qty 1)  
S Cable

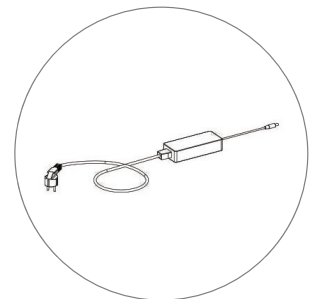

(qty 2)  
Transformer

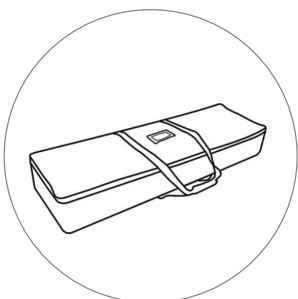

(qty 2)  
Travel Bag

# 9.8 X 7.4FT. SEGO MODULAR LIGHTBOX DISPLAY

SEGO MODULAR LIGHTBOX DISPLAY  
PRODUCT CODE: SEGO-300X225X12

## SET UP INSTRUCTIONS

①

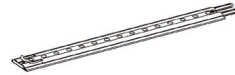

②

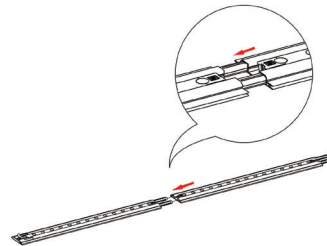

③

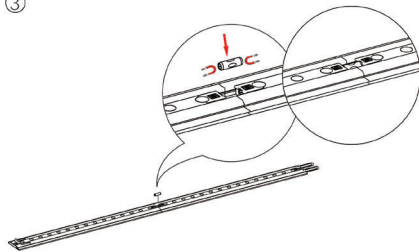

⑤

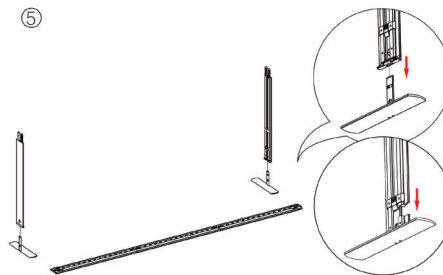

④

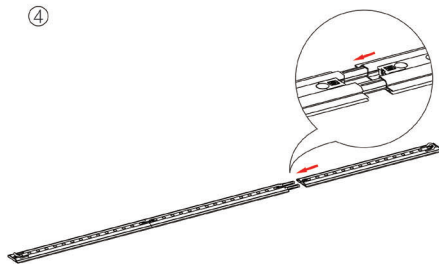

⑥

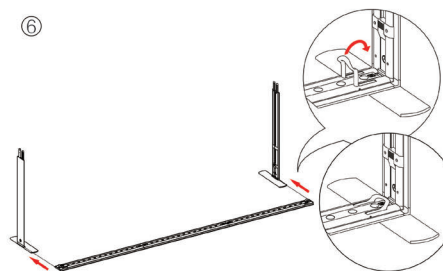

# 9.8 X 7.4FT. SEGO MODULAR LIGHTBOX DISPLAY

SEGO MODULAR LIGHTBOX DISPLAY  
PRODUCT CODE: SEGO-300X225X12

⑦

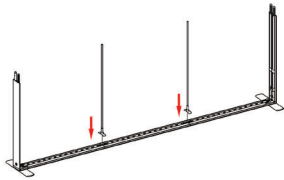

⑨

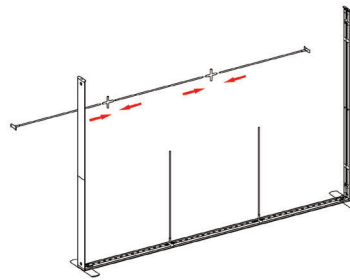

⑧

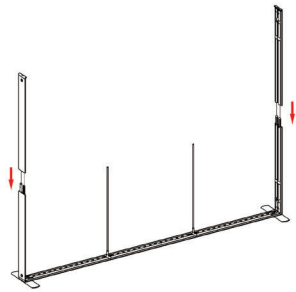

⑩

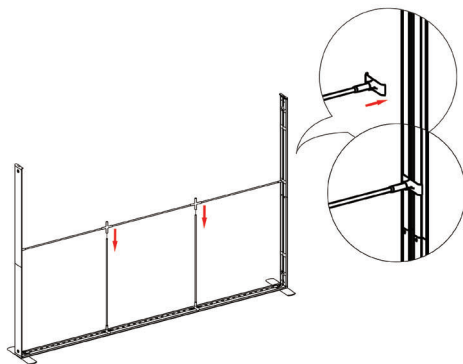

⑪

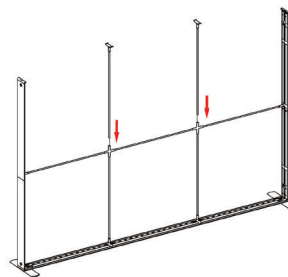

# 9.8 X 7.4FT. SEGO MODULAR LIGHTBOX DISPLAY

SEGO MODULAR LIGHTBOX DISPLAY  
PRODUCT CODE: SEGO-300X225X12

12

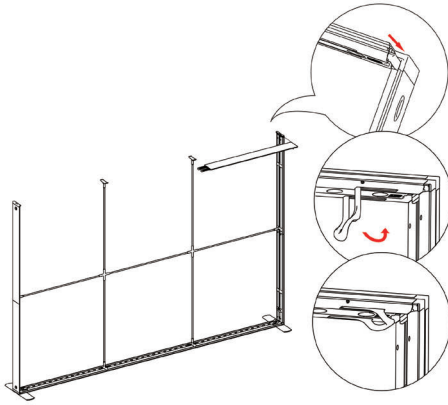

13

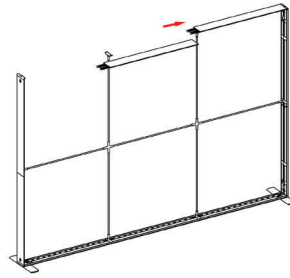

14

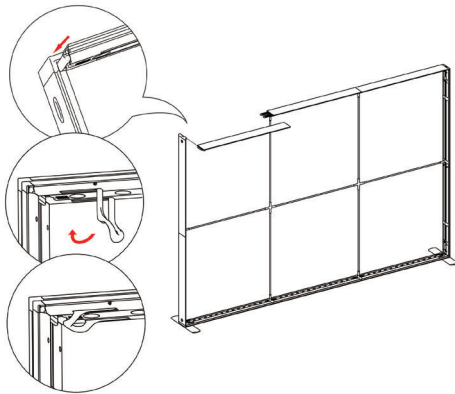

15

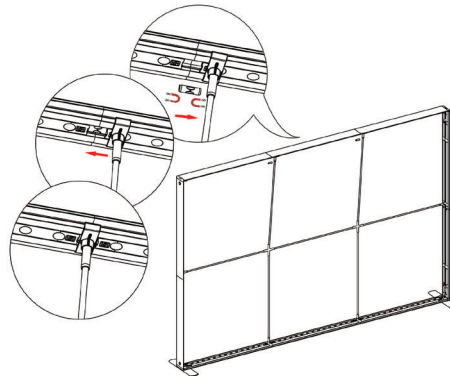

# 9.8 X 7.4FT. SEGO MODULAR LIGHTBOX DISPLAY

SEGO MODULAR LIGHTBOX DISPLAY  
PRODUCT CODE: SEGO-300X225X12

16

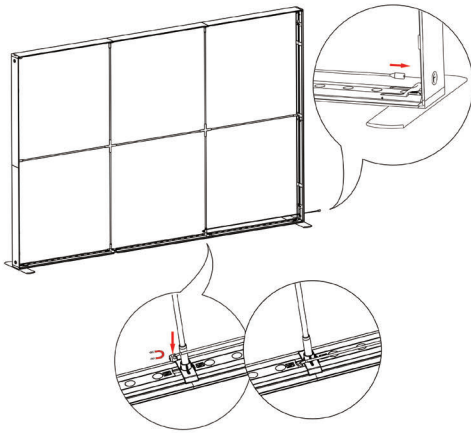

17

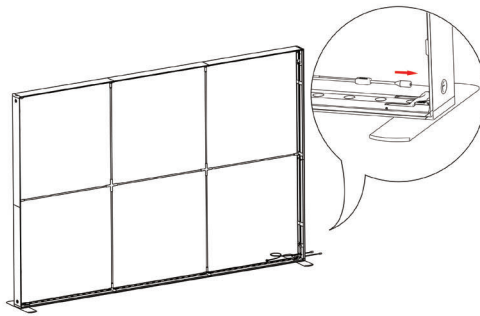

18

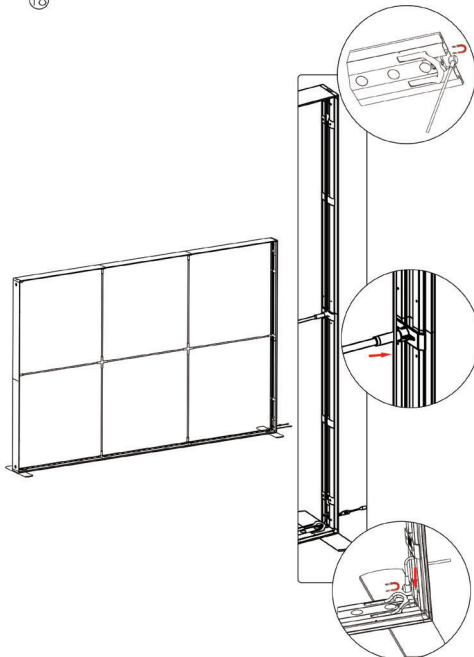

19

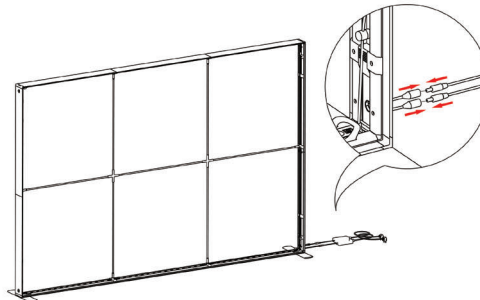

# 9.8 X 7.4FT. SEGO MODULAR LIGHTBOX DISPLAY

SEGO MODULAR LIGHTBOX DISPLAY  
PRODUCT CODE: SEGO-300X225X12



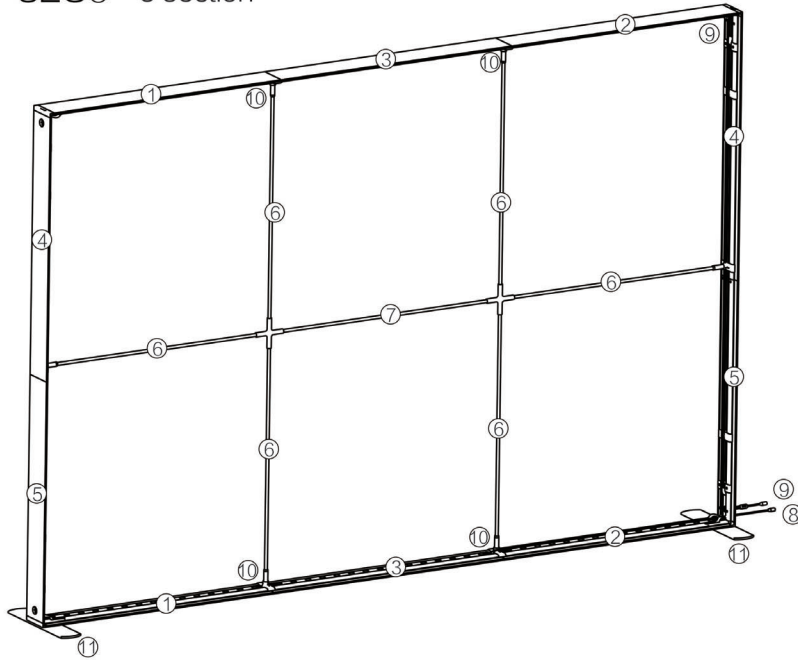









## SEGO 3 section



SEGO  
Mobile Light Box

sego.com

## Part list for 3 section

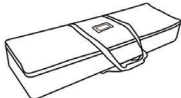
- |  |   |  |   |
|--|---|--|---|
| <br>① Horizontal Profile L x 2    | <br>② Horizontal Profile R x 2 | <br>③ Horizontal Profile M x 2   | <br>④ Vertical Profile Top x 2 |
| <br>⑤ Vertical Profile Bottom x 2 | <br>⑥ Mid Pole 1 end x 6       | <br>⑦ Mid Pole with 2 cross x 1  | <br>⑧ S-Cable x 1              |
| <br>⑨ S-Cable 2.6m x 1            | <br>Transformer x 2            | <br>⑩ LED Extension Connector x 4 | <br>⑪ Foot x 2                 |
| <br>Bag x 2                       |   |  |   |

# 9.8 X 7.4FT. SEGO MODULAR LIGHTBOX DISPLAY

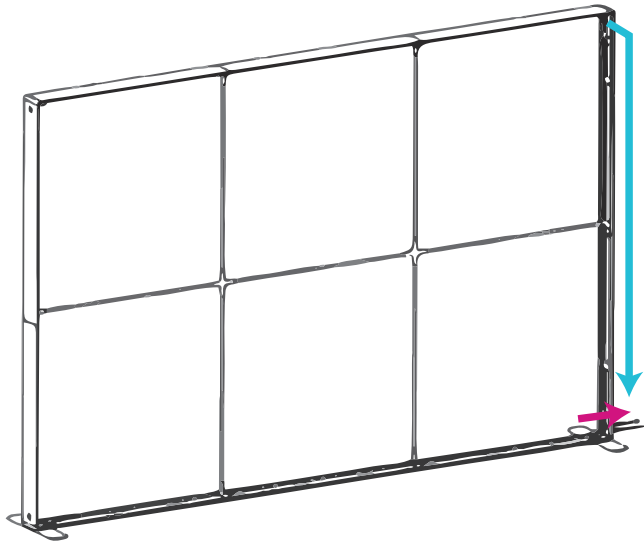

SEGO MODULAR LIGHTBOX DISPLAY  
PRODUCT CODE: SEGO-300X225X12

## INSIDE WIRING

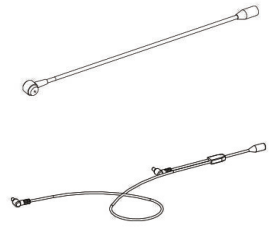

Close Ups



-  S-Cable 1
-  S-Cable 2

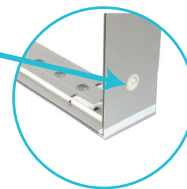
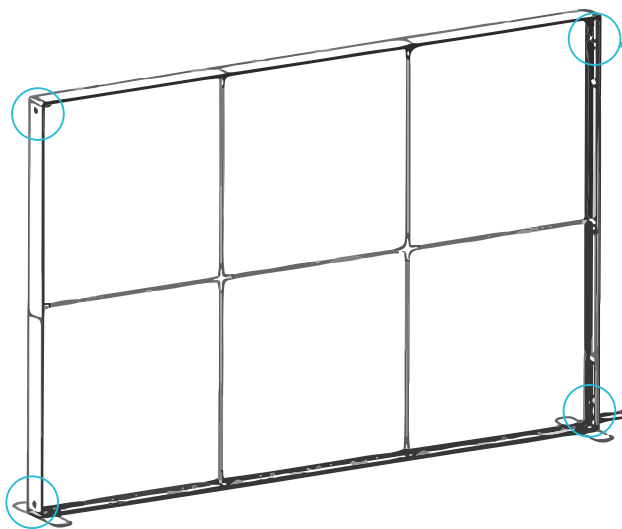

Each SEGO frame has 4 points of exits and entries for the white cables. So you can choose to connect frame from either left or right.

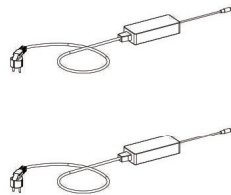
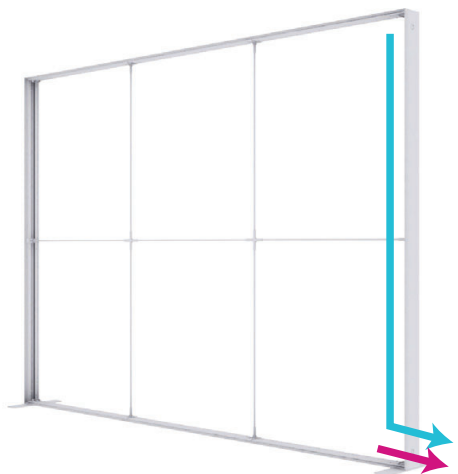

Finally Connect S-Cables to transformers

close up



9.8 X 7.4FT. SEGO will need (2) medium transformers - 152 watts each