

Construo 10' Truss Display

CONSTRUO

The Construo Truss is an innovative display featuring toolless assembly along with 2 Counters, 2 TV Mounts & portable rolling display case that can double as a podium.



features and benefits:

- Toolless assembly
- Kit includes: two counters, two monitor mounts, and one display case
- Five year hardware warranty against manufacturer defects

dimensions:

Hardware

Graphic

Assembled unit:
118.19" w x 93.63" h x 25.5" d
3003mm(w) x 2379mm(h) x 648mm(d)

Refer to related graphic template for more information.

Approximate weight:
117 lbs / 54 kg

One year warranty.

Visit:
www.exhibitors-handbook.com/graphic-templates

Shipping

additional information:

Packing case(s):
1 Case

Graphic material:
Dye-sublimation SEG push-fit fabric

Monitors not included.

Shipping dimensions:
Case: 40" l x 28" h x 19" d
1016mm(l) x 712mm(h) x 483mm(d)

When included in a larger kit, a different packaging solution will be listed to accommodate all contents of the kit. Individual packaging no longer provided.

Approximate total shipping weight:
140 lbs / 64 kg

Tabletop Colors:

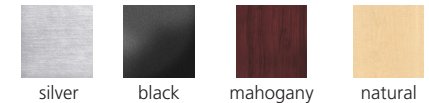

2 person assembly recommended:



We are continually improving and modifying our product range and reserve the right to vary the specifications without prior notice. All dimensions and weights quoted are approximate and we accept no responsibility for variance. E&OE. See Graphic Templates for graphic bleed specifications.

Included In Your Kit

Tools, Components, & Connectors



CONSTRO-CT-1B x2

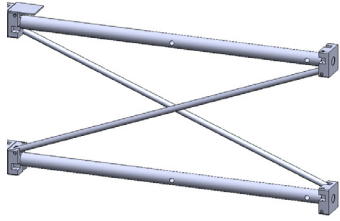

CONSTRO-CANOPY-TRUSS-I x2

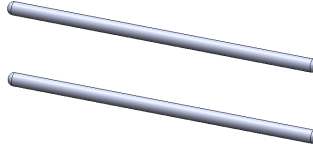

CONSTRO-MM-RAIL x4

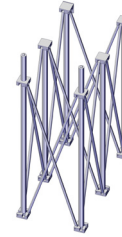

CONSTRO-BTM-TRUSS-L x1

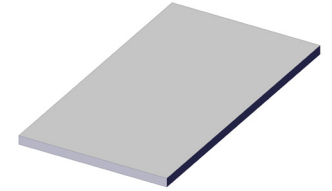

CONSTRO-BASE x2

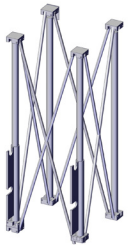

CONSTRUO-MID-TRUSS-L x1



CONSTRO-POLE x1

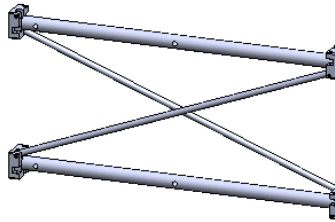

CONSTRO-CANOPY-TRUSS-J x1



CONSTRO-CT-1B x1



CONSTRO-CNTR-SHFT x4

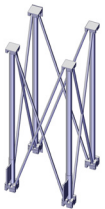

CONSTRUO-TOP-TRUSS-L x1

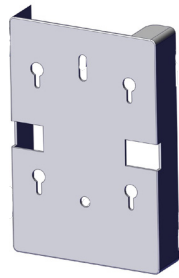

CONSTRUO-MM-BRACKET x2



CONSTRO-FB-WRAP x1

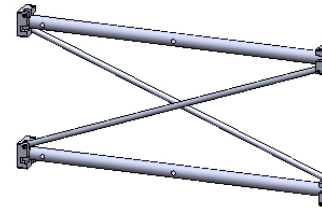

CONSTRO-CANOPY-TRUSS-H x1

Included In Your Kit

Tools, Components, & Connectors

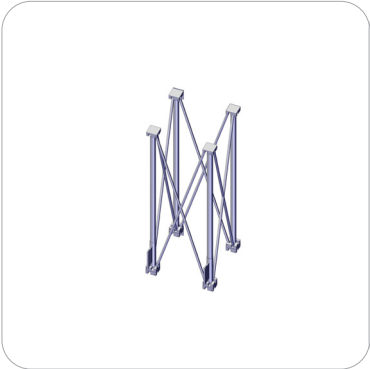

CONSTRO-TOP-TRUSS-R x1

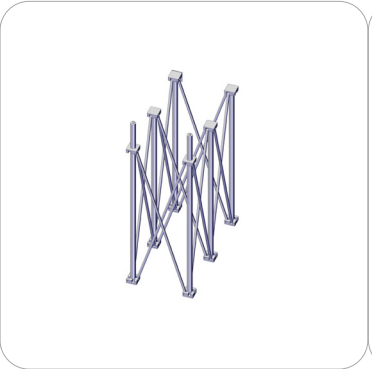

CONSTRO-BTM-TRUSS-R x1

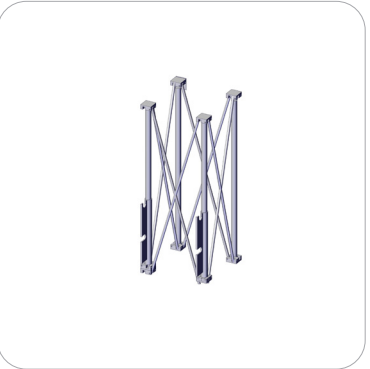

CONSTRO-MID-TRUSS-R x1

Graphics

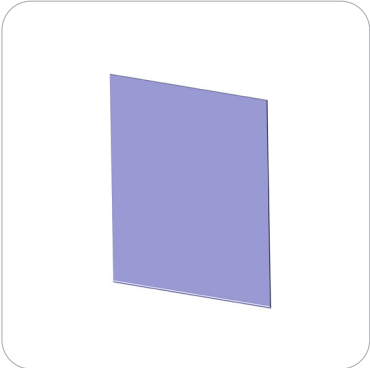

CONSTRUO-G x1

Exploded Diagram

CONSTRUO

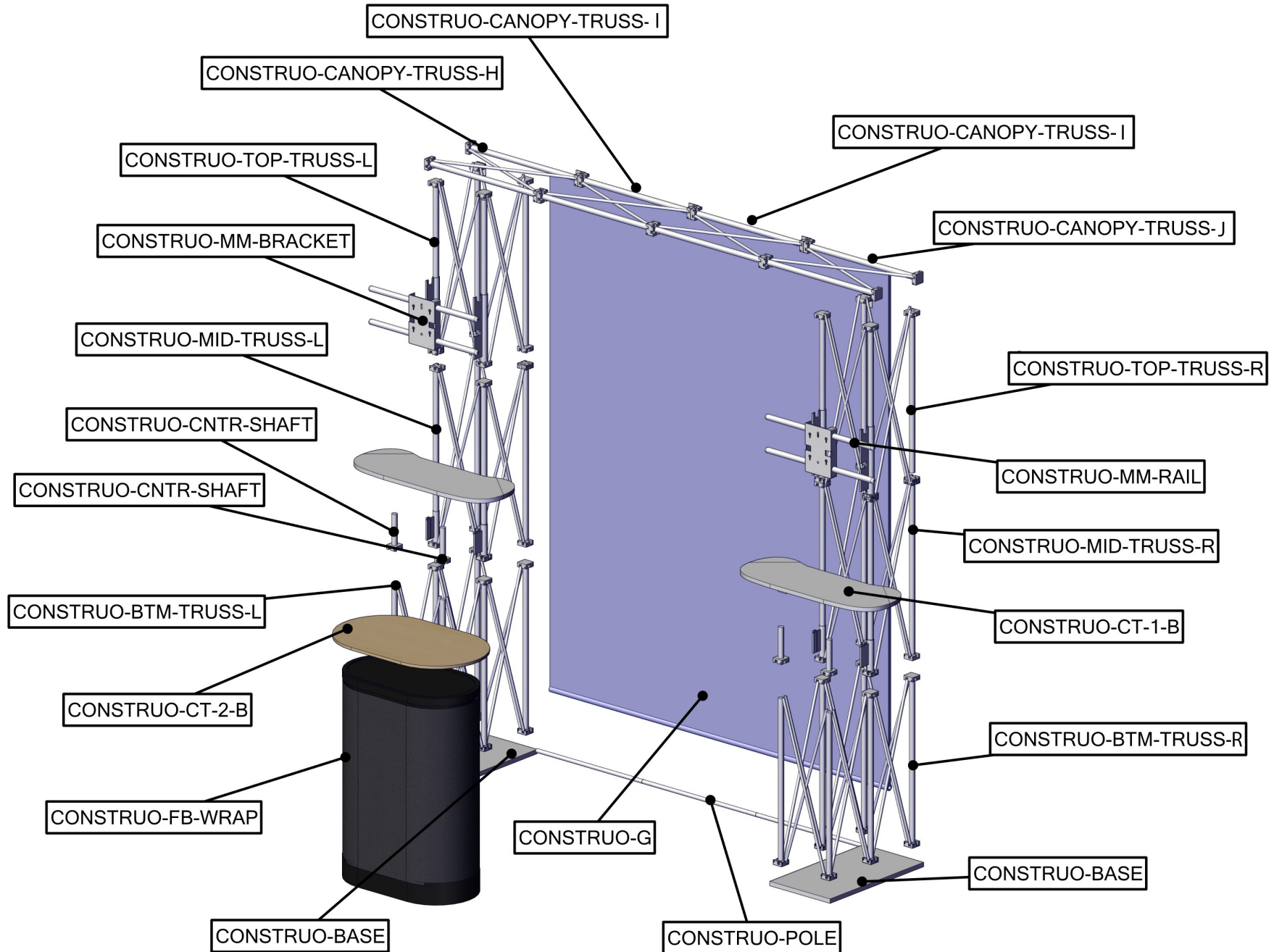

Kit Assembly

Step by Step

Step 1.

Gather the components to Needed to assemble base & section 1 the . Use the Exploded View Diagram for part labels.

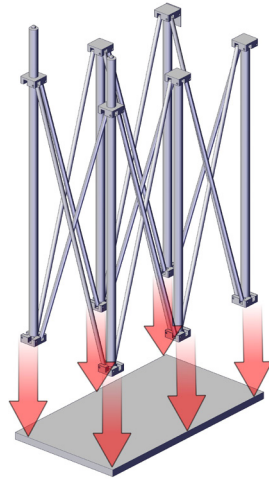
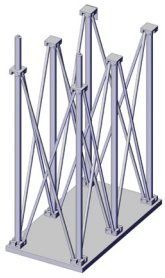

Step 2.

Gather the components to Needed to assemble section 1 & section 2. Use the Exploded View Diagram for part labels.

Reference Connection Method(s) 1 for more details.

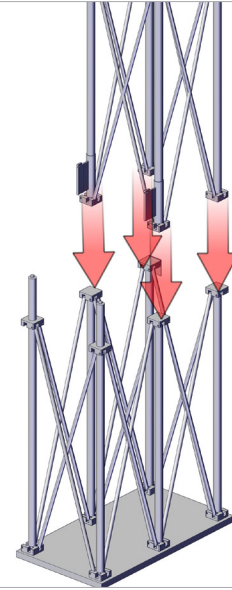

Step 3.

Gather the components needed to attach top section of tower. Use the Exploded View Diagram for part labels.

Reference Connection Method(s) 1 for more details.

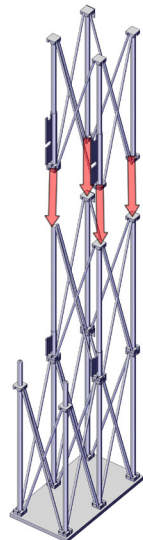

Step 4.

Gather the components to attach monitor mounts. Use the Exploded View Diagram for part labels.

Reference Connection Method(s) 2 for more details.

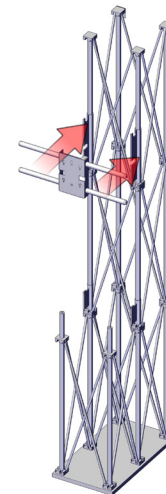

Kit Assembly

Step by Step

Step 5.

Gather the components to assemble top truss. Use the Exploded View Diagram for part labels.

Reference Connection Method(s) 1 for more details.

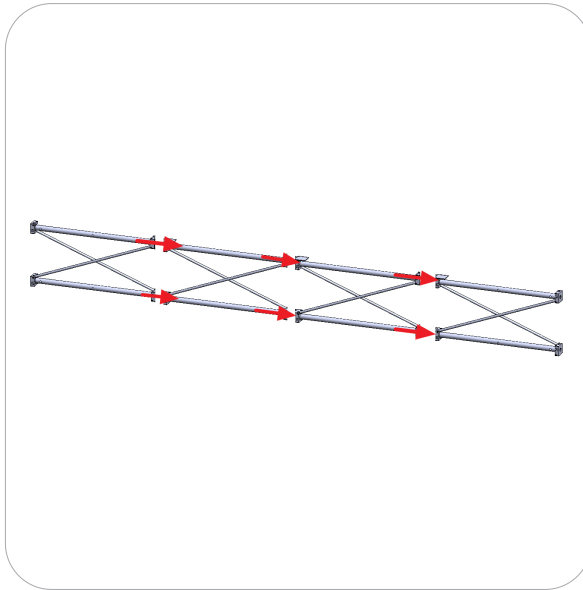

Step 6.

Gather the components to attach top truss. Use the Exploded View Diagram for part labels.

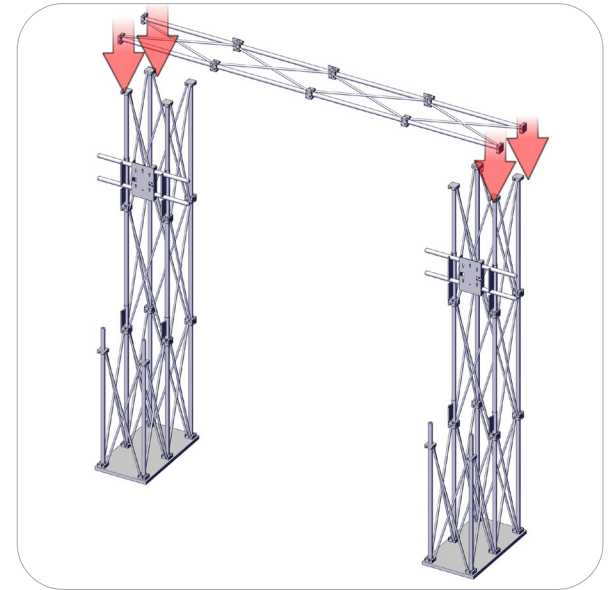
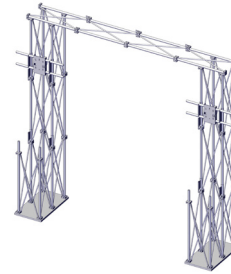

Step 7.

Gather the components to attach counter tops. Use the Exploded View Diagram for part labels.

Reference Connection Method(s) 3 for more details.

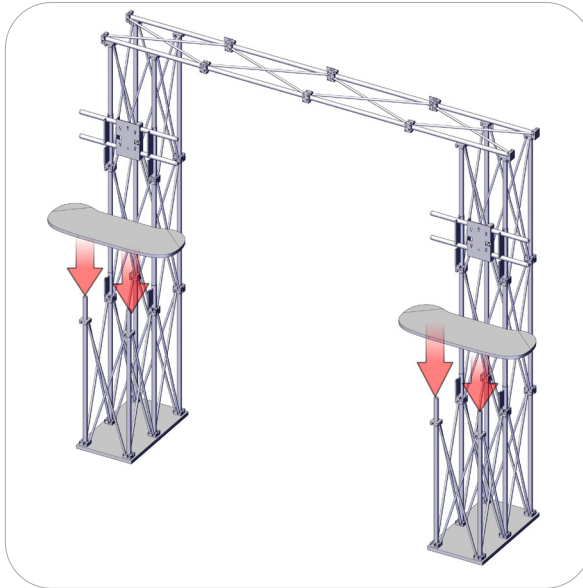

Step 8.

Attach graphic with velcro, along top and sides of truss and towers. Use the Exploded View Diagram for part labels.

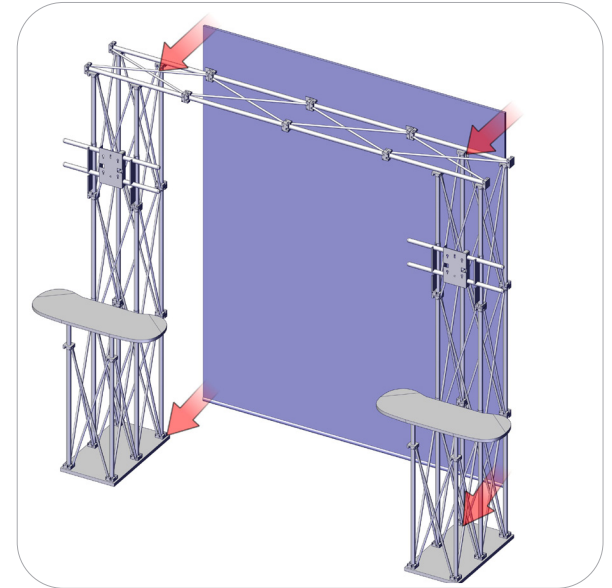
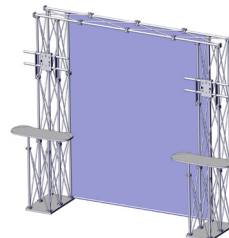

Kit Assembly

Step by Step

Step 9.

Gather the components to assemble bungee cord 3 section pole. once assemble of pole is complete slind in pole pocket. Use the Exploded View Diagram for part labels.

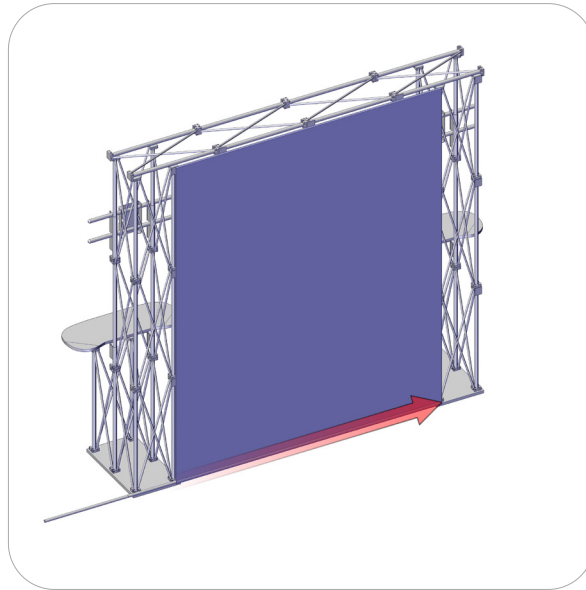
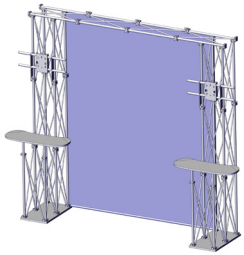

Step 10.

Attach portable case counter.

Setup complete.

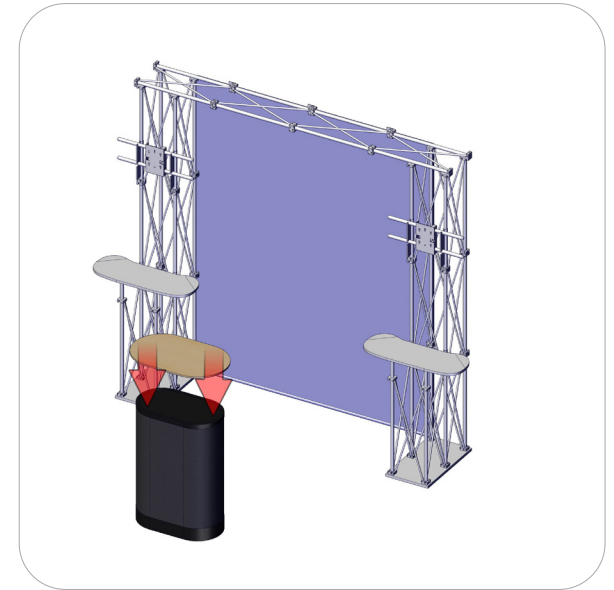
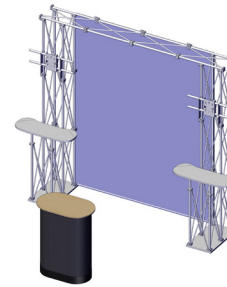

Connection Methods

Connection Method 1: CONNECTING FRAMES

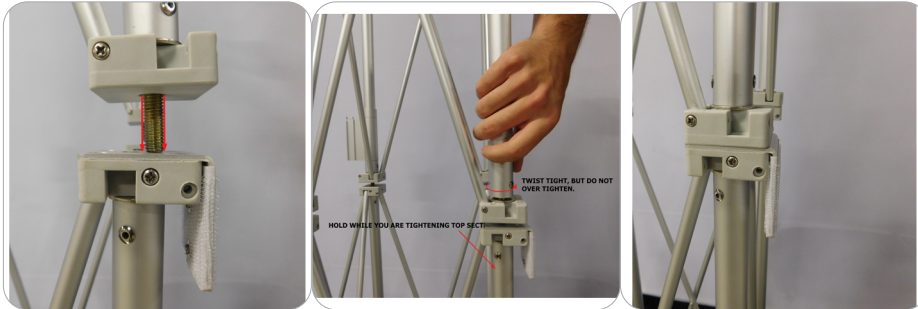

First, insert the threaded screw in to opening of lower frame. once in place, hold lower section pole with your hand(This makes it easy to tighten. If you dont hold the lower pole, both will spin.) and tighten the top pole with the other hand. Be sure not to over tighten, for this could strip or damage the parts.

Connection Method 2: ASSEMBLE MONITOR MOUNT



First, untighten the screw at top. Once the screw is loose, pull the lever up til you can slide the mount in the groove. Once in place pull lever down til it stops. Lightly tighten screw to assure it does not strip or damage parts.

Connection Method 3: COUNTER TOP ASSEMBLY



First, screw the CONSTRUO-CNTR-SHFT in to the top of the CONSTRUO-BTM-TRUSS LEFT & RIGHT. Second, only half tighten the CONSTRUO-CNTR-SHFT into place. If you tighten all the way, you will not be able to attach the counter. Third, A line both connect points, once a lined attach counter. Once counter is attached, tighten the CONSTRUO-CNTR-SHFT, but be sure not to over tighten.