

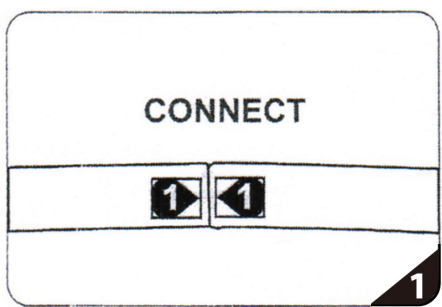

FABRIC DISPLAYS

ONE CHOICE - 10 FT. FABRIC DISPLAY - STRAIGHT
 PRODUCT CODE: OC-EZT10STRG1 & OC-EZT10STRG2

INSTRUCTIONS



Connect numbered tubes together.

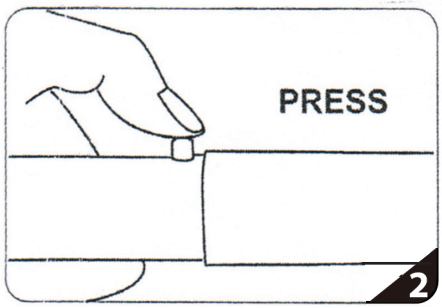

Snap tubes together.

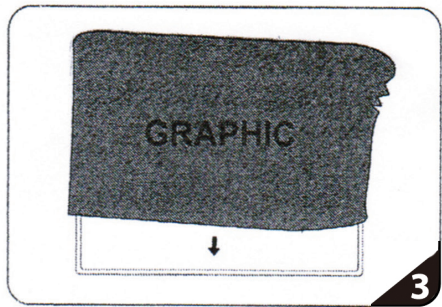

Cover frame with fabric graphic.

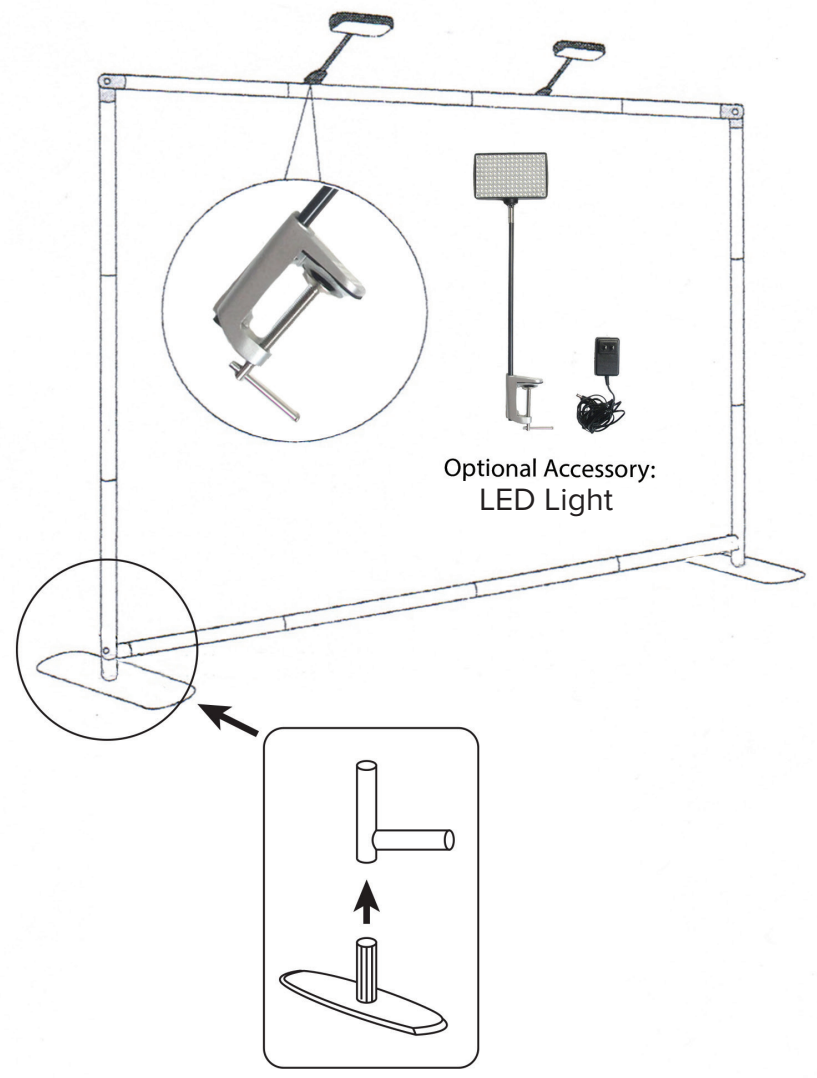

To assemble, connect the bottom corner connectors and feet together. Assemble the bungee-linked top and bottom horizontal tubes. Snap and connect the bottom horizontal tubes with the bottom corner connectors with matching labels. Then assemble the bungee-linked vertical tubes. Snap on the the remaining vertical tubes with the bottom corner connectors. Using the top corner connectors, connect the top horizontal tube to both vertical tubes to complete frame. Tilt or lay down frame to swiftly drape with the pillowcase graphic. Using the industrial-size-zipper, zip underneath the bottom tube, maximizing fabric tension. And zip closed.

